

File

2733.

MILAM SCRIP

46-999

Spring Creek Irrigation Co.

49 Acres

for origl Cert. No 1. and deed
to Jas. Spence, see file.
Travis Scrip 1139.

U. B. Certificate No. $23/301$.

Correct and map of Bosque
County. July 12/80

mkd ptd

C. W. Peoples.

Patent to R. C. Burnham

apex

Marsh

with R. C. Burnham apex

Sep. 7/87

Patent of Joseph G. ...

Sept 1/80 - William

N. 492 7-32

Mkd Pat Reg

Mgl

62302.

apex 29
7/11/80

CONTENTS.

No. 1. Certificate.

" 2. Field Notes.

" 3. Transfer

" 4. Surveys Cert. of Correction

apl 22/80

July 9, 80

Book

abstr. N. 1 999

James M. Robertson

No. 23/301

Class Scip

Quantity 119 Acres

General Land Office,

Austin, Texas, June 1th 1879

To any Legally Authorized Surveyor of the State of Texas:

This is to Certify That Scip Certificate

No. 1, issued to the Perry Cru Migration

Company by J. Greenhorn Genl Ld Office

on the 2nd day of July 1877

for 320 Acres of Land is now on file in this Office,

upon which

Two Hundred and Seventy One (271) Acres

have been returned and patented, leaving a balance of

Forty Nine (49) Acres

to be located, which you are authorized to survey by virtue of this Certificate.

In Testimony Whereof, I hereunto set my hand

and affix the Seal of said Office, the date

first above written.

A. C. Marsh

Commissioner.

See File 1139 Transcript for orig Certificate transfer to
Joseph Spence to whom the app to patent will pue

1 Title 2733.

Milam Scrip

Spring Creek Irrigation
Co

U. B. Certificate No. 23301
49 Acres

paid up 22.80

Rhoads Fisher
Clerk

98-9-6
66-4-01
66-20-6

2
The State of Texas & Fieldnotes of a survey
county of Basque of 49 acres made for
R. E. Burnham by virtue of certificate
No. 1 issued by J. J. Gross Comr Genl
Land Office on the 28th day of July
AD 1877. (See File 1139 Travis Scrip for
original transferred to Joseph Spence
and from him to R. E. Burnham.)
The same being situated in Basque
county Texas about 7 miles south ^{23'}

East of Meridian.

Beginning at the N.E. corner of a
survey made for St. M^cLee a pile of
stone in prairie being in the ~~west~~
line of the ^{Wm} A King survey; Thence
N 30° W 291 rods to the S.E. corner of
a survey ~~formerly~~ made for James
C. Johnson ^{ass^{ts} of Geo. J. Johnson} which corner is 370 rods
S 30° E from the N.W. corner of said Wm
A. King survey a pile of rocks in the
prairie; Thence S 60° W 947 rods
passed Johnson's S.W. corner 959 rods
to the ~~N.W.~~ N.E. corner of this survey a
pile of rocks; Thence S 30° E 291
rods to a pile of stone in M^cLee's north
line from which a Live Oak
hacked bears N 70° W 10 rods; Thence
N 60° E 959 rods to beginning

Surveyed 7th Oct 1879.

A. G. Turner }
R. T. Turner } C

James M. Robertson

County Surveyor Bosque County, Tex

The State of Texas } I James M. Robertson Surveyor of
County of Bosque } Bosque County, Texas do hereby cer-
tify that the above survey is correct and
made according to law and that the marks
natural and artificial are truly described in
the same.

James M. Robertson
County Surveyor Bosque Co., Texas.

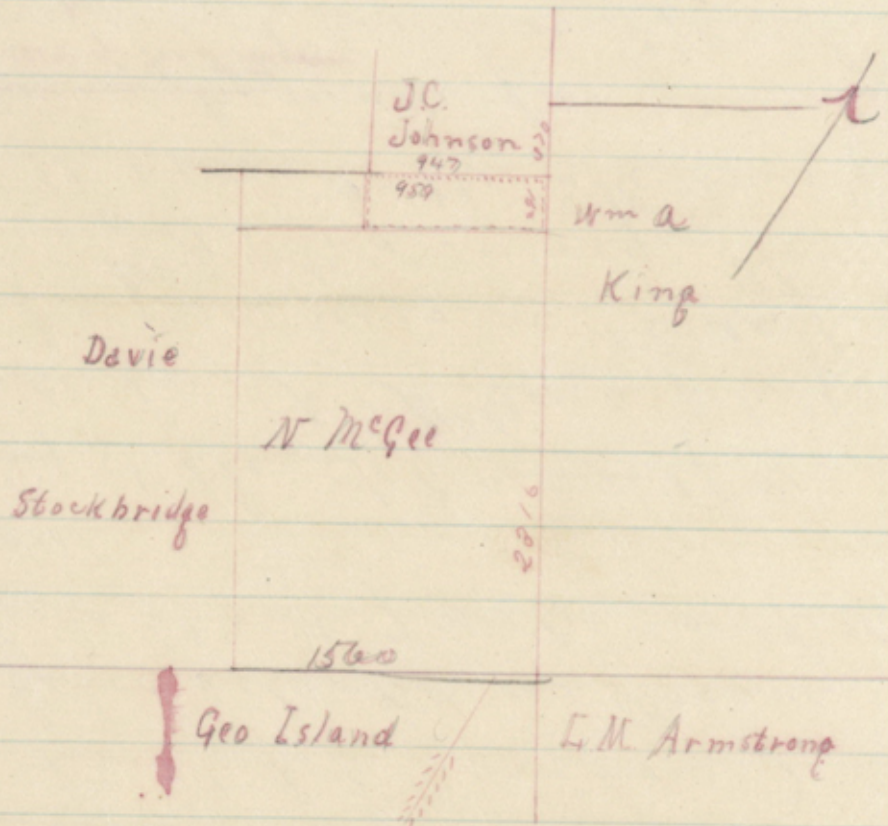

The State of Texas } I James M. Robertson County Surveyor
County of Bosque } of Bosque County, Texas do hereby
certify that the above plot is a true sketch of
the land upon which the foregoing 89 acres
was surveyed upon by a careful survey made
with sworn chain carriers and further that these

is actually a space of 291 rods vacant
between the Johnson and McLean surveys
after giving said surveys all the distance
and no of acres they each call for
caused by an excess in the line of
Wm a King said line being 2977
rods instead of 2688 as called for.

L. S.

To certify which I hereto
set my hand at office
in Meridian Bogue
County Texas ^{at} April 7, 1879
James M Robertson
Co Surveyor Bogue
County Texas

v Title 2733.

Milam Scrip

Spring Creek Irrigation
Company

Fieldnotes 49 Acres

Filed April 22 80

Rhoads Fisher
Chief Clerk

Correct and map of Bosque
County. July 12/80
C. W. Proffers.

Patented Sept 6/80
Malheur

Fieldnotes from
Bosque County

FILING FEE PAID

APR 22 1880

april 29
1880

State of Texas

County of Travis For and in consideration of the sum of Ninety $\frac{90}{100}$ Dollars the receipt of which is hereby acknowledged I Joseph Speer of the State and County aforesaid have this day bargained and sold and do hereby bargain sell transfer and convey to W. E. Burnham of the County of McLennan in the State of Texas the following described Land Certificate to wit: Number 23/301 issued by the Commissioner of the General Land Office June 7, 1879 for 49 acres of the Undivided Balance of Certificate Number one (1) issued July 28, 1877 to the Spring Creek Irrigation Company for 320 acres, which was transferred to me by the Company by transfer now on file in General Land Office dated July 31, 1877. To have and to hold said Undivided Balance Cert No 23/301 to the said W. E. Burnham his heirs and assigns forever: And I hereby warrant the title to said Certificate to the said W. E. Burnham his heirs and assigns against the claims of all persons whatever. This I do June 7th 1879

Joseph Speer

3 July 27 33

Milam Spring Creek
Spring Creek Tringalene
To Jcs. Spruce
deed.
R.E. Burnham.

filed June 22, 80
Rhoads Fisher
(Chf Clerk)

STATE OF TEXAS }

COUNTY OF TRAVIS.

Before me, D. B. Barnhart, a Notary Public for said county, duly commissioned and qualified.

this day personally appeared _____
to me well known, who acknowledged that _____ executed the foregoing instrument of writing
and declared the same to be _____ act and deed for the uses, purposes, and consid-
rations therein expressed.

To certify which, I hereto affix my hand and official seal in
the city of Austin 4th day of June 18 79

D. B. Barnhart
Notary Public, Travis county, Texas.

2/487

O. L. LOCKETT, Meridian. }
THOS. HARRISON, Waco. } Attorneys at Law.

Will practice in this and adjoining Counties, in the Appellate and Supreme Courts, and in the Federal Court at Waco.

—o—
Special attention given to LAND LITIGATION, and to COLLECTIONS.

J. M. ROBERTSON,
County Surveyor.

Lockett & Robertson,

Lawyers and Land Agents.

Will buy, sell, rent, lease and redeem lands, remove squatters, perfect titles, examine records, report condition of lands, and as to water, timber, soil, value, &c., &c.

Refer, by permission, to
ALEX. TRIMBLE, Co. Treas.
J. J. CHESTON, Sheriff.
J. H. JOHNSON, Dist. Clerk.
J. K. HELLON, Co. Judge.

Meridian, Texas, July 3rd 1880.

Hon. W. C. Walsh,
Austin, Texas,

Dear Sir:

Your favor of the 30th ult rec'd with statement for which please accept my thanks.

In regard to the Spring Creek Irrigation Co ^{W/B} Cert No ²³/₃₁₁ calling for J. L. Johnson instead of Geo. Henson I will state that I did not know that such was the case, (that is, that Johnson abandoned) I knew it was patented to Geo. Henson but presumed it was by assl as I could find no field notes recorded in Henson's name. I do not see any use in writing over all the field notes simply to correct the name hence I authorize you to erase Johnson and insert Henson in lieu thereof for me and issue and forward me the patent or if you can not do so send me the field notes and I will do so and return to you.

Yours truly
James M. Robertson

x Title 2733.

Milam Scrip

Spring Creek Irrigation Co
(U. S. C. t. 23 / 301)
Surveyor's Certificate of Correction
of a call.

filed July 8 / 50

Rhoads Fisher
Chief Clerk

2733

RECEIVED
JUL 10 1950
MILAM SCRIP