

3/20/08

402-407-1M

CONTENTS.

- 1. Application to Surveyor.
- 2. Field Notes.
- 3. Application to Purchase.
- 4. Treasurer's Receipt.

*3-20-08  
Youngblood*

SF  
File

8500

Dosque County

SCHOOL LAND.

*on P. 5603 & 2*

SOLD TO

*8-16-08*

*Rej: no vacancy  
April 11-1908  
John Terrell  
Comm.  
105 Acres.*

Survey No. *24*

Block No. ....

Surveyed for

*T J Lambert  
Walnut Springs*

ACT APRIL 15, 1905.

*Not disclosed by the official maps.  
See endorsement on field notes  
April 9/1908 D. von Rosenberg*

Mgl. ....

*cf - mar 21/08  
m.p.*

Application for a Survey to be made under Chapter XI, Page 29, Act of the First Called Session of the 26th Legislature, Approved February 23, 1900, and as amended by an Act, Approved April 15, 1901.

To H. M. Dillard County Surveyor of Bosque County, Texas, or to \_\_\_\_\_ District Surveyor of \_\_\_\_\_ land district:

You will please survey for me, and at my expense, under Chapter XI, page 29, Act of the First Called Session of the Twenty-sixth Legislature, approved February 23, 1900, and as amended by an Act, approved April 15, 1901, the following described land, to wit: also in accordance with Sec. 8 of an Act approved April 15, 1901

Situated in Bosque County, Texas, about 16 miles N. 32' W. from the County site. Said tract is bounded as follows:

On North by R. M. Reeder preemption,  
On the east by Henry Billings Survey,  
On the South by the G. W. Lively Co. and  
On the west by the C. C. O'Connell Survey

I solemnly swear that I reside in Bosque County, Texas; that my postoffice address is Walnut Springs, Texas; That I desire said land surveyed with the intention of purchasing the same, and that I am not acting in collusion with, or attempting to acquire said land for any other person.

(N. B.—Write name and P. O. distinctly.) T. J. Lambert Applicant  
Walnut Springs, Texas

Subscribed and sworn to before me, this 7th day of Feb 1908, and I hereby officially certify that with the exception of the field notes, I carefully read aloud to said applicant and for his benefit, the contents of the foregoing application and affidavit.

D. J. Butbirth Co. clk.  
Bosque Co Texas.  
(Note.—The above application may be sworn to before any officer authorized to administer oaths. SEAL MUST NOT BE OMMITTED.)

I, H. M. Dillard County Surveyor of Bosque County, Texas, or Surveyor for \_\_\_\_\_

Land District, hereby certify that the above and foregoing application was filed for record on the 7th day of Feb 1908, at 12 o'clock M., and recorded in Vol. 75- page 24, in my office Bosque County, Texas.

H. M. Dillard  
Co. Sur. Bosque Co.

File 8500  
Bosque County.

School Land.

App for Sur  
by J Lambert

Filed 3-19-1908

James Terrell  
Comm'r.  
J. M. Youngblood  
Clerk.

Survey No. ....

# APPLICATION

OF

## FOR A SURVEY OF LAND.

ACT OF 1900.

(AS AMENDED BY ACT APPROVED APRIL 15, 1901.)

In ..... County.

Received and filed this ..... day of

190.....

at ..... o'clock ..... M.

.....  
Surveyor.

Received and filed in General Land Office,

this ..... day of ..... 190.....

at ..... o'clock ..... M.

.....  
Commissioner.

*[Faint background text and bleed-through from the reverse side of the page, including a circular seal and various illegible words.]*

THE STATE OF TEXAS,

*Bosque* County,

No. ....

District, Blk. ....

FIELD NOTES of a survey of *105*

es of land made for *J. I. Lambert*

virtue of his affidavit and application made on the *7th* day

*Bosque* County or Land

District, on the *7th* day of *Feb* 1908, under Act of First Called Session of the Twenty-sixth Legislature, approved February 23, 1900, and as amended by an Act approved April 15, 1901, providing for the sale of unsurveyed land. Said land is situated in *Bosque County* County, about *16* miles *N. W.* from County site, and known as survey No. *24*

in block No. .... BEGINNING AT *the S.W. Corner of the Henry Billings Survey on line of Bosque & Somervell Counties for S.E. Cor of this School Grab -*  
*Hence N 30° W with the West line of said Billings*  
*Sur: 2200 to N.E. Cor. This [no branches crossed]*  
*Hence S 60° W with the South line of R. M. Reeder's*  
*preemption of 60 a. 270° to N.W. Cor of this and*  
*N.E. Cor. of the U. B. 100 Corner 320 a. Survey.*  
*Hence S 70° E with the East line of C' Corner at*  
*1638° a branch 2000 to S.W. of this & S.E. Cor. of*  
*said C' Corner.*  
*Hence N 60° E 270 to beginning. and containing*  
*One hundred & five acres -*

to the place of beginning.

Bearings marked

Surveyed *16th Mch* 1908

*N. F. Early*

Chain Carriers.

*U. B. Mattern*

*J. M. Dillard* Co.

Surveyor of *Bosque Co*

Texas, do hereby certify that the foregoing survey was made by me on the ground, and according to law; that the limits, boundaries and corners, with the marks, natural and artificial, are truly described in the foregoing Plat and Field Notes, just as I found them on the ground; and that they are recorded in my office in Book *C*

Page *205* This *17* day of *Mch* 1908

*J. M. Dillard*

Surveyor of *Bosque* Texas.

*J. M. Dillard* Co.

Surveyor of *Bosque Co.*

Texas, do hereby certify that the foregoing survey was made by me on the ground, and according to law; that the limits, boundaries and corners, with the marks, natural and artificial, are truly described in the foregoing Plat and Field Notes, just as I found them on the ground. This *17* day of *Mch* 1908

*J. M. Dillard*

Surveyor of *Bosque* Texas.

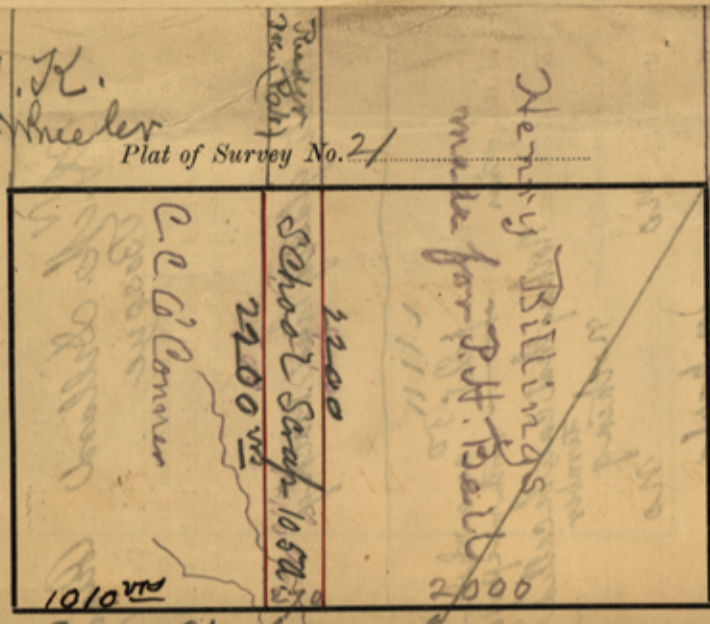

*Geo. W. Lively*

Variation

*2000*

on the *7th* day of *Feb*

1908, under Act of First Called Session of the

Twenty-sixth Legislature, approved February 23, 1900, and as amended by an Act approved April 15, 1901, providing for the sale of unsurveyed land.

Said land is situated in *Bosque County* County, about *16* miles *N. W.* from County site, and known as survey No. *24*

in block No. .... BEGINNING AT *the S.W. Corner of the Henry*

*Billings Survey on line of Bosque & Somervell*

*Counties for S.E. Cor of this School Grab -*

*Hence N 30° W with the West line of said Billings*

*Sur: 2200 to N.E. Cor. This [no branches crossed]*

*Hence S 60° W with the South line of R. M. Reeder's*

*preemption of 60 a. 270° to N.W. Cor of this and*

*N.E. Cor. of the U. B. 100 Corner 320 a. Survey.*

*Hence S 70° E with the East line of C' Corner at*

*1638° a branch 2000 to S.W. of this & S.E. Cor. of*

*said C' Corner.*

*Hence N 60° E 270 to beginning. and containing*

*One hundred & five acres -*

to the place of beginning.

Bearings marked

Surveyed *16th Mch* 1908

*N. F. Early*

Chain Carriers.

*U. B. Mattern*

*J. M. Dillard* Co.

Surveyor of *Bosque Co*

Texas, do hereby certify that the foregoing survey was made by me on the ground, and according to law; that the limits, boundaries and corners, with the marks, natural and artificial, are truly described in the foregoing Plat and Field Notes, just as I found them on the ground; and that they are recorded in my office in Book *C*

Page *205* This *17* day of *Mch* 1908

*J. M. Dillard*

Surveyor of *Bosque* Texas.

*J. M. Dillard* Co.

Surveyor of *Bosque Co.*

Texas, do hereby certify that the foregoing survey was made by me on the ground, and according to law; that the limits, boundaries and corners, with the marks, natural and artificial, are truly described in the foregoing Plat and Field Notes, just as I found them on the ground. This *17* day of *Mch* 1908

*J. M. Dillard*

Surveyor of *Bosque* Texas.

W. N. G. ...  
 or of ...  
 only swear th ...  
 of the land in ...  
 field notes is as ...  
 to glady ...  
 Dr ...  
 market value ...  
 other Dry ...  
 Timber North ...  
 value of Timber ...  
 No ...  
 for Settlement ...

THE STATE OF TEXAS, }  
 Survey }  
 Bosque County, No. ...  
 or District, Blk. ...

FIELD NOTES of a survey of 105  
 acres of land made for J. I. Lambert

Variation  
 before D. J. Buttrick  
 of Feb 7th 1908, and filed with the Surveyor of Bosque County or Land  
 District, on the 7th day of Feb 1908, under Act of First Called Session of the  
 Twenty-sixth Legislature, approved February 23, 1900, and as amended by an Act approved April 15, 1901, pro-  
 viding for the sale of unsurveyed land. Said land is situated in Bosque County  
 County, about 16 miles N. W. from County site, and known as survey No. 24  
 in block No. BEGINNING AT the S.W. Corner of the Henry

Billinga Survey on line of Bosque & Somervell  
 Counties for S. E. Cor of this School Grab  
 Thence N 32° W with the West line of said Billinga  
 Sur. 2200 to N. E. Cor. Thence (up branch crossed)  
 Thence S 61° W with the South line of R. M. Reeder's  
 preemption of 68 a. 270<sup>00</sup> to N. W. Cor. of this and  
 N. E. Cor. of the 46.6 10<sup>00</sup> Corner 320 a. Survey.  
 Thence S 75° E with the East line of S' Corner at  
 1638<sup>00</sup> a branch 2000 to S. N. of this & S. E. Cor. of  
 said S' Corner.  
 Thence N 61° E 270 to beginning. and containing  
 One hundred & five acres -

to the place of beginning.  
 Bearings marked N. F. Early }  
 Surveyed 16th Mch 1908 U. B. Mullen } Chain Carriers.

I, J. M. Dillard Co. Surveyor of Bosque Co.  
 Texas, do hereby certify that the foregoing survey was made by me on the ground, and according to law; that  
 the limits, boundaries and corners, with the marks, natural and artificial, are truly described in the foregoing  
 Plat and Field Notes, just as I found them on the ground; and that they are recorded in my office in Book C  
 Page 102 This 17 day of Mch 1908  
 J. M. Dillard  
 Co. Surveyor of Bosque Texas.

I, J. M. Dillard Co. Surveyor of Bosque Co.  
 Texas, do hereby certify that the foregoing survey was made by me on the ground, and according to law; that the  
 limits, boundaries and corners, with the marks, natural and artificial, are truly described in the foregoing Plat and  
 Field Notes, just as I found them on the ground. This 17 day of Mch 1908  
 J. M. Dillard  
 Co. Surveyor of Bosque Texas.

21

File 8500  
Bosque County.

School Land.

Field notes  
J. I. Lambert

Filed 3-19-1908

John J. Berrell  
Comm'r.

J. M. Youngblood  
Clerk.

Not disclosed by the official map.  
According to copy of  
Decree of court in Williams  
3-337 Cornelius O'Conner  
also 37th South Western  
page 316 there is no  
vacancy, but an excess  
belonging to the C. O'Conner  
p'd. 3-337 April 9/08.  
D. van Roubert

ofc. Mar 21/08  
M.V.

2

### FIELD NOTES.

Survey No. 24,  
Bosque County.  
Made for J. I. Lambert

I, A. M. Dillard  
Co Surveyor of  
Bosque County

do solemnly swear that the land included within  
the limits of the within field notes is properly  
and correctly classified as follows, viz:

Thin gravelly Soil.  
State Character.  
Dry or Watered Agricultural.  
Dry or Watered Grazing.  
No timber Timber.  
Dry or Watered, and Kind of Timber.

And that said land is reasonably worth  
\$ 200 per acre, and that the timber  
on said land is reasonably worth \$ Nothing  
per acre.

A. M. Dillard Co Surveyor.  
Sworn to and subscribed before me this the  
17 day of March 1908  
D. J. Cutbirth, Co. Clk  
Bosque Co. Tx

Approved and filed \_\_\_\_\_  
\_\_\_\_\_ 190

RECEIVED AS STATED  
100 Commissioner.  
V. M. MASS, SCHUTZE & CO., PRINTERS, AUSTIN, TEXAS.

MAR 19 1908  
GEO. W. BEAVER  
RECEIVER

*[Faint handwritten notes and bleed-through from the reverse side of the page.]*

2  
8



General Land Office.

State of Texas.

Austin.

April 11, 1908.

JOHN J. TERRELL, COMMISSIONER.  
J. T. ROBISON, CHIEF CLERK.

T. I. Lambert,  
Walnut Springs, Texas.

Dear Sir:

Referring to your 2 files covering Surveys  
24 and 22, SF 8500 and 8499, 105 and 211 acres, respec-  
tively, in Bosque county, you are advised that same are  
hereby rejected, for the reason that no vacancy can be  
recognized in these surveys.

Yours truly,

Youngblood-d  
Fs-8500&8499

Commissioner.

SF 8500  
(3)

General Land Office

State of Texas



April 11, 1908.

Austin

JOHN L. TERRELL, COMMISSIONER  
J. T. ROBINSON, CHIEF CLERK

T. I. Lambert,  
Walnut Springs, Texas.

Dear Sir:

Referring to your 2 files covering surveys  
84 and 82, SF 8500 and 8499, 105 and 211 acres, respec-  
tively, in Bosque county, you are advised that same are  
herby rejected, for the reason that no vacancy can be  
recognized in these surveys.

Yours truly,

Youngblood-d  
7a-85008499

Commissioner.





General Land Office.

State of Texas.

Austin.

September 10, 1908.

JOHN J. TERRELL, COMMISSIONER  
J. T. ROBISON, CHIEF CLERK.

Mr. H. M. Dillard,  
County Surveyor Bosque County,  
Meridian, Texas.

Dear Sir:

We acknowledge receipt of your favor of the 6th instant, enclosing money order for \$2.00, which balances your account. Now, with reference to the T.I. Lambeth Scrap file No. 8499, survey No. 24, between Henry Billings and C.C. O'Connor, near the North line in Bosque county, beg to advise that same was rejected because according to copy of decree of court, Cause No. 2051, P. T. Yocham vs McCurdy and Davies, District Court Bosque county, also 67th S.W. Rep., page 316, held that there was no vacancy, and upon examining the papers nothing is disclosed indicating that there was a compromise as the case was tried by a jury and a verdict rendered by said jury and that it appearing in accordance with the law this department could not recognize a vacancy under T.I. Lambeths file. If, however, you can establish the fact that the judgment was a compromise and you will furnish this department with these facts the matter will be taken up and carefully investigated. Awaiting your reply and hoping you may furnish the facts or information as will substantially confirm your contention, in this matter. In writing about this matter mention Milam 3rd Class, 337, Cornelius O'Connor; also S.F. No. 8500, in the name of T. I. Lambeth.

Yours truly,

Coleman-Dib

Commissioner.

5 F 8500

(4)

Central Trust Office



State of Texas

September 10, 1908.

Austin

JOHN J. TERRELL, COMMISSIONER  
J. T. ROBINSON, CHIEF CLERK

Mr. H. M. Willard,  
County Surveyor Borden County,  
Meridian, Texas.

Dear Sir:

We acknowledge receipt of your favor of the 8th instant, enclosing money order for \$2.00, which balances your account. Now, with reference to the T.I. Lambert Report, No. 8499, survey No. 24, between Henry Willard and W. O. O'Connell, near the north line in Borden County, please advise that name was rejected because according to copy of books of court, Cause No. 2051, P. T. Yocham vs. McQuay and Davis, District Court Borden County, also with E.W. Rep., page 210, held that there was no survey, and upon examining the papers showing in abstract including that there was a compromise as to the line of a quarter section, returned by said T.I. Lambert, and that it appeared to be a survey and that the same could not be returned as a survey until T.I. Lambert's survey, No. 8499, was returned. The fact that the same was a compromise and was not returned to this department until after the survey was taken up and eventually returned. Again, your reply and holding you may furnish the facts of the survey as it substantially confirm your contention, in this matter, in writing about this matter heretofore, in this matter, T.I. Lambert's Report, also S.F. No. 8500, in the name of T. I. Lambert.

Yours truly,

John J. Terrell

Commissioner

770  
939 1/2

Cada X N66W 13  
" " N54W 12

Lewis 4/8

C. J N84W 6  
" L N41W 5

P.O. M 558 8  
" N 402 W 14

1-564  
Cc 9/29/46

939 1/2

990  
N 67 E 120  
" D N 59 E 131

LO E S 19 E 17  
" F S 148 18  
LO E. S 4 W 50

Nate  
Flazen

T. K.

Wheeler  
1-561

Henry

9/29/46  
990

Billings  
B-728

635 950

C.C.

6/9  
Bourner  
3-337

July 18/51  
date  
400 m excess 8 kW

A B,  
King

G. 1350  
9/28/46 260

2000  
1790

1265  
155  
1350

Willow W N 27 W 27  
P N 10 W 27

Geo. W. Sept 28/46  
9/28/46

Lively  
2-172

W. T.  
Malone

1840 1910 940

S.P. G S 16 E 33  
Pecan H S 70 E 26

SF8500

③