

3/29/06

6/19/06 L

S. F.

File 7501 Abst 1340

# Houston County SCHOOL LAND.

SOLD TO  
W Dickey  
D.G.E.T  
12-19-06  
55.70 Acres.

Accept 50y Gray Timber  
Survey No. 75  
Land 1/10 Single  
17/19/06  
Block No. John Harrell  
Surveyed for

W. S. Dickey

ACT FEBRUARY 23, 1900.

Comp P. 576 RA Gilmore

See endorsement on field notes within.  
Pat to original Legg 6/25/06  
3/5/07 Travis  
Patented Mich 4/1904  
No. 403 vol 33  
Mgl. Heslet

abst. vol. 30

70 June 19/06

## CONTENTS.

1. Application to Surveyor. 6/8/1906.
2. Field Notes. Stuehlin
3. Privately 12/12/06.
4. Spec. Cont 12/15/06.
5. Application to Purchase.

### Treasurer's Receipt

5 Timber app } 12/24/06  
 6 app to Phil. }  
 7 & 8 Specs Recd 2/12/07  
Paid in full for 55.70  
Acres Stuehlin  
3/1/07

Sold pat. to Geo W Crook  
Crockett Texas - Robison  
3/1/07

Notified Geo W Crook,  
Agent Crockett  
Specs  
4/11/07  
W. S. Dickey  
Crockett

# Application for Survey

APPLICATION NO. 75.

To B. F. Duren County Surveyor of Houston  
County, Texas, or ~~to~~ District Surveyor  
of Land District.

By virtue of Section 8 of an Act approved April 15, 1905, I hereby apply for a survey of the following described unsurveyed land appropriated to the Public Free School Fund under Chapter 11, Act February 23, 1900, to-wit:

Situated in Houston County, Texas, about 9 1/2 miles  
N.E. from the County site. Said tract is bounded as follows:  
on North by ~~W. J. Dickey~~ A Well on  
East by G. Grounds on South by E. T. Allen  
on West by J. D. Dickey survey = This  
survey covers the J. A. Gilmore 53 7/10 acre survey -  
abandoned -

I solemnly swear that I desire said land surveyed with the intention of buying it, and that I am not acting in collusion with, or attempting to acquire said land for another person or corporation.

W. J. Dickey Applicant.

(N. B. - Write Name and P. O. address distinctly.)

P. O. Lovick (Rd # 1), Texas.

Subscribed and sworn to before me, this 16th day of May 1906.

(SEAL MUST NOT BE OMITTED)

J. F. Duren  
Notary Public Houston, Texas

I, B. F. Duren County Surveyor of Houston  
County, Texas, or ~~Surveyor for~~ hereby certify that the above  
Land District, hereby certify that the above and foregoing application No. no. 75. was filed for record on the 16th  
day of May 1906, at 12 o'clock M., and recorded in Vol. 1 page 108  
in my office Houston - County, Texas.

B. F. Duren  
Co Surveyor Houston, Texas

LAND OFFICE

S. F. No.

51<sup>2</sup>  
7501

Application for Survey

*W. D. Siskey*

Filed

*June 5<sup>th</sup> 1906*

*John Purcell*  
Commissioner.

*J. A. Sulchins*  
Clerk.



N Plat of Survey No. 75.

The State of Texas, Survey No. 75. Houston County, or District. Blk.

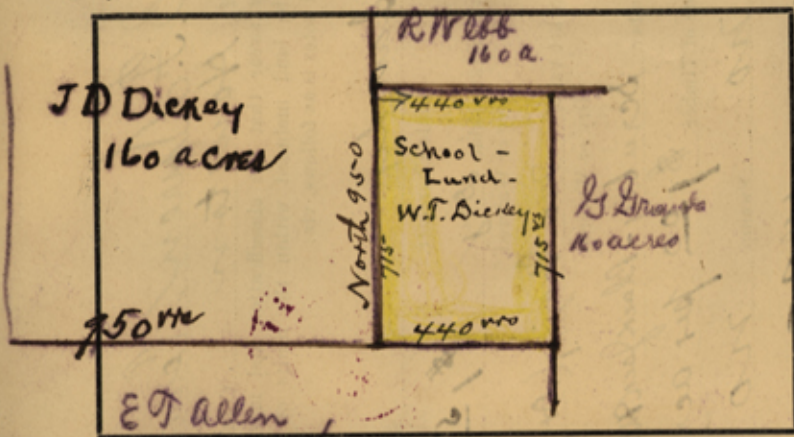

FIELD NOTES of a survey of 55.7/10

acres of land made for W. T. Dickey

by virtue of his affidavit and application made before J. F. Suren, Notary Public, Houston Co. Texas on the 16th day of May 1906, and filed with the Surveyor of Houston County or Land District, on the 16th day of May 1906, under Section 8 of an Act approved April 15, 1905, providing for the sale of the unsurveyed school land appropriated to the Public Free School Fund by an Act approved February 23, 1900. Said land is situated in Houston County, about 9 1/2 miles N 10 E from County site, and known as survey No. 75, in Block No. beginning at Rufus Webb's S.W. Corner on J. D. Dickey's E. B. line a Pine 10 in. mid. x bro. S 63 30 E 6 vrs Do 8 in. mid. x bro. S 37 0 E 5 vrs = Thence East with said Webb's S. B. line at 440 vrs to George Grounds N.W. Corner a Black Jack mid. x bro. West 4 vrs = Thence South with said Grounds N. B. line at 715 vrs corner a Pine 20 in mid x bro North 5 vrs a Post Oak 14 in mid x bro S 56 N 5 vrs = Thence West with E. J. Allen's N. B. line at 440 vrs to J. D. Dickey's S.E. Corner a Pine 15 in mid x bro. N 54 W 3 vrs - a Hickory bro S 25 E 4 1/2 vrs = Thence North with said Dickey's E. B. line at 715 vrs to the place of beginning =

"note" This survey covers the F. A Gilmore (Abandoned) to the place of beginning.

Bearings marked X G. W. Shavers Surveyed May 29th 1906 J. E. Luce Chain Carriers.

I J. F. Suren, Surveyor of Houston County, Texas, do hereby certify that the foregoing survey was made by me on the ground, and according to law; that the limits, boundaries and corners, with the marks, natural and artificial, are truly described in the foregoing Plat and Field Notes, just as I found them on the ground; and they are recorded in my office in Book no. 1 Page 67.

This 29th day of May 1906.

B. F. Durren Surveyor of Houston County, Texas.

Bob Weene 8/25

I, B. F. Duren, County  
Houston County,  
do solemnly swear that the classification and market  
value of the land included within the limits of the  
within field notes is as follows, viz:

Gray Sandy Soil.  
State Character.  
Agricultural, market value Dry \$150  
Dry or Watered.  
Grazing, market value no grazing (dry)  
Dry or Watered.  
Kind of Timber Scrubby - Black Jack & Post Oak  
Market value of Timber \$100 per acre  
Overflow no Swamp no  
Suitable for Settlement yes -

B. F. Duren  
County Surveyor, Houston County, Texas  
Sworn to and subscribed before me this the 29th  
day of May 1906.

J. F. Duren  
Notary Public, Houston County, Texas

Within enclosure of Corros the F. A. Gilmore (abandoned)  
Improvements owned by none -

P. O. address of owner of enclosure or improvements is  
Brockett, Texas  
B. F. Duren  
County Surveyor,  
Houston Co. Texas

LAND OFFICE

S. E. No. 75-7501

FIELD NOTES

Filed June 5 1906  
John J. Farrell  
Commissioner.

J. A. Hutchins  
Clerk.

Approved Dec 19 1906  
John J. Farrell  
Commissioner.

Not discl'd by offl maps  
in use 7/23/00 or now  
Vacancy less than 80  
surrounded.  
Corr P. 576 R. Gilmore  
Correct on map of Houston  
Co. Legg 6/25/06

Pr. 576 cancelled  
Hutchins 11/10/06

Patented Feb 14/1904  
Wesley

9c June 15/06

FILING FEE PAID.  
JUN 5 1906  
W. B. ANTHONY, Receiver,  
GENERAL LAND OFFICE.

Surveyor of \_\_\_\_\_ Texas.

I \_\_\_\_\_, Surveyor of \_\_\_\_\_, Texas, do hereby certify that I have examined the foregoing Plat and Field Notes and find them correct and that they were made on the ground as stated in the above certificate, and that they are recorded in my office in Book \_\_\_\_\_, Page \_\_\_\_\_, This \_\_\_\_\_ day of \_\_\_\_\_ 190\_\_\_\_\_.

Deputy Surveyor of \_\_\_\_\_ Texas.

I \_\_\_\_\_, Deputy Surveyor of \_\_\_\_\_, Texas, do hereby certify that the foregoing survey was made by me on the ground, and according to law; that the limits, boundaries and corners, with the marks, natural and artificial, are truly described in the foregoing Plat and Field Notes, just as I found them on the ground. This \_\_\_\_\_ day of \_\_\_\_\_ 190\_\_\_\_\_.

The State of Texas § Know all men by these presents that I, W.T. Dickey  
County of Houston § of the County of Houston in the State of Texas  
do hereby make, constitute and appoint George W. Crook, also of said County  
and State my true and lawful attorney for me and in my name place and  
stead to represent me in procuring a patent from the State of Texas to  
a certain tract of land situated in said Houston County, Texas, heretofore  
surveyed for F.A. Gilmore and known as the F.A. Gilmore survey, being the  
same for which I have made application as purchaser from the State of  
Texas and I hereby authorize the said Geo. W. Crook to fully represent me  
in all matters and things pertaining to said land, and I hereby author-  
ize the Commissioner of the General Land Office to direct all letters  
intended for me to my said attorney.

Witness my hand this the 6 day of December A.D. 1906.

W.T. Dickey

The State of Texas, ) Before me, John Spence, County Judge in and for  
County of Houston )  
Houston County, Texas, on this day personally ap-

peared W. T. Dickey, known to me to be the person whose name is subscribed  
to the foregoing instrument and acknowledged to me that he executed the  
same for the purposes and consideration therein expressed.

Witness my hand and seal of office this 6th day of December A. D. 1906.

John Spence  
County Judge, Houston County, Texas.

County Judge, Houston County, Texas.

*John Bruce*

Witness my hand and seal of office this 6th day of December A. D. 1906.

same for the purposes and consideration therein expressed.

to the foregoing instrument and acknowledged to me that he executed the

Devised W. T. Dickey, known to me to be the person whose name is subscribed

Houston County, Texas, on this day personally su-  
before me, John Spence, County Judge in and for

Clerk.

day of December A. D. 1906.

*W. T. Dickey*

3

51-  
File 7501  
Houston County.

School Land.  
W. T. Dickey  
Power atty

Filed 12/17 1906  
John Spence  
Comm'r.

John Spence  
Clerk.

a certain tract of land situated in said Houston County, Texas, heretofore  
stand to represent me in procuring a patent from the State of Texas to  
and State my true and lawful attorney for me and in my name place and  
do hereby make, constitute and appoint George W. Crook, also of said County  
County of Houston of the County of Houston in the State of Texas  
The State of Texas I know all men by these presents that I, W. T. Dickey

1667

B. F. Duren & Son  
Real Estate Agents  
Surveyors, Abstractors  
Crockett, Texas

Dec 13<sup>th</sup> 1906.

Hon John J. Terrell  
Austin Texas.

my dear Sir:

"S. F. 7500"

In reply to your letter of 7<sup>th</sup> Inst will

say, I was with my Father, B. F. Duren who was  
Co. Surveyor at the time and assisted him in surveying the  
W. T. Dickey 55.7 acres and same is not enclosed and  
has no improvements on same, this survey was at one  
time surveyed for F. A. Gilmore who abandoned same  
that is did not reside upon the land 3 years, all the improvements  
made by said Gilmore are gone now - Hoping this will suffice

I am very truly :- J. F. Duren  
Co. Surveyor.

*[Faint handwritten notes and stamps]*

57 2501

*[Faint, mirrored handwritten text, likely bleed-through from the reverse side of the page. The text is largely illegible due to fading and mirroring.]*

CHARLES ROGAN, COMMISSIONER.  
J. J. TERRELL, CHIEF CLERK.

*[Faint handwritten notes or signatures at the bottom right of the page.]*

File <sup>SVC</sup> 7501 4  
Houston County.

School Land.  
W. I. Dickey  
Surs. Clerk

Filed 12/15 1906

J. Robinson  
Comm'r.  
J. Hutchins  
Clerk.

J. J. LEBBETT, CHIEF CLERK  
CHARLES BOGGS, COMMISSIONER

Original

RECORDED  
INDEXED  
JAN 10 1907



## APPLICATION TO PURCHASE TIMBER

Crockett

TEXAS,

Dec 21 1906

To Hon. JOHN J. TERRELL,

Commissioner General Land Office:

I hereby apply to purchase under the provisions of an Act relating to the sale and lease of Public Free School land and Asylum lands, as provided for in Chapter CXXV, Section 8, of the Act approved April 19, 1901, and the Act of April 15, 1905, the timber on the following described land, situated in Houston County, 9 1/2 miles (give course) N.E. from County Site, agreeing to pay cash for the same the price per acre below specified.

Section	Block	Certificate	GRANTEE	Acres	Price per Acre
<u>sur. no 75</u>			<u>Surveyed for W. J. Dickey</u>	<u>55 2/10</u>	<u>2.00</u> <del>3.00</del>

Signed:

W. J. Dickey

Applicant

Post Office Address:

Crockett

Texas

No. ....

Timber Application of

*M J Dickey*  
P. O. *Leackitt*

SECTION	BLOCK	TOWNSHIP	ACRES
<i>75</i>	<i>—</i>	<i>—</i>	<i>557</i>
S. F. No.	GRANTEE		CERTIFICATE
<i>7501</i>	<i>M J Dickey</i>		<i>—</i>

In *Houston* County

Filed *Dec 24* 1906

*John Ferrell* Commissioner

Awarded *Jan 7* 1907

Rejected *—* 190

*John Ferrell* Commissioner

Roll *—*

Class *Sum T. S.*

Appr'm't *\$200*

Appl. *X*

Map *#9556*

Lease *—*

On Market *—*

*S.F. 7501*  
*Houston* County.

School Land.

*M J Dickey*  
*Timber app*

Filed *12/24* 1906

*John Ferrell*  
Comm'r.  
*J. A. Hutchins*  
Clerk.

## Application and Obligation to Purchase School Land Without Settlement.

P. O. Crockett, Texas, Dec 21 1906

To the Commissioner of the General Land Office, Austin, Texas:

By virtue of Section 8 of the Land Act approved April 15, 1905, I hereby apply to purchase the following described land, in Houston County, about 9 1/2 miles N. E (course) from county site, and I agree to pay for the land the price per acre offered below:

Survey No.	Block	S. F. No.	Surveyed for	Acres	Price Per Acre	Classification
<u>75</u>			<u>W. J. Dickey</u>	<u>53 2/10</u>	<u>200 for timber 50 for land Total \$3.50</u>	<u>Dry Grazing</u>

For the purpose of securing said land I have remitted to the State Treasurer, at Austin, Texas, the sum of \$199 25 including \$5.00 patent fee as the full cash payment therefor, and subscribe to the following oath, to wit:

I, W. J. Dickey, do solemnly swear that I am not acting in collusion with others for the purpose of buying the land for any other person or corporation, and that no other person or corporation is directly or indirectly interested in the purchase thereof.

(Signed) W. J. Dickey  
Applicant.

Postoffice Crockett, Texas

Sworn to and subscribed before me, this the 21 day of December, 1906

Geo W Crook  
Notary Public Houston County, Texas.

NOTE—If applicant pays all cash he should tear off the obligation below.

Officer must not omit seal.

52  
6  
7501  
File No.

Houston  
County

W. G. Dickey  
Appl. and Oblig.

Filed Dec 24 1906

John Farrell  
Commissioner

J. A. Hutchins  
File Clerk

No. ....

S. F. No. ....

APPLICATION OF  
W. G. Dickey  
P. O. Crockett  
WITHOUT SETTLEMENT

SECTION	BLOCK	S. F. No.	ACRES
<u>25</u>	<u>—</u>	<u>7500</u>	<u>55</u> <sup>70</sup>

TOWNSHIP \_\_\_\_\_ Surveyed for  
W. G. Dickey

In Houston County

Filed Dec 24 1906

John Farrell Commissioner

Awarded Jan 7 1907

Rejected \_\_\_\_\_ 190  

John Farrell Commissioner

Roll \_\_\_\_\_

Class \_\_\_\_\_

Appr'm't \_\_\_\_\_

Appl'n \_\_\_\_\_

Obligation \_\_\_\_\_

Seal \_\_\_\_\_

Map \_\_\_\_\_

Lease \_\_\_\_\_

On Market \_\_\_\_\_

#9556



1572288878

File No. *501*  
*Houston* County.

SCHOOL LAND

Treasurer's Receipt.

*W. Dickey*

Filed *2/27* 190*7*

*John J. Furell*  
Comr.

*J. Hutchins*  
File Clerk.

No. 24803

*W. Dickey*

*W. Dickey*

ORIGINAL

County, sold under an Act approved April 10, 1882, and amendments thereto.

of the State of

County

Certificate No.

Block No.

the same being first payment on

the sum of

on account to

Received of

of the State of

for

and

TREASURER'S OFFICE

Date of Sale

P. O.

Terms of Sale: *23 23/100*  
*W. Dickey*

*W. Dickey*  
*John J. Furell*  
*J. Hutchins*

*120*  
*22 1/2*

*103 21*

*W. Dickey*

THE STATE PRINTING CO., DALLAS, TEXAS

Letter No.

16301

Date of Sale

Dec 27-06

P. O.

Herodect

Acres

55 7/8

@ \$

2 00

per acre

TREASURER'S OFFICE. No. 54206

AUSTIN, TEXAS,

Received of

W. J. Dickey

on account of

Self (Timber)

the sum of

One Hundred Eleven

DOLLARS,

the same being first payment on

Tr 4501

Section

75

Block No.

Certificate No.

Grantee

W. J. Dickey  
Waxton

situated in

County, sold under an Act approved April 16, 1895, and amendments thereto.

Terms of Sale,

Cash

\$

111 04

Sam Sparks

Treasurer.

ORIGINAL

Vertical stamp: ORIGINAL  
Vertical stamp: 2000  
Vertical stamp: 190  
Vertical stamp: 75  
Vertical stamp: 111 04  
Vertical stamp: 54206  
Vertical stamp: 16301  
Vertical stamp: Dec 27-06  
Vertical stamp: W. J. Dickey  
Vertical stamp: Waxton  
Vertical stamp: Sam Sparks  
Vertical stamp: Treasurer.

191212291

*Handwritten notes in purple ink, including '150' and '100'.*

File No. 17501  
Houston County  
SCHOOL LAND  
Treasurer's Receipt.

W. D. Dickey

Filed 2/12 1907

John J. Tunell  
Com'r.

J. A. Hutchins  
File Clerk

100 24500

ORIGINAL

County, and amendments thereto.

in

Certificate No.

Block No.

the same being first payment on

the sum of

on account of

Received of

AUSTIN, TEXAS

500

22

TREASURER'S OFFICE

Date of Sale

Factor No.

10321

20-7-5-1175

P. O.

2000000000



General Land Office,

State of Texas.

Austin.

JOHN J. TERRELL, COMMISSIONER.  
J. T. ROBISON, CHIEF CLERK.

June 27, 1906.

Mr. W. T. Dickey,  
Corckett, Texas.

Dear Sir:-

Referring to your file, covering a survey of land made for you in Houston County, being survey No. 75 of 55.7 acres, SF-7501, I beg to say that we find your file covers the F. A. Gilmore pre-emption, Houston P-576, and before we can sell this land to you, you must show by the affidavit of three or more credible, disinterested citizens of Houston County, that neither F. A. Gilmore, nor any one claiming under him occupied this pre-emption survey for three consecutive years from the date of his application. When this affidavit is received by this department your file will have further consideration.

Yours truly,

Act'g. Commissioner.

Hutch-Guyer.

Central Land Office

State of Texas

Austin



JOHN L. TERRELL, COMMISSIONER  
J. T. ROBINSON, CHIEF CLERK

June 27, 1908.

Mr. W. T. Dickey,  
Corocket, Texas.

Dear Sir:

Referring to your file, covering a survey of land made for you in Houston County, being survey No. 75 of 55.7 acres, SW-7501, I beg to say that the land your file covers was not surveyed by you. You must show by the affidavit of title or one credible disinterested citizen of Houston County, that neither F. A. Gilmore, nor any one claiming under him occupied this pre-emption survey for three consecutive years from the date of application. When this affidavit is received by this department your file will have further consideration.

Yours truly,

1057-75

Act'g. Commissioner.

Hutch-Guyver.



General Land Office,

State of Texas.

Austin.

Oct. 27, 1906.

JOHN J. TERRELL, COMMISSIONER.  
J. T. ROBISON, CHIEF CLERK.

Mr. W. T. Dickey,

Crockett, Texas.

Dear Sir:

Referring to your file, SF-7501, covering survey #75, 55.7 acres of land made for you in Houston county under the Act of April 15, 1905, I beg to refer you to our letter of June 27, 1906, in which we advised you that your file covered the F. A. Gilmore pre-emption and that you would be required to furnish this office with an affidavit of abandonment of that pre-emption before the land could be sold to you. Up to this time we have heard nothing from you. This matter has been pending a long time and we are anxious to close it up finally, and unless you comply with our requirements as set forth in our letter of June 27, 1906, within the next thirty days, we will be compelled to cancell your file account of incorrect field notes.

Yours truly,

Commissioner

Guyer.  
SF-7501

General Land Office

State of Texas

Austin

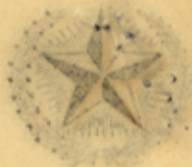

Oct. 27, 1906

JOHN J. TERRELL, COMMISSIONER  
J. T. ROBINSON, CHIEF CLERK

Mr. W. T. Stoker,  
Groesbeck, Texas.

Dear Sir:

Reference is made to your letter of the 15th inst. covering survey No. 5577 covering land in the Groesbeck area, and in your letter of the 27th inst. in which we advised you that your life covered the W. A. Dillmore pre-emption and that you would be required to furnish this office with an affidavit of abandonment of that pre-emption before the land could be sold to you. Up to this time we have heard nothing from you. This matter has been pending a long time and we are anxious to close it up finally, and unless you comply with our requirements set forth in our letter of June 27, 1906, within the next thirty days, we will be compelled to cancel your title account of incorrect field notes.

105750

Yours truly,

Commissioner

Over,  
ST-7-801



General Land Office.

State of Texas.

Dec. 7, 1906.

Austin.

JOHN J. TERRELL, COMMISSIONER.  
J. T. ROBISON, CHIEF CLERK.

County surveyor,

Houston County,

Crockett, Texas.

Dear Sir:-

In the matter of survey #75 made for W. P. Dickey in Houston county, field notes for which are of record in book 1, page 67 in your office, I have to say that the field notes are correct for 55.7 acres. We find on the reverse of the field notes that you report this land within the enclosure of and is covered by the F. A. Gilmore (abandoned). You say there are no improvements on the land. I would like for you to advise this department whether or not this land lies within an enclosure and if so to give the name and P. O. address of the owner or owners. It seems that you have certified that the land is within the enclosure of F. A. Gilmore but your certificate is not perfectly clear, and hence, I ask for this information.

Yours truly,

Hutch-Guyer.  
SF-7501

Commissioner

General Land Office



State of Texas

Austin

Dec. 7, 1906

JOHN A. TERRELL, COMMISSIONER  
J. T. ROBINSON, CHIEF CLERK

County Surveyor,  
Houston County,  
Ochockel, Texas.

Dear Sir:-

In the matter of survey proceedings in Dickey in Houston County, field notes for which are of record in book I, page 67 in your office, I have to say that the field notes are correct for 88.7 acres. We find on the reverse of the field notes that you report this land within the enclosure of and is covered by the P. A. Gilmore (abandoned). You say there are no improvements on the land. I would like for you to advise this department whether or not this land lies within an enclosure and if so give the name and P. O. address of the owner or owners. It seems that you have certified that the land is within the enclosure of P. A. Gilmore but your certificate is not perfectly clear, and hence, I ask for this information.

5/17/50

Yours truly,

Commissioner

Hutch-Guyot,  
82-7501



## General Land Office

State of Texas

Austin

Dec. 19, 1906.

JOHN J. TERRELL, COMMISSIONER  
J. T. ROBISON, CHIEF CLERK

Mr. W. T. Dickey,  
C/o Geo. W. Crook, Agt.,  
Crockett, Texas.

Dear Sir:-

Your application to the county surveyor of **Houston** county, for a survey of land under section 8 of the Act of April 5, 1905, together with the field notes for survey No. **75**, block No. **55-7/10**, acres, has been examined and the field notes approved.

The land is classified as **Dry Grazing** and valued at \$ **1.50** per acre, and is subject to sale to you upon the following terms, to-wit:

The timber on this land is valued at \$2.00 per acre and must paid for in cash before the land can be sold to you. You can apply for the land and the timber at the same time. The land is subject to sale to you for cash only. When you make your application to purchase this land for cash only and send same to this office, you should at the same time remit to the State Treasurer, Hon. Jno. W. Robbans, Austin, Texas, the aggregate price of the land as the full cash payment thereon, and send to this office a patent fee of \$5.00.

Enclosed herewith is a blank for application to purchase this land. To avoid delays, mistakes and correspondence, you are urged to fill every blank space in making out the application to purchase. Under the law you will have SIXTY DAYS from this date within which to file your application to purchase in this office.

In writing about this matter please refer to S.F.No. **7501**

Very respectfully,

Guyer

Commissioner.



JOHN A. TERRELL, COMMISSIONER  
L. T. ROBINSON, CHIEF CLERK

Central Land Office  
State of Texas  
Houston

Dec. 19, 1906

Mr. W. T. Dickey,  
C/o Geo. W. Crook, Agr.,  
Groesbeck, Texas.

Dear Sir:-

Your application to the county surveyor of  
Houaton  
County, for a survey of the land described in the field notes  
together with the field notes of survey No. 78  
1905, has been examined and the field notes approved.

The land is classified as Dry Grazing  
and valued at \$1.50 per acre, and is subject to sale to you upon the following  
terms, to-wit:

557-15

The timber on this land is valued at \$3.00 per acre and  
must be paid for in cash before the land can be sold to you. You can  
apply for the land and the timber at the same time. The land is  
subject to sale to you for cash only. When you make your application  
to purchase this land for cash only and send same to this office, you  
should at the same time remit to the State Treasurer, Hon. J. B.  
Robb, Austin, Texas, the aggregate price of the land as the full  
cash payment thereon, and send to this office a patent fee of \$5.00.

9 SF 7501

Enclosed herewith is a blank for application to purchase this  
land. To avoid delays, mistakes and correspondence, you are urged  
to fill every blank space in making out the application to purchase.  
Under the law you will have SIXTY DAYS from this date within which  
to file your application to purchase in this office.

In writing about this matter please refer to S. F. No. 7501

Very respectfully,

Commissioner

Buyer