

✓
File 2171 ✓

Dracos County

SCHOOL LAND.

Abst 254

SOLD TO

52 1/2 ⁹ 8-22-01
~~80~~ ^{HP}
Acres.

✓ 8/22/01 Dracos 39
Survey No.

Block No. Charles Rogan
Commr.

Surveyed for

Jeff P. Mitchell

ACT FEBRUARY 23, 1900.

(Detected)
Corrected on map of Dracos
County Aug 22/1901.
Aug 24/1901. D. von Rosenberg

Mgl. 7-29-1901

Abst. Vol. 25

16 P. 119

53/357

Map Rtd on Reg and map 9-12-01.

CONTENTS.

6.26.01
Rogan

1. Application to Surveyor.
2. Field Notes.
~~2 1/2~~ ^{7.2.01} Rogan
3. Letter of Explanation
3 1/2 app. to Pur
4. Treasurer's Receipt.

Patent to Original 9/9/01
Charles Rogan
Commr

Patented 9/10/01. Wicker
No 252 Vol 21

\$500 Paid 8/28/1901
by Jeff. P. Mitchell
Bryan Texas

Application for a Survey to be Made Under Chapter XI, Page 29, Act of the First Called Session of the 26th Legislature Approved February 23, 1900.

To Dick Jones Esq., County Surveyor of Troy County, Texas, or to _____ Esq., District Surveyor of _____ land district:

You will please survey for me, and at my expense, under Chapter XI, page 29, Act of the First Called Session of the Twenty-sixth Legislature, approved February 23, 1900, the following described land, to-wit:

Situated in Troy County, Texas, about 14 miles 5 1/2 from the County site. Said tract is bounded as follows:

On the South by the Sterrett D. Smith and West by James Gray, Surveyor, and on the East by the Nevada River.

I solemnly swear that I reside in Troy County, Texas; that my postoffice address is Bryan, Texas; that I desire said land surveyed with the intention of purchasing the same, and that I am not acting in collusion with, or attempting to acquire said land for any other person. I further swear that I have a preference right to purchase said land, for the following reasons: (Affiant will state specifically, using the exact language of the Statute, under which preference he bases his right, if any he claims)

I further swear that no other person has a preference right over me, either under section five (5) or seven (7) of the Act approved February 23, 1900, to purchase the above described tract of land. To the best of my knowledge & belief

Jeff P. Mitchell Applicant.
Bryan, Texas.

(N. B. Write name and P. O. distinctly.)

Subscribed and sworn to before me, this 12th day of June, 1901, and I hereby officially certify that with the exception of the field notes, I carefully read aloud to said applicant and for his benefit, the contents of the foregoing application and affidavit.

G. W. McMichael Clerk
By A. L. Sunnica Deputy

(Note. The above application may be sworn to before any officer authorized to administer oaths. SEAL MUST NOT BE OMITTED.)

I, Dick Jones County Surveyor of Troy County, Texas, or Surveyor for _____ Land District, hereby certify that the above and foregoing application was filed for record on the 12th day of June, 1901, at 1:35 o'clock P. M. and recorded in Vol. 1, page 394, in my office in Bryan County, Texas.

Dick Jones
Co. Surveyor Troy Co. Tex.

Survey No.

APPLICATION

OF

Jeff P. Ritchie

FOR A SURVEY OF LAND.

Act of 1900.

In *Brays* County.

Received and filed this *12* day of

June 190*1* at *1:35* o'clock *P.*M.

W. H. Jones

Surveyor.

Wm. H. Davis

Received and filed in General Land Office,

this _____ day of _____ 190_____

at _____ o'clock _____ M.

Commissioner.



File Clerk.

Charles Rogan
Com'r.

CHARLES ROGAN,

Filed *6/24/1901*

Jeff P. Ritchie
School Land,
Brays County,

Brays County,

File No. *592171*

11

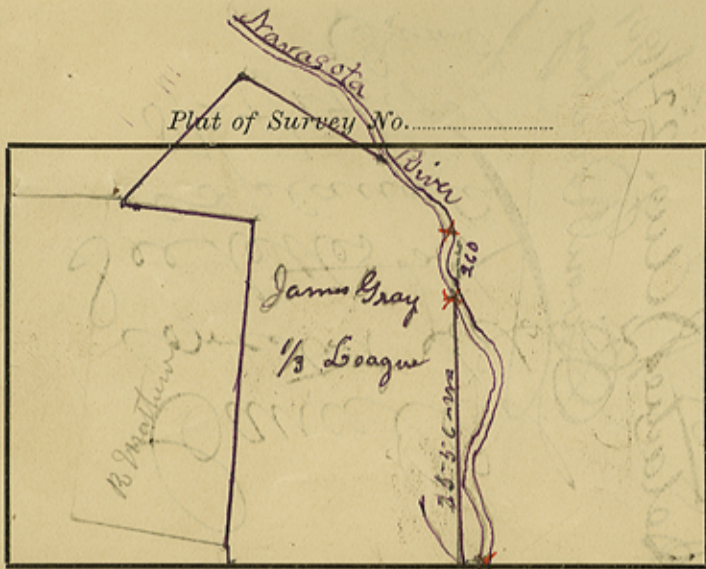

The State of Texas,

Survey
 Bryan County, No. 39
 or District. Blk. _____

FIELD NOTES of a survey of 80
 acres of land made for Jeff P. Mitchell

Street & Smith Variation 8 1/2

by virtue of his affidavit and application made

before A. T. Sumner Sept. 10. 1901 on the 12th day of June 1901, and filed with the Surveyor of Bryan County or Land District, on the 12th day of June 1901, under Act of First Called Session of the Twenty-Sixth Legislature, approved February 23, 1900, providing for the sale of unsurveyed land. Said land is situated in Bryan County, about 1 1/4 miles S 55 E from County site, and known as survey No. 39 in block No. _____ BEGINNING AT the upper or N E

corner of the Street & Smith League a stake on the W bank of the Navasota River from which a Burr Oak is in in dia br 230 W 10 W and a Hackberry 18 in in dia br N 16 E - 8 W. Thence W 108 and corner on the W bank of a slough or lake - Thence N 5th to mid channel of the Navasota River a Burr Oak br 214 W 8 W. Thence down mid channel of said River with its meanders as follows: 1st S 71 E - 210 W 2nd S 10 E 85 W 3rd S 60 W 170 W 4th S 34 E 230 W 5th S 38 E 230 W 6th S 53 W 180 W 7th S 17 E 440 W 8th S 72 E 200 W 9th S 21 W 100 W 10th S 41 W 240 W 11th S 78 E 225 W 12th S 14 W 440 W to the place of beginning.

Bearings marked H
 Surveyed June 25th 1901
 R. Jones
 John Henderson } Chain Carriers

I, Dick Jones, Surveyor of Bryan Co Texas, do hereby certify that the foregoing survey was made by me on the ground, and according to law; that the limits, boundaries and corners, with the marks, natural and artificial, are truly described in the foregoing Plat and Field Notes, just as I found them on the ground; and that they are recorded in my office in Book 1, Page 395

This 22nd day of June 1901

Dick Jones
 Surveyor of Bryan Texas.

I, Dick Jones, Deputy Surveyor of Bryan Texas, do hereby certify that the foregoing survey was made by me on the ground, and according to law; that the limits, boundaries and corners, with the marks, natural and artificial, are truly described in the foregoing Plat and Field Notes, just as I found them on the ground.

This 20th day of June 1901

Dick Jones
 Deputy Surveyor of Bryan Texas.

674 531
1061-7-25-1901

FIELD NOTES.

Survey No. 39

Brewer County.

Made for Jeff. P. Mitchell

I, Lick Jones
Surveyor of

Brewer Co. Tex

do solemnly swear that the land included within the limits of the within field notes is properly and correctly classified as follows, viz:

Stiff Swamp Soil.
(Soil Character.)

No Agricultural.
(Dry or Watered.)

Poor Grazing.
(Dry or Watered.)

Walnut Pine Timber.
(Dry or Watered, and Kind of Timber.)

And that said land is reasonably worth \$ 40 cents per acre, and that the timber on said land is reasonably worth \$ 10 cents per acre.

Lick Jones Surveyor.

Sworn to and subscribed before me this the 22 day of June 1901

J. H. Miller
Notary Public

Approved and filed _____

_____ 190

Commissioner.

I, _____, Surveyor of _____, Texas, do hereby certify that I have examined the foregoing Plat and Field Notes and find them correct and that they were made on the ground as stated in the above certificate, and that they are recorded in my office in Book _____, Page _____, This _____ day of _____, 190_____.

Surveyor of _____ Texas.

Handwritten notes:
Dance De
Correct field notes
See letter by
Espalavaca
8/24/24/1901
Correct on map
of Brewer Co.
Notary Aug. 22/901
Dance De

File Clerk,
Charles Rogan
Com'r
Filed 6/24/1901
Jeff. P. Mitchell
Surveyor
Brewer County,
File No. 2171

James Gray
1/3 League

Brooks Co. Texas

from 3225 - 5225
39 ac
Lunas

Verona River

James Gray
to B.B. Smith
137 - Acres
April 11th 1860.

to W.L. Kincannon
169 - Acres
April 11th 1860
1275 - acres

300 - m
770 m

2 1/2
29 1/2

4 25 5151

Yours truly
Jeff. B. Coe

Wm Bryan Esq Aug 23rd 1901

Dear George

Your favor of 22nd to hand. also notice of application
sent on - per your order - by Chas R. Coe?

Enclosed find Plot - showing 27 1/2 acres - Cut
off of the 80 - acres, applied for - reducing the ac
of acres to 52 1/2 -

The 169 - acres, as shown by the Plot, was sold
to Mr. Kincannon, Apr 11th 1860 - by James Gray,
lines & corners marked - on the ground -

After the survey James returned from
making the survey, he informed me, that he
crossed a fence on the North ^{of the} line, ^{169 - acre} running
East - to the Boovata River, this fence with
the River acting as a fence, would Enclose the
27 1/2 acres cut off -

This taken in connection with the fact that
the present owner or the original purchaser, having
bought this land - gives them the preference
over any one else -

These are my reasons for changing my application
from 80 - to 52 1/2 acres. Please explain to Mr. Rogan
and have the corrected field notes adopted - calling for
52 1/2 - acres. Please write me if the explanation is satisfactory

For your
minutes
Wm Bryan

File SF 2171 3
Briggs County,
School Land,

Jeff P. Mitchell
Letter of Explanation

Filed 8/24/1901.

Charles Rogan,
Clerk

J. Oglesby,
Clerk

Please file this
letter of explanation
in SF. 2171.

8/24/1901
D. W. R.

Put in Book
J. B. W.
8/27/01

578171

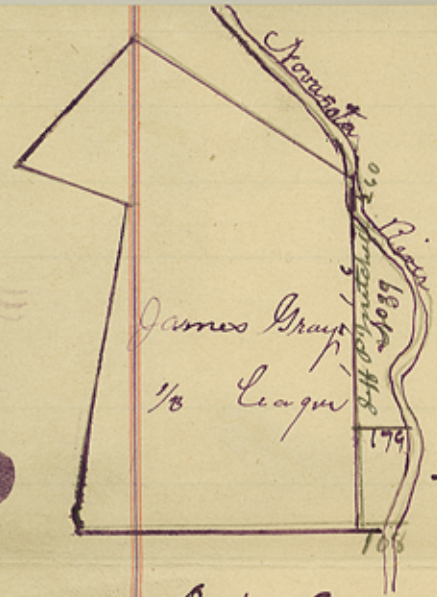

The State of Texas }
 Brazos County } Survey No 39.

Corrected field notes, of ^{52 1/2} ~~52~~ acres

of land made for Jeff P Mitchell by virtue of his affidavit and application made before A. L. Bunch

Dep. Co. Clerk, of Brazos Co. on the 12th day of June 1901, and filed with the Surveyor of Brazos Co on the 12 day of June 1901 under act of the first called session of the twenty sixth legislature approved February 28 1900 providing for the sale of unswayed land. Said land is situated in Brazos Co. Texas, about 14 miles S. by E. from the County Site known as Survey No 39 - Beginning at the upper, or N. E. corner of the Sturritt P. Smith League on the west bank of the Navasota River. Thence run up said River, with its meanders, 1st N 16 E - 440 - rods - 2nd N 77 W - ~~421~~ 421 rods and set a Stk in mid channel of said Navasota River, for the beginning corner of this Survey (No 39) from said cor a Black Gum 16 in in diam, br S 19 E - 8 rods, and an over Cup Oak 14 in in diam - br S 19 E - 2 1/2 - rods. Thence run West - 179 - rods and cor Stk on East line of James Gray Survey of 1/2 league - Thence run North with said East line of James Gray Survey 1716 - rods to mid channel of the Navasota River and cor a Burr Oak br S 19 W - 8 - rods Thence down mid channel of the Navasota

With its meanders as follows 1st
S 71 E - 210 - rods, 2nd S 10 E - 86 - rods, 3rd S 60 N - 170
rods - 4th S 3 3/4 E - 230 - rods, 5th S 38 E - 230 - rods - 6th
S 83 E - 180 - rods - 7th S 17 E - 470 - rods - 8th S 52 E - 200
rods - 9th S 21 N - 100 - rods - 10th S 45 N - 240 - rods
11th S 7 E - 204 - rods. to the beginning corner of
this survey, No 39 - and containing fifty
two & one half acres of land,
~~being~~ cutting off (27 1/2) acres off of
the ^{South end of the} 80 - acre survey 22nd June 1901 field
notes recorded in Surveys Records - Vol 1 - page
395 -

State of Texas
County of Bryan } I Dick Jones County
Surveyor of Bryan Co. Texas do hereby
certify that the above is a true and correct
copy of the corrected field notes of 80 acres
of land in Bryan Co. Texas surveyed
for Jeff P. Mitchell. Surveyed June 21 1901.
Said corrected field notes are recorded in
Book 1. page 396 surveys record of
Bryan Co Texas

Witness my hand this 1st day of July 1901
Dick Jones
Co. Surveyor Bryan Co. Texas

2 1/2

File No. ⁵¹ 2171

Brazos County,
School Land

Jeff P. Mitchell
Cor. Field Notes

Filed 7. 2. 1901

CHARLES ROGAN,
Com'r.

Rd Ragdale
File Clerk.

Corrected field dates
correct for 52 1/2 acres
on west of Brazos Co.
Aug. 24/1901.
J. van Rosenberg

Approved and filed
Aug 24, 1901.

Charles Rogan
Commissioner

7-29-1901

J. H. P. M. J.

Patented 9/10/01. Wickes

Application and Affidavit to Purchase Detached and Isolated Lands

UNDER ACT APPROVED FEBRUARY 23, 1900.

To the Commissioner of the General Land Office, Austin, Texas:

I hereby apply to purchase under Chapter XI, page 29, Act of the First Called Session of the Twenty-Sixth Legislature, approved February 23, 1900, the following described land, situated in

Brazos County, Texas, about 14 miles S 5 5/8 E
from the county site, known as survey number 39 and surveyed for Jeff. P. Mitchell
on the 22nd day of June 1901, and more particularly described as follows:

BEGINNING at the upper or N.E. corner of the Sturatt D. Smith League, on the N. bank of the Navasota River. Thence run up said River with its meanders 1st N 16 E. 440-000, 2nd N 7 W. 421-000, and set a stake in said channel of said Navasota River for the Beginning corner of this Survey 39- from said corner a Black Gum 16 in in diam by N 19 E-8-000 and an Over Cup Oak 14 in in diam by S 19 E-24-000. Thence run West 179-000 and corner a Stk on E. line of James Gray Survey of 1/2 league. Thence run N. with said E. line of James Gray Survey 1714- to mid channel of the Navasota River and corner, a Bum Oak, by S 19 W-8-000- Thence down mid channel of the Navasota with its meanders as follows: 1st S 7 1/2 E-210-000, 2nd S 10 E-86-000, 3rd S 60 W-170-000, 4th S 3 3/4 E-230-000, 5th S 33 E-230-000, 6th S 83 E-150-000, 7th S 17 E-470-000, 8th S 52 E-200-000, 9th S 21 W-100-000, 10th S 45 W-240-000, 11th S 7 E-204-000

to the place of beginning, containing 52 1/2 acres; said land being classified as Grazing and appraised at one Dollar per acre, which I agree to pay in cash, at the State Treasury in Austin, Texas.

For the purpose of complying with the law regulating the sale of said land, I hereby make and subscribe to the following oath, to-wit:

I Jeff. P. Mitchell do solemnly swear that I have this day forwarded to the State Treasurer at Austin, Texas, the sum of \$ 52 1/2 in full payment for said land; that I am buying the same for my own use, and that I am not acting in collusion with or attempting to acquire said land for any other person, and that I am twenty-one years of age and not a married woman.

(Signed) Jeff. P. Mitchell Applicant.

Subscribed and sworn to before me, this 26 day of August 1901

G. W. McMichael
b b b B b

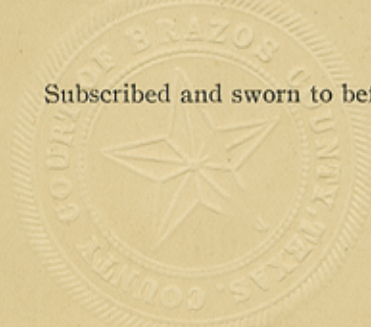

Letter No.

23147

Date of Note

8-27-01

P. O.

Bryan

Acres

52 1/2

@ \$

100 per acre.

TREASURER'S OFFICE,

No. 26301

AUSTIN, TEXAS.

Aug 30

1901

Received of

Jeff. P. Mitchell Self

on account of

the sum of

\$ Fifty two & 50/100

DOLLARS,

the same being first payment and accrued interest on former account forfeited, on

Jeff. P. Mitchell
 J. P. Brazos

Section ¹⁹ Block No. Certificate No. Grantee
 PUBLIC FREE SCHOOL LANDS, situated
 in _____ County, sold under an Act approved April 16, 1895, and Act
 amendatory thereto passed May 7, 1897, and Act approved February 23, 1900.

\$

\$

\$

Interest.

Principal.

Total.

\$ 37
 52 50/100
 2 2

John M. Collins
 Treasurer.

File ST 2171 4
Brasos County.

School Term,
Jeff P. Mitchell
Treas. Rept

Filed 8/31/1901,
Charles Rogan
Clerk

J. O. Oglesby
Clerk

TREASURER'S OFFICE

36301

Receipt of

ORIGINAL

Handwritten signature

Handwritten notes:
Date of year 8-31-01
Brasos

Handwritten notes:
1891

Large handwritten signature across the bottom of the page.

General Land Office,

State of Texas, Austin,

8/22/01

Mr Jeff P Mitchell,

Bryan, Texas.

Your application for a survey of a tract of land in BRAZOS
(Sur No 39, 80 acres)
county, filed with the surveyor of said county on the 12th day of
June 1900, together with the field notes as made by him
have been examined and approved.

The land has been classified as Grazing and valued at \$ 1.00
per acre, and being isolated and detached, must be sold as such. (See Sec-
tion 5 of the Act approved February 23, 1900).

Enclosed herewith is a blank on which you will make your application
to purchase the same. To avoid delays, mistakes and correspondence you are
urged to fill every blank space. Under the law, you will have sixty days
from this date within which you are required to file your application in
this office. At the time you forward your application here you must at the
same time remit to the State Treasurer, Hon. John W. Robbins, Austin, Texas,
the sum of \$ 80.00 and also a patent fee of \$ 5.00 to this office.
Both of these remittances should be made by draft or post office money order.

In writing about this matter, please refer to File No. 2171 BRAZOS CO

Yours respectfully,

Charles Rogan

File 2171 Brazos Co

Commissioner.

Mae Inerney

Copy to

Hon. Jno. W. Robbins,

This is for your information

General Land Office,

State of Texas. Austin, 8/24/01

REFERRING TO MY NOTICE OF THE 22ND INST. PLEASE SUBSTITUTE THIS IN LIEU THEREOF

Mr. Jeff P Mitchell,

Bryan, Texas.

Your application for a survey of a tract of land in BRAZOS
(Sur No 39, ~~2~~ 32 $\frac{1}{2}$ acres)
county, filed with the surveyor of said county on the 12th day of
JUNE 1900, together with the field notes as made by him
have been examined and approved.

The land has been classified as Grazing and valued at \$ 1.00
per acre, and being isolated and detached, must be sold as such. (See Sec-
tion 5 of the Act approved February 23, 1900).

Enclosed herewith is a blank on which you will make your application
to purchase the same. To avoid delays, mistakes and correspondence you are
urged to fill every blank space. Under the law, you will have sixty days
from this date within which you are required to file your application in
this office. At the time you forward your application here you must at the
same time remit to the State Treasurer, Hon. John W. Robbins, Austin, Texas,
the sum of \$ 52.50 and also a patent fee of \$ 5.00 to this office.
Both of these remittances should be made by draft or post office money order.

In writing about this matter, please refer to File No. 2171 BRAZOS CO

Yours respectfully,

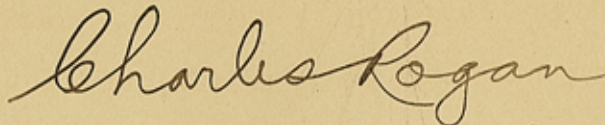

Commissioner.

File 2171 Brazos Co

Mac Inerney

Copy to Hon. Jno. W. Robbins,

This is for your information

(b) SF-2171

2457

2171

Bryan Tex July 14 1901

Hon. Charles Rogan
Austin Tex

Dear Sir

Your favor of 29th
to hand. Enclosed find corrected
field notes, of the 80 - acres of State
Land applied for by me

I will be pleased to hear from
you, as soon as you pass on
this application

Respectfully
Jeff. P. Mitchell

② SF 2171

Y 401

lee

10/10/10

10/10/10

10/10/10

10/10/10

10/10/10

10/10/10

10/10/10

10/10/10

10/10/10

10/10/10

10/10/10

10/10/10

Y 401

lee

10/10/10

10/10/10

10/10/10

10/10/10

1027

Bryon Texas
June 22nd 1901.

Mr Charles Reagan,
Austin Texas.

Dear Sir: Enclosed you will find application
of Jeff P. Mitchell for a survey of 80 acres of
detached public land. also Greene's notes for
your inspection.

Yours Very truly
Dick Jones
Co. Surveyor Bryan Co.

⑧ SF 2171