

Ark. Natural Gas Corp 10-16-30

Patent. The other survey
to the original grantee.

Elgin.

no 864 vol 5

Contents

- 1 Certificate
- 2 Field Notes
- 3 Return "

Feb 10/79

Patented Nov. 10th

1852

W. R. Symons

no 5 Cherokee
50
156 File 183

Maugoches Bounty
No. 616 & 617

Geo. R. Mercer

Survey 3 140 Aug - cash
no 658

One survey correct on map.
Feb. 17/79. Craybair

One survey correct on map
of Cherokee County. Sept. 8/51
8 mhd. ptd. Craybair

Court of Platting
original
Crosby

One Survey patented
Oct. 8/54
no 709 vol 5

The other survey correct on map in
Cherokee County. Nov. 9/52. Craybair
8 mhd. ptd

One set of field notes filed?
to Survey Maugoches Co for Cor.
section 26 Sept. 1848. Ret. Nov. 9, 1862
Over
Mgt 4453. 2 mhd. ptd. in Ar

No. 10

ACRES. 10

REPUBLIC OF TEXAS.



KNOW ALL MEN TO WHOM THESE PRESENTS SHALL COME:

THAT George W. Mercer having served faithfully and honorably for the term of Eleven months from the twentieth day of February 1836 until the thirtieth day of January 1837 and being honorably discharged from the Army of Texas is entitled to twelve Acres Bounty Land, for which this is his Certificate.

And the said George W. Mercer is entitled to hold said land and donate the same, and exercise all rights

This Certificate will be transferable by Endorsement, with a Deed, before any competent authority, with witnesses to the same.

In Testimony Whereof, I have hereunto set my hand,

at Houston this day of December 1837

Raymaster
Secy

REPUBLIC OF TEXAS.

LAND OFFICE.

I Thos. J. Flays a Deputy surveyor for Nacogdoches County do hereby solemnly swear that on the 6th day of December A.D. 1843 I surveyed in the said County six hundred and forty acres of land and on the 4th day of February A.D. 1846 I surveyed as above six hundred and forty acres now all upon the within claim Witness my hand this 23rd day of March A.D. 1848



Thos. J. Flays
Supt. Surveyor Tex. Cty.

KNOW ALL MEN TO WHOM THESE PRESENTS SHALL COME:

THAT

1881
Nacogdoches County
Wardman
Wm. W. W. W.
1280

13.5.1
1280
S. N. W.

In Testimony Whereof I have hereunto set my hand
this day of March 1848

[Faint, illegible handwritten text]

Republic of Texas } Survey of Six hundred and forty acres of
 Nacogdoches County } land made by virtue of Certificate No.
 658 Issued by Barnard E. Bee Sec. War to George R. Mercer
 for twelve hundred and eighty acres of land and dated
 Houston December 1st. 1837.

Situated ^{in Cherokee Co.} on the waters of the river Angelina ^{about 8 miles N³⁰W. from} ~~South of and~~
~~adjoining the residence of Wm. Isaacks.~~ Beginning at the
 S.W. corner of a survey of $\frac{1}{2}$ League for B. C. Walter, a Post
 from which a Blk. Jack 6 in. dia. bears S. 27° W. 2 ms. dis.
 a Post Oak 20 in. dia. bears S. 70° E. 11 ms. dist. Thence East with
 the S. B. of said $\frac{1}{2}$ League 1494 ms. to N.W. corner of $\frac{1}{2}$ Sect. for
 Whitaker a Post from which a Blk. Jack 9 in. dia. bears S.
 52° W. $2^{\frac{1}{2}}$ ms. dis. R. O. 16 in. dia. bears N. 24° E. 6 $\frac{7}{10}$ ms. dis. Thence
 South with said Whitaker, W. B. 430 ms. Br. Co. N. E. 1344 ms. to S.
 W. corner of same 1690 ms. Cr. 2 ms. wide Co. N. E. 1800 ms. a
 Post ^{for S. E. cor. of this Survey} from which a Pine 42 in. dia. bears N. 65° W. $11^{\frac{1}{4}}$ ms. dis
 Red Oak 18 in. dia. bears N. 17° W. $15^{\frac{1}{2}}$ ms. dist. Thence West 16
 ms. Cr. Co. N. E. 2343 ms. a Post ^{for the S. W. cor.} from which a Post Oak 8 in.
 dia. bears N. 62° W. $4^{\frac{1}{2}}$ ms. dist. Blk. Jack 10 in. dia. bears N.
 70° E. 18 ms. dis. Thence North 482 ms. Br. Co. East 720 ms. Br.
 Co. S. E. 1050 ms. to S. B. of No. 227 Post from which a Blk. Jack
 10 in. dia. bears S. 14° E. $5^{\frac{1}{2}}$ ms. dis. Blk. Jack 7 in. dia. bears N.
 29° W. 5 ms. dist. Thence East with said S. 880 ms. to S. E. corner
 of said No. 227 a Post from which a Post Oak 18 in. dia. bears
 N. 67° E. $3^{\frac{1}{2}}$ ms. dis. Blk. Jack 16 in. dia. bears N. 60° W. $15^{\frac{1}{2}}$ ms. dis.
 Thence North with E. B. of said No. 227 805 ms. to the Beginning
 D. M. Isaacks, Chain Line } Surveyed 4th day February 1840 }
 Wm. Prof } } Dept. Surv. Nac. Cty.

Variation $9^{\circ} 10' E.$

Scale 4000 yds to an Inch

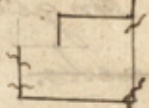

I, Thos. J. Hays a deputy Surveyor for Nacogdoches County do hereby solemnly swear under my official Oath that the survey designated by the foregoing Plat and field-notes was made by me on the 4th day of February A. D. 1846 and the lines boundaries and corners of the same together with the marks natural and artificial are truly described therein Witness my hand this 23rd day of March A. D. 1846

Thos. J. Hays
Dept. Surveyor Nac. Cty

I, Wm Nelson County Surveyor for Nacogdoches County do hereby ^{certify} that I have examined the foregoing plat and field notes and find them correct and the survey made according to Law, and that the said field notes are recorded in Book C page 410 & 411

Given under my hand this 27th day of March A. D. 1846

Wm Nelson County Surveyor Nacogdoches County

NACOG. B-172

No. 228
640 acres
G. B. Mercer

Filed in office
March 27 1846
O. A. Quinn
Clerk
Recorded

Campbell
Fees 1.00 paid
by S. R. Smith

28

Christie Feb 182

50
Munroochus Buntley

Field Notes 1840

Geo. R. Muer

Correct on map. Feb. 17
1849
Creurbaler

Pat Oct. 8/57

J. M. Beard

The State of Texas

Cherokee County

A Survey of 640 acres
of Land made for S. R.
Emmitte on the 26th day of
Nov., 1851 Correcting a
Survey of 640 acres made

By Tho^s, J. Days on the 6th day December 1845

By virtue of Certificate No 658 issued by Barr
and E. Bee Secretary of War to George R. Mercer

Murcer for 1280 acres of Land dated at Houston

Dec., 1st 1837 Situated ^{in Cherokee County} on the Waters of the

River Hickore about 17 or 18 miles ⁵⁵ N. of the

Town of Rush and Beginning at the S. W.

Cor of Survey No 193 a Stake from which a

Blfack 10th in dia Bears $422^{\circ} N 54^{\circ} W$ dis a Blfack ^{675th}

16th in dia Bears $850^{\circ} E 12^{\circ} W$ dis thence South to the

S. E. Cor of 102 a Stake from which a Post oak

14th in dia Bears $572^{\circ} E 4^{\circ} W$ dis a Post oak 12th in

dia Bears $47^{\circ} E 28^{\circ} W$ dis thence West 760 m to the

S. E. Cor of No 93 a Stake from which a Pine 24th in

in dia Bears $579^{\circ} E 7^{\circ} W$ dis a Pine 28th in dia

Bears $439^{\circ} N 10^{\circ} W$ dis thence North with the E. B.

Line of No 83. 1860 m to a Stake from which a

Blfack 16th in dia Bears $457^{\circ} N 5^{\circ} W$ dis a Hickory 5th in

in dia Bears $425^{\circ} E 6^{\circ} W$ dis thence East 778 m to the

S. E. Cor of No 84 a Stake from which a Blfack 12th in

in dia Bears $427^{\circ} E 15^{\circ} W$ dis a Blfack 16th in dia Bears

$572^{\circ} N 7^{\circ} W$ dis thence North 860 m to the S. W. Cor

of No 85 a Stake from which a Hickory 9th in dia

Bears $559^{\circ} E 8^{\circ} W$ dis a Blfack 16th in dia Bears South

$74^{\circ} W$ dis thence East with the S. B. Line of No 85. 780 m

to the N. B. Line of No 90 a Stake from which to

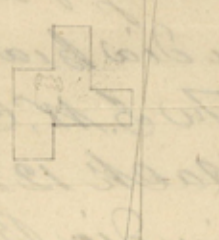

Scale 1/40000

a Hickory 8 m in dia bears S 51° W 3 m dis a Hickory
15 m in dia bears N 47° W 5 m dis thence South ¹³¹⁰ 1310
to the S. W. Cor of No 70 a State from which
a Black 12 m in dia bears N 85° W 5 m dis a Black
10 m in dia bears South 18 m dis thence ^{East} with S. B.
Line of No 70. 822 m a State from which a
Sand oak 8 m in dia bears S 8° W 4 m dis a Sand
oak 8 m in dia bears N 52° W 8 m dis thence South
725 m to the N. W. Line of No 193 a State from
which a Hickory 6 m in dia bears N 72° W 1 m
dis a Hickory 8 m in dia bears S 67° E 2 m dis thence
West 160 m to the Beginning containing 640
acres More or Less

P. C. Bagdel
J. M. Cope J. C. C.

A. J. Coupland
County Surveyor
of Cherokee County

I A. J. Coupland County Surveyor of Cherokee
County do Certify that the Survey described
in the foregoing plat and field notes was
made by me on the 26th Day of November
A. D. 1851 and the same was made according
to Law and the Corners Lines Marks Natur-
al and artificial are therein truly described
and the same are Recorded in Book
A Page 515 & 16 Given under my hand
at Rush this 27th Day of October A. D. 1851
A. J. Coupland
County Surveyor
of Cherokee County

72

No. 200

Survey of
64 Acres

S. B. Smith

Recorded in Book
A Pages 5154 16

Oct 27th 1852
A. J. Coupland
CSCC

Surveying 640 acres
10190m. 8 16.00
Recording 8 17.00

3 Feb 1852

Acergroches Beauty
Fieldnotes. - 640 Acres.

George R. Mercer

Correct on map in Chero-
-kee County. Nov 9/52
Greenbank

Patented Nov. 10th
1852 Raymond