

L. S. Madison 75 large survey
S. S. Grimes small survey

File 4945

Montgomery 1st dep.

N. Ab. 44 1/2 - abt 470
no 2981

Luke Bryan, Jr.
3082

See map p. 1722 for Bl.

Downys } 7,225,984 sq. v.
1,224,584 " "

For original location of 87 farms
see file 1-210 Liberty.
Suspect 1,330 Liberty for Kibjiale

Large Survey on one in the
Name of H. Royal 240
(otherwise) both surveys comes
Outmap of Grimes of Madison
County April 1876

Small
92 mhd ptd 8/11/61
Capt the small survey
to Nancy Randolph
Patd May 1/61

A. S. Heaton

Pat det. C. H. Randolph Sept
16th 1861. O.W.

mkd on Regr
Mar 13. 90 gis
1 MP in Reg
c April 12
c JNH 61

The large sur.
Nancy Ran-
dolph - afa - m ch

Patented Nov 13th 1868

Cyell

8 and 3 99 Vol 16

1 May 1861

8 587 Vol 17

13 Nov 1868

3 3 3 3

1. Cont. of U.S. Pat.

Vol 3. Field notes.

Nov. 29/78.

Book.

M. 27 Oct
31 12.

GENERAL LAND OFFICE,

Austin, August 12 1853

This is to Certify, That Richard Bryan is entitled to have surveyed, by any legally authorized surveyor, upon any of the vacant and unappropriated public domain of the State of Texas, Seven hundred Million
One Hundred and Fifty Thousand
17,150,000 square Acres of land,
 it being the Unlocated Balance of the right Certificate
No. 12 Class issued by the Board of Land Commissioners
Millions of Acres to the said Richard Bryan
 for One League and One Labor of land, dated the
first day of February 1838

In Testimony Whereof, I hereunto set my
 hand, and affix the Seal of said Office, the day and
 date first above written.

[Signature]
 Commissioner

17,150,000
 8,455,588
 8,694,432

[Signature]
 H. Jackson

[Vertical handwritten notes]
 1853
 3. 10. 11
 1853

The State of Texas }
County of Galveston } Town

For value Received of Harry Randolph
I Luke Bryan Jun have sold and assigned and
I do hereby bargain sell and assign the
within Land Certificate issued to said Luke Bryan
Jun. from the General Land Office dated August
15th 1853 to the said Harry Randolph
To Have and to Hold the said Certificate with
all and singular the rights and appurtenances
thereunto belonging to him the said Randolph
his heirs & assigns forever
Witness my hand & Seal using
Scroll for Seal this the 21st day of
January A.D. 1854

Luke Bryan Jun.

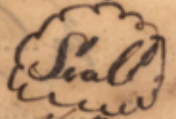

The State of Texas }
County of Galveston } Before me John L Darragh a Notary
and on this day personally appeared, Luke Bryan
to me personally known who acknowledged the foregoing
deed or instrument of writing to be his act and deed
for the purposes and considerations therein
expressed

To Certify which I hereunto
subscribe my name and affix
my seal this the 21st day of
January A.D. 1854 at the
City of Galveston
John L Darragh
Notary Public



State of Texas

County of Walker  The undersigned Clerk of the County Court
in and for the County and State aforesaid do hereby certify that the
foregoing and attached Certificate of Transfer was Filed March
5th 8 A M 1855 and Recorded March 7th 5 P M 1855 in Book
D. pages (122 & 123) of Walker County Records

In Testimony whereof I have hereunto set my
hand and Seal of office at office in Huntsville
this the 7th day of March A D 1855

John M Davidson

Clerk to the Court



March 5 1855
March 7 1855
John M Davidson

March 7 1855

1. File 494
Montgomery 1st

cert. for un. bal
17. 150, 000, 000.

Luke Bryan Jr.

B3 Transfer 17, 150, 000, 000.

Harvey Randolph

File 494

John W. Anderson

John W. Anderson
March 5 8 AM 1955

auth



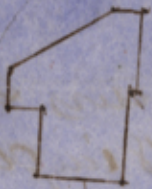

The State of Texas,
District of Montgomery

Field Notes of a survey of, 7,225,984
Square varas of land, situate in Madison County,
^{about 11 miles S. 33° E. from the town of Madison}
on Garrison's Creek, a tributary of the Trinity
River, made for Luke Bryan, junr (Harvey Rauloff's
assignee) being a part of the remainder of the
quantity of land to which he is entitled by
virtue of certificate No. $\frac{2981}{5092}$, unlocated balance,
(full amt 17,150,000, Sq. varas.)

Beginning ~~at~~ 220 varas N. 55° E from the S. E.
corner of Thomas Lamb's survey, at a post, from
which a post oak, 18 in dia., bears N. 33° E. 8 varas,
distant, and a post oak, 18 in dia., bears N. 51° W.
20 varas distant

Thence South 55° W

220 varas - Intersected Lamb's survey at its S. E.
corner & following his S. E. line (crossing Garrison's
Creek at 430 varas

2820 varas To S. W. corner of Thomas Lamb's sur-
vey, a post from which a post oak, 14 in dia.
bears S. 33° W. $11\frac{1}{10}$ var. dist., and a post oak, 12 in
dia., bears S. 35° E. 10 var. dist

Thence South

964 varas to a post from which a pine 18 in dia.
bears N. 16° E. $14\frac{1}{10}$ var. dist., and a black jack
14 in dia., bears N. 86° E. $17\frac{5}{10}$ var. dist

Thence East

658 varas to a post from which a post oak, 18 in dia.
bears N. 18° W. $8\frac{2}{10}$ var. dist., and a post oak
12 in dia. bears N. 72° W. $5\frac{4}{10}$ var. dist

Thence South

1219 varas - to a post from which a post oak, 10 in
dia. bears N. 2° E. $3\frac{1}{10}$ var. dist. and a post oak

10 in. dia. bears S. 40° W. 5 $\frac{1}{2}$ varas dist

Thence East with N. line of Jas. Amers. Survey
1900 varas to a post from which a post oak, 18 in. dia.

bears N. 65° W. 21 varas distant, and a post
oak, 18 in. dia. bears N. 28° W 96 $\frac{1}{2}$ varas dist

Thence North with lines of barbers & Blackburns
1900 varas to a post from which a pin oak 30 in. dia
bears N. 68° W 9 $\frac{1}{2}$ varas. dist, and a birch, 12 in.
dia. bears S 55° E. 6 $\frac{1}{2}$ varas distant

Thence East

100 varas to a post from which a black oak
30 in. dia., bears N. 44° E. 58 $\frac{3}{4}$ varas. dist
and a post oak 12 in. dia. bears N
15° E. 46 $\frac{1}{2}$ varas. dist.

Thence North

1900 varas to a post from which a post oak
30 in. dia. bears N. 79° W 46 $\frac{1}{2}$ varas. dist
and a post oak, 12 in. dia. bears S 72° W.
64 varas distant

Thence West with Nancy Rhoads Ry
(in the assignm of James Duncan.)
344 varas to the beginning.

Surveyed July 21. 1858

J. D. H. Richardson, Chm.
Cramer. Ford 3 Curran

District Surveyors Office,
Montgomery, July 29, 1858.

Being satisfied of the correctness of the work
and in obedience to instructions received
from the Comr Gen. Land Office, I return
these field notes. The land included was
once surveyed by virtue of conditional certifi-
cate No. 49, issued to Henry Rogee, by the Col.
G. Robertson County.

John W. Wade,
Dist. Surveyor
Land Dist. Montgomery

Recorded in Book 50, folio 110-112, of first class
records--

John W. Wade,

Dist. Surveyor

Lana Dist. Montana

Madison Co. 189.

2 Feb 4 94
Montgomery Miss.

Field notes 7, 205, 984
Luke Bryan Jr.

Filed 6th Aug 94

By Surveys with Name of A.
Hoyall 2. 40. 5th Dec 1861
On map of Madison County
April 15/61
August 27/62. H. B. Brown

7, 225, 984, 209. 2000
names of B. H. H. H. H.
names of B. H. H. H. H.

John Bryan, Junr
St. Randolph, Ark.

Madison County
Land Dist. 1000

Pl. Black

April 12
J. H. N.



Scale 400000. to an inch
Variation $9\frac{1}{2}$ East

The State of Texas. Survey
District of Montgomery. No. —

Field Notes of a Survey of 1 labor 229,580

sq. varas (or 218 acres) of land, made for Luke Bryan, jun. (H. Randolph assignee) it being a part of the quantity of land to which he is entitled by virtue of Unlocated Balance certificate No. $\frac{2981}{3082}$, issued by the Commissioner of the Gen. Land Office to Luke Bryan jun for 17,150,000 sq. varas. Said Survey is in Trinity County, situated on the head waters of South Bend a tributary of Trinity about $18\frac{1}{2}$ miles $N 17^{\circ} E$ of the town of Anderson. Beginning at the S. W. Corner of Evan Corvins league and labor survey, at a stake from which a post oak 14 in. dia. bears $N. 15^{\circ} W. 1$ var. dist. and a post oak 14 in. dia. bears $S 46^{\circ} E. 10$ varas dist.

Thence South $80^{\circ} E.$ with E. Corner survey 1380 varas to N. W. Corner of Job A. Collards survey, a post from which a post oak 6 in. dia. bears $S 40^{\circ} W. 7$ var. dist. and a black jack 8 in. dia. bears $N 72^{\circ} E. 16\frac{1}{2}$ var. dist.

Thence $S. 10^{\circ} W.$ with Collards survey 891 varas to the N. E. Corner of Philip Dixon's survey, a stake on West line of Collards survey for corner

Thence North $80^{\circ} W.$ with N. line of Dixon's survey 1380 varas to the S. E. Corner of Stokely's survey, a stake from which a black jack 6 in. dia. bears $N. 19^{\circ} W. 27$ var. dist and a black jack 4 in. dia. bears $S 46^{\circ} E. 3$ var. dist.

Thence North $10^{\circ} E.$ with Stokely's survey 891 varas to the beginning. This survey is all pasture land.

Surveyed July 20th, 1858.

Jacob Kappelman } Chain Carriers
Thos. Cornubert }

I, John M. Wade, District Surveyor Land District of Montgomery do hereby certify that the foregoing survey was made according to law, and that the limits, boundaries and courses, are truly, with the marks natural and artificial described in the above plat & field notes, and that I have recorded the same in Book K pages 109 & 110 of 1st class records of this office

Given under my hand at Montgomery this 26th July 1858.

John M. Wade,
Dist. Surveyor, Montgomery Dist

Certify also that the above survey is bounded on all sides by lines of previous surveys, and encloses all the vacant land. John M. Wade, Dist Sur
Montgomery District

3
Feb 1194
Montgomery Stds.

Guad. in Lds 1,229,500 1/2

Luke Bryan, Jr.

Trid. C. M. Colby, Jr.

July 20, 58

Card May 1/61

P. H. H. H. H. H.

P. C. G. & L. in on the

within amounting to

twenty nine c. n. to, Spain

Harry, Standard

1971 16/6

Montgomery Land Dist

1,229,580 ag. ans

000

Frank Blake }

Luke Bryan, Jr.
(M. R. R. R. R. R. R.)

April 12
C. J. H. H. C.