

15. John's Receipts 73 Large 500. 00
4. S. Curran 2
File 317
Montgomery Co. N.Y.

59. Wash - 257 G. No 407
William W. Sanborn

18. 536.500
1000000
775.150
1000000
775.150
No 2932/2833

The Larger survey Commission
in all of the States
& mtd ptd

Survey of 18+ Subs. Pat. for patenting
over

Survey of 18 Subs. Patents
October 31 1855.
Patent delivered to Sec
Daniels 30th Dec. 1855
Smicker.

Field notes for 7+ Subs.
mtd by J. M. Anderson to
be returned by 7th 1857

Certificate of Delinquent Balance taken
out of the report of the Small survey of
the 18+ Subs. mtd ptd on 18
The 18+ Subs. mtd ptd on 18
No 5149. 3000 306

Strong, B. Feb, 1852
1. Cond't. Sect.
2. Cont. W. Balance
3. Cook's Sect.
4. Field notes
5. Con. ptd
6. Power of atty
7. Surv. Sect.
Nov. 29/78 Cook

Resurvey correct on map
February 18/57 J. S. Willne
& mtd ptd

The Resurvey Commission
Patenting
V. 381 vol 4
Patd Oct. 31, 1845
Elgin.

Patented March 9 1857
2710 vol 12
Sam. J. Pratt
W. Purkey

This is to Certify that William B. Sanders has appear-
ed before us the Board of Land Commissioners for the
County of Washington and proved according to Law
that he arrived in this Country in the Year 1833, that
he is a married man, and entitled to One One League
and One Labor of Land, upon the condition of paying
at the rate of three dollars of ⁵⁰/₁₀₀ for every Labor of
irrigable land, two dollars of ⁵⁰/₁₀₀ for every labor of arable
or temporal Land and One dollar of ²⁰/₁₀₀ for every Labor
of Pasture Land which may be contained in the Survey
deared to him by this Certificate given under our hands
this 1st day of March 1838.

Certificate
issued under
the seal of the
County of Wash
D. C.

Attest
James Hoopes
Cly.

Certified
5.688359

Stephen R. Roberts, Clerk
James Arrington Associa Com.

mont 7 - 317.

Republic of Texas
Montgomery County

and 536.500 sq. varas of Land in part of the within
certificate. 5th September 1838.

W. H. Cole
Deputy Surveyor

This certifies that I have
Surveyed Eighteen Labors

William R. Sanders
Certificate
1 League of Land

Republic of Texas
Montgomery County
September 5th 1838

I have surveyed Two Labors and 266500
sq. varas of land on the within certificate.

W. H. Cole
Deputy Surveyor

William R. Sanders

No 2732
2833

5749

S. W. American Print, Austin.

GENERAL LAND OFFICE,

Austin, February 12th 1855.

This is to Certify, That William A. Sanders is entitled to have surveyed, by any legally authorized surveyor, upon any of the vacant and unappropriated public domain of the State of Texas Seven Millions, four hundred and sixty thousand, five hundred and fifty seven square varas of land, it being the Unlocated Balance of Headright certificate No. 1000 Class 1000 issued by the District Court of Harris County to the said William A. Sanders for own labor of land, dated the 12th day of December 1841

In Testimony Whereof, I herunto set my hand, and affix the Seal of said Office, the day and date first above written.

[Signature]
Commissioner.

*Case extended to 29th of May
for this
been put in
and a new
part of this
and it is still
previously
for money
original cert
land having
about authority
175150
M. Clyn.*

J. W. Henderson for 50¢

State of Texas
Law District of Montgomery

I Joseph M. Brown District Surveyor in and for the
Law District of Montgomery State of Texas hereby
certify that I have surveyed upon the within certificate
1,775.150 Sq. rods of Land

Dec 1853

Joseph M Brown
Dist. S. L. D. Ill

2.

File 317.

Montgomery 1 Chap.

By W. L. Col. #7. 146. 5. 500

William W. Sanders.

John W. S. / 56

Republic of Texas
County of Washington
District Court Oct
Nov AD 1841

County of Washington
District Court of the District
County of said. I hereby
Certify that William S. Davidson, executor against
the Estate of J. S. [?], the above specified bonds
one dollar and one labor of land, to which
he was entitled by virtue of certificate no (373) upon
condition of paying at the rate of three dollars
and fifty cents for every labor of arable or improved
land, and one dollar, twenty cents for each labor of
Pasture land, which may be contained in the
Survey secured to him by said Certificate

Gives under my hand and seal
of Office at Office this the 27th day
of December AD 1841. and the
Independent of [?]

W. S. Davidson, Clerk
D. C. M.

Certificate
Balance
Arrows
Arrows

423.50
150
5.68
being total good
that are being paid into
ground tax day
to [?]

Approved
N. C. [?]
1841

File 317
Montgomery 1st class

W. R. Saunders

Certificate

one league & labor

Black's Creek

W. R. Saunders
Certificate

W. R. Saunders
Sept 4/5000
League and labor
Certificate

I certify that the within Certificate was
given upon the necessity of the work brought
by last storm to repair the works
granted to have done by the Board of
Land Commissioners and for the benefit
of Washington and adjacent by the Board
of Commissioners which original
Certificate is numbered 10594
Done at St. M. 1844

1st Class.

1st June 1858.

Survey for William R Hauncler's Eighteen Labor and 536.500
 of Land. Situated on the North Side of Connaugh Survey, West and
 side of James Cox survey and West side of Charles O Edwards survey,
 side of the Navasoto River. Being a part of the land to which he is entitled by
 two of Certificate No 373 issued by the board of land commissioners for the County of Wash
 ton for One League and One Labor of Land, Beginning on the North side of
 James Cox survey at the S.W. corner of Charles O Edwards survey at a Stake from which
 Hickory 12 inches diameter marked S. bears S. 28° N. 15¹/₂ varas distant, and a Post Oak 14
 inches diameter marked S. bears S. 25¹/₂° N. 7¹/₂ varas distant
 thence S. 89° N.

990 To the N.W. corner of James Cox survey at a Post from which a Swamp Oak
 17 inch diameter bears N. 84° E. 1¹/₂ varas distant, and an Elm 10 inches diam
 bears S. 35° E. 12¹/₂ varas distant.
 thence S. 31° E.

1010 To Rocky creek 9 varas wide bears N.

2060 In a Prairie

2370 In Timber

2940 In a Prairie

3110 In Timber

3620 intersected the North boundary of Connaugh survey at a Post
 from which a Post Oak 14 inches diam: bears N. 71° N. 16¹/₂ varas distant and
 a Post Oak 16 inches diam: bears N. 20¹/₂° N. 10¹/₂ varas distant.
 thence S. 69° N.

3210 To the S.W. corner of Connaugh survey

3780 To the Navasoto River at a Post from which An Ash 5 inches diameter
 bears N. 7¹/₂° E. 7¹/₂ varas distant, and a Pecan 3 inches diameter bears N.
 7¹/₂° E. 4 varas distant. thence up the East side of the
 river to the river

No. Station	Bearings.	Distance.
1	N. 31° N.	83
2	N. 38° E.	150
3	N. 67° E.	330
4	N. 13° E.	530
5	N. 64° N.	60
6	N. 15° N.	132
7	N. 12° E.	310
8	N. 39° N.	170
9	N. 89° N.	200
10	N. 21° N.	340
11	N. 53° N.	129
12	N. 38° N.	205
13	N. 20° E.	410
14	N. 38° N.	340
15	N. 89° N.	460
16	N. 18° N.	110
17	N. 63° N.	190
18	North	50
19	N. 30° E.	110
20	N. 62° E.	130

656

Wm. C. Saunders.

1st - 6th

Montgomery Co.

Does not pay

Mr. Beattie

Re: forty three copies
of the same in
the same
in the same
in the same

Drinker

October 1st 1815

Wm. C. Saunders

Wm. C. Saunders

Filed with Mr. ...

Montgomery Co. ...

File 317

404

62

No. Stations	Bearings	Distance Varas.	Sta	Bearings	Distance Varas
21	N. 49° E.	230	2	N 9 E	360
22	N. 34° E.	140	3	N 71 W	260
23	N. 10° E.	360	4	N 27 W	400
38	N. 52° E.	100	5	N 17 E	80
39	N. 33° E.	150	6	N 27 W	130
40	N. 73° E.	150	7	N 20 W	260
41	N. 9° E.	90	8	N 41 W	220
42	N. 19° W.	98	9	N 19 E	100
			10	N 43 W	220
			11	N 46 W	390
			12	N 52 E	1000
			13	N 34 W	1000
			14	S 79 W	1000
			15	N 25 W	1000
			16	N 25 E	80

The missing
meanders
Sta's 21-37,
inclusive -
taken from
Patent Notes
P.R.C.

Varas. To a Post from which an Ash 30 inches diam bears N. 18° E. 10⁴/₁₀ varas distant, and an Ash 24 inches diameter bears S. 75° E. 9⁹/₁₀ varas distant. Thence N. 89° E.

885 To a Post from which a Hickory 10 inches diameter bears N. 61¹/₂° E. 9⁹/₁₀ varas distant, and a black jack 5 inches diam: bears N. 88° W. 11⁴/₁₀ varas distant. Thence N. 21° W.

338 To a Post from which a Post Oak 24 inches diam: bears S. 34° E. 16⁵/₁₀ varas distant, and a Hickory 8 inches diameter bears S. 16° E. 17²/₁₀ varas distant. Thence N. 89° E.

3820 To Smith's creek 10 varas wide course S. Intersected the W. boundary line of Charles O. Edwards survey from which a black jack 6 inches diam. bears S. 10° W. 5²/₁₀ varas distant and a Post Oak 14 inches diameter bears S. 36¹/₂° W. 15 varas distant. Thence S. 1° E. with the W. boundary line of Charles O. Edwards survey

950 To the beginning. All the bearing trees marked S.

William H. Vansent 3 chain
Joseph L. Walker 3 Carrion

The foregoing survey contains fifteen Labors of Arabule and Two Labors and 536,500 square varas of pasture land to the best of my belief and knowledge

W. H. Case
D. Pub. G.



Variation 9° 30' E.

Scale of 4000 Varas to the inch.

b

W. H. C. M. do solemnly declare under Oath of my Office that the foregoing survey was executed according to law and made since the first day of February last, and is a true copy taken from my field book.

Page

According page 393-

1826

*Wm. R. Chandler
State of N. York*

53

State of Texas
 Walker County
 Land District of Montgomery
 Connected Survey for Wm. R. Sanders of 1775.150
 Square yards of land in Walker County, ^{about 17 miles South 53° East of Trinityville} adjoining the
 surveys of Briscoe Hollis and Miles it being a part
 of the quantity of land to which he is entitled
 by virtue of Duplicate Certificate No. ²⁷³²/₂₈₃₃ dated
 Austin February 12. 1853 issued by the Commissioner
 Gen. of the Land Office

Beginning on the North boundary line of the
 Large survey of A Briscoe attorney for Vital G. Lo
 nes. 130 ~~varas~~ ^{varas} N 65° E from the N.W. corner of said
 Survey at a white oak 18 in dia marked from
 which a post oak 8 in dia bears West 8 varas
 dist. Thence North 65° E with Briscoes

N boundary line
 2731 varas to the S.W. corner of David Hollis Survey
 of 25-3/4 acres land a stake from which a pine 10 in
 dia bears N 6° E 8 varas dist and a pine ^{line} 16
 in dia bears N 38° E 16 varas dist

Thence N 25° W with west line of Hollis Survey
 650 varas to a stake from which a red oak 14 in dia
 bears S 57° W 11 1/2 varas dist and a pine 14 in
 dia bears N 27° W varas dist

Thence S 65° W

1670 varas to a survey the S.E. corner a survey of Pratter & Bell Miles 1880
 and with the South line of said survey

2731 varas to stake on said line from which a hickory
 14 in dia marked X bears N 53° ^{East} 8 2/3 varas dist and a
 post oak 10 in dia marked S bears N 85° W 6 2/3 varas dist
 Thence S 25° East

650 varas to the beginning

J. Ellison Chain }
Wm Ellison men }

Joseph M Brown
Dist. S. L. D. Me

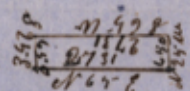
Scale of 10000 acres to a inch  variation 9° 30' East

I Joseph M Brown District Surveyor Land District of
Montgomery State of Texas solemnly declare under oath
of my office that foregoing Survey was executed according
to law and made on the 15th day of September
1853 that the limits boundaries and Courses are
truly described in the foregoing plot and field notes
and that I have recorded the same in Book **H** first
Class Head Rights on pages 247 & 248 of the records of my
office this December 17. 1853 Joseph M. Brown
Dist. S. L. D. Me

First Class

Wm. R. Sanders

1775-150 Sep 27

Feb 217 15
Montgomery A. Self.

Corrected Field notes

1 ⁷⁷⁵⁻¹⁵⁰/₁₇₇₅₋₁₅₀ Labors

W. R. Sanders.

Filed April 7. 1854.

Contents correct and correct
on map March 4/54 *Revised*

Patented March 7/54

Sam. J. South

Rec'd for Dues on
the within field notes
amounting to Eighty
Eight cents. Specie
from J. De Cordova
March 11th 1854

J. W. Moore
Receiver

Republic of Texas
County of Montgomery } Know all men by
these presents that I
William R Sanders of the County in the
Republic aforesaid have made constituted
and appointing and by these presents Do make
Constitute and irrevocably appoint Charles
B Stewart of the same County and Republic
my true lawful and irrevocable agent and
attorney in fact to apply for and receive from
the Commissioner of the General Land Office or
proper authority the patent or patents which
will or may be issued for the lands surveyed
under or upon my head right Certificate
Survey and Subm. issued to me from the District
County of Washington County upon record upon
my original head right issued in same County
and to do all and every act matter and
thing necessary in and about procuring and
obtaining the patents aforesaid for the lands
aforesaid and further to substitute and
appoint an agent or attorney or attorneys
under him with full and sufficient power
in the premises

Heavily certifying and confirming
all and singl^r the acts and doings of my
said agent or attorney in the premises, which
may be done by the agent or attorney which he
may deem proper in the premises. Witness
before these presents my hand and affixing my seal
at such place the 15th March 1844
Signed sealed and delivered
in presence of

W. R. Sanders

(15)

C. J. Biddle

The Republic of Texas
I thought I Mc Huffin Cha
Justice and Ex Officio Notary

Public in and for the County of Montgomery in the
 Republic of America do hereby certify that
 on this the 26th day of March A.D. 1874. P. J.
 Gony one of the subscribing witnesses to the
 within instrument of writing came personally
 before me in the County aforesaid and being by me
 duly sworn with upon his oath that he saw
 and the other subscribing witness C. J. Birdsell
 men present and saw William R. Sanders sign
 seal and deliver the said instrument to Charles
 V. Bellman for the purposes therein mentioned
 and contents, and thereupon he said Gony and
 the said Birdsell in the presence of each other
 and in the presence of said William R. Sanders
 set their names thereunto as witnesses of the
 execution of the same To all of which I certify
 from under my hand and private seal for
 want of a seal of office this the day & date
 above written

~~Thos. J. Gony~~ ^{Mr. J. Gony}
~~County of~~ ^{Montgomery}

Chief Justice of
 Montgomery County and
 Ex officio Notary public of
 the same



John Patterson
 Wm R. Sanders &
 Petrus Patent

Montgomery-1-317

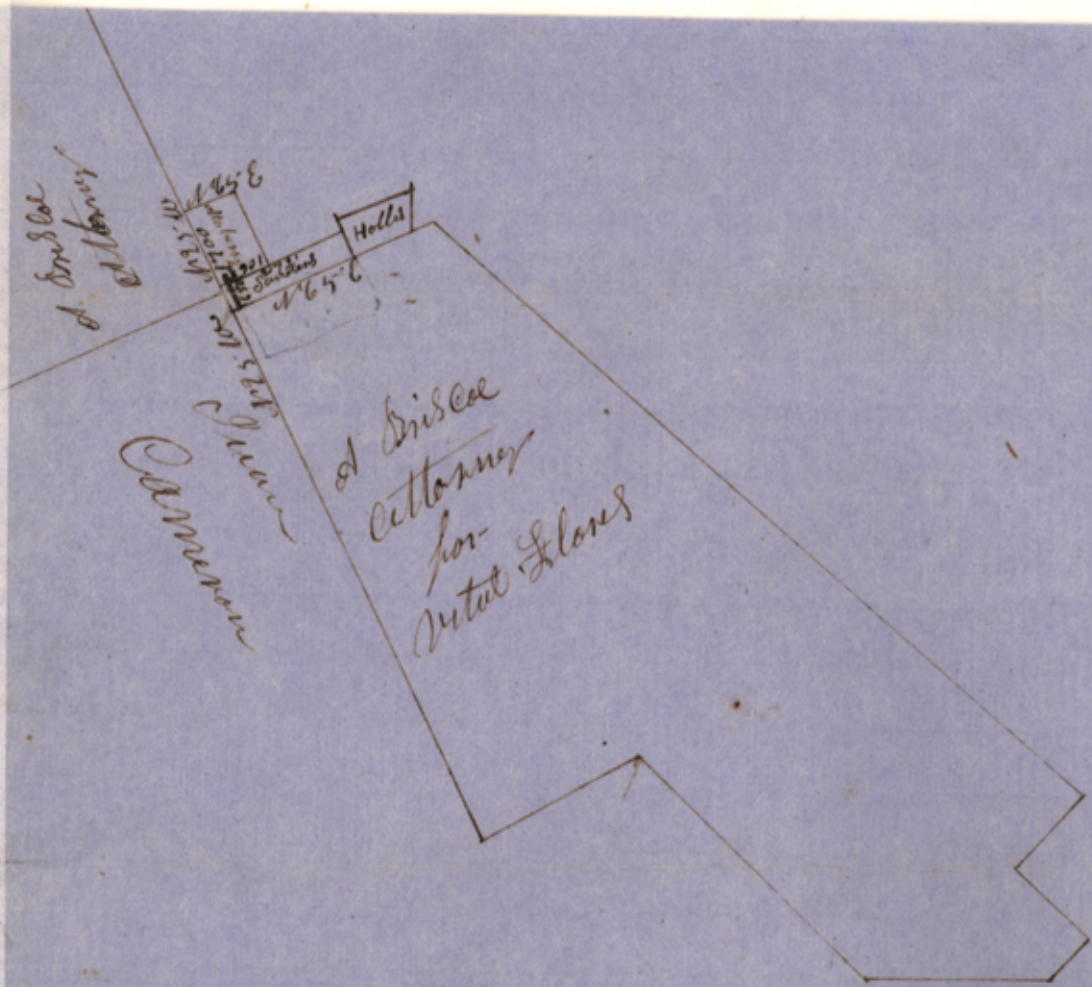

State of Texas
 Law District of Montgomery
 I Joseph M. Brown District Surveyor in and for
 the Law District of Montgomery State aforesaid hereby
 certify the foregoing Sketch of the Connection of the Sur-
 veys of d. Briscoe John J. Mabery and David Hollis ~~to be~~
 with the Corrected Survey of Mrs B. Sanders to be
 truly connected in the foregoing Sketch as they are upon
 the ground. This the 6th day of February 1854
 Joseph M. Brown
 District, Sur, Law, Dist, Mont

Montgomery 1st Class

3/7

Sevin Beach

Dr. Content's correct in connection
map. March 4/84. Prof. Allen.

Examined this
of D. W. Content
place etc. on map
for the same.