

Bosque Co.

8/3/1900 ~ 6/3/96

le

565-2

Milam

PRE-EMPTION.

H. N. Ericson

35 1/3

acres

ct

May 26, 1873,
M. P. D. Landry

Correct on map of
Bosque County for
35 1/3 acres. July 7/1900.

Devon Rosenberg

Empire patite Regl.

Patent to Original
7/14/1900.

John J. Surrill
Chfld
Paid 7/14/1900. Wicks

No 531. Vol 30

gl.

2886 Ext. V. 20

7/17/1900 Ptd. obs. 24

CONTENTS.

No. 1. Affidavit.

No. 2. Field Notes.

No. 3.

No. 4.

5/20 Smith
96

Cert of Correction
9/8/96 Smith
Proof occup 6/27-99 P
5 cor f notes { 6/19/1900
6 ord for Pat } camp land

3-21-00

\$500 Sept 4/1900
by H. N. Ericson
Lifton - Texas

Rept 9/27/96
Tom L. Greer
Meridian

THE STATE OF TEXAS, }

County of Dosque

To the County Surveyor

of Dosque County

By virtue of the accompanying affidavit, made in accordance with Arts. 3939 and 3940, Revised Statutes, and under the provisions of "An Act for the relief of actual occupants of the public lands," approved April 24, 1879, I, H. N. Ericsson

son hereby apply for a survey of the following premises, 180

acres, to wit:

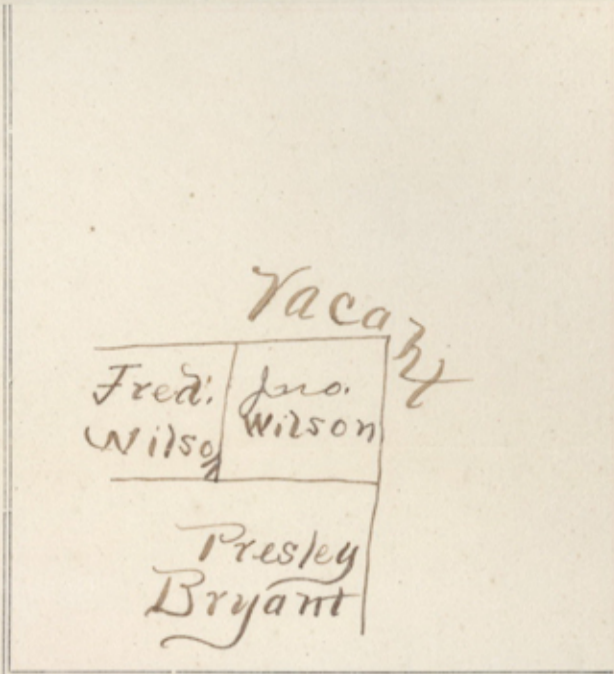

Lying N. and E. of the Jno. Wilson Pre-emption Survey.

and I further state that I claim the same for myself in good faith, under the laws granting homestead donations; that I am without any homestead of my own, and that I have actually settled upon the land which I claim, and that I believe the same to be vacant and unappropriated public domain. I further state that I am not the head of a family

eighteen (18) yrs. of age
[Signed] A. N. Ericsson Applicant.

THE STATE OF TEXAS, }

County of Dosque
H. N. Ericsson

Before the undersigned authority personally appeared H. N. Ericsson applicant, who, being by me duly sworn, according to

law, deposes and says that the above and foregoing statement is true and correct.

[Signed] A. N. Ericsson Applicant.

Sworn to and subscribed before me, this 8th day of April A. D. 1896

O. W. Sidwell Co. Clerk
Dosque County, Texas.

* Here state "the head of a family"—or, if single, "eighteen years of age."

By J. L. Minigus Deputy

DUTY OF THE SURVEYOR.

ARTICLE 3940. Said application shall be filed with the said Surveyor, and recorded by him in a well bound book, kept for recording pre-emption and homestead applications; and the said Surveyor shall give a receipt therefor, if desired.

ARTICLE 3941. It shall be the duty of the Surveyor of the proper district or county to survey the land described in the application aforesaid, as soon as practicable and within twelve months after the date of said application, and the field notes thereof shall be certified to, recorded and mapped, as required by law in other cases, the applicant paying all legal surveyor's fees.

File 565-21
Milam Co
H. N. Ericson
Application
Filed May 19/1896
W. J. Wood
Chf Clerk
J. J. Smith
File 600

4-8-96
4-9-96
5-14-96

THE STATE OF TEXAS,
County of *Borgess*

APPLICATION AND AFFIDAVIT
FOR
HOMESTEAD

OF

J. N. Ericson

Filed *April 8* A. D. 189*6*
and recorded in Book *1* page *50*

J. J. Smith
Surveyor.
County, Texas.

~~Application must be
18 years of age before
he can acquire a homestead
Denote, under sec
Article. Return 7/14/1896~~

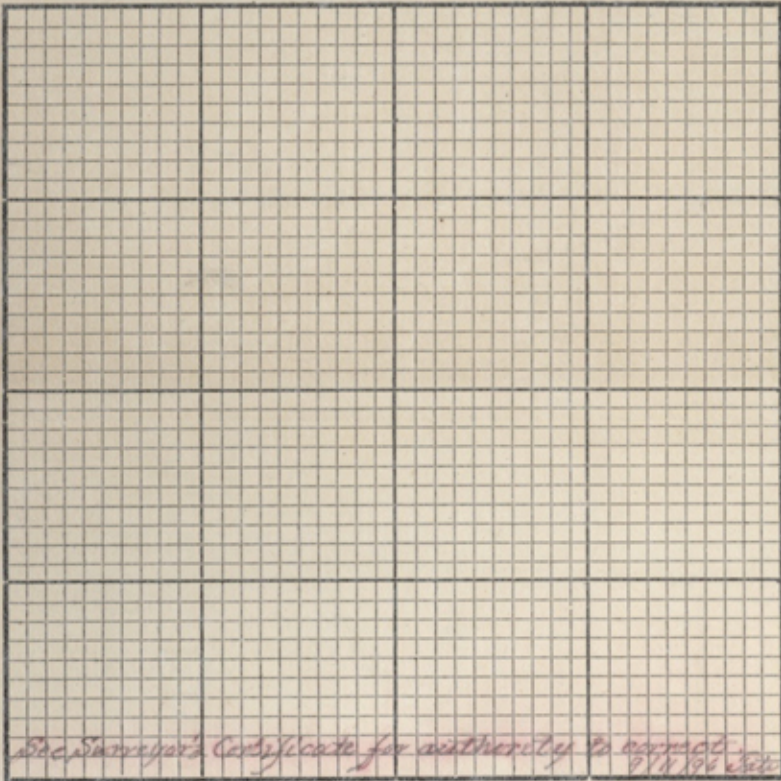

THE STATE OF TEXAS, } Survey
County of Basque } No.

FIELD NOTES of a Survey of 41

Acres of Land made for
N.W. Erickson
it being a portion
of the land to which
he is entitled
by virtue of his
affidavit of oc-
cupancy.

Scale Varas per Inch. Variation

Said Survey is No. in Basque County, Texas, situated on the
waters of Turkey, a tributary of Basque River,
about 10 1/2 miles S 12° W of Meridian

BEGINNING at The S.E. cor. of the Jacob Castle-
man survey, from which a L.O. mkd.
H hrs. S 75 E 30 vars. and another mkd H hrs.
S 56 E 28 vars.

Thence S 60 W 672 vars passing S.W. cor
of Castleman, — 1162 vars to The S.W.
cor. of the A.P. Jöle survey.

Thence S 30 E ¹⁵² 120 vars to the
N.W. cor. of the Fred. S. Wilson survey from
which a L.O. mkd W hrs S 10 E 6 vars.

Thence N 55 E with an ⁹⁶³ old, very
plainly marked line, 930 vars to
the N.E. cor. of said Wilson survey
from, which a black post mkd, W hrs N 60 E
26 vars.

Thence S 30 E 84 vars to the original
N.W. cor. of the J. Wilson survey.

Thence N 60 E with a well marked
line 950 vars to the N.E. cor. of the
J. Wilson survey.

Thence N 30 W 151 vars to the orig-
inal S.E. cor. of the O.P. Peterson survey

Thence S 60 W 738 vars

Additional Certificate

I hereby certify that
I did on the day below stated find every

File 56522
 Milam Co
 H. W. Ericson
 Field Notes
 Filed May 19/1896
 Myself
 Chfs etc
 v. J. Smith
 File etc,

Cancelled
 corrected notes
 6/30/1900
 24 000
 19 000
 5-25-96

FILING FEE PAID.

MAY 19 1896
 J. B. HARRIS, RECEIVER,
 GENERAL LAND OFFICE

FILING FEE PAID.

MAY 13 1896
 J. B. HARRIS, RECEIVER,
 GENERAL LAND OFFICE

No. *26*

FIELD NOTES

OF A

SURVEY

MADE FOR

H. W. Ericson

Filed for Record the *12* day of *May* 189*6*, at *9* o'clock *A.M.*, and duly Recorded
 the *12* day of *May*, 189*6* Book *229* Page *229*
Samuel Green SURVEYOR

By *Samuel Green* Deputy.
Samuel Green County Surveyor, Texas.

I, *Samuel Green*, County Surveyor of *Milam* County, Texas,
 do hereby certify that the foregoing described Survey was actually made by me on the ground, according to law, on the
 date and with the Chain Carriers aforesaid, duly qualified, and that all the Corners, Lines, Boundaries and Marks of the
 same, whether natural or artificial, are truly and correctly described and set forth in the foregoing Plat and field Notes.

Bearings marked
 Surveyed *April 9* 189*6* *Charles Johnson* Chain Carriers
Matt Johnson

to the place of beginning.

corners except for as described in the
 foregoing field notes as stated or
 described above, and that the only
 one bearing trees above described
 that the corners of the inside described
 were certified to by living witness
 as on the ground, as showing been
 located by locating bearings when
 said land was located
Samuel Green
 County Surveyor of
 Milam County,
 Texas.

Samuel Green Surveyor,
Samuel Green County, Texas.

11/20

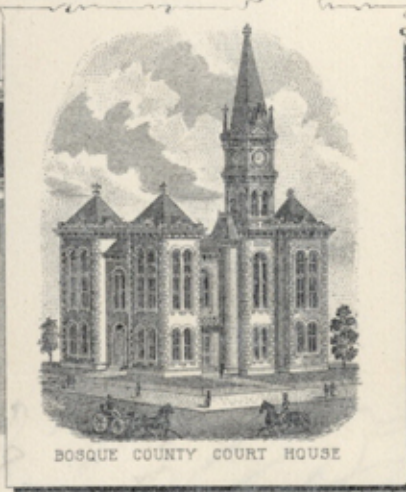

BOSQUE COUNTY COURT HOUSE

BOSQUE COUNTY.

COUNTY COMMISSIONERS
 J. H. ESTES.
 PRECINCT NO. 1, MERIDIAN, TEXAS.
 J. L. OWNBAY,
 PRECINCT NO. 2, WALKER, TEXAS.
 W. S. FEAGIN,
 PRECINCT NO. 3, SHERMAN, TEXAS.
 L. H. SCRUTCHFIELD,
 PRECINCT NO. 4, VALLEY HILLS, TEXAS.

W. B. Thompson, County Judge
 C. W. Tidwell, Co. Clerk. J. N. Metcalf, Sheriff
 F. P. Smith, Dist. Clerk. H. F. Dillard, Co. Atty.
 H. W. Randal, Treasurer. John Dyer, Collector
 J. C. Fittle, Co. Assessor. T. L. Greer, Co. Surveyor

Meridian, Texas, Sept. 5 1896.

Mr. J. Baker Esq.,
Austin Texas.

Dear Sir:

In reply to yours of 2nd inst
 in regard to the A. W. Carrierson Survey
 I will authorize you to make the
 2nd call "S 88° E 144 770"
 3rd " " N 55° E 969 " " as the
 same has been made on my records

Truly yours
 Tom L. Greer,
 Co. Surveyor.

File 565-2¹¹³
Milam Pm
H. W. Ericson
Cert. of Correction
Filed Sept. 8/1896
M. J. Wolf
Chf Clerk
V. J. Smith
File Clerk

Applied

PROOF OF SETTLEMENT UNDER HOMESTEAD ACT.

THE STATE OF TEXAS, }

County of Bosque }

BEFORE ME, the undersigned, County Clerk in and for the County aforesaid, this day came and personally appeared N. W. Ericsson, a resident citizen of said county, who being by me duly sworn, declares that he is a *bono fide* settler upon 41 acres of vacant public land, situated in said county, and surveyed for N. W. Ericsson on the 8th day of April 1896, by Tom L. Greer a surveyor of said county; that he has occupied and improved the same as a Homestead for a period of three consecutive years, beginning on the 8th day of April 1896, that he is a single man, and that he makes this affidavit for the purpose of obtaining a title the same for a Homestead, under "An act for the Benefit of Actual Occupants of the Public Lands," approved May 26th, 1873, and Acts prior thereto; and that he has not a Homestead other than the above.

And also at the same time came and personally appeared John Mattson and Jacob E. Wilson, two credible resident citizens of said county, to me well known, who being sworn, dispose and say that N. W. Ericsson the person first above named in this affidavit, has actually settled upon and cultivated as a Homestead the land surveyed for him on the 8th day of April 1896, by the surveyor aforesaid, for the period of three years, and they nor either of them have any interest in the said land.

N. W. Ericsson
John Mattson
J. E. Wilson

Sworn to and subscribed before me, and I hereby certify that John Mattson and J. E. Wilson are credible and trustworthy citizens of said county.

IN TESTIMONY WHEREOF, I have hereunto set my hand and affixed the seal of said county, at office, this 19th day of

June 1899
J. L. Mingers
Clerk of County Court Bosque Co.

575-2

File 5657

(H)

Milam Pre-
Eruption

H W Ericson

Proof occup

Filed June 27-99

A A Peoples

File clk

H. W. Ericson
Settler.

PROOF
OF SETTLEMENT OF LAND

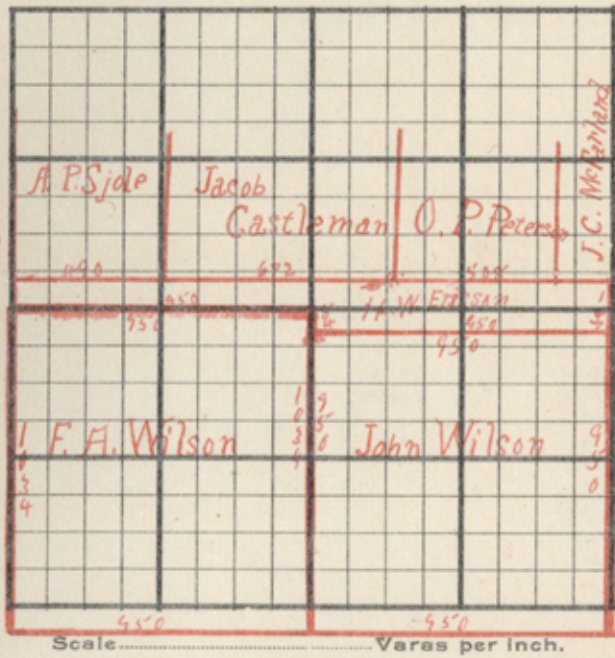

The State of Texas, } SURVEY

Bosque COUNTY, No. ^{1/3}

corrected FIELD NOTES of a Survey of 35 ~~70~~ acres

of Lands, made for

H. H. Ericsson it being a portion of the land to which he is entitled by virtue of his affidavit of occupancy

Said Survey is No. _____, in Bosque County, Texas, situated on the waters of

Turkey Creek a tributary of the Bosque River, about 14 miles South of Meridian Beginning at the S.E. corner of the Jacob

Castleman survey from which a live oak marked H bears S 56° E 30 varas and another marked H bears N 75° W 28 varas

Thence S 60° N 672 varas passing the S.W. corner of said Castleman survey and the S.E. corner of A.P. Sjole survey

- 1162 varas to the S.W. corner of said Sjole survey, on the E. B. line of the J. F. Johnson survey; Thence S 30° E

63 varas to the N.W. corner of the Fred A. Wilson survey from which a live oak marked W bears S 10° E 6 varas

Thence N 60° E 950 varas to the N.E. corner of said Wilson survey from which a Black Jack marked W bears N 60° E 26 varas;

Thence S 30° E 84 varas to the N.W. corner of the John Wilson survey; Thence N 60° E with

an old and very plainly marked line 450 varas to the N.E. corner of the said John Wilson survey;

Thence N 30° W 147 varas to a corner in the South line of the John C. McFarland survey; Thence S 60° N passing the S.W. corner of the John C. McFarland and the S.E. corner of the O.P. Peterson

surveys 686 varas to the place of beginning.

Bearings marked _____
Surveyed April 24 1890 } Chain Carriers.
C. A. Henning
J. E. Wilson

I, G. H. Garner County Surveyor

of Bosque County, Texas, do hereby certify that the foregoing described survey was actually made by me on the ground, according to law, on the date and with the Chain Carriers aforesaid, duly qualified, and that

all the corners, lines, boundaries and marks of the same, whether natural or artificial, are truly and correctly described and set forth in the foregoing Plat and Field Notes.

G. H. Garner
County Surveyor of Bosque Co., Texas.

By _____ Deputy

G. H. Garner
County Surveyor.

I, G. H. Garner County Surveyor of Bosque County do hereby certify that I have examined the foregoing plat and field notes, and find them correct and that they are recorded in my office in Book No. C page 233

File ~~5652~~ 3957 (5)
Milam Pa. Euphon
H. W. Ericsson
Cornet and field notes
Filed 4/30/1900
W. Hoar
File CLK

Correct for 35% same
on map of Berque Co.
May 8/1900
July 7/1900
D. R.

Patented 7/18/1900,
W. Hoar

5/8/1900
D. R.

Cornet and field notes of
Mr. H. W. Ericsson present
non Army No. 5652

740



BOSQUE COUNTY COURT HOUSE

Bosque COUNTY.



COMMISSIONERS:
 HENRY LATIMER, PRECINCT NO. 1. MERIDIAN, TEXAS.
 J. R. MORRISON, " 2. MORGAN, TEXAS.
 G. W. MAY, " 3. WOHACK, TEXAS.
 P. A. NOWLIN, " 4. VALLEY MILLS, TEXAS.

H. C. COOKE, COUNTY JUDGE.
 J. L. MINGUS, Co. CLERK. W. A. BOYD, SHERIFF.
 ROBERT JONES, DIST. CLK. H. S. DILLARD, Co. ATTORNEY.
 J. C. TITTLE, TREASURER. ED. MISSICK, TAX COLLECTOR.
 L. C. McCANDLESS, ASSESSOR. WILLIS TURNER, SURVEYOR.

Meridian, Texas, June 9th 1890

Hon. Charles Rogan
Austin Texas

Dear Sir:

Please send to G. W. James the Co. Surveyor of Bosque Co. the patent to the H. H. Ericsson Preemption, Claim 3957, in Bosque County, Milan Preemption.

And Oblige
H. H. Ericsson

File ⁵⁶⁰⁵²⁷ 3957
Milam Pro Emption
H. N. Ericson
order for patent
Filed 6/19/1900
W. J. Bourne
J. Chalk

L. 560
3957

W. J. Bourne

6/19
E. J.