

Bosque Co.

8/2/95

File 5611

Milam

PRE-EMPTION.

G. F. Reeder

15.8³/₄ Acres

Act T. 79 C. 9 R. S.

Sketch discrepancy in ms 3520

According to field notes of surrounding surveys, this survey conflicts with S. 15, S. 16, & S. 17 all, R. C. Campbell; and J. J. Burleson P. 4786, all patented. Surveyor should send a certified sketch showing the position of the James Cooper, B. B. Johnson & Peter Wood surveys, relative to the said R. C. Campbell surveys.

See Orderings & direct at Off. R. 5579 ^{8/5/95} State.

See endorsement on Surveyor's Sketch.

8/20/95

West. Vol. 19

Mgl. 28392 ^{11/21/95} State

O. C. Aug 20/95 State

CONTENTS.

- No. 1. Affidavit. ^{7/9/95}
- No. 2. Field Notes. ^{9/5/95} S.
- No. 3. Certified Sketch
- No. 4. Sur Letter ^{8/15/95} S.

Repd to Surveyor

8/6/95 - 8/20/95

State

The State of Texas, }

County of Bosque

To the County Surveyor
of Bosque County

By virtue of the accompanying affidavit made in accordance with
Art. 3939 and 3940, Revised Statutes, and under the provisions of
"An Act for the relief of actual occupants of the public lands, approved
April 24th, 1879," I, G. J.

Reeder hereby apply for a survey
of the following premises,

158 acres, to wit:

James Cooper

Vacant

R. C. Campbell
320 320 320

*Lying south of the E.S.C.
Robertson 369 acre survey and
James Cooper and north of R.C.
Campbell's surveys.*

and I further state that I claim the same for myself, in good faith, under the laws granting Homestead donations; that I am
without any homestead of my own, and that I have actually settled upon the land which I claim,*

married man and that I believe the same to be vacant and unappropriated public domain

Signed, G. J. Reeder Applicant.

THE STATE OF TEXAS, }

COUNTY OF Bosque

BEFORE THE UNDERSIGNED AUTHORITY, personally

appeared G. J. Reeder Applicant, who being by me duly sworn

according to law, deposes and says that the above and foregoing statement is true and correct.

Signed, G. J. Reeder Applicant.

Sworn to and subscribed before me this 20th day of April A. D. 1895:

IN TESTIMONY WHEREOF, I hereunto affix my official seal and signature.

W. Sidwell Clerk County
County Bosque Co. Texas

* Here state if "the head of a family"—if single that applicant is eighteen years of age.

DUTY OF THE SURVEYOR.

ARTICLE 3940. Said application shall be filed with the said Surveyor, and recorded by him in a well-bound book kept for recording pre-emption and homestead applications; and the said Surveyor shall give a receipt therefore, if desired.

ART. 3941. It shall be the duty of the Surveyor of the proper District or County, to convey the land described in the application aforesaid, as soon as practicable, and within twelve months after the date of said application, and the field notes thereof shall be certified to, recorded and mapped, as required by law in other cases, the applicant paying all legal Surveyor's fees.

File 5611 ✓
Milam Presumption
G. F. Reeder
Application
Filed July 5/1895
H. E. Ross
Chief Clerk

SEO. D. BARNARD & CO., PRS., ST. LOUIS.

THE STATE OF TEXAS,

County of Bosque

**APPLICATION AND AFFIDAVIT
FOR HOMESTEAD,**

G. F.
Reeder

Filed the 20 day of April

A. D. 1895, and recorded in Book 1

Page 20

James L. Greer,
SURVEYOR.

1162

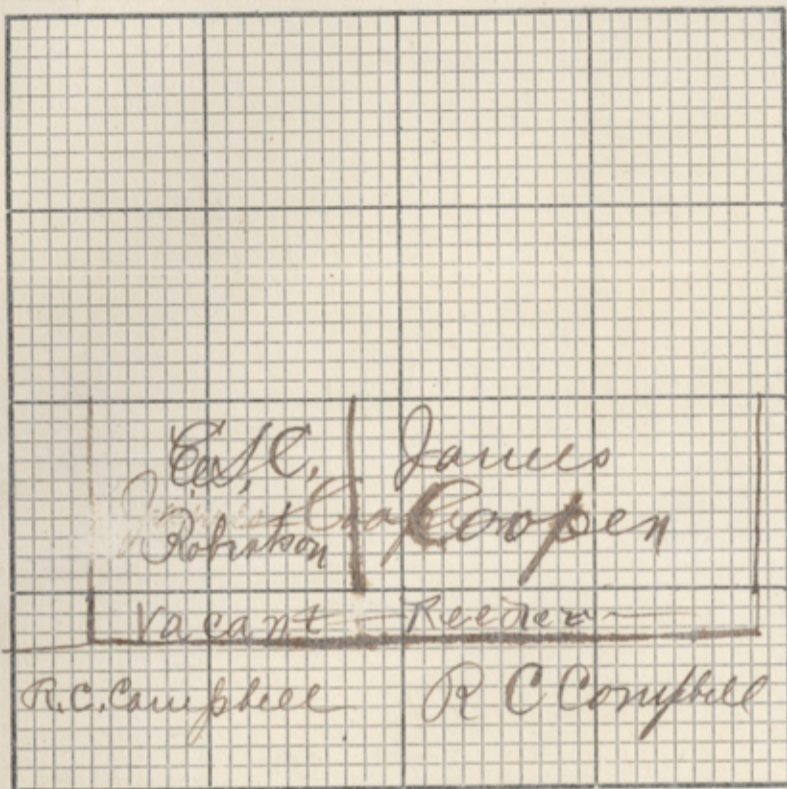

THE STATE OF TEXAS, } Survey
County of *Basque* } No.

FIELD NOTES of a Survey of *158³/₄*
Acres of Land made for

G. F. Reeder
it being a portion of the land to which he is entitled by virtue of his affidavit of occupancy

Scale Varas per Inch. Variation

Said Survey is No. in *Basque* County, Texas, situated on the waters of *Possum Int.* a tributary of *Basque* River, about ~~17~~ *17* miles *S. 2¹/₂ E.* of *Meridian*

BEGINNING at *the S.E. corner of the James Cooper Survey.*

*Thence S 00° W 10 vars a branch in ~~2713~~ vars to the N.W. corner in the South line of E. C. Robertson 369^{Ac} Survey
Thence S 30° E 323 vars to the S.W. corner in the N. line of R. C. Campbell 320^{Ac} Survey.
Thence N 00° E ~~2713~~ vars to the S.E. corner
Thence N 30° W 323*

For authority & correct, see Surveyor's Certificate 9/20/95

File 5611 ²
 Milan Prescription
 G. F. Reeder
 Field Notes
 Filed July 5/1895
 H. J. Pappas
 Chief Clerk

contains 195 ²¹/₁₀₀ acres
 7/13/95 G. F. R.

C. C. Aug 20/95 Later

..... to the place of beginning.
 Bearings marked.....
 Surveyed March 27 28 29 1895
 I, *Samuel Green*, County Surveyor of *Bozque* County, Texas, do hereby certify that the foregoing described Survey was actually made by me on the ground, according to law, on the date and with the Chain Carriers aforesaid, duly qualified, and that all the Corners, Lines, Boundaries and Marks of the same, whether natural or artificial, are truly and correctly described and set forth in the foregoing Plat and field Notes.
 By *Samuel Green* Deputy
 County Surveyor *Bozque* County, Texas.

Filed for Record the 26 day of *June* 1895 at 9 o'clock A.M., and duly Recorded
 the 26 day of *June* 1895 Book *C* Page *199*

*These field notes adopted 21st day of April 1895
 by Saml R. Greer. County Surveyor.*

FIELD NOTES
 OF A
 SURVEY
 MADE FOR
G. F. Reeder
 Surveyor
 County, Texas
 No.
 E 541
 8-33-10

*Surveyor must accept these as first note as the survey was made prior to application
 6/9/95*

FILING FEE PAID
 JNO. P. HARRIS, CLERK

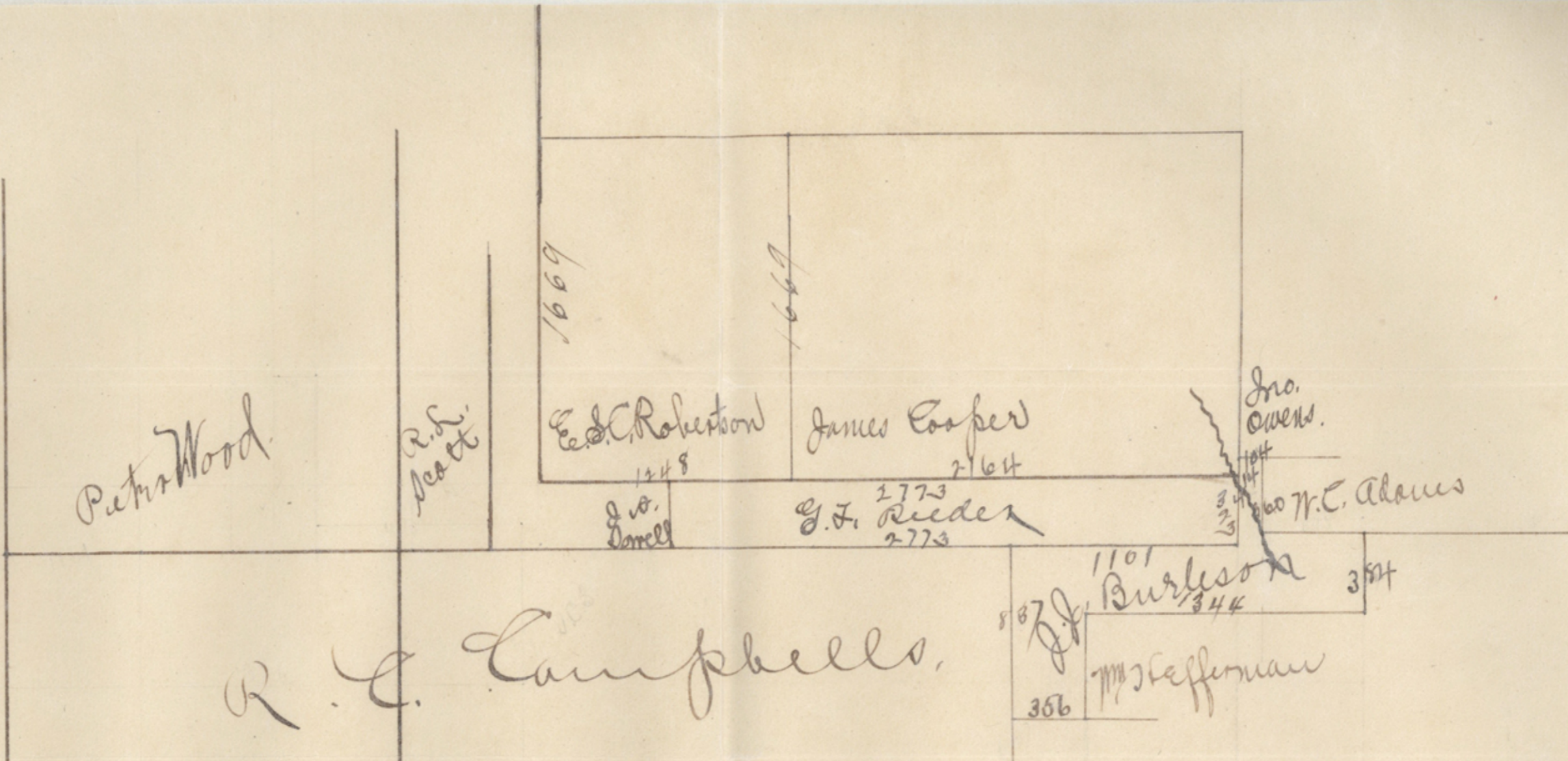

R. C. Campbell,

I, J. M. L. Green, County Surveyor of Boone County do hereby certify that the above is a true and correct plat of the G. F. Reeder and adjoining surveys

J. M. L. Green
 Co Surveyor.
 Boone Co. Mo.

Faint handwritten notes and a sketch of a rectangular plot with various lines and labels. The sketch includes a diagonal line and several smaller rectangular areas within the main plot. Faint text like '3rd' and '1st' is visible near the sketch.

File 5611 3
Milam In
G. F. Reeder
Certified Sketch
Filed Aug 14/1895

Conir

This sketch is not sufficient to establish the vacancy for this survey. Said sketch does not show how any of the lines or corners of surrounding surveys were identified. This office requires more evidence than is adduced by this sketch, to prove this survey (G. F. Reeder) to be correct on map.

8/20/95
 Tate

Faint handwritten notes and a sketch of a rectangular plot with various lines and labels. The sketch includes a diagonal line and several smaller rectangular areas within the main plot. Faint text like '3rd' and '1st' is visible near the sketch.

1895

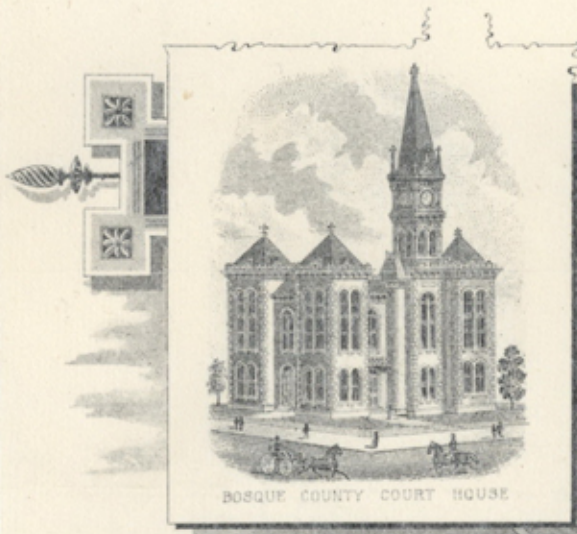

BOSQUE COUNTY.

COUNTY COMMISSIONERS
 J. H. ESTES
 J. L. OWNBEY
 W. B. FEAGIN
 L. H. SCRUTCHFIELD

W. B. Thompson, County Judge
 C. W. Tidwell, Co. Clerk: J. N. McCall, Sheriff
 F. P. Smith, Dist. Clerk: H. S. Dillard, Co. Atty.
 F. J. Randal, Treasurer: John Dyer, Collector
 J. C. Fittle, Co. Assessor: T. L. Greer, Co. Surveyor

Meridian, Texas, Aug 12, 1895

A. J. Baker Esq.
 Austin Tex 400.
 Dear Sir:

You will find enclosed Certified Sketch of E. F. Reeder's Pre-emption survey and relation to other surveys.

You will please correct the field notes of the said E. F. Reed Survey in E. F. W. calls. "N 60° E 2773 rods + S 60° W 2773 rods" instead of 3412 rods. It was a clerical error and you will oblige me by a correction.

Sincerely yours
 Tom L. Greer,
 Co. Surveyor
 Bosque County,
 Tex.

File 5611 4

Milam Pm

G. F. Reeder

Sur. Letter

Filed Aug 14/1895

Baker

Applied