

Basque Co. 6/10/95

File 5606

Milam

act, 1224-19

PRE-EMPTION.

for vol 19

S. A. Mims

137
~~153~~ Acres

Act 79, 69, R.S. & on map. 1-4-'01

Correction map of
Basque County June
11th 1895 C. McKill

Sept 26th 1900
J. F. McKinney
Co. for pat. to orgl-
Patent to original
12/4/1900
at base John [unclear]
Chas. [unclear]
Patent 4/1900
No. 223 vol 31

Mgl. 783
C. [unclear] 19
C. [unclear] 24
C. [unclear] 3/95

CONTENTS.

- No. 1. Affidavit. 6/6/95
- No. 2. Field Notes. Moses.
- No. 3. Proff of occupancy 2/3/1900
- No. 4. Affidavit 11/26/1900

5 Order for patent 11/24/00
without a home 1000
acres of land and to
every legally married
18 years of age and
80 acres provided the
comply with the terms of
the law in law of
married woman is not
the head of a family.
Applicant will have to
show by affidavit the
above set forth as a fact
at date of the application
has already begun
the land.

6/23/1900
\$500
by Mrs S. A. Mims
Meridian Texas
Tom L. Hill
Meridian

The State of Texas, }

County of Bosque

To the County Surveyor
of Bosque County

By virtue of the accompanying affidavit made in accordance with
Art. 3939 and 3940, Revised Statutes, and under the provisions of
"An Act for the relief of actual occupants of the public lands, approved
April 24th, 1879," I, Mrs. S. A.

Mims hereby apply for a survey
of the following premises, 160

_____ acres, to wit:

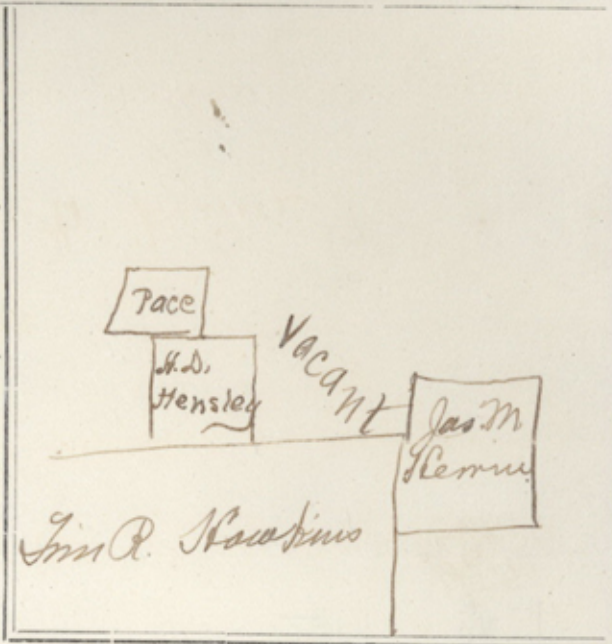

*Lying East and adjoining
the H. D. Hensley Pre-emption
survey.*

and I further state that I claim the same for myself, in good faith, under the laws granting Homestead donations; that I am
without any homestead of my own, and that I have actually settled upon the land which I claim, * Married
woman and that I believe the same to be vacant and unappropriated public domain

Signed,

S A Mims

Applicant.

THE STATE OF TEXAS, }

COUNTY OF Bosque

BEFORE THE UNDERSIGNED AUTHORITY, personally

appeared Mrs. S A Mims Applicant, who being by me duly sworn

according to law, deposes and says that the above and foregoing statement is true and correct.

Signed,

S A Mims

Applicant.

Sworn to and subscribed before me this 30th day of March A. D. 1885.

IN TESTIMONY WHEREOF, I hereunto affix my official seal and signature.

C. W. Sidwell, County Clerk
Bosque County, Texas

* Here state if "the head of a family"—if single that applicant is eighteen years of age.

By J. L. Minges deputy

DUTY OF THE SURVEYOR.

ARTICLE 3940. Said application shall be filed with the said Surveyor, and recorded by him in a well-bound book kept for recording pre-
mption and homestead applications; and the said Surveyor shall give a receipt therefor, if desired.

ART. 3941. It shall be the duty of the Surveyor of the proper District or County, to convey the land described in the application aforesaid,
as soon as practicable, and within twelve months after the date of said application, and the field notes thereof shall be certified to, recorded and mapped,
as required by law in other cases, the applicant paying all legal Surveyor's fees.

1 File 5606
Milam Gre
S. A. Mims
Application
Filed June 5, 1885
H. Stebbins
Chief Clerk

96-0-9
-96-0-7
96-0-9

REG. D. BARNARD & CO., PRS., ST. LOUIS.

THE STATE OF TEXAS,

County of Basque

**APPLICATION AND AFFIDAVIT
FOR HOMESTEAD,**

—OF—

Mrs. S. A.
Mims.

Filed the 30 day of March

A. D. 1885, and recorded in Book 1

Page 18

Tom Greer.

SURVEYOR.

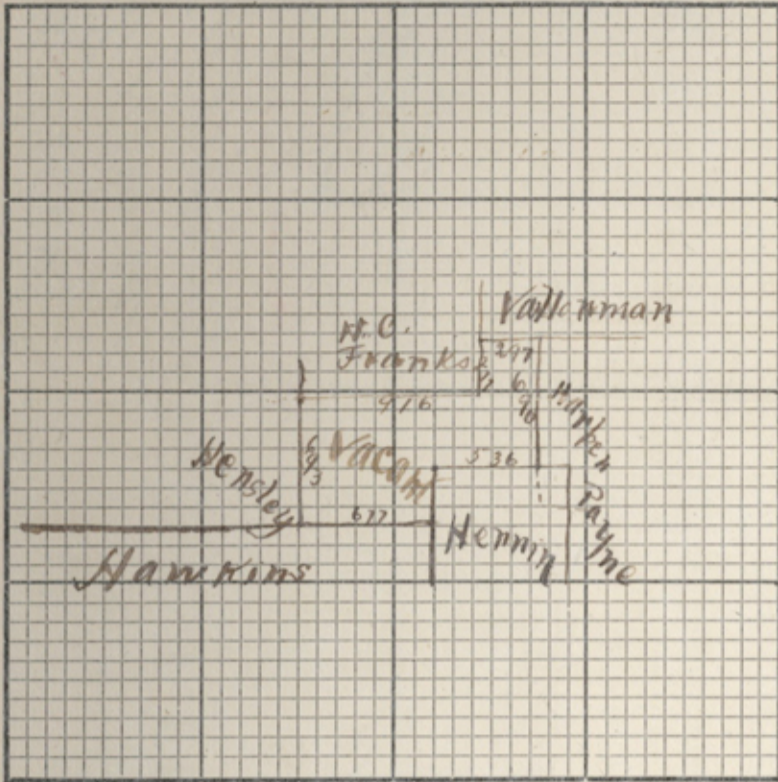

THE STATE OF TEXAS, } Survey
 County of Bosque } No.

FIELD NOTES of a Survey of 133 137

Acres Land made for

Mrs. S. A. Minnie
 it being the
 a portion of the
 land to which she
 is entitled by
 virtue of her
 affidavit of oc-
 cupancy.

Scale Varas per Inch. Variation

Said Survey is No. in Bosque County, Texas, situated on the
 waters of Spring Creek, a tributary of Bosque River,
 about 10 miles N 76 W of meridian

BEGINNING at NE. cor. of N. Tom. R. Hawkins
Survey.

- Thence N 30 W 280 varas to the
N.W. cor. of Jas McKerrin pre-emption sur.
from wh. a L.O. n.k. 576 & 35 vrs.
 Th. N 60 E 536 varas.
 " N 30 W 690 "
 Th. S 60 N 297 "
 " S 30 E 277 "
 " S 60 W 916 "
 " S 30 E 693 "
 " N 60 E 677 "

File 5606
Milam A.
S.A. Wims
Field Notes
137 acres
Filed June 5, 1895
Reports
Chief Clerk

Correct on map
of Posque County
June 11th 1895
C.M. Hill

Sept 26th 1900
J. F. Pinckney
Dated 12/4/1900
Macker

June 7/95
S. A. Wims

E 541

No.

FIELD NOTES

OF A

SURVEY

MADE FOR

Mrs. S. A.
Wims

FILING FEE PAID.

JUN 10 1895
JNO. P. HARRIS, RECEIVER,
GENERAL LAND OFFICE.

Tom L. Greer Surveyor,

Posque County, Texas.

8-93-10

Bearings marked to the place of beginning.
Surveyed *Apr 5 changed May 1895* } Chain Carriers.
Tom L. Greer }
I, *Tom L. Greer*, County Surveyor of *Posque* County, Texas,
do hereby certify that the foregoing described Survey was actually made by me on the ground, according to law, on the
date and with the Chain Carriers aforesaid, duly qualified, and that all the Corners, Lines, Boundaries and Marks of the
same, whether natural or artificial, are truly and correctly described and set forth in the foregoing Plat and field Notes.

By *Tom L. Greer* Deputy.
County Surveyor *Posque* County, Texas.
Filed for Record the *3* day of *June* 189*5*, at *5* o'clock *P.*M., and duly Recorded
the *8* day of *June* 189*5* Book *6* Page *191*
Tom L. Greer SURVEYOR

PROOF OF SETTLEMENT UNDER HOMESTEAD ACT.

THE STATE OF TEXAS,)

County of Tosque)

BEFORE ME, the undersigned, County Clerk in and for the County aforesaid, this day came and personally appeared Mrs S. A. Mims, a resident citizen of said county, who being by me duly sworn, declares that she is a *bono fide* settler upon 137 acres of vacant public land, situated in said county, and surveyed for Mrs S. A. Mims on the 30 day of March 1895, by Thomas L. Gried a surveyor of said county; that she has occupied and improved the same as a Homestead for a period of three consecutive years, beginning on the 30 day of March 1895, that she is a widow, and that she makes this affidavit for the purpose of obtaining a title the same for a Homestead, under "An act for the Benefit of Actual Occupants of the Public Lands," approved May 26th, 1873, and Acts prior thereto; and that she has not a Homestead other than the above.

And also at the same time came and personally appeared, W. F. Walling and G. F. Kealley, two credible resident citizens of said county, to me well known, who being sworn, dispose and say that Mrs. S. A. Mims the person first above named in this affidavit, has actually settled upon and cultivated as a Homestead the land surveyed for ~~him~~ ^{her} on the 30th day of March 1895, by the surveyor aforesaid, for the period of three years, and they nor either of them have any interest in the said land.

Mrs. S. A. Mims
W. F. Walling
G. F. Kealley

Sworn to and subscribed before me, and I hereby certify that W. F. Walling and G. F. Kealley are credible and trustworthy citizens of said county.

IN TESTIMONY WHEREOF, I have hereunto set my hand and affixed the seal of said county, at office, this 2nd day of July 1900 1898

J. L. Mingers
Clerk of County Court Tosque Co.

File 5606 (3)
Milam
Preemption
Mrs A Minus
Proof of occupancy
Filed Feb 3 1900
J. O. Claupland
File Clerk

PROOF
OF SETTLEMENT OF LAND
Mrs. S. A. Minus
Settler.

mil P. 5606

PROOF OF SETTLEMENT UNDER HOMESTEAD ACT.

THE STATE OF TEXAS,)

County of Rosque)

Notary Public

BEFORE ME, the undersigned, ~~County Clerk~~ in and for the County aforesaid, this day

came and personally appeared Mrs. S.A. Mims, a resident citizen of said county, who being by me duly sworn, declares that he is a *bono fide* settler upon 137

acres of vacant public land, situated in said county, and surveyed for me on the 5th day of April 1895, by Thomas L Greer

a surveyor of said county; that he has occupied and improved the same as a Homestead for a period of three consecutive years, beginning on the 5th day of April 1895, that he is a widow, and ^{was} the head of a family at the time application for preemption was made, and that he makes this affidavit for the purpose of obtaining a title the same for a Homestead, under "An act for the Benefit of Actual Occupants of the Public Lands," approved May 26th, 1873, and Acts prior thereto; and that he has not a Homestead other than the above.

And also at the same time came and personally appeared Ed. Greer and F. B. Davis, two credible resident citizens of said county, to me well known, who being sworn, dispose and say that Mrs. S.A. Mims the person first above named in this affidavit, has actually settled upon and cultivated as a Homestead the land surveyed for her on the 5th day of April 1895, by the surveyor aforesaid, for the period of three years, and they nor either of them have any interest in the said land.

S. A. Mims
Ed. Greer
F. B. Davis
Ed. Greer

Sworn to and subscribed before me, and I hereby certify that Ed. Greer and F. B. Davis are credible and trustworthy citizens of said county.

IN TESTIMONY WHEREOF, I have hereunto set my hand and affixed the seal of said ~~office~~ ^{my} office, this 17th day of November 1895.

C. H. Cain, Notary Public
~~Clerk of County Court~~ Rosque Co. Texas

file 5606 (4)
Milam
Preemption
B. A. Sims
affidavit
filed Nov 26 1900
J. O. Campbell
J. O. C.

PROOF
OF SETTLEMENT OF LAND
By
J. A. Mims
Settler.

HOUSE OF REPRESENTATIVES

585

IREDELL, TEXAS, Nov. 24th 1902

J. J. Terrell, Chief Clerk,
Austin, Texas.

Dear Sir:— Your esteemed favor of
Sept. 29th stating that a patent to my
137 acre pre-emption in this, Bosque
County, file # 5606 Milam pre-emption, can
be issued to me when I make proper
affidavit that I was the head of
a family at the time application to
pre-empt the same was made,
to hand, and I have made the
affidavit which you will find
enclosed.

Please issue patent and mail
to C. H. Cain, at IredeLL, Texas, and oblige.

Yours truly,
S. A. Mims.

Mil. P. 5606 passed to S. A. Mims, org.

Robison 11/27/1900

File 5606
Milton P. & Aptin
S. A. Mims
order for patent
Filed 11/24/00
W. J. Coan
File cut

(5)

Ans-II-30-1900 Peoples.

S. A. Mims II-24-1900.

RECEIVED
FEB 1 1901
U. S. PATENT OFFICE