

Bosque Co. 1895

File 5601

Milam 21

PRE-EMPTION.

J. W. Arnold

107 Acres

Act T. 79, S. 69, R. 5.

According to within
Statements correct
on map of Bosque
County Nov 10th 1897

of C. G. Hice
Patent to Chas. A.

Lewis open 11/22/97

made on Dec 11/24/97
Patented Nov 22nd 1897

Mgl. 178353 Oct 14/19

June 4/95

CONTENTS.

No. 1. Affidavit. 5/30/95

No. 2. Field Notes. Moses

No. 3. Proof of Occupancy

No. 4. Transfer 6/14/97 S.

5. Certificate of Survey 11/24/97

6. Certificate of Survey 11/24/97

Should certify to the
fact & show how
he identifies the line
& corners by adjacent
surveys. 6/14/95

\$5.20 Dep'd 11/24/97
by Chas. A. Lewis

Meridian
Rept 6/17/95 to
James S. Greer
Meridian

The State of Texas,

County of Bosque

To the County Surveyor
of Bosque County Texas

By virtue of the accompanying affidavit made in accordance with
Art. 3939 and 3940, Revised Statutes, and under the provisions of
"An Act for the relief of actual occupants of the public lands, approved
April 24th, 1879," I, J. A. Arnold

hereby apply for a survey
of the following premises, 100 one hundred
Acres of land acres, to wit:

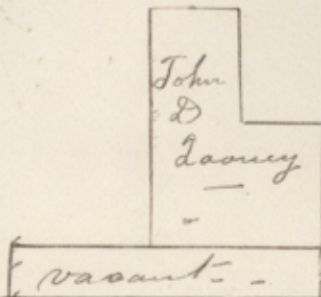

Beginning at the S.W. corner of J. B. Arnold's
survey. For the S.E. corner of this tract:
thence S 60 W. 2000.00. to S.W. corner of this,
thence N 30 W. 290.00. to N.W. corner of this,
thence N 60 E 2000.00. to N.E. corner of this,
thence S 60 W 290.00. to place of Beginning

and I further state that I claim the same for myself, in good faith, under the laws granting Homestead donations; that I am
without any homestead of my own, and that I have actually settled upon the land which I claim,* a the
head of a family and that I believe the same to be vacant and unappropriated public domain

Signed,

J. A. Arnold Applicant.

THE STATE OF TEXAS,

COUNTY OF Bosque

appeared J. A. Arnold

BEFORE THE UNDERSIGNED AUTHORITY, personally

an Applicant, who being by me duly sworn

according to law, deposes and says that the above and foregoing statement is true and correct.

Signed,

J. A. Arnold Applicant.

Sworn to and subscribed before me this 30th day of March A. D. 1884

IN TESTIMONY WHEREOF, I hereunto affix my official seal and signature.

W. A. Morgan a Notary
Public Bosque Co Texas

head of family.

* Here state if "the head of a family" if single that applicant is eighteen years of age.

DUTY OF THE SURVEYOR.

ARTICLE 3940. Said application shall be filed with the said Surveyor, and recorded by him in a well-bound book kept for recording pre-emption and homestead applications; and the said Surveyor shall give a receipt therefor, if desired.

ART. 3941. It shall be the duty of the Surveyor of the proper District or County, to convey the land described in the application aforesaid, as soon as practicable, and within twelve months after the date of said application, and the field notes thereof shall be certified to, recorded and mapped, as required by law in other cases, the applicant paying all legal Surveyor's fees.

File 5601
Milam Pres.
J. A. Arnold
Application
Filed May 19, 95.
Hopwood
Chief Clerk

SEC. O. BARNARD & CO., PRS., ST. LOUIS.

THE STATE OF TEXAS,

County of *Bosque*

**APPLICATION AND AFFIDAVIT
FOR HOMESTEAD,**

—OF—

J. A. Arnold

Filed the *30* day of *March*

A. D. 18*94*, and recorded in Book *Sen!*

Page *111*

J. A. Weeks, Co.
SURVEYOR.

per N. A. Morgan
Special Deputy.

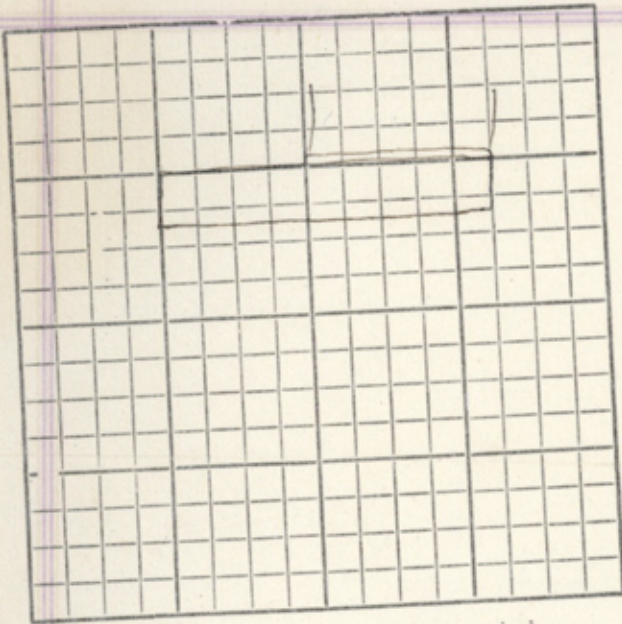

The State of Texas, } SURVEY

Bosque County, } No. _____

FIELD NOTES of a Survey of One hundred and Seven (107) Acres of Land, made for J. A. Arnold a part of the land to which he is entitled by virtue of his affidavit of occupancy, issued by N. A. Morgan, a Notary Public in Bosque County Texas, on 30th day of March 1894

Scale _____ Varas per inch.

Said Survey is No. _____, in Bosque County, Texas, situated on the waters of North Cedron Creek a tributary of Brazos River, about 7.9 ^{4.75} miles East of Meridian Beginning at S.W. corner of J. D. Looney Survey, for a corner of this.

Thence S 30 E 11 1/2 us. to E. P. Golden S. E. Corner
Thence S 61 W 8 35 us. to N. E. corner of New-Sheaffer Survey, for N. W. corner of this.

Thence S 30 E 30 6 1/2 us. to S W corner of This

Thence N 60 E 19 35 us. to S. E. Corner of This

Thence N 30 W 318 us. to N. E. corner of This

Thence S 60 W 1100 us.

to the place of beginning.

Bearings marked A + W.

Surveyed May 7th 1894

J. A. Arnold
Calvin Acuff } Chain Carriers.

I, N. A. Morgan Deputy County - Surveyor of Bosque County, Texas, do hereby certify that the foregoing described Survey was actually made by me on the ground, according to law, on the date and with the Chain Carriers aforesaid, duly qualified, and that all the corners, lines, boundaries and marks of the same, whether natural or artificial, are truly and correctly described and set forth in the foregoing Plat and Field Notes.

By N. A. Morgan Deputy

James A. Weeks
Surveyor Bosque County, Texas.

Filed for Record the _____ day of _____ 1894
at _____ o'clock _____ M.

Surveyor.

Recorded in Book R. C. page 184 Bosque County Surveyors Records.

File 5601

Milam A.

J. W. Arnold

Field Notes

Filed May 1995

Notes

Chief Clerk

Correction map
of Desque County

Nov 15/97

C. Mc Nice

Patented Nov 22nd/97

Dawson

C. June 4/
C. S. B. 195

FILING FEE PAID.
MAY 29 1895
JNO. F. HARRIS, RECEIVER,
GENERAL LAND OFFICE.

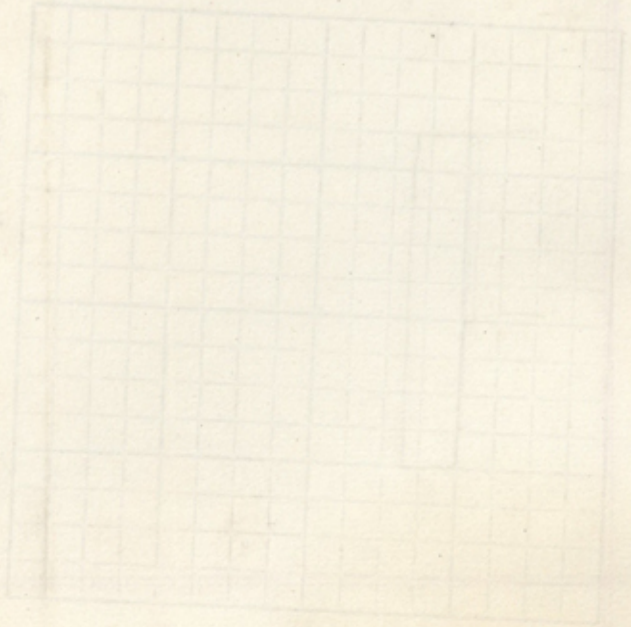

PROOF OF SETTLEMENT UNDER HOMESTEAD ACT.

THE STATE OF TEXAS, }

County of Bozque }

BEFORE ME, the undersigned, County Clerk in and for the County aforesaid, this day came and personally appeared J. A. Arnold, a resident citizen of said county, who being by me duly sworn, declares that he is a *bono fide* settler upon 10.7 acres of vacant public land, situated in said county, and surveyed for J. A. Arnold on the 30 day of March 1894, by N. A. Morgan, Deputy surveyor of said county; that he has occupied and improved the same as a Homestead for a period of three consecutive years, beginning on the 30 day of March 1894, that he is Married, and that he makes this affidavit for the purpose of obtaining a title the same for a Homestead, under "An act for the Benefit of Actual Occupants of the Public Lands," approved May 26th, 1873, and Acts prior thereto; and that he has not a Homestead other than the above.

And also at the same time came and personally appeared F. L. Woods and W. E. Weehunt, two credible resident citizens of said county, to me well known, who being sworn, dispose and say that J. A. Arnold the person first above named in this affidavit, has actually settled upon and cultivated as a Homestead the land surveyed for him on the 30 day of March 1894, by the surveyor aforesaid, for the period of three years, and they nor either of them have any interest in the said land.

J. A. Arnold
F. L. Woods
W. E. Weehunt

Sworn to and subscribed before me, and I hereby certify that F. L. Woods and W. E. Weehunt are credible and trustworthy citizens of said county.

IN TESTIMONY WHEREOF, I have hereunto set my hand and affixed the seal of said county, at office, this 5th day of April 1897.

W. S. Howell
Clerk of County Court Bozque Co.

By J. L. Minges deputy

File 5601 (3)

Milam Co

J. A. Arnold

Proof of Occupancy

Filed May 4/1897

W. Wood

Chief Clerk

V. J. Smith

File Clerk

56
262
318

306
16
317

Each for Price, Meridian, Texas.
PROOF
OF SETTLEMENT OF LAND
J. A. Arnold
Settler.

The State of Texas,

County of Roque

Know all Men by These Presents, That J. J. Arnold, joined
by my wife J. E. Arnold
of the County of Roque State of Texas, in consideration of the sum of
One hundred and seven DOLLARS,
paid and secured to be paid by Charles A. Lewis as follows:

On April 1st 1897, for which sum of \$107⁰⁰ said Lewis
has made and delivered his promissory note to
me bearing even date herewith and payable
April 1st 1897 without interest and which said
note is not transferrable nor negotiable

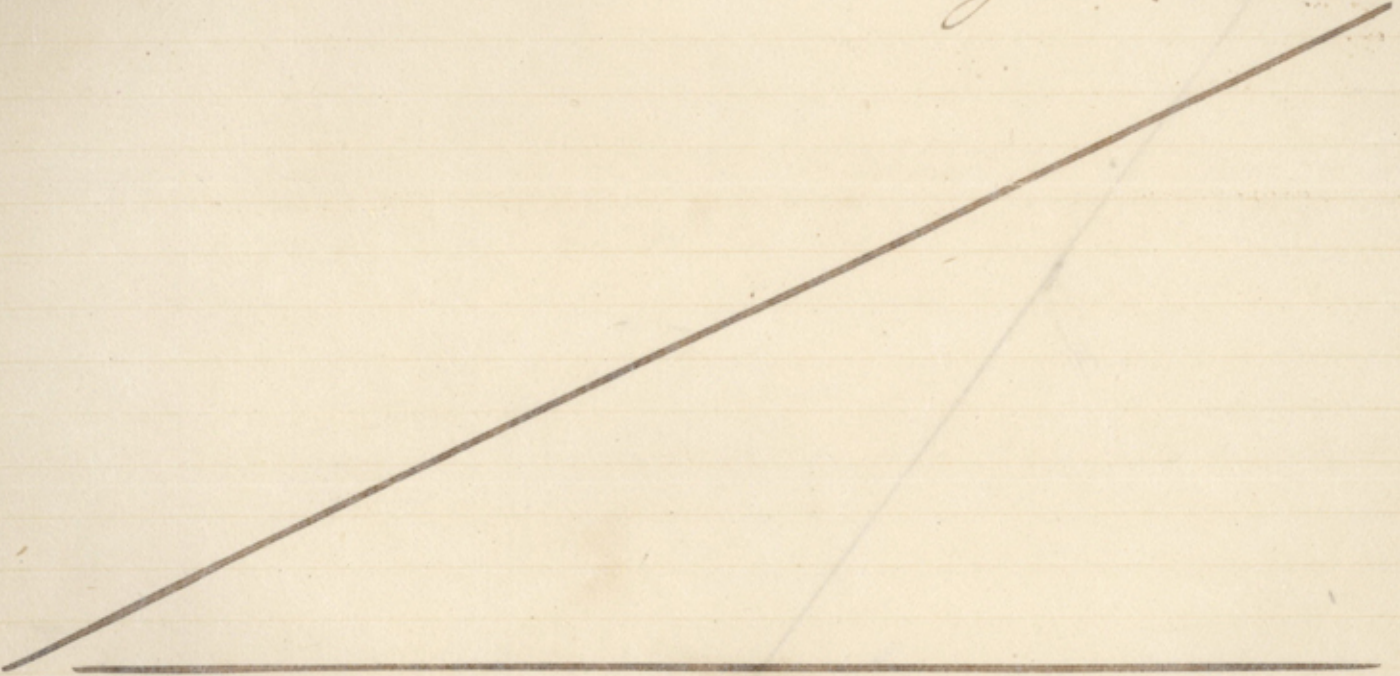

have Granted, Bargained, Sold and Conveyed, and by these presents do Grant, Bargain, Sell and Convey unto the said

Charles A. Lewis of the County of Roque

in the State of Texas all that certain Lot, Tract or Parcel of Land described as follows:

One hundred and seven acres situated in the County
of Roque and State of Texas on North Cedron Creek
about 10 miles East of Meridian, Beginning at the
South West corner of J. D. Rooney survey, a line oak with
A. bears S11W 8 varas and another marked V bears N75 1/2 W 70 1/2 varas.
Thence S30E eleven and one half (11 1/2) varas to South East corner
of E. C. Golden's survey.
Thence S60W Eight hundred & thirty five (835) varas to North East
corner of Newsham's survey for North West corner of this.
Thence S30E 306 1/2 varas to South West corner of this.
Thence N60E (930) thirteen hundred and thirty five varas
to South East corner of this.
Thence N30W Three hundred & eighteen (318) varas to North
East corner of this.
Thence S60W Eleven hundred (1100) varas to the place of
Beginning

Together with all and singular, the rights, members, hereditaments and appurtenances to the same belonging, or in anywise incident or appertaining.

To have and to hold, all and singular, the said premises unto the said Charles A. Lewis
his heirs and assigns forever. And I do hereby bind
myself my heirs, executors and administrators, to warrant and forever defend, all and singular the said
premises unto the said Charles A. Lewis his
heirs and assigns, against every person whomsoever lawfully claiming or to claim the same, or any part thereof.

Witness our hand, this 17th day of November A. D. 1894

J. A. Arnold
J. B. Arnold

The State of Texas, }

COUNTY OF Bosque }

BEFORE ME J. W. Gilpin, Notary Public

of the County of Bosque, in the State of Texas, on this day personally appeared L. A. Arnold

known to me, (or proved to me on the oath of _____) to be the person whose name is subscribed to the foregoing instrument, and acknowledged to me that he executed the same for the purposes and considerations therein expressed.

GIVEN UNDER MY HAND and Official Seal of office, this 31st day of August A. D. 1895
J. W. Gilpin Notary Public
Bosque County Texas

The State of Texas, }

COUNTY OF Bosque }

BEFORE ME J. W. Gilpin
a Notary Public

in and for Bosque County, Texas, on this day personally appeared J. E. Arnold
Arnold wife of L. A. Arnold

known to me _____ to be the person whose name is subscribed to the foregoing instrument, and having been examined by me privily and apart from her husband, and having the same fully explained to her, she, the said J. E. Arnold

_____ acknowledged such instrument to be her act and deed, and she declared that she had willingly signed the same for the purposes and consideration therein expressed, and that she did not wish to retract it.

GIVEN UNDER MY HAND and Seal of Office, this 31st day of August A. D. 1895
J. W. Gilpin
Notary Public
Bosque Co. Texas

The State of Texas, }

COUNTY OF Bosque }

I HEREBY CERTIFY that the foregoing instrument of writing, with its certificate of authentication, was filed for record in my office, on the 10th day of April A. D. 1897, at 1¹⁵ o'clock P M., and was duly recorded on the 17 day of April 1897, at 10²⁵ o'clock A M., in Volume 30, Page 482, of the Records of Deeds, etc., of said County.

WITNESS my hand and Official Seal at Office in Meridian
this 17th day of April A. D. 1897
C. W. Stewart

County Clerk Bosque County, Texas.
By J. L. Wiggins Deputy.

File 5601 4

Milam Prov

J. A. Arnold

To Transfer

Chas. A. Lewis

Filed May 4/1897

W. Wood

Chief Clerk

D. J. Smith

File Clerk

Chas. A. Lewis
Dallas, Texas

Total, \$
Recording, \$
Acknowledgment, \$

FEEES:
By.....Deputy
County Clerk

at.....o'clock M.
A. D. 1897
Filed for Record.....day of

Chas. A. Lewis

TO DEED. (No 119)

J. R. Smith

map 15607
 N. R. MORGAN,
 ATTORNEY-
 AT-LAW.....
 AND NOTARY PUBLIC.

Meridian, Texas,

Nov 11

1897

Hon A. J. Baker
 Austin Tex
 Dear Sir

Enclosed find Certificate of Mr Werke
 I know from actual knowledge that
 it is correct, as I surveyed out the
 General Law, and its N W Cor is about
 308 on S 30 E from the N. E. Cor of the
 Newchaffer, and the owner of the
 Newchaffer and E. R. Golden have
 it fixed that way.

This in answer to your late
 letter to C. A. Lewis touching
 variance of Patent to the J. A.
 Arnold Preemption survey

Yours or

N. R. Morgan

file and send
to draftsman

File both in
P-5601. Hill
11/12/97

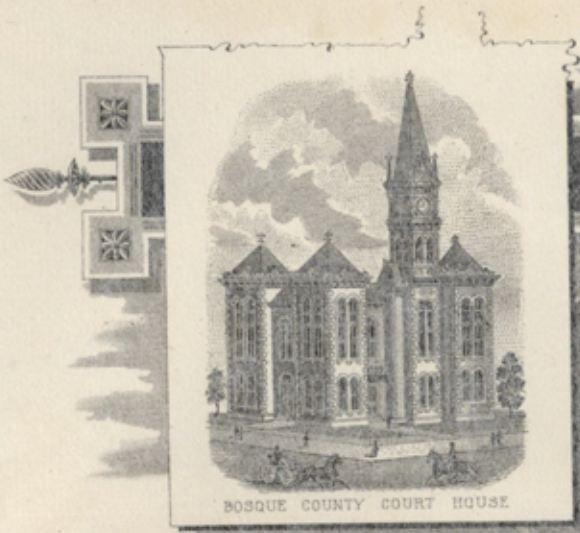

BOSQUE COUNTY.

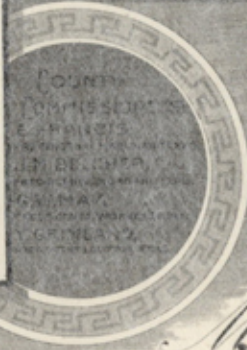

W. B. Thompson, County Judge
 C. W. Tidwell, Co. Clerk W. A. Boyd, Sheriff
 Robert Jones, Dist. Clerk J. A. Gillette, Co. Atty.
 H. W. Randal, Treasurer W. J. Powell, Collector
 L. C. M. Handless, Co. Assessor Willis Turner, Co. Surveyor

Meridian, Texas, _____ 1897

State of Texas 3
 County of Bosque 3
 I, James Weeks, Ex County Surveyor of Bosque County, Texas, do hereby certify that, the Newshafen is expressive of 62 acs, which is the cause of the J A Arnold Preemption Sur - The corners of Newshafen the Greenlaw - and the J D Looney are well defined and are on the ground - well known to me
 Nov 11th 1897

James Weeks
 Ex Co Sur

Sworn to and subscribed before me this 11th day of November 1897.

W R Morgan
 Notary Public for Bosque Co Tex

File 5601 ⁶

Milam Ore

J. A. Trivedi

Derry & Pettit

Dec 11/97

J. H. Rowell, Jr
Derry

[Faint, mostly illegible handwritten text, likely bleed-through from the reverse side of the page.]

N. R. MORGAN,

ATTORNEY-
AT-LAW.....
AND NOTARY PUBLIC.

Received as stated, \$5.00

NOV 21 1897

NOV 21 1897

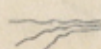

SPECIAL ATTENTION TO
LAND PRACTICE.

1120

Meridian, Texas, Nov 22 1897

Hon. A. J. Baker
Com. Gen. Land Office, Austin

Dear Sir

Enclosed please find
C. P. O. Money Order
Exp. in Austin for \$5.00 as
Patent Fee on J. A. Arnold
Presumption. Please issue and
forward to N. R. Morgan
Meridian Texas & oblige

Yours Very Respy
Chas. A. Lewis

File 5601

Buque, Co.

McLaurie

J. A. Arnold

Crawford

File No. 23/97

J. A. Arnold

File 10

RECORDED

INDEXED

[Faint, illegible handwriting on the lower half of the page]