

8/18/03.
a.

Basque Co

192

File 5420

abt 1193

Milam

PRE-EMPTION.

N. T. Hastings

6 1/2
94 Acres

Act May 26/73

Correct on map of Basque Co.
6/21/93

Corrected on map of Basque Co. showing
the true relative positions
of the survey lines
of the sketch must show.

Patented 8/11/03 Meridian

N 39° 00' E 38
Acres

by 1/1/1907 Robinson

Vol XVI Meridian Pat on Reg.

Ag. 26 4 1 6 other att vol 26

conf. 6/20/92

CONTENTS.

No. 1 Affidavit.

No. 2. Field Notes.

No. 3. Surveyors Cert.

No. 4. 5/14/92. Moses
4 Cor. Field Notes
5/30/98 Rowen

5. Cor. 7/notes
1/14/95 Moses.

6. Proof Occup 10/14/98

7 Cor 7/notes 11/8/1900

8 Cor 7/notes 5/2/1902

9 Cor sketch Campbell

10 Order for Pat 8/10/03

Roberts

line of G. C. ...

line of E. Gorse

7/10/91 J. H. ...

\$5.00 Sept 1/11/02

by G. W. Fairman

Meridian-Texas

money rec'd in off
1/3/02

Pat 9/23/02

Meridian

Meridian

AFFIDAVIT FOR PRE-EMPTION.

THE STATE OF TEXAS,

COUNTY OF BOSQUE.

Before me, *A. C. Clark* Clerk of the *Bosque* Court of Bosque

County, this day personally appeared *Nereid Kostings*

to me known, who after being by me duly sworn, upon his oath deposes and says: that he is now a bona fide settler upon _____ acres of Land, that he believes to be of

the public vacant lands of the State of Texas; that he is improving said land for a Homestead, and has no other; and further that he is a *married* man _____

and makes this Affidavit for the purpose of obtaining a Home. Said Land is situated in Bosque County, about *1 1/2* miles *SW* from Meridian, on the waters of *Muskey* Creek:

beginning *at the SW corner of the C. B. McPhail survey; thence South with the lines of the McPhail, S. B. Ry, Larew and Co. Hill surveys to Hamilton Co. line and around all the vacant land in along narrow strip not to exceed 160 acres South of the above named survey* and more particularly described by the accompanying field notes.

Given under my hand and the seal of the *County* Court of Bosque County, at office, in the Town of Meridian, this *2d* day of *April* A. D. *1892*

A. C. Clark
Clerk *Bosque* Court, Bosque County, Texas.

By *B. J. Mansby* Deputy.

1788
1303
1977

300
403
703

1 File ⁵⁴²⁰
~~3240~~
Milam Pre
N. J. Hastings
Affidavit
Filed May 13/92

No.

N. J. Hastings
Affidavit for re-emption.

ISSUED

the 2^d day of April 1892.

M. C. B. Co.

C. C. B. Co.

By *J. Mansby* Deputy.

M. Strickland, Stationer and Printer, Galveston.

Surveyed - 5th + 6th May - 92.



46-91-9
46-9-9
66-2-11

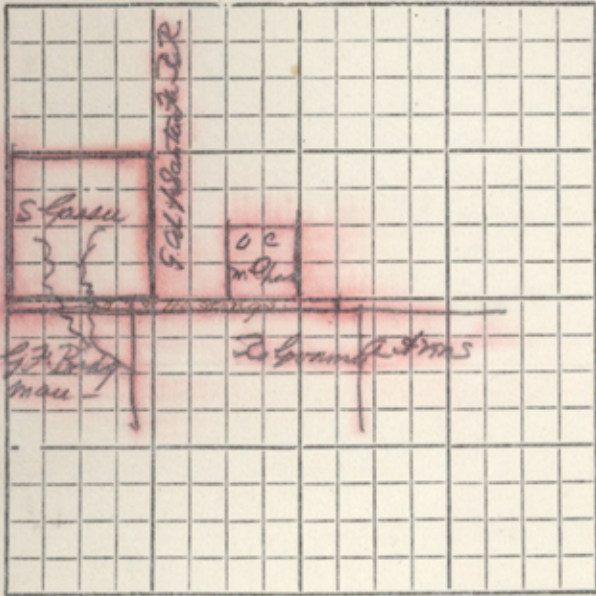

The State of Texas, } SURVEY.
 County. } No.

FIELD NOTES of a Survey of (94) Ninety
 Four Acres of Lands made for
 N. T. Hastings by virtue
 of his Affidavit for Preemp-
 tion before H. C. Cook, dated
 2nd April 1892.

Scale _____ Varas per inch.

Said Survey is No. _____, in Bosque County, Texas, situated on the waters of
Mustang R. a tributary of Meridian R. River, about 12 miles N^oW.
 of Meridian Beginning at 210⁰⁰ S^oW from the
N. E. Cor. of the Robert Grossman at a pile of
rocks from wh. a Spanish O. M. A. bears S^oW
300⁰⁰ Thence N^oW-300⁰⁰ to a corner on the
 mountain. Thence S^oW-passing S. W. Cor.
O. C. McPhail survey at 1077⁰⁰ 1483⁰⁰ S. W.
Cor. Gulf Col. Santa Fe R. R. Survey - 1780⁰⁰
 to a corner in S. line of Garsce survey
 Thence S^oE-300⁰⁰ to N. W. Cor. Robert
Grossman survey. Thence N^oE 1780⁰⁰

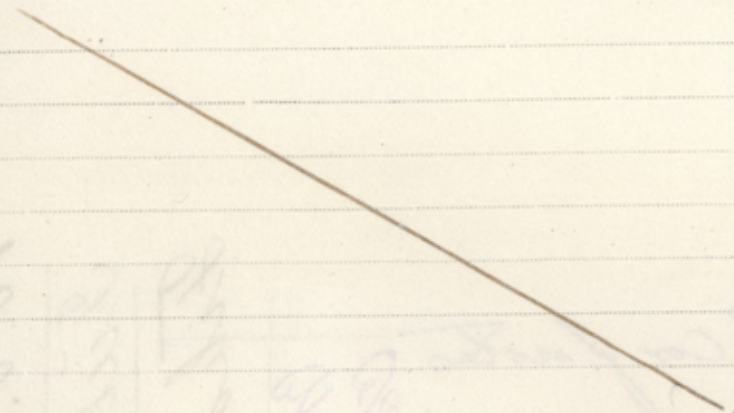

_____ to the place of beginning.

Bearings marked _____

Surveyed the 16th May 1892

J. J. Ferguson
Oscar Knuteson } Chain Carriers.

I, A. M. Dillard Co. Surveyor
 of Bosque County, Texas, do hereby certify that the foregoing described Survey was actually
 made by me on the ground, according to law, on the date and with the Chain Carriers aforesaid, duly qualified, and
 that all the corners, lines, boundaries and marks of the same, whether natural or artificial, are truly and correctly
 described and set forth in the foregoing Plat and Field Notes.

By _____ Deputy A. M. Dillard Co. Surveyor Bosque County, Texas.

Filed for Record the _____ day of _____ 1892 at _____ o'clock _____ M. A. M. Dillard Surveyor.

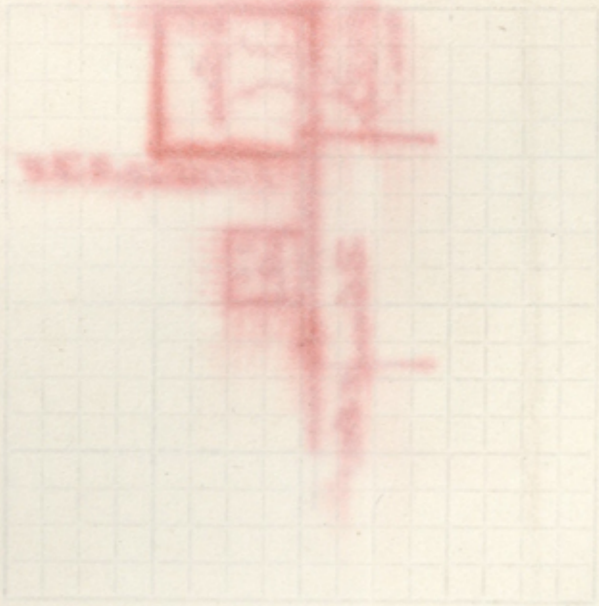

2 File 5420
Milam Pre
W. T. Hastings
Field Notes
Filed May 13/92

Wm Braullette
Chief Clerk

Cancelled by Cor of notes

Filing Fee Paid.
W. B. CROSS, Receiver,
GENERAL LAND OFFICE

5
File 2113
92

THE STATE OF TEXAS.

1024

W. B. THOMPSON, County Judge.
 H. C. COOKE, County Clerk.
 J. DANSBY, Deputy Clerk.
 F. P. SMITH, District Clerk.
 JOHN DYER, Tax Collector.
 WYATT McFADDEN, Tax Assessor.
 W. S. POWELL, County Treasurer.
 ROBT DONNELL, Sheriff.
 H. S. DILLARD, County Attorney.
 H. M. DILLARD, County Surveyor.

COUNTY COMMISSIONERS

R. B. HARRIS.
 C. V. OGDEN.
 W. G. FEAGIN.
 L. H. SCRUTCHFIELD.



Bosque Co.

Meridian Tex

189

Report of the Surveyor who located the
 W. F. Hastings preemption claim.

1st I found 1 orig. witness tree standing at N.W.
 Cor. Allison Arms or Saason, marked as such
 for in field notes & ran S 60° W - to N.W. Cor.
 Robert Grossman. 2nd located the S. line
 of the O.C. McPhail from N.W. Cor. which is
 well defined & of which there is no controversy
 Ran S 30° E - 950^{ms} found original Cor. as located
 - Continued this course S 30° E - 300^{ms} before striking
 N. line of Robert Grossman as just located
 This line, ^{N. line Robert Grossman} is now fenced upon correct line.
 The field notes of the G. Col. vs H. R. R. Survey
 call for its S.E. Cor. in N. line of the Robt.
 Grossman but this is a clear mistake as
 the same call, ^{in G. Col. field notes} is for the O.C. McPhail Cor.
 The witness tree at S.W. Cor. of Garsen are gone, but the
 N.E. Cor. of said Garsen is settled by Nat. Calls & is unques-
 tionable - From this Cor. S 30° E the distance gives out 146^{ms}
 before getting to a point S 60° W. of the McPhail Cor.

THE STATE OF TEXAS.

1024

W. B. THOMPSON, County Judge.
 H. C. COOKE, County Clerk.
 J. DANSBY, Deputy Clerk.
 F. P. SMITH, District Clerk.
 JOHN DYER, Tax Collector.
 WYATT McFADDEN, Tax Assessor.
 W. S. POWELL, County Treasurer.
 ROBT DONNELL, Sheriff.
 H. S. DILLARD, County Attorney.
 H. M. DILLARD, County Surveyor.

COUNTY COMMISSIONERS

R. B. HARRIS.
 C. V. OGDEN.
 W. G. FEAGIN.
 L. H. SCRUTCHFIELD.



Bosque Co.

Meridian Tex

189

but as there is an old pile of rock ⁴⁰³
 00. S 60° W of said McPhail, ^{the old cor. of C. S. Garses Survey} has it puts the
 corner in easy reach of Span. O. stumps we
 accepted it as ^{the} cor. Garses. This line (Garses) is also marked.
 Again - the intermediate distance between
 the Natural branch cuts on the Garses is
 the dif. between 1900⁰⁰ & 1410⁰⁰ = 490⁰⁰ & the
 distance between these same branches of Mustang
 on the N. line of the R. Gossman ^{see pr.}
 field notes again is the dif. between 1610 &
 1180 = 430⁰⁰ which is a mathematical
 demonstration of the impossibility of the
 2 lines being one & the same.

I certify that the above is a correct
 statement of facts as found by me on the
 ground - ^{Please put this with H. S. Hastings Survey -}
 sent by him.

H. M. Dillard
 Co. Surv. Bosque Co.

3 File 5420

Milam Ore

W. T. Hastings

Surveyors Cert.

Filed May 18/92

Wm Braullette
Chief Clerk

Report of
James Milam
Esq. Surveyor
in the case
of the
for the
of the
of the

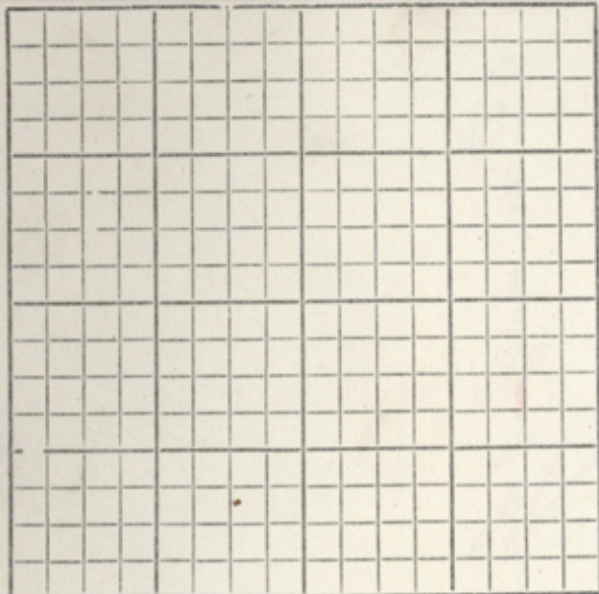

The State of Texas, } SURVEY

Boaque County, } No. _____

Corrected
FIELD NOTES of a Survey of *44 acres*

Lands, made for
N. J. Hastings a part
of the land to which
he is entitled by virtue
of his affidavit of occupancy
issued by Geo. H. Lee of
Boaque to April 2^d 1892

Scale _____ Varas per inch.

Said Survey is No. _____, in *Boaque* County, Texas, situated on the waters of

Mustang creek a tributary of *Miridian* ^{creek} River, about *1 1/2* miles *South*
of *Miridian* Beginning at *SW cor of O. C.*

McPhail sur a pile of stone and
Spanish *Merid X* *hrs* *N 16 W 3* *ms*
Thence *S 30 E 300* *ms* to pile of stone
for in *NB* line of *Potts* *Crossman*
for *SE* cor of this *Thence* *S 60 W*
836 *ms* to *NW* cor of said *Crossman*
Thence *N 30 E 300* *ms* to cor in *SB*
line of *G. L. S. F. No 1* - *Thence* *N 60 E 836* *ms*
to

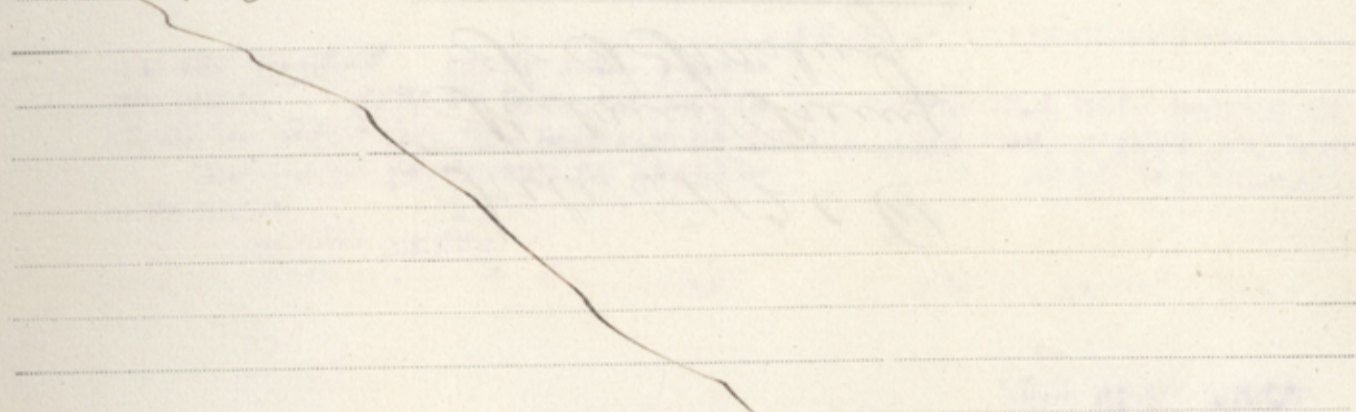

to the place of beginning.

Bearings marked _____

Re Surveyed *April 17th* 189 *3*

J. P. Robertson
W. J. Ferguson } Chain Carriers.

I, *James Weeks* Surveyor
of *Boaque* County, Texas, do hereby certify that the foregoing described Survey was actually
made by me on the ground, according to law, on the date and with the Chain Carriers aforesaid, duly qualified, and
that all the corners, lines, boundaries and marks of the same, whether natural or artificial, are truly and correctly
described and set forth in the foregoing Plat and Field Notes.

Recorded Book *No 6-1395*
By _____ Deputy Surveyor *James Weeks* *Boaque* County, Texas.

Filed for Record the _____ day of _____ 189 _____ }
at _____ o'clock _____ M. }

Surveyor.

File 5420 4

Milam Pump
N T Hastings

Cor. Field Stone
Filed 5/30/1892

McEvoy
Bluff Creek

Cancelled by Cor of no

5420

State of Texas, corrected field
Booque County 3 notes of 60³/₁₀ acres
of land made for
N. J. Hastings it being a part
of the land to which he is entitled
by virtue of his affidavit of occu-
pancy issued by H. C. Cooke Co. Clk
of Booque Co. Texas on 2^d day
of April 1892.

Said survey is situated in Booque
Co. Texas on the waters of Mustang Creek
a tributary of Meridian Creek about
7¹/₂ miles S. 62^o W. from Meridian
Begin at SW cor. of F. N. Heflin
on N. B. line of R. C. Crossman, run a pile
of stone for S. E. cor. of this. Thence
N 30 W 300 us to cor. in S. B. line of
of Cal. McPhail run. Thence
S 40 W - 320 us passes original
cor. of said McPhail, 1150 us to
cor. in S. B. line of G. C. & S. F. Ry
Co. No 1 a pile of stone for cor. Thence
S 20 W - 300 us to NW cor. of said Robt
Crossman, Thence N 60 E 1150 us
to place of beginning

Surveyed Nov 29th 1894

J. P. Rodulson }
W. J. Ferguson } C

I James S. Weeks Co
surveyor of Booque Co. Texas do here by
certify that the above survey was made
on the ground according to law
with qualified chain carriers &c
Recorded B-8806-p 414

James Weeks
C. S. B. C. J.

5
File 5420
Milam Co.
W. T. Hastings
Cor. F / notes
Filed Jan'y. 7. 95
Weyns

Check.

Corrected on Map
of Basque Co for 61 $\frac{3}{10}$
Acres
1/25000/00000

Dated 8/11/03 Wick

6
7
8
9
10
11
12
13
14
15
16
17
18
19
20
21
22
23
24
25
26
27
28
29
30
31
32
33
34
35
36
37
38
39
40
41
42
43
44
45
46
47
48
49
50
51
52
53
54
55
56
57
58
59
60
61
62
63
64
65
66
67
68
69
70
71
72
73
74
75
76
77
78
79
80
81
82
83
84
85
86
87
88
89
90
91
92
93
94
95
96
97
98
99
100

Total

PROOF OF SETTLEMENT UNDER HOMESTEAD ACT.

THE STATE OF TEXAS,)

County of Bosque

BEFORE ME, the undersigned, County Clerk in and for the County aforesaid, this day came and personally appeared N. J. Hastings, a resident citizen of said county, who being by me duly sworn, declares that he is a *bono fide* settler upon 6.7 acres of vacant public land, situated in said county, and surveyed for N. J. Hastings on the 29th day of Nov 1894, by J. N. Shanks County surveyor of said county; that he has occupied and improved the same as a Homestead for a period of three consecutive years, beginning on the 2nd day of April 1892, that he is 21 years of age, and that he makes this affidavit for the purpose of obtaining a title the same for a Homestead, under "An act for the Benefit of Actual Occupants of the Public Lands," approved May 26th, 1873, and Acts prior thereto; and that he has not a Homestead other than the above.

And also at the same time came and personally appeared George Knudson and J. N. Hastings, two credible resident citizens of said county, to me well known, who being sworn, depose and say that N. J. Hastings the person first above named in this affidavit, has actually settled upon and cultivated as a Homestead the land surveyed for him on the 29th day of Nov 1894, by the surveyor aforesaid, for the period of three years, and they nor either of them have any interest in the said land.

N. J. Hastings
G. A. Knudson
J. N. Hastings

Sworn to and subscribed before me, and I hereby certify that G. A. Knudson and J. N. Hastings are credible and trustworthy citizens of said county.

IN TESTIMONY WHEREOF, I have hereunto set my hand and affixed the seal of said county, at office, this 30th day of Sept 1898

C. W. Tidwell
Clerk of County Court Bosque Co. Texas

File 5420
Museum Ore
N. T. Hastings
Proof Occup.
Filed Oct. 19/98
J. H. Rowce
J. C.

P. O. Granite Bay
Boson & Co

=====

OF SETTLEMENT OF LAND

PROOF

=====

STATE OF TEXAS, Meridian, Texas.

=====

Settler. _____

=====

[Faint handwritten notes, possibly bleed-through from the reverse side of the page]

Corrected field notes of
M. T. Hastings

5720

State of Texas } Corrected field notes of 60 acres of land
Bosque County } made for M. T. Hastings, it being a
part of the land to which he is entitled by virtue of his
Affidavit of occupancy made before H. C. Cook Co. Clerk
of Bosque Co. on the 2nd day of April 1892 -

Said land is situated in Bosque Co. Texas on the waters
of Mustang Creek a tributary of Mesquite Creek, about
12 miles S 60th from Mesquite: Beginning at the S. N.
corner of F. N. Heflin survey in N. B. line of Robert
Crossman survey a pile of stone for S. E. corner of
this: Thence N 30th W 300 varas to corner in S. B. line
of O. C. McPhail; Thence S 60th W 320 varas passing
S. N. corner of McPhail - 1156 varas to corner in S.
B. line of Lemore Garrell survey; Thence S 30th E 300 varas
to Robert Crossman's N. N. corner; Thence N 60th E 1156
varas to place of beginning.

I, G. W. Turner County Surveyor of Bosque County Texas
do hereby certify that I have examined the foregoing field
notes, and find them correct: and that they are recorded in
my office in Book No. 6 page 417

G. W. Turner

County Surveyor of Bosque Co. Tex.

This the 4th day of Nov. 1901

(7)

File No 5420

Mil Preemption

School Land.

N.J. Hastings

Cor F. Notes

Filed 11/8 1901

CHARLES ROGAN,
Com'r.

J.O. Coupland
File Clerk.

Cancelled by Cor et N.
12-8-1901

Corrected field notes
of 2.60 acre
Survey made for
M. J. Hastings

R 111
10-21-11
for 61 1/2 acres 11-12-11

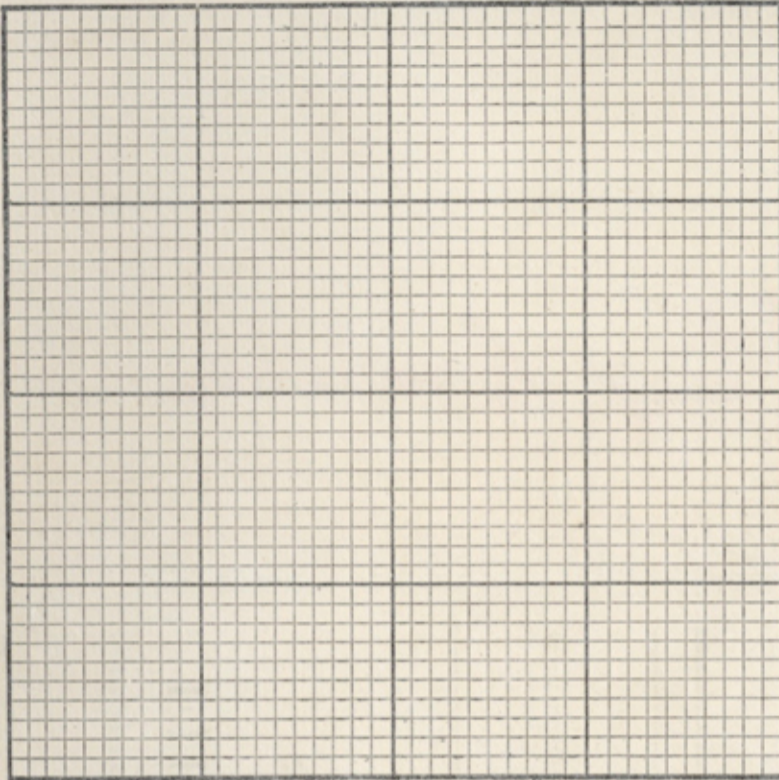

THE STATE OF TEXAS, } Survey

County of Bosque } No.

FIELD NOTES of a Survey of 44³⁰/₁₀

Acres of Land made for

M. T. Hastings
a part of the land to which he
is entitled by virtue of his affidavit
of Preemption by made before H. C.
Loake County Clerk of Bosque Co.
dated 2nd April 1892

Scale Varas per Inch. Variation 9 1/2

Said Survey is No. in Bosque County, Texas, situated on the
waters of Mustang Creek a tributary of Meridian Creek River,
about 4 1/4 miles S 62³⁰ W of Meridian

BEGINNING at the original S. W. corner of the O. C. McPhall survey and old
pile of rocks from which a Spanish oak stump bears N 16 1/2 W 3 varas
Thence S 30 E with the West line of the F. M. Hefflin survey 300 varas
to the S. E. corner of this in the North line of the Robert Crossman
survey; Thence S 60 W with the North line of said Crossman survey
835 varas to an old pile of rocks for the N. W. corner of said
Crossman survey; Thence N 30 W 300 varas to the North West corner
of this in the South line of the Demore Garsee survey on top of a
mountain; Thence N 60 E with the South line of said Garsee
and G. C. & S. F. R.R. No. 1 surveys 835 varas to the place of



to the place of beginning.

Bearings marked

Surveyed Nov. 30 1887

J. J. Pison

N. J. Hastings

Chain Carriers

I, G. H. Tanner

County Surveyor of Brazos County, Texas,

do hereby certify that the foregoing described Survey was actually made by me on the ground, according to law, on the date and with the Chain Carriers aforesaid, duly qualified, and that all the Corners, Lines, Boundaries and Marks of the same, whether natural or artificial, are truly and correctly described and set forth in the foregoing Plat and field Notes.

G. H. Tanner

By Deputy

County Surveyor Brazos

County, Texas.

Filed for Record the 29 day of Nov

1887, at 4 o'clock P. M., and duly Recorded

the 29 day of Dec

1887 Book No. 6 Page 418

G. H. Tanner

SURVEYOR

FIELD NOTES OF A SURVEY MADE FOR

No.

E 541*

Surveyor

County, Texas

Clarke & Courts, Stationers, Galveston. 6-95-9-1154

File No. 5420
Mil Preemption
N. J. Hastings
Cor. F. / notes
Filed 1/2 1892
CHARLES ROGAN,
Com.
J. Daupland
File Clerk.

Cancelled by Prior Cor. F. N.
1/29/02/Comm

8/29/02 Comm.

Scale 400 varas = 1 inch

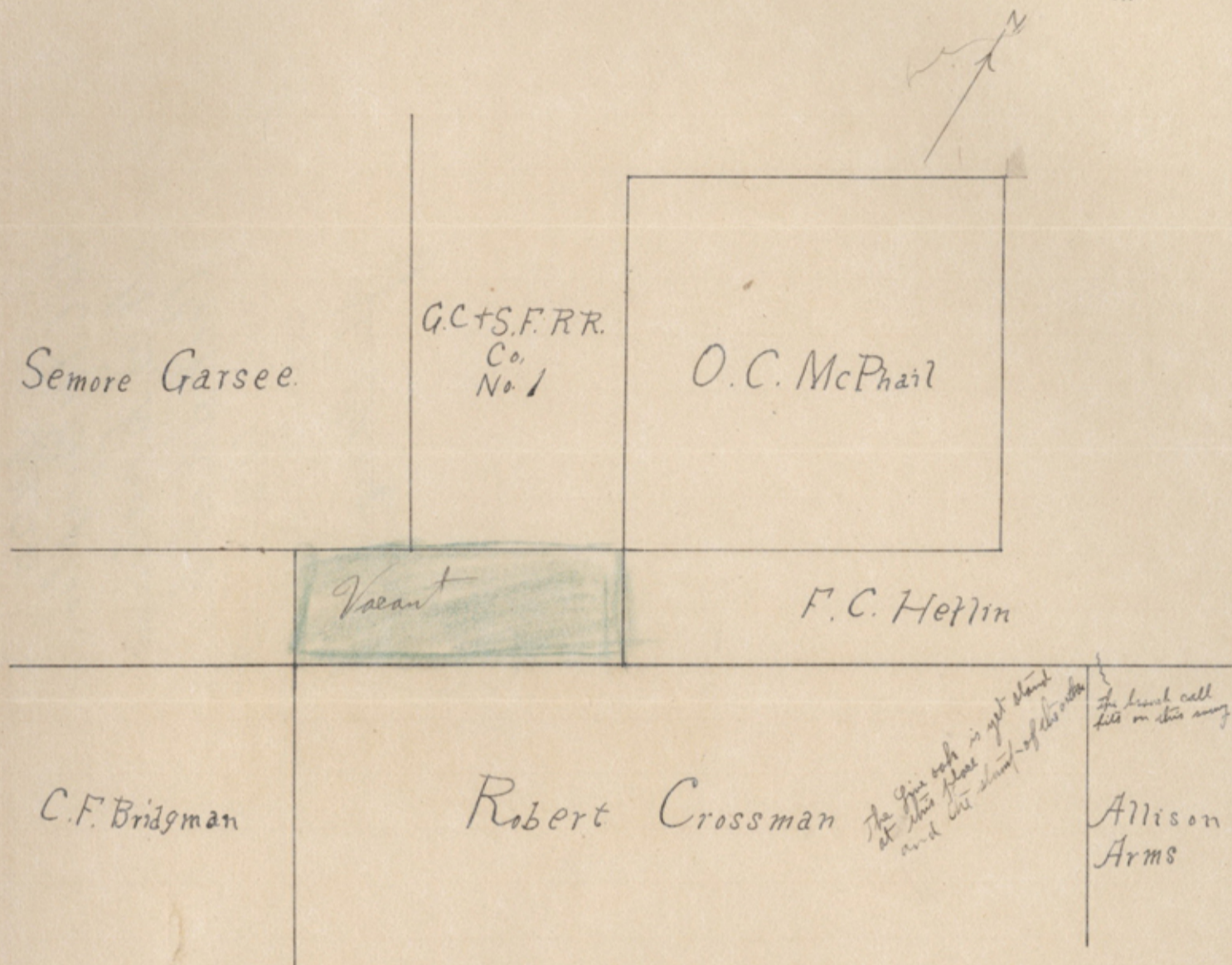

This is to certify that J. G. H. Turner the County Surveyor of Bosque County Texas did on the 30th day of December A. D. 1892, go on the ground and make a survey of the North line of the Robert Crossman and South lines of the G. C. + S. F. R. R. Co. No. 1 and Semore Garsee survey.

I begin at the N. E. corner of the Robert Crossman and the Allison Arms N. W. corner from which one of the live oaks is yet standing as called for in the field notes of the said Crossman and Arms survey N 40° 44' marked J. The stump of the other was found as called for. Also the branch on the North line of the said Arms survey fits the call N 60° E 20 varas

We ran thence S 60° W at 1165 varas a branch 2000 varas to the N. W. corner of said Crossman and N. E. corner of said Bridgman survey at a point N 30° W from the established S. W. and S. E. corners of said survey; thence N 30° W 300 varas to the South line of the Semore Garsee survey; thence N 60° E passing the S. E. corner of the said Garsee and S. W. corner of the G. C. + S. F. R. R. Co. No. 1 survey at 835 varas to the S. E. corner of said G. C. + S. F. R. R. Co. No. 1 survey and the S. W. corner of the O. C. McPhail survey from which we found the old rock pile and the stump of the Spanish oak which bears N 16 1/2° W 3 varas.

J. G. H. Turner
Co. Surveyor of Bosque Co. Tex.

(9)

File No. 5420
Mil. Pre-emption
N. T. Hastings
Cert. Sketch
Filed 1/2 1902
CHARLES ROGAN,
Com'r.
J. O. Campbell
File Clerk.

GEO. P. ROBERTSON,
ATTORNEY AT LAW
NOTARY IN OFFICE

THE ONLY COMPLETE ABSTRACT BOOKS IN BOSQUE COUNTY
ABSTRACTS PREPARED ON SHORT NOTICE

BUY AND SELL LANDS, RENDER AND PAY
TAXES. PROPERTIES TAKEN FULL
CHARGE OF FOR NON-RESIDENTS

BOSQUE COUNTY LAND AND ABSTRACT Co.

INCORPORATED

R. S. ROBERTSON, ABTRACTER

SPECIAL INDUCEMENTS OFFERED ACTUAL SETTLERS ON LONG TIME WITH SMALL ANNUAL PAYMENTS

—
MERIDIAN, TEXAS.

July 31st, 1903

To the Commissioner of the General Land Office of Texas,
Austin, Texas

Dear Sir:-

Mr. R. S. Robertson of Meridian, Texas, is fully authorized
by me to apply for and receive my patent from your office and you
can consider this as your authority for delivering said patent to
him and oblige, Yours very truly,

N. J. Hastings

File No. 5420

Bosque County,

W P Hastings

Order for Pat

8-10-1903
J P Robinson
Acty Com'r

W P Rowlett

File Clerk

him and office. Yours very truly,

can consider and as your authority for delivering said patent to
by me to apply for and receive my patent from your office and you

Mr. H. S. Robertson of Meridian, Texas, in fully authorized

Dear Sir:-
Austin, Texas,

To the Commissioner of the General Land Office of Texas,

MERIDIAN, TEXAS

July 21st, 1903.

ROBERTSON & COMPANY

ROBERTSON & COMPANY

ROBERTSON & COMPANY

ROBERTSON & COMPANY