

Bosque County.

File

5310. <sup>90</sup>

Ab-1175

MILAM PRE-EMPTION.

J. M. Pittman

106 1/4 abt-1175-  
160 acres

Dtd Dec 17-

B. Co

Act

Chas G. Pittman

see 4493 Milan Pre-emption  
of abandoned tract of Milam Co.

Covers J. J. Raspberry E 4995 otherwise correct  
according to Surveyor's within certificate, and  
map of **Bosque Co**

P. 4493 no mistake 4/25/93  
Chas G. Pittman

Or to J. A. Holmes assy.  
Pat. to J. A. Holmes assy.

5/2/93 Braullette  
Chas G. Pittman

Correction to  
491 Baylor Patent 3/29/93

97-424 Vol 256 Compton  
otherwise correct 2/24/93

mkd Pld by Cor. 9 for 1524  
10/10/93

Mgt.

25042 30 AM 2  
91  
Act 14

CONTENTS.

- No. 1. Affidavit. n/r.
- No. 2. Field Notes, & Sketch
- No. 3. Cert of Occupancy
- No. 4. 8/23/90 Deeds
- 3. Cor of notes
- 4 cor 5/26/91 Guibry
- 5 Transfer 3/20/93
- 6 Surveyor's statement  
4/19/93 Beaver

75<sup>00</sup> def Nov 27/892  
by J. M. Pittman  
Meridian  
Texas

4/8/91  
Nov 11/90  
J. N. Weeks  
Meridian

11/11/90  
11/11/90

J. B. Weeks, Surveyor,

BOSQUE COUNTY.

Meridian, Texas, 18



The State of Texas 2 Field notes of  
County of Bosque 3 160 acres of land  
D Made for J. M. Pittman the  
quantity of land to which he is entitled by virtue  
of his certificate of occupancy issued by  
H. C. Cooke Co. Clerk of Bosque Co. of  
Texas on the 19<sup>th</sup> day of June 1888  
Situated in Bosque County Texas, on  
the waters of Bosque river, about 8 miles  
N45W from Meridian.

Beginning at NW cor of McKinney and Williams  
Truce No. 1152, run to the SW cor of the  
Minafer tract. Thence N30W. 1647. run to cor  
in West line of Hollingsworth sur  
Thence S60W 238 run to cor. in E. B. line of  
Lynch survey. Thence S30E 987 run to cor  
Thence S60W 914. run to cor. in E. B. line of  
Geo Hodge. Thence S30E. 560 run to place  
of beginning  
Surveyed June 20<sup>th</sup> 1888

Geo. Gary 2c  
John Holmes 3c

James Weeks  
C. S. B. C. S.

State of Texas 2  
County of Bosque 3  
I James Weeks  
Co. Surveyor of Bosque Co. Texas do  
here by certify that the foregoing plot  
and field notes are correct and  
made according to law, and recorded  
in Book No. 6, p. 355, Records of Bosque Co.  
Texas

Aug 21<sup>st</sup> 1890

James Weeks  
C. S. B. C. S.

1 Price 5310.

Milam Preempt

J. M. Pittman

Spots

Price Aug 23/90.

R. P. Shelley  
CHIEF CLERK

Don't close by 1000
2nd call 230 W 1647
3rd call 530 E 987
6th " " 560 / 1547
100

Aug 20/90  
JMW

## Proof of Settlement under Homestead Act.

The State of Texas,  
County of Bosque

Before me, the undersigned H. C. Cook, County Clerk in and for the County aforesaid, this day came and personally appeared J. M. Pittman a resident citizen of said County, who being by me duly sworn, declares that he is a *bona fide* settler upon 160 acres of vacant public land, situated in said County, and surveyed for J. M. Pittman on the 20<sup>th</sup> day of June 1888 by Jas. N. Weeks a Surveyor of said County; that he has occupied and improved the same as a Homestead for a period of three consecutive years, beginning on the 1<sup>st</sup> day of June 1884 that he is a married man and that he makes affidavit for the purpose of obtaining a title to the same for a Homestead, under an Act supplementary to "An Act for the Benefit of Actual Occupants of the Public Lands," approved May 26th, 1873, and Acts prior thereto; and that he has not a Homestead other than the above.

AND also at the same time came and personally appeared J. A. Dundy and N. C. Brummett two credible resident citizens of said County, to me well known, who being duly sworn, depose and say that J. M. Pittman the person first above named in this Affidavit; has actually settled upon and cultivated as a Homestead, the land surveyed for him on the 20<sup>th</sup> day of June 1888 by the Surveyor aforesaid, for the period of three years, and they nor either of them have any interest in the said land.

J. M. Pittman  
J. A. Dundy  
N. C. Brummett

SWORN TO and subscribed before me, and I hereby certify that J. M. Pittman J. A. Dundy and N. C. Brummett are credible and trustworthy citizens of said County.

IN TESTIMONY WHEREOF, I have hereunto set my hand and affixed the Seal of said County, at office, this 5<sup>th</sup> day of Aug. 1890

H. C. Cook  
Clerk County Court Bosque Co.

PROOF OF  
SETTLEMENT OF LAND

*J. M. Pittman*

Settler.

②  
File 5310.  
Milam Precinct  
J. M. Pittman  
Cert of  
Occupancy  
Filed Aug 23/90.

*P. J. Sherry*  
CHIEF CLERK

FILING FEE PAID.

G. H. HOLLINGSWORTH,

Recorder S. L. C.

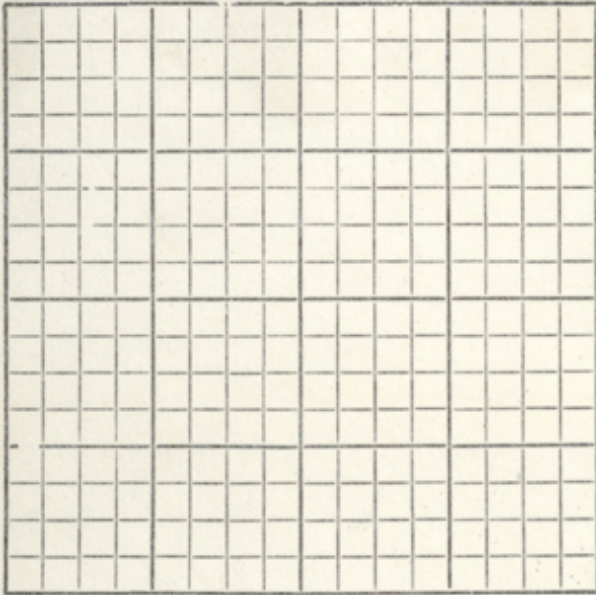

The State of Texas, } SURVEY  
Bosque County. } No. \_\_\_\_\_

FIELD NOTES of a Survey of *One hundred and sixty acres of* Lands, made for

~~J. M. Pittman~~  
*J. M. Pittman*  
The amount of land to which he is entitled by virtue of his certificate of occupancy issued by H.C. Cook County Clerk Bosque County, Texas. June 19<sup>th</sup> 1888.

Scale \_\_\_\_\_ Varas per inch.

Said Survey is No. \_\_\_\_\_, in *Bosque* County, Texas, situated on the waters of \_\_\_\_\_ a tributary of *Bosque* River, about *8* miles *NW* of *Mission* Beginning at *the NW. corner of*

*a survey made in the name of McKinney & Williams. Thence N 60 E 1168 varas to S.W. corner of Mrs Mumfey's pre-emption survey thence N 30 W 1036 varas to Mrs Mumfey's NW corner. for N.E. corner of this. Thence S 60 W 238 varas to corner in E.B. line of M. Frank's pre-emption thence S 30 E 376 varas to S.E. corner of said Frank's. Thence S 60 W 930 varas to Frank's S.W. corner in E.B. line of George Hodge survey. Thence S 30 E 660 varas*

\_\_\_\_\_ to the place of beginning.

Bearings marked \_\_\_\_\_

Surveyed *May 27* 189*1*

} Chain Carriers.

I, *James M. Wicks* Ex-Surveyor of *Bosque* County, Texas, do hereby certify that the foregoing described Survey was actually made by me on the ground, according to law, on the date and with the Chain Carriers aforesaid, duly qualified, and that all the corners, lines, boundaries and marks of the same, whether natural or artificial, are truly and correctly described and set forth in the foregoing Plat and Field Notes. *having first located said survey on ground when was Co Surveyor*

By \_\_\_\_\_ Deputy \_\_\_\_\_ Surveyor \_\_\_\_\_ County, Texas.

Filed for Record the \_\_\_\_\_ day of \_\_\_\_\_ 189 \_\_\_\_\_ at \_\_\_\_\_ o'clock \_\_\_\_\_ M.

*James M. Wicks* Ex-Surveyor.

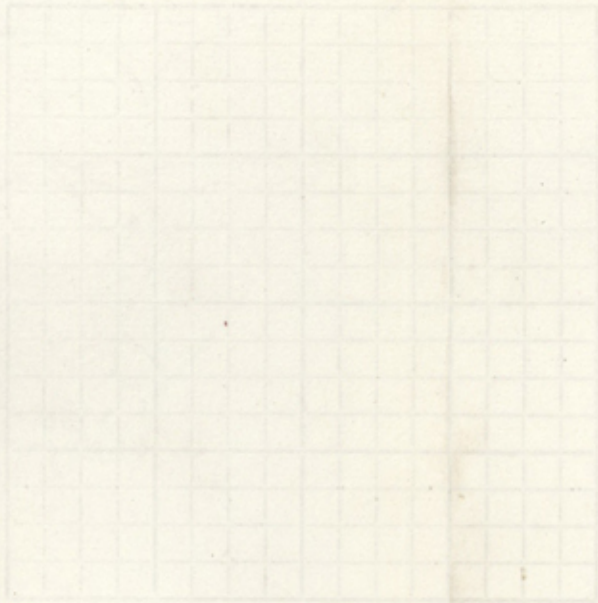

S.W. corner of Mrs. M.A. Menefee's survey, is 1197 rrs while these field-notes make said <sup>distance</sup> 1168 rrs. Explanation required.

8/12/91 C.W. Tate

3) File 5310

Orilau Pre  
J. M. Pittman  
Cor of notes  
Filed May 23/91

(Covers preemption survey in name of J. J. Ashberry. Also surveyor should show how he identified the S.W. corner of M. P. Frank's survey. By the calls in said Frank's field-notes the distance from Hollingsworth's S.W. corner to Frank's S.E. corner is 502 rrs instead of 367 rrs as these field notes declare.

Because, if aforesaid distance is greater than 367 rrs this survey will conflict with said Frank. Finally, by calculation the distance from N.W. corner of M. Kinney & Williams' survey to

over

of for 152 <sup>4</sup>/<sub>10</sub> 1000  
5  
30 1000  
91



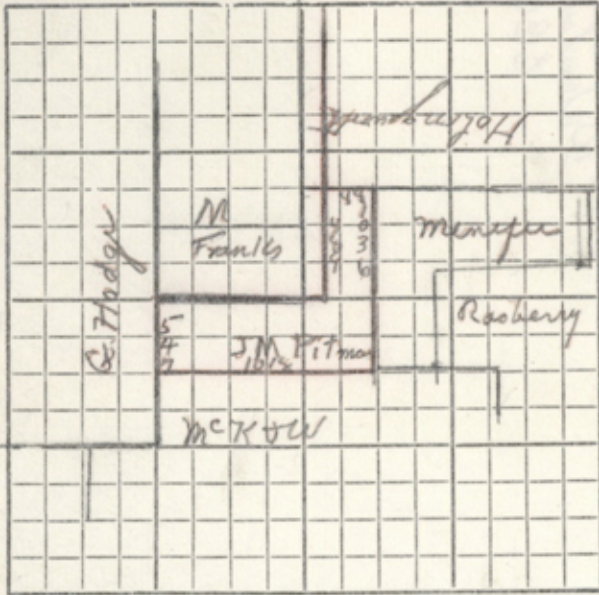

The State of Texas, } SURVEY  
 }  
 } Boaque County. } No. \_\_\_\_\_  
 } Corrected

FIELD NOTES of a Survey of

10674 acres of Lands, made for  
 M. Pitman the land  
 to which he is entitled by  
 virtue of his affidavit of  
 occupancy issued by  
 Co. Clerk of Boaque Co.  
 Tex on the 19th June 1888

Scale \_\_\_\_\_ Varas per inch.

Said Survey is No. \_\_\_\_\_, in Boaque County, Texas, situated on the waters of

a tributary of Boaque River, about 8 7/8 miles N 75 W

of Meridian Beginning at SW cor of M A  
Minnifer Pr in S 3 B line of Hollingworth  
Survey Thence S 60 W 88 us to SW cor of  
said Hollingworth in E B line of M P Frank's  
Survey Thence S 30 E 489 us to SE cor  
of said Frank's sur Thence S 60 W 930 us  
to NW cor in E B line of Geo Hodge  
sur it being the SW cor said M.P. Frank's  
Thence S 30 E 547 us to NW cor of McKim  
& Williams for SW cor of this Thence N 60 W  
1018 us to SW cor of said Mrs M A  
Minnifer, a pile of rocks for cor  
 Thence N 30 W 1036 us completing

to the place of beginning.

Bearings marked \_\_\_\_\_

Resurveyed March 9<sup>th</sup> 1893

James Harris  
John Pitman } Chain Carriers.

I, James Weeks Surveyor  
 of Boaque County, Texas, do hereby certify that the foregoing described Survey was actually  
 made by me on the ground, according to law, on the date and with the Chain Carriers aforesaid, duly qualified, and  
 that all the corners, lines, boundaries and marks of the same, whether natural or artificial, are truly and correctly  
 described and set forth in the foregoing Plat and Field Notes.

Recorded in  
 by Book No. 6 p. 372 Deputy

James Weeks  
 Surveyor Boaque County, Texas.

Filed for Record the \_\_\_\_\_ day of \_\_\_\_\_ 189 }  
 at \_\_\_\_\_ o'clock \_\_\_\_\_ M. }

Surveyor.

4 Pile 5310  
Milam Precip  
J M Pittman  
cor F. Notes  
Filed March 18/93  
W. L. Mezaughy  
Comm

Covers J. J. Raspberry P. 4498; otherwise  
according to Surveyors certificate with  
in correct on map of Bosque Co.

4/25/93  
E. W. State

Patented 5/29/93  
E. C. Compton

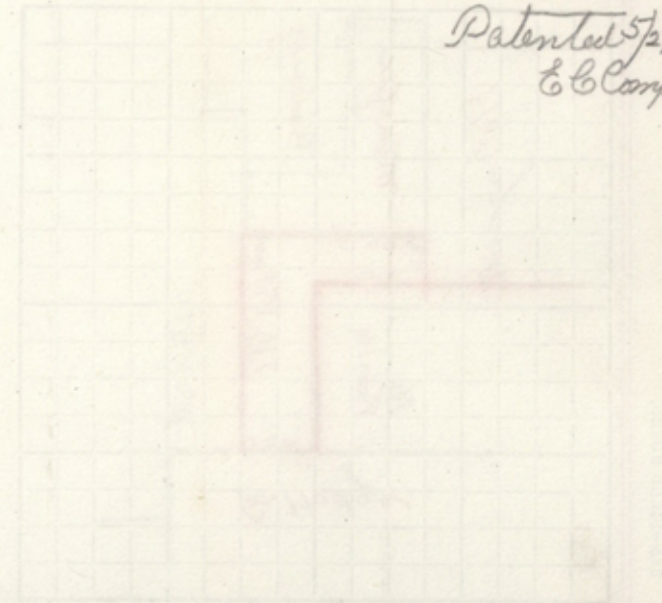

C. C. Mar. 27/93 E. W. State

**The State of Texas,**

County of Bexar

Know all Men by these Presents:

That we, J. M. Pittman and wife  
L E Pittmanof the County of Bexar State of Texas, for and in consideration  
of the sum of Three Hundred and Fifty  
(\$ 350<sup>00</sup>) Dollars.

to us in hand paid by

J. A. Holmes

the receipt

of which is hereby acknowledged

have Granted, Sold and Conveyed, and by these presents do Grant, Sell and Convey,  
unto the said J A Holmesof the County of Bexar State of Texas, all that certain  
tract or parcel of land the same  
being a survey originally in the  
name of J J Ramsey and after-  
wards resurveyed for the said J. M.  
Pittman and not yet patented  
situated about seven miles North-  
West of the town of Meridian

in Bosque County Texas. said sur-  
vey adjoining the W.P. Frank survey  
on the South. the M.A. Wampler  
survey on the West and the  
McKinney & Williams survey  
on the North and this deed  
conveys all the right title and  
interest which we have in and  
to said land acquired by  
us by virtue of our Prescription  
and Homestead rights - Hereto.  
subject to be Patented by the  
state

To have and to hold the above described premises, together with all and singular  
the rights and appurtenances thereto in anywise belonging, unto the said

J A Holmes

his

heirs and assigns forever; and We do hereby bind our heirs, executors  
and administrators, to Warrant and Forever Defend, all and singular the  
said premises unto the said

J A Holmes

his

heirs and assigns, against every  
person whomsoever lawfully claiming or to claim the same or any part thereof.

Witness our hands at Mendota this 23 day of January D. 1893

J M Pittman

L E Pittman

Witnesses at Request of Grantor:

The State of Texas

County of Bosque

a Notary Public

Bosque

Before me, N R Morgan

in and for

Bosque County, Texas, on this day personally appeared

J M Pittman

Known to me

to be the person whose name is subscribed to the foregoing instrument, and acknowledged to me that he executed the same for the purposes and consideration therein expressed.

Given under my hand and seal of office, this 9 day of March, D. 1893

N R Morgan

Notary Public Bosque Co Tex

The State of Texas

County of Bosque

a Notary Public

Bosque

Before me, N R Morgan

in and for

Bosque County, Texas, on this day personally appeared

Mrs L E Pittman

wife of

J M Pittman

Known to me

to be the person whose name is subscribed to the foregoing instrument, and having been examined by me, privily and apart from her husband, and having the same fully explained to her, she the said Mrs L E Pittman acknowledged such instrument to be her act and deed, and declared that she had willingly signed the same for the purposes and consideration therein expressed, and that she did not wish to retract it.

Given under my hand and seal of office, this 9 day of March, D. 1893

N R Morgan

Notary Public Bosque Co Texas

The State of Texas

County of \_\_\_\_\_

I, \_\_\_\_\_

Clerk of the County Court of said County, do hereby certify that the foregoing instrument of writing, dated on the \_\_\_\_\_ day of \_\_\_\_\_ A.D. 18\_\_\_\_, with its

Certificate of Authentication, was filed for record in my office this \_\_\_\_\_ day of \_\_\_\_\_ A.D. 18\_\_\_\_, at \_\_\_\_\_ o'clock \_\_\_\_\_ M., and duly recorded the

\_\_\_\_\_ day of \_\_\_\_\_ A.D. 18\_\_\_\_, at \_\_\_\_\_ o'clock \_\_\_\_\_ M., in the Deed Records of said County, in Volume \_\_\_\_\_ on pages \_\_\_\_\_

Witness my hand and the seal of the County Court of said County, at office in \_\_\_\_\_ the day and year last above written.

Clerk.

County Court,

County, Texas.

By \_\_\_\_\_

Deputy

6 File 5310  
Milam Precinct  
J. M. Pittman  
Do of Transfer  
J. A. Holmes  
Filed March 17/93  
W. L. McGeoughy  
Clerk

E 589

# Mortgage Deed

WITH JOINT ACKNOWLEDGMENT

J. M. Pittman  
Wife L. E. Pittman  
To  
J. A. Holmes

Filed for Record this the \_\_\_\_\_ day of  
\_\_\_\_\_ A. D. 18\_\_ at \_\_\_\_\_  
o'clock \_\_\_\_\_ M

\_\_\_\_\_  
County Clerk  
By \_\_\_\_\_  
Deputy

Recorded \_\_\_\_\_ A. D. 18\_\_  
in \_\_\_\_\_ County Record  
of \_\_\_\_\_ Book \_\_\_\_\_  
Page \_\_\_\_\_

\_\_\_\_\_  
County Clerk  
By \_\_\_\_\_  
Deputy

Recording Fee \$ \_\_\_\_\_  
This Deed should be immediately Filed with  
the County Clerk for Record.

OFFICE OF

N. R. MORGAN,

Attorney at Law and Notary Public.

SPECIAL ATTENTION GIVEN TO  
LAND MATTERS.

MERIDIAN, Texas,

April 15<sup>th</sup> 1893

Mr W<sup>m</sup> Bramlett  
Austin  
Texas

Dear Sir

I have just read your letter to Mr Morgan concerning the J M Pitman Pre- in this Co, in which you ask how we determined the distance between Mrs Minifus and M. P. Frank's Surveys. I think my Certificate was made according to law and that work was done on the ground and Mrs Minifus line is a defined line and my affidavit was made to the whole and not a part—  
yours Resly J. Morgan

CS

6 File 5310

Milam Prampf

N. R. MORGAN  
Attorney at Law and Notary Public

J. M. Pitman

Survivors statement

Filed April 17/93

Wm Brantlett

Ch. J. Clark

*[Faint, mirrored text bleed-through from the reverse side of the page, including phrases like "Dear Sir", "I have just read", "your letter", "concerning the", "of Mr. Pitman", "in which", "are contained", "the names", "of M. D. Brantlett", "and my wife", "I think my certificate", "is made and is ready", "to issue and that would be", "done on the ground and", "that this is a definite", "line and my affidavit", "was made to the effect and", "not a part - James Clark"]*