

77-5068 Milam
Pre

Bosque County 38

affidavit filed for
5068 cert. copy from
Bosque

MILAM PRE-EMPTION.

B. 283:1147

an
Acq Land

148 1/2 acres corner

100 Acres

See surveyor's cert on P.
instrument in 5290 Milam P. 56.

See Surveyor's Cert. in Mil. P. - 5065

conflicts with A.C. McSpadden P. 4593
otherwise according to certificate in P. 5290 and
that of P. 5065 correct in map of

Bosque Co. 3/13/94

Patent to original
7/27/94

148 1/2 acres
B. 283:1147

Hotwell

Patented Aug. 3, 1894

373530

July 26, Lawson

Pre Reg

Vol. 2, 438

July 26, 1894

CONTENTS.

No. 1. Affidavit.

No. 2. Field Notes. 6/17/88

No. 3. Protect
Broglette
10/2/89 David

No. 4.

" 3 cert occupancy
11/12/90 Gait

4. Cor. Field notes

5. Cor. notes

6. affidavit

3/2/94
Rowen
4/2/94
Rowen

See Meridian

Refers
to
Meridian

THE STATE OF TEXAS,

Boque County.

Survey No. _____

FIELD NOTES of a Survey of 160 acres of Land, made for A. G. Gary it being the quantity of land to which he is entitled by virtue of his affidavit of occupancy issued by W. C. Hooper County Clerk of Boque Co Tex. on 13th day of December 1887

Said Survey is No. Situated in the County, Texas, situated on the waters of the Boque River, about 6 miles of _____ miles West of from Meridians

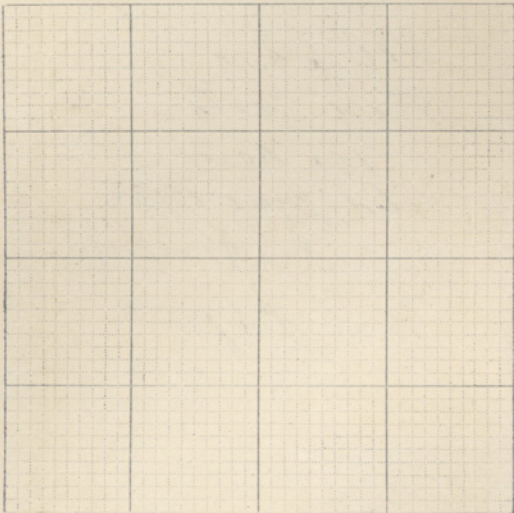

SCALE _____ VARAS PER INCH.

VARIATION

Beginning at S. E. cor. of a 42 acre survey in the name of David Lelie.

- Thence S30E 50 vrs to North line of Parris
- Thence S60W 95 vrs to N. W. cor. said Parris
- Thence S30E 250 vrs to cor.
- Thence S60W 1505 vrs to S. E. cor of W. Cunningham run
- Thence N30W 600 vrs to cor.
- Thence N60E 1144 vrs to cor in West line of said Lelie
- Thence S30E 300 vrs to cor. (S. W.) of said Lelie
- Thence N60E 456 varas

to the place of beginning.

Bearings marked

Surveyed March 12th 1888

Frank Gandy Sr
Frank Gandy Jr.

CHAIN CARRIERS.

I, James A. Weeks, County Surveyor of Boque County, Texas, do hereby certify that the foregoing described Survey was actually made by me on the ground, according to law, on the date and with the Chain Carriers aforesaid, duly qualified, and that all the Corners, Lines, Boundaries and Marks of the same, whether natural or artificial, are truly and correctly described and set forth in the foregoing Plat and Field Notes.

Recorded in B-C-p 138

By James A. Weeks Deputy. County Surveyor. Boque County, Texas.

1
File 5008
Milam Pramp
Greg Gary
Field Notes
160 lines
Filed June 17/88
R. O. Shelley
Chgo

Correct for only 141 ⁷/₁₀ lines
June 21/88
R. O. S.

FILING FEE PAID.

J. N. HOLLINGSWORTH.

RECEIVED G. L. O.



S. H. LUMPKIN,

ATTORNEY AND COUNSELOR AT LAW

2

AND REAL ESTATE AGENT.

Will practice in the District and
Inferior Courts of Bosque and Ad-
joining Counties, in the Supreme Court
and Court of Appeals of Texas, and
in the United States Courts of Waco,
and have a complete Abstract of Titles
to the Lands in Bosque County.

MERCANTILE, LAND AND PROBATE
PRACTICE A SPECIALTY.

Meridian, Texas, _____ 18_____



(Gary's) preemption, Mr. Gary has been in town
and trying to see Mr. Weeks and the
surveyors records in his office for two
days and thus far he has wholly
failed to see the County surveyor ^{or} the
records of said office, and this fact will
account for his being unable to give you
havin the field notes of the said land
in controversy. I wish you would give this
your individual attention, if possible,
and refer our county surveyor to Art-
393-1 of the R. S. - Furthermore please let me
know whether or not the field notes of
A. N. Gary preemption has been properly
returned to your office, and what ~~it~~
is necessary to have patent issued thereon.

Our deputy surveyor is absent with the key of
his office, and has been for several days.

Yours truly,
S. H. Lumpkin
Att. for A. N. Gary.

② Fee 5068.
Milam Presumpt
A. N. Gary
Protect.

Filed Oct 27/89
R. C. Kelley
Infect.

The "Detain" having
not been returned;
& the letter file not
being unable to
furnish "letter file
No." just at present;
the protect. is filed
in the A. N. Gary
claim. Done
10/27/89

PH 72545-
Serial PH 5387

Proof of Settlement under Homestead Act.

The State of Texas,

County of Bosque

Before me, the undersigned ^{Justice of the Peace & Clerk of the Public} John Hawey, Clerk in and for the County aforesaid, this day came and personally appeared A. N. Gary

a resident citizen of said County, who being by me duly sworn, declares that he is a bona fide settler upon 160 acres of vacant public land, situated in said County, and surveyed for A. N. Gary on the 12th day of March 1888 by J. N. Weeks a Surveyor of said County; that he has occupied and improved the same as a Homestead for a period of three consecutive years, beginning on the 12 day of March 1887 that he is a married man and that he makes affidavit for the purpose of obtaining a title to the same for a Homestead, under an Act supplementary to "An Act for the Benefit of Actual Occupants of the Public Lands," approved May 26th, 1873, and Acts prior thereto; and that he has not a Homestead other than the above.

AND also at the same time came and personally appeared R. A. Cline and _____ two credible resident citizens of said County, to me well known, who being duly sworn, depose and say that A. N. Gary the person first above named in this Affidavit; has actually settled upon and cultivated as a Homestead, the land surveyed for him on the 12th day of March 1888 by the Surveyor aforesaid, for the period of three years, and they nor either of them have any interest in the said land.

A. N. Gary
R. A. Cline
R. L. Hanna

SWORN TO and subscribed before me, and I hereby certify that R. A. Cline and R. L. Hanna are credible and trustworthy citizens of said County.

IN TESTIMONY WHEREOF, I have hereunto set my hand and ~~affixed the~~ Seal of said County, at office, this 7th day of Oct 1890

John Hawey, Justice of the Peace & Clerk of the Public
Secretary of the Bosque Co.
Tex

File 5-068

JENNINGS BROS. PRINTERS AND BLANK BOOK MAKERS, MARSH, L., TEXAS.

PROOF OF SETTLEMENT OF LAND

Milam Presumptive

Acq Gary

Cert Occupancy

Filed Nov 12th 1890

D. P. Shreeley
CLERK

Settler.



12 APRIL 1891

Handwritten text, likely a signature or official statement, in cursive script.

				910	
S	(4)	1239	1217	1262	1280
L			300		
W				1550	
N		600			
E				1162	
S			300		
E				438	
				<u>600</u>	1550

1214 915

Erwer West 50 N.

[Signature]

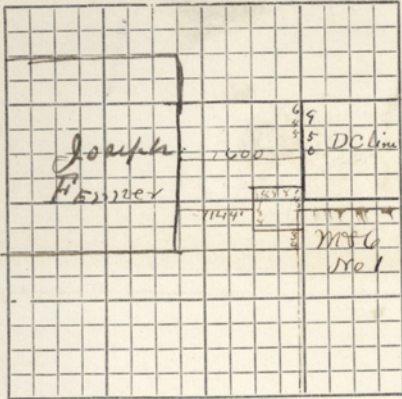

Scale _____ Varas per inch.

The State of Texas, } SURVEY
 Boque County. } No. _____

FIELD NOTES of a Survey of one hundred and sixty acres of Land, made for Aca Pary the quantity of land to which he is entitled by virtue of his affidavit of occupancy issued by H.C. Cooke to both of Boque Co Tex on the 15th day of Dec 1887

Said Survey is No. _____, in Boque County, Texas, situated on the waters of Cline Branch a tributary of Boque River, about 6 miles West of Meridian Beginning at a point in West boundary line of Morris Cummings which is S60W 50 varas from S E cor of a 42 acre sur in name of James Castleman. Thence S30E 300 var to cor in line of sd MVC No 1. Thence S60W 1550 var to S E cor of Joseph Fenner a pile of rocks SW cor of this Thence N30W 600 var to cor in E. B. line of sd Fenner sur Thence N60E 1162 var to cor in WB line of sd Castleman Thence S30E 300 var to SW cor of sd Castleman. Thence N60E 438 var

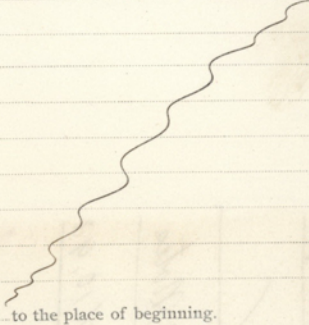

to the place of beginning.

Bearings marked

Surveyed March 8 1888

Frank Pandy Sr
John Pandy Jr } Chain Carriers.

I, James N. White Surveyor of Boque County, Texas, do hereby certify that the foregoing described Survey was actually made by me on the ground, according to law, on the date and with the Chain Carriers aforesaid, duly qualified, and that all the corners, lines, boundaries and marks of the same, whether natural or artificial, are truly and correctly described and set forth in the foregoing Plat and Field Notes.

By Recorded B.D. / 269 Deputy _____ Surveyor Boque County, Texas.

Filed for Record the _____ day of _____ 189 }
 at _____ o'clock _____ M. } Surveyor.

File 5068

Milam Prump

Acia Gary

Cor. Field Notes

Filed Mar. 10, 93

W. L. McGeough

Comr

Boneclase

Ever West 50 vs.

$\frac{4}{18}$ 1893

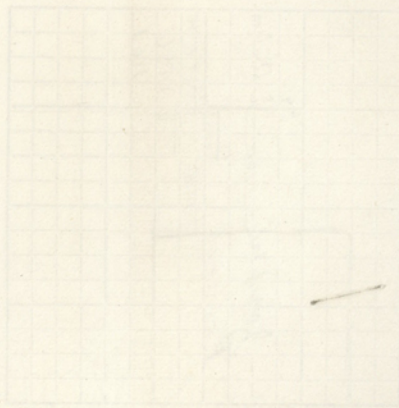

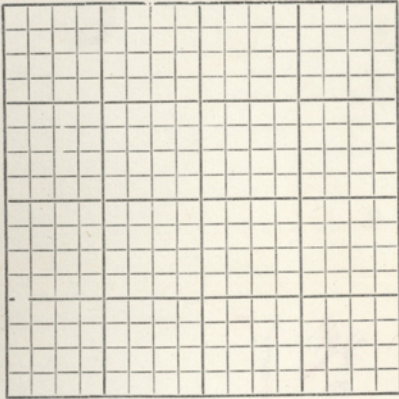

The State of Texas, } SURVEY

Bosque County. } No. *1482*

FIELD NOTES of a Survey of *one hundred*

Sixty acres of Land, made for *Acq. Gary*, at being the quantity of land to which he is entitled by virtue of his affidavit of occupancy issued by *H. C. Cook* Clerk of *Bosque Co., Texas*

Dec. 15th 1887

Scale _____ Varas per inch.

Said Survey is No. _____ in *Bosque* County, Texas, situated on the waters of *Chine Branch* a tributary of *Bosque* River, about *6* miles *West* of *Meridian* Beginning at *SW corner of Jas*

Castlemans Survey, of 62 acres, for a corner of this, thence N 60 E 140.6 us. to corner in South line of said Castlemans; thence S 30 E with Morris and Luningos west line 300. us. to corner; thence S 60 W 1600. us. to S.E. corner of Joseph Finners Survey; thence N 30 W with said Finners, East line 600. us. to corner; thence N 60 E 1194. us. to corner in west Boundary line of said Jas. Castlemans survey; thence S 30 E 300 us.

to the place of beginning.

Bearings marked _____

Surveyed *March 12th 1892*

Frank Gandy Sr.
Frank Gandy Jr. } Chain Carriers.

I, *Jas. N. Weeks,* *Bosque* County, _____ Surveyor of *Bosque* County, Texas, do hereby certify that the foregoing described Survey was actually made by me on the ground, according to law, on the date and with the Chain Carriers aforesaid, duly qualified, and that all the corners, lines, boundaries and marks of the same, whether natural or artificial, are truly and correctly described and set forth in the foregoing Plat and Field Notes.

By _____ Deputy _____ Surveyor *Bosque* County, Texas.

Filed for Record the _____ day of _____ 189 }
at _____ o'clock _____ M. } _____ Surveyor.

Book "C" pp 180.

5 Feb 50 08

Milam Preemp

Acy Gary

Cor. J. notes

Filed Feb. 24/1894

Report
Ch. Lewis

conflicts with T. 4893; otherwise
According to certificate in P. 5290 and
within T. 5003 correct on map of
Bosque Co. 3/12/94
C. M. Tate

Patented Aug. 3rd /94

Dawson

9/3rd 1894

Will practice in the District and
Inferior Courts of Bosque and Ad-
joining Counties, in the Supreme Court
and Court of Appeals of Texas, and
in the United States Courts of Waco,
and have a complete Abstract of Titles
to the Lands in Bosque County.

MERCANTILE, LAND AND PROBATE
PRACTICE A SPECIALTY.

S. H. LUMPKIN,

ATTORNEY AND COUNSELOR AT LAW

AND REAL ESTATE AGENT.

Meridian, Texas, Oct. 19th 1889

Leon. R. M. Hall

Austin Tex:

Dear Sir:

For Mr. A. S. Gary I her wish to
enter a protest against the issuance of any
patent for one ^{Delta} pretended to be claimed
by the said ^{Delta} as a homestead on lands
lying north of the Walter course survey and
South West of the David Bline survey, and
South of L. S. Mc Daniels survey, about 6 miles
a little north of West from the town of Meridian
The facts in the case are these, about three
years ago Mr. A. S. Gary made affidavit
under the Homestead donation act, and
had the land in question to wit 160 acres
surveyed for him, by J. A. Werks the then
and now county surveyor of this county,
and he ^{has} occupied the same ever since
as his homestead. That, on day before yester-
day, Mr. Gary was informed that the same
county surveyor J. A. Werks, by office work
had located the said ^{Delta} upon his

AFFIDAVIT FOR PRE-EMPTION.

THE STATE OF TEXAS,

COUNTY OF BOSQUE.

Before me, H. C. Cooke, Clerk of the County Court of Bosque
County, this day personally appeared A. N. Gary
to me known, who after being by me duly sworn, upon his oath deposes and says: that he is now a
bona fide settler upon 160 acres of Land, that he believes to be of
the public vacant lands of the State of Texas; that he is improving said land for a Homestead, and
has no other; and further that he is a Married man
and makes this Affidavit for the purpose of obtaining a Home. Said Land is situated in Bosque
County, about 6 miles N. W. from Meridian, on the waters of the Bosque Creek:
beginning at S. W. cor David Blue certificate

and more particularly described by the accompanying field notes.

Given under my hand and the seal of the County Court of Bosque
County, at office, in the Town of Meridian, this First
day of August A. D. 1877

H. C. Cooke
Clerk County Court, Bosque County, Texas.

By J. S. Rogers, Deputy.

No. _____

H. W. Gary
Affidavit for Pre-emption.

ISSUED

the 1st day of Aug 1897

H. C. Cooke
C. C. C., B. Co.

By *J. L. Rogers* Deputy.

M. Strickland, Notary and Printer, Galveston.

Rec'd. Mar. 17, 1891

Book 40, 1, Page 24

6. Title 5068

William C
A. T. Gany
Affidavit
Filed 4/22/1894

W. C. Gany
Cohasset

no off.

See

Art 6. R. S.

All affidavits
provided for
in this title shall
be in writing and
signed by the party
making the same

7/1894. Fugate