

Bosque County, '88

File

5038.

abst 1152 - 12  
MILAM PRE-EMPTION.

Geo. A. Prather

So does

Act

May 29 1873

Surveyor calls to begin at the corner of a divisional survey of the Cherino League. This is wrong, for he should take his connection from the corner of some original survey. If this survey is on the Cherino league surveyor should take his connection from some one of the corners of said league or from some survey that does take its connection from said league.

3/22/88

void  
22275

Mgl.

abst Vol 24

Mich 10  
E 117N. 88

CONTENTS!

- No. 1. Affidavit n/p
- No. 2. Field Notes. 3/5/85 Daniel
- No. 3. cert of accy.
- No. 4. 6/18/91 Gentry

Cancelled for reason no affidavit made & returned. The survey is therefore illegal & void

1/26 Carllige  
95  
P.P. 5/23/91

J. H. Hilton  
Meridian

J. Weeks. Tex  
Meridian

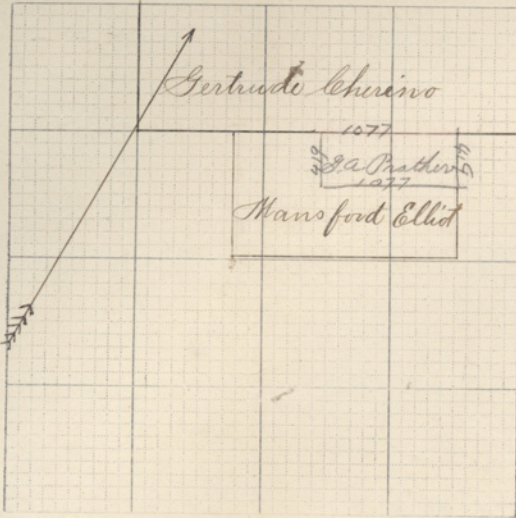

THE STATE OF TEXAS, )

Bosque County. )

Survey No. \_\_\_\_\_

FIELD NOTES of a Survey of 80 acres of  
 Land, made for Geo. A. Prather the am-  
 ount to which he is entitled by vir-  
 tue of his affidavit of occupancy issued  
 by H. C. Cook County Clerk  
 of Bosque Co. Texas July  
 2<sup>d</sup> 1887

Said Survey is No. \_\_\_\_\_ in Bosque County, Texas,  
 situated on the waters of Rocky Creek a tributary  
 of the Brazos River, about 13  
 miles S E of Meridian

SCALE 1000

VARAS PER INCH.

VARIATION 7° 30' East

Beginning at the S. E. cor. of a survey out of the Churino  
 League, bought by Ben. Prather from P. M.  
 Greenwood as shown by record of deeds, from  
 which a L. O. X. is S. 30° E. 1500  
 Thence S. 60° W. 1077 ns. to cor.  
 Thence S. 30° E. 419 ns. to cor.  
 Thence N. 60° E. 1077 ns. to cor.  
 Thence N. 30° W. 419 ns.

to the place of beginning.

Bearings marked

Surveyed July 4<sup>th</sup> 1887

Chris Gorg  
 Walter Hawthorne } CHAIN CARRIERS.

I, James A. Weeks, County Surveyor of Bosque County, Texas, do hereby  
 certify that the foregoing described Survey was actually made by me on the ground, according to law, on the date and with the Chain Carriers afore-  
 said, duly qualified, and that all the Corners, Lines, Boundaries and Marks of the same, whether natural or artificial, are truly and correctly described  
 and set forth in the foregoing Plat and Field Notes.

Recorded Book No 6 P 329 Deputy.

James A. Weeks  
 County Surveyor Bosque County, Texas.

Filed for Record the \_\_\_\_\_ day of \_\_\_\_\_ 1887 at \_\_\_\_\_ o'clock \_\_\_\_\_ M.

Surveyor.



① File 5838.

Miriam Pincus

Gold Prater

Sprague

Tris Mich of St.

Rothman

Chusick

cc Mich 10  
9/11/38

FILING FEE PAID  
U. S. DEPARTMENT OF JUSTICE

State of Texas, :-:

:-:

County of Bosque. :-: Before me, the undersigned, H. C. Cooke,

Clerk of the County Court of Bosque County, Texas, on this day

personally appeared B. T. Prather (the father of C. A. Prather) <sup>o</sup>

resident citizen of said County, who, being by me duly sworn,

on oath stated that his son, C. A. Prather, on or about the ... day

of ....., 1888, settled upon Eighty Acres of vacant pub-

lic lands in said Bosque County, which was surveyed for him on

the .... day of ....., 1888, by James N. Weeks, the County Sur-

vveyor of said County; that his said son, C. A. Prather, occupied and

improved the same as a homestead from the date aforementioned

till his death, which occurred on the 10th day of December, 1890;

that since the death of his son on said date, he, the affiant,

has continued to occupy and improve said land; that H. C. A. Pra-

ther aforesaid was a single man at the time he settled upon said

80 acres of land and remained single till his death; that said

land has been occupied and improved as a homestead for a period

of three consecutive years, including the time it was occupied

by the said C. A. Prather, now deceased, and by affiant, B. T. Pra-

ther, the father of said C. A. Prather, deceased; and that he, affiant,

is qualified to administer the will of the said C. A. Prather, deceased, for the purpose of obtaining a title to

the same as the joint heir with his wife, M. A. Prather, the

wife of the deceased (who also survives him) under the laws of

the State of Texas in such cases made and provided.

Also appeared before me X. <sup>B</sup> Bennett and James N. Weeks, known to

me to be credible and worthy citizens of said County, who, be-

ing duly sworn, asked and say that they are personally ac-

quainted with affiant and with his son, C. A. Prather, deceased, in the

past, that they know the facts set forth in the foregoing

statement of B. T. Prather are true and correct, and that they are

in no way interested in said land.

B. T. Prather  
J. B. Bennett  
James N. Weeks

Witness my hand and seal of office this 10th day of June, A.D. 1891 H. C. Cooke, Clerk of Bosque Co. &

*Prather*  
*W. P. Prather*  
*James N. Weeks*  
*B. T. Prather*



<sup>2</sup>  
File 5038

Melvin Pre  
Geo a. Prather  
Cent of occy.

Dated June 15/91

W. Brantlett  
Chief Clerk



W. Brantlett  
Chief Clerk