

Basque Col '87

Basque County.

File

4931.

not on alt

MILAM PRE-EMPTION.

L. Cranfill

84 88 1/2

St. Louis

Mad Old on map

Act

May 26. 1873.

3-2217

On the unpatented

Mil 3-2217 J. Harrison
otherwise according to
Dunwoody's statement before
Council on map of Basque
Co for 84 acres 11/27/12

3-2217 no obstacle.

11/29/12 Sketching

Patent to Arques
10/9/12 Sketching

Submitted Dec. 18, 1912.

no. 282. Vol. 33

Page 282. Vol 33

Mad Old on map

identifies

Mgt.

keys between

Meridian 10/8/87

CONTENTS.

No. 1. Affidavit. n/r

No. 2. Field Notes. (Copy)

No. 3. Cert of Occupancy

No. 3. Sketch & Cert of Co

4/28/87. Damm

4. Certified Sketch

10/26/87. Damm

5. Sur. Statement 7/15/87

6. Cert of Occupancy 1/7/83. P & A.

7. Aff. of ownership 1/7/83. P & A.
which should be
done. see sketch
for survey, show
position of this area
appears on later map
of Hamilton County
Oct 29/87

\$5.00 Dep 12/18/85 by

J. Cranfill, and
\$1.00 of which is used
for filing fee 4/28/87

Special Appropriation
160 = 84

Scale, $\frac{1}{2}$ Varas to the Inch.
Variation,

The State of Texas, } Survey No. ~~87~~
COUNTY OF BOSQUE.

Field Notes of a Survey of Eighty one
acres
of land made for J Cranfill
it being _____ the land to which he is
entitled by virtue of his gift of occupancy

Issued by the County Clerk of
Bosque County Tex on the 21st day of Aug 1882
Said land is situated on the waters of Menden
Creek about 15 miles S & W from Menden

Beginning at the N.W. cor of W Schimpf
320 acre sur a pile of rocks for N.E. cor of
this sur from which a fine oak Mk'd X bears
N 88 E 102 us to Do Mk'd X bears N 10 E 701 us
thru S 60 W 609 us to S. B. Cranfills N.E. cor
a pile of rocks thence S 80 E 735 us to S B Cranfills
Cen. on Nattle line of ^{F.M.D} Rufous 8.0 acre sur
thence N 60 E 609 us to N.E. cor Jacob Harrison
160 acre sur a pile of rocks for the S.E. cor
of this thence N 30 W 735 us to the place
of Beginning

See Survey of J. Cranfill

Bearings Marked Surveyed Oct 31st 1882
Chain Carriers
John Reed
J H Cranfill

I S. J. Siddall Co Surveyor Bosque Co Tex
do hereby certify that the foregoing survey
is made according to law and that the
limits boundaries and corners with the
marks natural and artificial are truly
described in the foregoing plot and field
notes

S. J. Siddall
Co Surveyor Bosque Co
Tex

The State of Texas }
County of Bosque } J N B Radol Co Surveyor
of Bosque Co. do hereby
certify that the above is a true and

Correct copy of Field Notes of David Croufille
Survey. Recorded in Book C Page 101. of
County Surveys Records. This Dec 16th a 6
1865

N B Brandal Co Surveyor
Bosque Co Tex

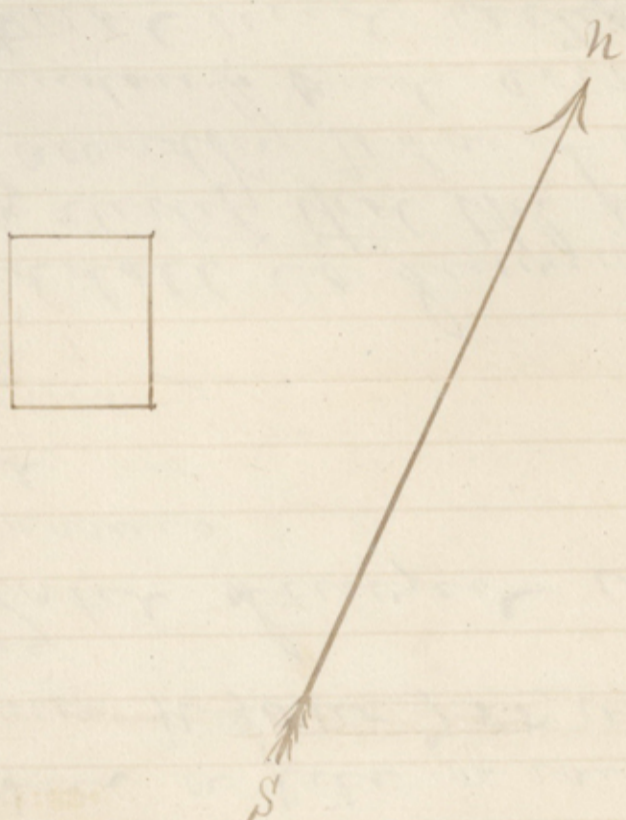

The State of Texas & I hereby make application to
County of Bosque & the Co Surveyor Bosque Co
Texas to Survey me 160 acres
of land by virtue of my draft of occupancy made
on the 21st day of August 1862 beginning at the
NW cor of J W Schump's 820 acre tr. This
sur goes as to include 160 acres or all of the
Public ^{voice} domain this the 21st day of Aug
1862. said land is situated about 11
miles S & W from Medford.

I Croufille
I N B Brandal Co Surveyor hereby certify
that the above is a true & correct copy
of the original or now of Record in file
Book Page 211.

N B Brandal
Co Surveyor
B C F

FILING FEE PAID.
O. N. HOLLINGSWORTH,
Receiver G. L. O.

① File 4931.
Milam Preempt
L Craufill
S/mates
Fri Dec 18/85.

Robinson to sign

Chief Clerk
Cancelled by
Don S/mates

Excursion

contract for 88 1/2 - a
May 2/87
J.H.H.

(8000)

Corner east half of
(northern) ^{paradise} survey in name
of Jacob Harrison - Milam
3-2217 -

owing to confusion in
location of surveys in this
vicinity, it is necessary
to have a certified sketch
made by the Co. Sur. showing
all the surrounding surveys
as they actually exist
on the ground - before
these field notes can be
passed.

9/20/12

Clark

Re. 12/18/85 - J. H. R. Co., 54 + is to Cr of Grantee
No Letter - J. D. Roberdeau

Proof of Settlement under Homestead Act.

The State of Texas,

County of _____

Before me, the undersigned _____ County Clerk in and for the County aforesaid, this day came and personally appeared G. Cranfill

a resident citizen of said County, who being by me duly sworn, declares that he is a bona fide settler upon 51 acres of vacant public land, situated in said County, and

surveyed for said G. Cranfill on the 31st day of Oct 1882 by G. J. Siddall a Surveyor of

said County; that he has occupied and improved the same as a Homestead for a period of three consecutive years, beginning on the 21st day of August 1882

that he is a married man and that he makes affidavit for the purpose of obtaining a title to the same for a Homestead, under an Act supplementary to "An Act for the Benefit of Actual Occupants of the Public Lands," approved May 26th, 1873, and Acts prior thereto; and that he has not a Homestead other than the above.

AND also at the same time came and personally appeared E. R. Spencer and John P. Jordan two credible resident citizens of said County, to me well known, who being duly sworn, depose and say that G. Cranfill

the person first above named in this Affidavit; has actually settled upon and cultivated as a Homestead, the land surveyed for him on the 31st day of Oct 1882 by the Surveyor aforesaid, for the period of three years, and they nor either of them have any interest in the said land.

G. Cranfill
Evan R. Spencer
John P. Jordan

SWORN TO and subscribed before me, and I hereby certify that Evan R. Spencer and John P. Jordan are credible and trustworthy citizens of said County.

IN TESTIMONY WHEREOF, I have hereunto set my hand and affixed the Seal of said County, at office, this 14th day of November 1885

Geo. W. Randal
Clerk County Court Basque Co.
for John Alexander Dept.

PROOF OF SETTLEMENT OF LAND

G. Cranfill Settler.

(2) Fee 4931. Milan Preempt. F Cranfill Cert of Occupancy Filed Dec 18/85. G N Robinson Robinson to Sepn Suspect

Faint handwritten text at the bottom right of the page, including the name 'G. N. Robinson' and other illegible words.



I, S. J. Siddall Ex County Surveyor
 of Barger county Texas do hereby certify that
 the J. Southerland presumption survey is correct
 on the ground the corners of the surveys as
 shown in the above plat all found on
 the ground. but see there is a mis call
 in the J. Southerland field notes they call
 for the N line of the C. Beubran but should
 call for the N line of the F. M. Beubran SW
 which you will please correct the error in
 the call as I have corrected it in the Book
 C. Page 101

S. J. Siddall
 Ex County Surveyor
 of Barger county
 Texas

The State of Texas, I James N
Booque County } Weeks County
Surveyor of Booque County Certify
that I have examined the foregoing
plot and field notes of Survey made
made for S Cranfil. by S. J. Siddall
and it correct according surveyor
records of Booque County Tex as
This 22^d day of April 1887

James N Weeks
County Surveyor
Booque County Tex

③ True 1901.
Milam Precinct
L. Cranfil
Attest and
Cert of Com. in
Filed Apr 27/07
R. B. Shaver
Clerk

Official

4931 mi Pre

The State of Texas }
County of Basque }

I, S. J. Siddall Ex County County
Surveyor of Basque County Texas do
hereby certify that I actually surveyed
on the ground with chain carriers duly
qualified the 3 Cranfill Survey and
all of the surrounding surveys
and that it does not conflict with
the S B Cranfill and no other survey
the N E corner ~~of~~ of the S B Cranfill on
the S line of John Copuin is the NW cor
of S B Cranfill Survey and also the S E cor
of S B Cranfill on the N line of J Benson Sur
is 3 Cranfills S.W cor this the 22nd of Oct 1887
from the NW Albany Sur to S. J. Siddall
The J. W. Scripps, S N W cor Ex County Surveyor
15 7 1/2 as of Basque County Texas



over

The State of Texas,
County of Bogue 3 I James N Weeks
County Surveyor of Bogue County Texas
do hereby certify that I have examined
the foregoing plot and find it
correct according to record.

James N Weeks

Oct 22^d 1887.

County Surveyor
Bogue Co Tex

④ Price 4931.
Milam Receipt to
Z. Crawford

Centris
Sketch
This Oct 24th 1887
R. A. Sherry
C. P. Pickett

Some of the
the same of the

THE STATE OF TEXAS ##

COUNTY OF BOSQUE ##

In the matter of the application of the heirs
of Z.Cranfill, deceased, for letters patent to
84 acres of land li Bosque County, Texas,
filed on by Z.Cranfill.

I, Mack Bertelson, County Surveyor of Bosque County, Texas, hereby
certify that on the 10th day of August, 1912, I did go on the ground
and make an actual survey of the 84 acres of land in the said County,
corrected field notes of which with application of the heirs of said
Z.Cranfill for a patent on said land, is now on file with the Commis-
sioner of the General Land Office of, Texas. That in making said sur-
vey and location, I did find the N.E. and S.E. corners of the S.B.Cran-
fill survey as recognized by the present owner, the vendee of S.B.Cran-
fill; that I found the N.E. corner of said S.B.Cranfill survey as so recog-
nized, to be 649-1/2 varas ~~XXXXXX~~ S.60 W. from the S.E. corner of the
J.Cornin 320 acre survey and the S.W. corner of the J.Cornin 640 acre
survey and the N.W. corner of the J.W.Schrimpf surveys as recognized
by the several owners of said surveys, which said corners I found on
the ground and recognized as such by said owners as aforesaid.

I also found the N.W. corner of the F.Renfro survey on the ground
as it is recognized, and it is in a course N.30 W. from the S.W. corner
of the C.Renfro survey which I found on the ground and which is well
known and recognized as being a well defined corner. I also found
that the N.W. corner of the F.Renfro survey as recognized and found
by me on the ground, is 672 varas S.60 W. from the N.W. corner of the
I.Reed survey, Assignee of J.Harrison, as recognized. I also found on
the ground the South line of the J.Cornin 320 acre survey, the West line
of the J.W.Schrimpf, the North line of the I.Reed, Assignee of J.Harrison,
and the East line of the S.B.Cranfill surveys as they actually exist
on the ground and are recognized generally and as they are specially
recognized by the present owners, and neither of said surveys conflict
with nor lap over on the said Z.Cranfill survey of 84 acres. I further
certify that I grew up in the neighborhood of said surveys, and personally
know that Z.Cranfill during his lifetime, and his widow and children since
his death, have been in undisputed possession of said 84 acres of land
for more than twenty years, and I know from reliable information that
they have so occupied it for at least forty years. I further certify
that the relative locations of the surveys above mentioned are as
represented on the accompanying plat and the distances therein in-
dicated.

Witness my official signature, this November 23rd, 1912.

Mack Bertelson, County Surveyor, Bosque Co. Texa

4931

(5)

Surveyor's Statement

Field Notes

FILED

NOV 26 1912

A. T. ROBINSON, Commissioner

W. Hawkins

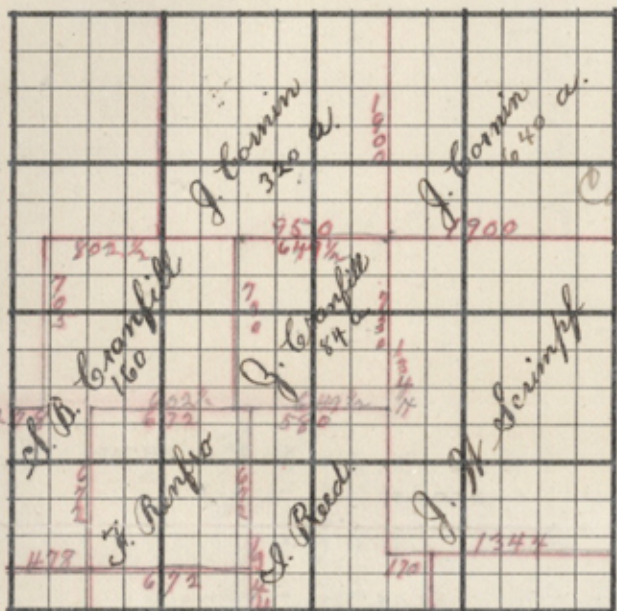

Scale 800 Varas per inch.

The State of Texas, } SURVEY

Bosque COUNTY. } No. _____

FIELD NOTES of a Survey of Eighty-four (84)

acres of _____ Lands, made for

the Heirs of Z. Cranfill, it being a

part of the lands to which they are

entitled by virtue of Z. Cranfill's

Certificate of occupancy issued by

the County Clerk of Bosque County,

Texas, on the 21st day of August, 1882.

Said Survey is No. _____, in Bosque County, Texas, situated on the waters of

Meridian Creek a tributary of the Bosque River, about 15 miles S. 56 W.

of Meridian Beginning at the N.W. corner of the J.W.

Schrimpf 320 acre survey, a pile of rocks for the N.E. corner of this

survey, from which a Live Oak marked X bears N. 8 E. 102 varas, and

another marked X bears N. 10 E. 101 varas; Thence S. 30 E. 730

varas to the N.E. corner of a survey in the name of I. Reed, Assignee

of J. Harrison, for the S.E. corner of this; Thence S. 60 W. 649-1/2

varas to the S.E. corner of a survey of 160 acres in the name of S.B.

Cranfill, for the S.W. corner of this; Thence N. 30 W. 730 varas to the

N.E. corner of said S.B. Cranfill survey in the South line of the John

Cornin 320 acre survey, for the N.W. corner of this; Thence N. 60 E.

649-1/2 varas to the place of beginning.

XXXXXXXXXXXXXXXXXXXX

Bearings marked X

Surveyed August 10th, 1912. ~~1912~~

C.G. Cranfill }
 Z. Cranfill } Chain Carriers.

I, Mack Bertelson Surveyor
 of Bosque County, Texas, do hereby certify that the foregoing described survey was actually made
 by me on the ground, according to law, on the date and with the Chain Carriers aforesaid, duly qualified, and that
 all the corners, lines, boundaries and marks of the same, whether natural or artificial, are truly and correctly
 described and set forth in the foregoing Plat and Field Notes.

Mack Bertelson

County Surveyor Bosque Co., Texas.

By _____ Deputy

in my office in Book "C" page 267.
 Filed for Record this 2nd day of October, 1912.
 at 4:30 o'clock P. M.

Mack Bertelson
 Surveyor.

Z.CRANFILL 84 ACRE PRE-EMPTION SURVEY- BOSQUE COUNTY.

THE STATE OF TEXAS ##
 ##
COUNTY OF BOSQUE ##

I, E.G.Cranfill, of Bosque County, Texas, being duly sworn, on oath do say, that Z.Cranfill, who made application for a pre-emption survey of 84 acres of land in Bosque County, Texas, is dead, and that his widow is dead, and that he left surviving him as his sole heirs at law, the following children, viz: this affiant, E.G.Cranfill, Tom Cranfill, E.Cranfill, O.D.Cranfill, Z.Cranfill, Jr., and J.M.Cranfill, Mrs. Mary Weller, Sarah Smith, Viola Spruell, Katie Norris, Ellen Smith and Josie ~~Ellis~~ Adams. That I am in possession of said land holding it for myself and my said brothers and sisters, under a written memorandum authorizing me to act for them in procuring patent to said land, and to act generally for them in regard to same, and that I am entitled to receive the patent to said land for myself and my said brothers and sisters, and I make this affidavit for said purpose.

E. G. Cranfill

Subscribed and sworn to by E.G.Cranfill, before me, on this the 24th day of December, 1912.

R. H. Hale, County Judge,

Bosque County, Texas.

Bosque County, Texas.

County Judge,

1018, September 10, 1931.

Dear Sir: I have the honor to acknowledge the receipt of your letter of the 7th inst.

W. H. ...

and in reply to advise you that the same has been forwarded to the proper authorities.

I am, Sir, very respectfully,
Your obedient servant,
W. H. ...

I have the honor to acknowledge the receipt of your letter of the 7th inst. and in reply to advise you that the same has been forwarded to the proper authorities.

17
Off. of ...
Filed 11/15/31
W. H. ...

I have the honor to acknowledge the receipt of your letter of the 7th inst. and in reply to advise you that the same has been forwarded to the proper authorities.

I, E. C. ... of Bosque County, Texas,
do hereby certify that the above is a true and correct copy of the original as the same appears in the files of this office.

E. C. ... Bosque County, Texas.

General Land Office

J. T. ROBISON, COMMISSIONER
J. H. WALKER, CHIEF CLERK

AUSTIN, TEXAS, 1/7/13.

Mr. E. B. Cranfill,
Meridian,
Texas.

Dear Sir:

Enclosed find patent for land in Bosque County,
issued to Z. Cranfill
Patent No. 282, Vol. 33. Class Presumption.

Yours truly,

J. H. Walker, chf. clk. + actg.
Commissioner.

Anthony

Milam Pre
493

COMPTON

RECEIVED

NOV 10

1907

RECEIVED

NOV 10

RECEIVED

NOV 10

RECEIVED

RECEIVED

RECEIVED