

B- abt 1122  
File H 42 (No-1) 22

PRE-EMPTION.

Entered field notes  
 June 1<sup>st</sup> 1849  
 Col McNeill  
 Conflicts with the Ericson  
 P. 3957 & series P. 3945  
 otherwise correct on  
 map of Bosque County  
 July 1859  
 Col McNeill  
 July 7<sup>th</sup> 1859  
 Patent July 11/89  
 Mgl. [unclear]  
 June 28  
 1849  
 B- abt vol 19

CONTENTS.

- No. 1. Affidavit.
- No. 2. Field Notes.  
March 10/86.
- No. 3. [unclear]  
Davit
- No. 4. 3 Cert. of Occupancy  
4/12/88. Davit
- 4. Cor. F/notes  
7/18/88. Davit
- 5. Cert. of Title  
3/20/89
- 6. Cor. F/notes  
6/26/89 Davit
- 7. Cor. F/Notes 7/95. Mass
- 8. apt of Div. of [unclear] 5/11/89  
\$5<sup>00</sup> Dep 4/12/88  
Severin John  
July Clifton  
Repts to  
Tom L. Greer  
N.D. [unclear]  
Merid [unclear]

John on [unclear] map  
 11/11/89  
 7-551-7th 77

The State of Texas. } Personally appeared  
County of Bosque } before the undersigned  
authority this day.

Severin Johnson, who after being duly sworn deposes and says that he is an actual and bona fide <sup>settler</sup> ~~citizen~~ upon One Hundred and sixty acres of land which he believes to be of the vacant public domain. That he is cultivating and improving the same as a homestead, and has no other, that he is a male citizen, twenty-one years of age, <sup>and a married man.</sup> and that he makes this application for the purpose of securing a home under the homestead laws, Beginning at a point 646 varas. N. 30° W. from S. E. corner of the P. Anson Survey, ~~on the waters of~~. Thence S. 30° E. Said land situated on the waters of Turkey Creek.

Severin Johnson

Sworn to and subscribed to before me this 24<sup>th</sup> day of March, 1885.

G. J. Sibbs

Justice of the Peace and  
ex officio Notary Public  
Precinct No 8. Bosque  
County Texas.

File #721.  
Milam Precinct  
S Johnson.

Affidavit  
Filed with  
D. N. Robinson  
Lufkin.

Affidavit

Filed with 24, 1888  
N. A. Paudyal  
D. N. Robinson

108  
J. H. G.

State of Texas } Field Notes of 160 acres of  
Co of Basque } land made for S. Johnson  
out of the Public domain  
by virtue of his affidavit of  
occupancy issued by ~~the~~ Clerk J. G.  
Gibbs Notary Public of Basque Co Texas  
March 24<sup>th</sup> 1885. said land is situated  
on the waters of Turkey Creek about  $4\frac{1}{3}$   
miles South<sup>24<sup>th</sup></sup> from Meridian. Beginning at  
N E cor. Columbus McCurry Survey. Thence  
S 30 E 672 00 cor in McCurrys E line from  
which a Live oak Mark X to N 50 W 85 00  
Thence N 60 E 672 00 a pile of rocks for cor  
Thence N 30 W 722 00 a " " " " "  
Thence N 60 E 221 00 a cor on W line of S. Newton  
Thence N 30 W 950 00 a rock pile for cor  
Thence S 60 W 672 00 a pile of rock for cor on E line  
of P. Cameron  
Thence S 30 E 522 00 a pile of rocks for cor  
Thence N 60 E 388 00 " " " " "  
Thence S 30 E 438 00 " " " " "  
Thence S 60 W 600 00 to the place of beginning  
Surveyed March 28<sup>th</sup> 1885:

chain men

N. J. Nelson 2  
J. N. Neilson 2

N. B. Randal  
Co Surveyor Basque Co Tex

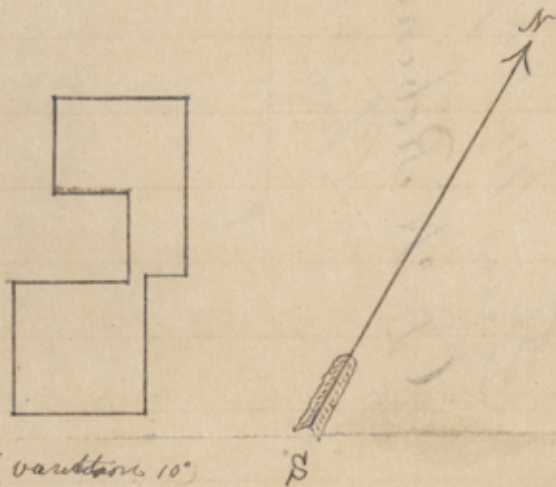

Scale 1000 us to inch (variation 10°)

S

I N. B. Randal Co Sur. Bexar Co Texas do  
herby certify that the above Survey & field notes  
was made according to law and that the maps  
noted and certified are correctly described  
and recorded in Book No. 6, page 305 of  
Bexar Co Surveyors records.

N. B. Randal Co Sur  
Bexar Co Texas

② File #721.  
Milam Preempt  
J. Johnson  
Find Notes  
Find Mich 6/86.  
D. N. Robinson  
Chiefcl.

Don't call -

difference between calls

S30E + N30W 40' - +

between calls, S60W + N60E

9' -

Mich 12/86

9' -

Cut by dam

4721 mile Pr

### PROOF OF SETTLEMENT UNDER HOMESTEAD ACT.

The State of Texas, }  
County of Bosque

BEFORE ME, the undersigned, County Clerk in and for the County aforesaid, this day came and personally appeared S. Johnson, a resident citizen of said County, who being by me duly sworn, declares that he is a *bona fide* settler upon 160 acres of vacant Public Land, situated in said County, and surveyed for him on the 28<sup>th</sup> day of March 1885, by N. B. Raudal a Surveyor of said County; that he has occupied and improved the same as a Homestead for a period of three consecutive years, beginning on the 24<sup>th</sup> day of March 1885, that he is married, and that he makes this affidavit for the purpose of obtaining a title to the same for a Homestead, under "An act for the Benefit of Actual Occupants of the Public Lands," approved May 26th, 1873, and Acts prior thereto; and that he has not a Homestead other than the above.

And also at the same time came and personally appeared N. Jacob Nelson and A. Amunson, two credible resident citizens of said County, to me well known, who being duly sworn, depose and say that S. Johnson, the person first above named in this Affidavit, has actually settled upon and cultivated as a Homestead the land surveyed for him on the 28<sup>th</sup> day of March 1885, by the surveyor aforesaid, for the period of three years, and they nor either of them have any interest in the said land.

S. Johnson  
N. Jacob Nelson  
A. Amunson

Sworn to and subscribed before me, and I hereby certify that N. Jacob Nelson and A. Amunson are credible and trustworthy citizens of said County.

IN TESTIMONY WHEREOF, I have hereunto set my hand and affixed the Seal of said County, at office, this 4<sup>th</sup> day of April 1888

N. C. Coode  
Clerk of County Court. Bosque Co. Tex.

3

File 4721.  
Milam Precinct  
S. Johnson  
Cert of  
Occupancy  
Filed Apr 12/88.  
R. Shellen  
Chief Clerk

Geo. D. Barnard & Co., PRS., ST. LOUIS.

PROOF OF SETTLEMENT OF LAND

Settler.



The State of Texas } - Corrected  
 County of Bosque } Field notes of a survey of 160  
 acres of land made for Berwin  
 Johnson out of the public domain of the State of  
 Texas the amount that he is entitled to by virtue  
 of his certificate of occupancy issued by  
 J. G. Gibbs a Notary public in and for Bosque Co  
 on the 24<sup>th</sup> day of March 1885

Situated in Bosque Co Texas on the waters  
 of the Bosque river, about 15 miles S20E  
 from Meridian.

Begin at the NE cor of C. Mc Lury

Thence S30E 672 ms to cor

Thence N60E 672 ms to cor

Thence N30W 672 ms to cor

Thence S60W 672 ms to beginning of this

Also Begin at Most Eastern NW cor of Berwin

Thence N30W 522 ms to cor

Thence N60E 672 ms to cor in Newton West line

Thence S30E 910 ms to cor

Thence S60W 284 ms to SE cor of Berwin

Thence N30W 388 ms to NE cor of Berwin

Thence S60W 388 ms to place of beginning

Resurveyed July 6<sup>th</sup> 1885

N. J. Nelson }  
 A. Christopherson } C

James Weeks  
 Co Surveyor

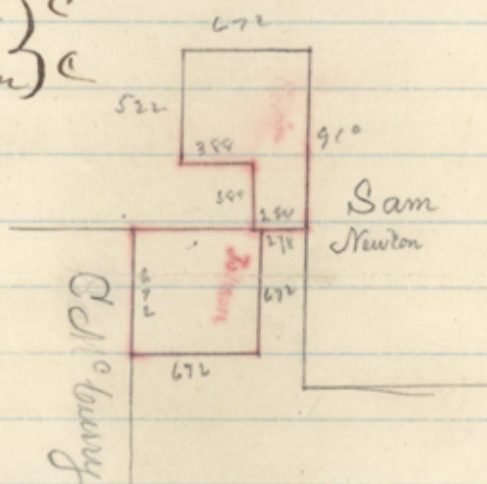

I James Weeks Co Surveyor of Bosque Co Tex  
 do hereby certify that the foregoing plat and  
 field notes are true and correct  
 Recorded - Book No. 6 - P. 355  
 James N Weeks - Co Sur  
 13.6.85

④ Fee 4721.

Milam Preempt  
S. Johnson

Corrected

~~18~~ 1/2 notes

160 acrs  
Paid July 18/88

R. Sheeley

Chief

These 160 acrs close & contain 160  
acres, but they are made up of 2  
distinct sets of 80 notes, each having  
a set of 40 beginning. As they were  
brought together, land, the lines  
should be continuous from the  
1st corner to the last, and all  
together should embrace the  
160 acres - If the beginning corner  
of the first set of 80 notes is  
made the beginning corner,  
the lines will run S 30 E 67 2 -  
N 60 E 67 2 - N 30 W 67 2 - N 60 E  
- N 30 W 91 0 - S 60 W 67 2 -  
S 30 E 52 2 - N 60 E 38 8 - S 30 E  
38 8. S 60 W - The notes

beginning of 1st and last calls  
must be supplied by the surveyor  
as there are notes given no data  
by which they can be determined  
New 80 notes as suggested  
wa. - July 20/88  
RST

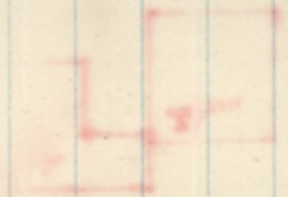

11608  
672

2  
16  
358

3  
9  
0

1  
2  
7  
8

Samuel R Newton

OK Betum slow

666

6  
7  
2  
McBury

6  
7  
2

S. Johnson

950

W H Maple

4721 7

The State of Texas, corrected field  
County of Boaque 3 notes of 160 acres  
of land made for S Johnston, the amount  
that he is entitled by virtue of his certificate  
of occupancy issued the 24<sup>th</sup> March  
1885 by J. G. Gibbs a Notary Public of Boaque  
Co Texas.

Situated in Boaque Co Texas on  
the waters of the Boaque river about  
15 miles S 20 E from the Town of  
Meridian.

Beginning at the NE cor of G M Curry  
Thence S 30 E 672 us to NW cor of W H Maple for  
the SW cor of this

Thence N 60 E 950 us to NE cor of said Maple  
for SE cor of this

Thence N 30 W 1278 us to NE cor of this in  
Sam'l Newtons West line

Thence S 60 W 672 us to cor in J Armesons E line

Thence S 30 E 216 us to a cor of O K Berwin

Thence N 60 E 358 us to NE cor of Berwin

Thence S 30 E 390 us to cor

Thence S 60 W 666 us to place of beginning  
Corrected March 18/89

I certify that the foregoing plat and  
field notes are correct according  
records of this office.

Recorded B. N. O. P. 359

James M. Wells  
Co Surveyor

File (5) 4721

"Milam. Pump"

S. Johnson,

Cart<sup>a</sup> D. Notes

Field  
March, 2 of 89  
Shelley  
C.C.

Don't close by 3000 -  
Calls - 530 E 672 - 760 690 -  
N 30 W 1278 - 560 W 672 -  
530 E 216 - 760 E 358 -  
530 E 390 - 560 W 666 -

Mich 26/89  
M.M.

Cancelled

137

4721 mil Pre

J. B. Weeks, Surveyor,

BOSQUE COUNTY.

Meridian, Texas, June 19<sup>th</sup> 1889

Corrected field notes made for B Johnson of 160 acres of land the quantity to which he is entitled by virtue of his affidavit of occupancy issued by J. G. Gibbs a Notary Public of Bosque County Texas on 24<sup>th</sup> Day of March 1885.

Said Land is situated in Bosque County Texas on the waters of Turkey creek, about 13 miles South<sup>27 E</sup> from Meridian. Begin at N E cor of C McCurry Survey, Thence S30 E 672 ms to NW cor of W H Maples Thence N60 E 672 ms to cor in N B line of said Maples, Thence N30 W 672 ms to cor a pile of rocks, Thence N60 E 278 ms to cor in W B line of Saml Newton a mound Thence N30 W 910 ms to pile of stone for cor also in W B line of said Newton Thence S60 W 672 ms to cor in E B line of P Armeson a pile of stone for cor Thence S30 E 522 ms to extreme NW cor of O K Berven. Thence N60 E 388 ms to said Bervens N E cor Thence S30 E 388 ms to S E cor of said Berven Thence S60 W 666 ms to place of beginning

Corrected June 19<sup>th</sup> 1889

The State of Texas }  
County of Bosque }

I James N Weeks Surveyor of Bosque County Texas do hereby certify that the foregoing plat and field notes is correct according to records in this office, and Recorded B. Note.

James N Weeks  
Surveyor 1865

File 474.

Milam Preempt

J. Johnson

~~Cur. App. 2062~~

~~Filed January 29~~

~~Shelley~~

~~Conflicts with M. Ericson~~

~~P. 3957 & covers P. 3945~~

~~otherwise correct on~~

~~map of Bosque County~~

~~July 6/89~~

~~Patent July 17/89~~

~~P. M. King~~

Also conflict with P. 3062 plus

u/c June 28  
1889

*[Faint, mostly illegible handwritten text, likely bleed-through from the reverse side of the page.]*

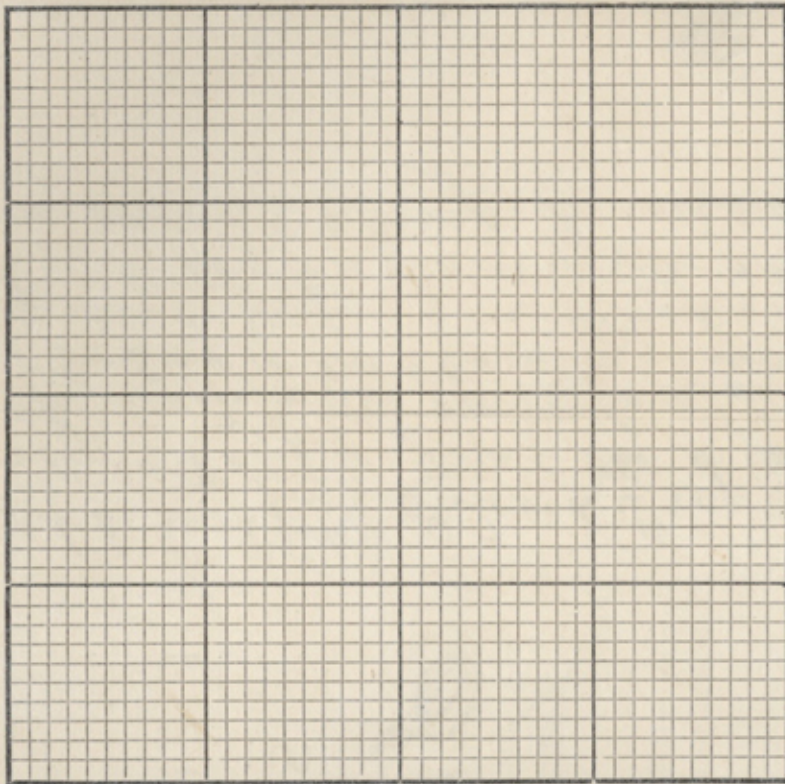

THE STATE OF TEXAS, } Survey  
County of Bosque } No. 160  
Corrected  
FIELD NOTES of a Survey of 160

acres Land made for  
Samuel Johnson  
it being the amount  
of land to which  
he is entitled  
by virtue of  
this affidavit of  
discovery  
before G. Gibbs J.P.  
of B.C. March 24, 1885

Scale ..... Varas per Inch. Variation .....

Said Survey is No. .... in Bosque County, Texas, situated on the  
waters of Turkey creek, a tributary of Bosque River,  
about 3 1/2 miles S 206 of Meridian

BEGINNING at N.E. cor of Columbus McCurry  
Survey

- Thence S 306 672 vars pile of rock for corner in McCurry's line from which a L.O. mkd X bns. N 57. W. 35 vars.
- Thence N 606 672 vars pile of rock for cor.
- " N 30 W 672 " " " " "
- " N 60 E 216 " " " " in line of S.R. Newton Survey.
- Thence N 30 W 992 vars pile of rock for corner in W. line of S.R. Newton Surv.
- Thence S 60 W 610 vars pile of rock for corner in E. line of P. Arneson Survey
- Thence S 306 604 vars. pile of rock for cor.
- " N 606 388 " " " " "
- " S 306 388 " " " " "
- " S 60 W 666 " " " " "



to the place of beginning.

*correcting*  
Aud. Christoffer  
Jno. Anderson.  
Chain Carriers.

Bearings marked

Re Surveyed *June 5*  
*March 28* 1895

*J. J. Stewart*  
*J. H. Miller*

I, *Tom L. Greer*, County Surveyor of *Bosque* County, Texas, do hereby certify that the foregoing described Survey was actually made by me on the ground, according to law, on the date and with the Chain Carriers aforesaid, duly qualified, and that all the Corners, Lines, Boundaries and Marks of the same, whether natural or artificial, are truly and correctly described and set forth in the foregoing Plat and field Notes.

By *Tom L. Greer* Deputy. County Surveyor *Bosque* County, Texas.

Filed for Record the *6* day of *June* 1895, at *9* o'clock *9* M., and duly Recorded the *6* day of *June* 1895 Book *6* Page *305*  
*Tom L. Greer* SURVEYOR

E 541

No. ....

FIELD NOTES  
OF A  
SURVEY  
MADE FOR

*Severin*  
*Johnson*

*Tom Greer* Surveyor,  
*Bosque* County, Texas.

8-93-10

Addit. Certificate I, Tom Greer, Co. Surveyor do hereby certify that the S. Johnson survey conflicts with S. R. Newton survey 62 vrs. in N. 60 E. S. 60 W. calls. This was determined by running out Johnson's notes and they ran 62 vrs into S. R. Newton survey. The above notes extend this N. on vacant strip to include 160 acres.

*Tom Greer,*  
Co Surveyor,  
Bosque Co. Tex.

Bill 4921

Milam P.

S. Johnson

Cor. 7/Notes

Bills June 7, 95.

Report of  
Chief Clerk

Correct on map  
of Bosque County  
June 11th 1895

to Hill

Patented July 12<sup>th</sup> 1895

Dawson

cc 6/11/95  
Hill

State of Texas } This is to  
County of Bosque } Certify that  
I, Serrin Johnson, of Bosque  
County, Texas do now  
own and am living  
on the Serrin Johnson  
Pre-emption Survey and  
that I have never sold-  
contracted to sell, nor in  
any way transferred my  
claim to the same since  
filing my application  
for Homestead & Survey.

Signed Serrin Johnson

Given to and subscribed before me this 25<sup>th</sup> day of  
June 1895.

G. J. Lingo

Notary Public, Bosque County, Texas.

File 4721 8  
Mil. Premption  
A. of Ownership  
S. Johnson  
Filed June 28/1895

H. J. Potts  
Chief Clerk

