

Bosque Co. 84

File 4500.

1183

Milam

PRE-EMPTION.

Warren Lucy

160 Acres.

Act May 26, 1873

Correct on maps of Bosque
County Aug 26 85
Nov 12 86 C. M. Hill

Correct for patenting
Nov 19 86. W. H. Hill

Patented Nov 24 86
No. 100 4219
mkd pld 4 Reg

Mgl. 19839

10
of 16.100
84

CONTENTS.

- No. 1. Affidavit.
- No. 2. Field Notes.
- No. 3. Application
- No. 4. Consent
- No. 4. Cert of Company
- 11/9/86 Deed

\$5.00 Def 11/9/86 by
Warren Lucy
Mentioned
Sept 27 85 to
Lucy

AFFIDAVIT FOR PRE-EMPTION.

THE STATE OF TEXAS,

COUNTY OF BOSQUE.

Before me, Wm. Maudslayi Clerk of the County Court of Bosque
County, this day personally appeared Warren Tracy
to me known, who after being by me duly sworn, upon his oath deposes and says: that he is now a
bona fide settler upon 160. acres of Land, that he believes to be of
the public vacant lands of the State of Texas; that he is improving said land for a Homestead, and
has no other; and further that he is a married man and
and makes this Affidavit for the purpose of obtaining a Home. Said Land is situated in Bosque
County, about 18 miles S. E. from Meridian, on the waters of Coon Creek:
beginning at the S. W. of J. W. Stack Survey

and more particularly described by the accompanying field notes.

Given under my hand and the seal of the County Court of Bosque
County, at office, in the Town of Meridian, this 3d
day of Sept A. D. 1883

Wm. Maudslayi
Clerk County Court, Bosque County, Texas.

By _____ Deputy.

No. _____

Warren Lacy

Affidavit for Pre-emption.

ISSUED

the *30th* day of *Sept* 18*63*

G. H. Randal

C. C., B. Co.

By _____

Deputy.

M. Strickland, Stationer and Printer, Galveston.

① File 4500.

*William
Preemption
Warren Lacy.*

*Affidavit
filed Nov 28/64.*

D. N. Robinson

Chief Clerk

Scale, _____ Varas to the Inch.
Variation,

The State of Texas, } Survey No. _____
COUNTY OF BOSQUE.

Field Notes of a Survey of 160 acres

of land made for William Lacy
it being _____ the land to which
entitled by virtue of Six certificate of occupancy
issued by the County Clerk of Bosque
County on the 3rd day of Sept 1883

Said land is situated on the waters of Coon
creek about 1 1/2 miles S & E from Meridian
beginning 264 or 308 from the NW cor of Jesse
Cordova League a pile of rocks for the SE cor of
this sur thence N 50 W 239 or N prang of Coon creek
9 + 8 or a branch 1344 or to the W cor a pile of
rocks thence S 60 W 672 or to the SW cor in the East
line of ~~1/2~~ ^{Branch} ~~S. B. S.~~ sur a pile of rocks thence S 30 E
286 or retrace the branch 1232 or retrace Coon
creek 1344 or to the SW cor a pile of rocks
thence N 60 E 672 or to the place of beginning
M. J. Brittain } c Surveyed August 30th 1885
Jahn Taylor } c

I S. J. Siddall County Surveyor
of Bosque County I do hereby certify that the
foregoing survey was made according law and that
it was actually made on the ground and that
the field notes are recorded in my office in
Book C page _____ and that it was run on
a variation of 10 1/2 degrees

S. J. Siddall
County Surveyor of
Bosque County Texas

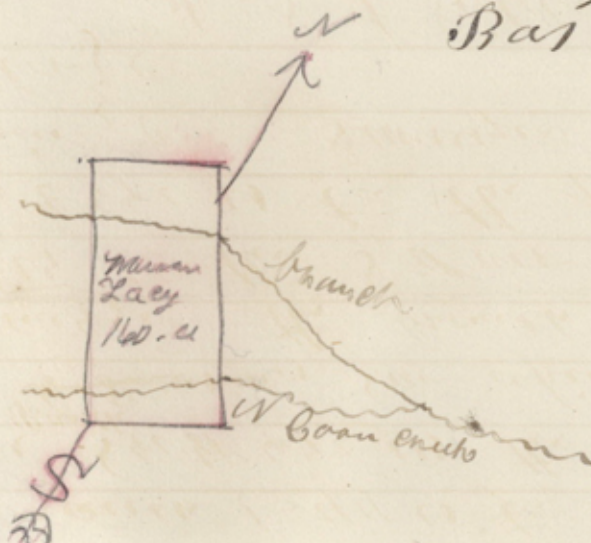

Warren Lacey vs
Field Notes

(2) Title 1500.
Milam
Preemption
Warren Lacey.
Field Notes
160 acres.

file Nov 25/84.
D N Robinson

Chief Clerk

Correct map of Bosque
County Aug 26/85
Nov 2/86 R. M. Hill

Patented Nov 24/86
Bosque

The State of Texas } I hereby make application to the
County of Basque } County Surveyor of Basque County,
Texas, to survey me one hundred and eight
acres of land by virtue of my certificate of occupancy
issued by the County Clerk of Basque County, the
3rd day of Sept 1883 said land is situated on
the waters of Coon Creek about 18 miles S E from
Meridian Beginning at the S W cor of J H Sticks
640 acre survey then run so as to include 180
acres this the 3rd day of Sept 1883

Wm Lacy

I S J Siddall County Surveyor of Basque
County Texas do hereby certify that the foregoing
application is a true and correct copy of original
as recorded in Surveyors file Book page 230

S. J. Siddall
County Surveyor of Basque
County Texas

③ File 4500.

William

Preception

Warren Lacy

Application

filed Mar 25/84.

D N Robinson

Chap. Clerk

Proof of Settlement under Homestead Act.

4500

The State of Texas,

County of Doaguel

Before me, the undersigned County Clerk in and for the County aforesaid, this day came and personally appeared Warren Lacy a resident citizen of said County, who being by me duly sworn, declares that he is a bona fide settler upon 160 acres of vacant public land, situated in said County, and surveyed for Warren Lacy on the 28th day of August 1883 by S. J. Biddall a Surveyor of said County; that he has occupied and improved the same as a Homestead for a period of three consecutive years, beginning on the 28th day of Aug 1883 that he is married man and that he makes affidavit for the purpose of obtaining a title to the same for a Homestead, under an Act supplementary to "An Act for the Benefit of Actual Occupants of the Public Lands," approved May 26th, 1873, and Acts prior thereto; and that he has not a Homestead other than the above.

AND also, at the same time came and personally appeared Henry Lacy and J. M. Williams two credible resident citizens of said County, to me well known, who being duly sworn, depose and say that Warren Lacy the person first above named in this Affidavit; has actually settled upon and cultivated as a Homestead, the land surveyed for him on the 28 day of aug 1883 by the Surveyor aforesaid, for the period of three years, and they nor either of them have any interest in the said land.

Warren Lacy
Henry Lacy
J. M. Williams

(SWORN TO and subscribed before me, and I hereby certify that Henry Lacy and J. M. Williams are credible and trustworthy citizens of said County.

IN TESTIMONY WHEREOF, I have hereunto set my hand and affixed the Seal of said County, at office, this 4 day of Nov 1884

Geo. W. Roush
Clerk County Court Doaguel Co.

PROOF OF
SETTLEMENT OF LAND

Warren Lacy
Settler.

④ File 4500.
Milam Precinct
Warren Lacy.
Cert of
Occupancy
Filed Nov 9/86.
D N Robinson
Inspector.