

File

Angel County.

1058. OK

1086-7

MILAM PRE-EMPTION.

L. P. Taylor

100 Acres.

OK

May 26, 1873.

Old Wrapp inside
Correction map of
Sosque County April 30/90
H. C. Hill

second endorsement
on writ. pt. of our
papers.

cancelled by writ. No. 26
1797 8. 1/2

131.

c 52017
2 2/11/89

CONTENTS.

No. 1. Affidavit.

No. 2. Field Notes.

No. 3. ~~Old Wrapp~~

No. 4. Cert of Occupancy
12/14/89. Lamin

5 aff-of abund on
writ 2203 E

W. J. Graham
Bourne

AFFIDAVIT FOR PRE-EMPTION.

THE STATE OF TEXAS,

COUNTY OF BOSQUE.

Before me, *S. A. Gallie*, Clerk of the *Bosque* Court of Bosque County, this day personally appeared *J. P. Labor* to me known, who after being by me duly sworn, upon his oath deposes and says: that he is now a bona fide settler upon *Six One Hundred & sixty* acres of Land, that he believes to be of the public vacant lands of the State of Texas; that he is improving said land for a Homestead, and has no other; and further that he is a *Married* man and makes this Affidavit for the purpose of obtaining a Home. Said Land is situated in Bosque County, about *12* miles *"E"* from Meridian, on the waters of *Adron* Creek: beginning *at Danah Hensley, line on the Danah.* and more particularly described by the accompanying field notes.

Given under my hand and the seal of the *Bosque* Court of Bosque County, at office, in the Town of Meridian, this *1st* day of *August* A. D. 18*71*

S. A. Gallie
Clerk *Co* Court, Bosque County, Texas.

By

Deputy.

No. _____

J. P. Labor

Affidavit for Pre-emption.

ISSUED

the *1st* day of *August* 18*81*

J. A. Bacon

C. C., B. Co.

By _____

Deputy.

M. Strickland, Stationer and Printer, Galveston.

11050
Mexican President
J. P. Bacon
affidavit
Dec. 15/81
part of
city ed.

VALID FOR RECORD

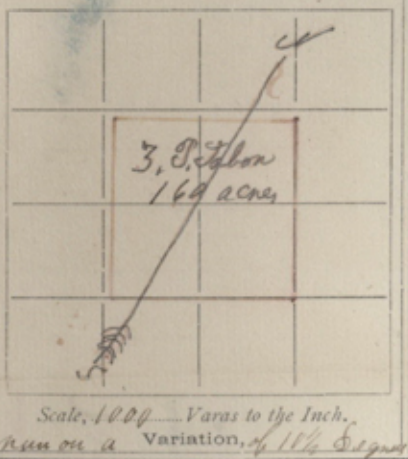

The State of Texas, } Survey No. _____
 COUNTY OF BOSQUE. }

Field Notes of a Survey of 160 acres

of land made for Z P Labor

it being _____ the land to which he is

entitled by virtue of his certificate of occupancy

issued August 1st 1881 said land is

situated on the waters of bedman Creek about ~~1 1/2~~ ^{1 1/2} miles East from Meridian

Beginning at 264 N S 60 W from the N W corner of the Luis Bardin sur pile of rocks for the N E cor of this sur from which a Spanish Oak marked X bears S 60 W 38 N and a Live Oak marked X bears S 6 1/2 E 44 N Thence S 30 E 950 N to S E cor pile of rocks from which a Spanish Oak marked X bears N 60 E 1 N Thence S 60 W 950 N pile of rock for the S W cor Thence N 30 W 950 N the N W cor at stake on the South line of Sarah Hensley League Thence N 60 E 950 N to the place of beginning Surveyed Dec 22nd 1881

W. Shaw 30

Z. P. Labor } I S. J. Siddall County Surveyor of Bosque
 County do hereby certify that the foregoing survey was made according to law and that it was actually made on the ground and that the field notes are recorded in my office in book 6 page 84

S. J. Siddall
 County Surveyor

The State of Texas }
 County of Bosque } I hereby make application to the County
 Surveyor to survey me 160 acres of land by virtue of my
 certificate of occupancy issued by the County Clerk of
 Bosque County August 1st 1881. Beginning on the South line
 of the Sarah Hensley League dated December 3, P. Labor

I S. J. Siddall County Surveyor of Bosque County
 do hereby certify that the foregoing application is true
 copy as recorded in Surveyors file book page 175

S. J. Siddall
 County Surveyor

Z P Labor, Past office address

Whitney, Texas

Tract 4050

Mican Precinct

J. P. Faber

Tract No 65

160

Acres

Tract Dec. 15/82
D. Robinson

Do. et

Correct on map of
Dodge County July
18/89
april 30/90
C. M. Hill

Feb 2/89
2/11/88
Dec 17/89

3

Bosque Co.

File 11050

Milam

PRE-EMPTION.

J. P. Sabon

No 160 Acres

Act May 26th 73

Correct on map of
Bosque County July
18/89 C. Mc Hill

As proof of occupancy
July 18/89 Grant

Mgl. 17978

July 2
1889

Fragment of another document with handwritten text, including "July 18/89" and "Sid..."

4050 miles

The State of Texas }
County of Bastrop } before J. H. Nygaard
Justice of the Peace and ex officio Notary
Public in and for Bastrop County Texas
This day came R. P. Taber who being by me
duly sworn and on his oath deposes and
says that he was a bona fide settler
upon 160 acres of vacant Public land
situated in Bosque County Texas
surveyed for J. P. Taber on the day
188 by Surveyor of said
county that he occupied the same
and improved it as a homestead for
three consecutive years beginning on the
1 day of July 188 and that he make
affidavit for the purpose of obtaining
a title to the same for a homestead under
an act supplementary to an for the benefit
of actual occupants of Public lands
approved May 26th 1873 and acts prior thereto
and that he has not a homestead other than
the above - R. P. TABER

Stated, sworn to and subscribed before me
This the 20th day of November A. D. 1889
J. H. Nygaard J. P. and ex officio Notary
Public. Bastrop County Texas

affidavit of
R. P. Taber

The State of Texas }
County of Bastrop } before me J. H.
Nyegaard a Justice of the Peace and
ex officio Notary Public in and for
Bastrop County Texas this day came
before me W. J. Faber and M. R. Faber
who being by me duly sworn each
deposes and says that ^{they} knew R. P. Faber
when he lived in Bosque County
Texas and that he lived on a tract of
land and that said R. P. Faber told
them that he bought said land
from his son J. P. Faber and that his
~~son~~ and that said land was taken up
by his son as vacant Public land and
that said R. P. Faber claimed said
land as his homestead.

W. J. Faber
mark
M. R. Faber

Tested, subscribed and sworn to
before me this the 20th day of November A. D. 1859
J. H. Nyegaard J. P. and ex officio
Notary Public
Bastrop County Texas

④ Fee 4050.

Milam Preempt

J. P. Tabor.

Cert of
Occupancy

Jan Dec 1884

R. M. Miller

Chiswick

8-1-81

12-12-81

12-10-82

This is not sufficient
The claimant must
show continuous
occupancy for three
consecutive years by
the Org applicant, or
the Org applicant & app.
in consecutive receipt
by witnesses residents
of the County where
the land lies
May 1890

Graves

THE STATE OF TEXAS,)

County of

Bosque

BEFORE ME,

D. J. Cutbirth

County Clerk

in and for said County, State of Texas, this day personally came and appeared

J. B. Arnold, E. J. W. Ogden

J. B. Arnold

to me well known, and who, after being by me duly sworn, did depose and say

That he knows the J. P. Taber 160 acre preemption conveyance on
Bedon Creek in Bosque County Texas about 15 miles S.E.
of Meridian; that he knew J. P. Taber personally; That
said J. P. Taber never did move on to or live on said
160 acre preemption ^{for a term of three years} and that no other person, claiming
under said Taber or otherwise has ever lived on said
land since it was undertaken to be preempted by
said J. P. Taber

*J. B. Arnold
E. J. W. Ogden
J. B. Arnold*

Sworn to and subscribed before me. Witness my hand and seal of office, in

Meridian Texas

this the

24

day of

January

A. D.

1892

*D. J. Cutbirth County
Clerk Bosque*
County, Texas.

By

J. M. Hall

Deputy.

E 681*

No.

AFFIDAVIT

OF

TO

Filed..... 189.....

Clerk,

Deputy.

By

Filed.....

2-2-1903

J. Robinson
Clerk

File 4050 (5)

Posque County,
Milton Pr Camp
J. P. Taber,
appears
of abridgment

	9	244
Taber	506	506
	950	
Heart	347	
	3	
Argentz	289	
	410	2194
Webb	88	
	05	
	04	6724
	910	

$$\begin{array}{r} 310 \\ 390 \\ \hline 360 \end{array}$$

~~B-140~~

~~P-13885~~

~~P-3296~~

3-1945-

B-1389

P-4050

11-4499

File 4050 - List 5

THE STATE OF TEXAS,

KNOW ALL MEN BY THESE PRESENTS:

COUNTY OF Atascosa

That

Zeb. P. Faber and W A Faber wife of Zeb. P. Faber

of the County of Atascosa and State aforesaid, in consideration of the sum of one
hundred and fifty DOLLARS,

to me in hand paid by R. P. Faber

the receipt of which is hereby
acknowledged

have GRANTED, SOLD AND CONVEYED, and by these presents do GRANT, SELL AND CONVEY unto the said

R. P. Faber

of the County of Bosque and State of Texas all that certain

160 acres of land, about 12 miles
E from Meridian on the West
of Cedron Creek in Bosque County
Texas, Beginning 264 vrs S 60 W from
the N W corner of the Ennis Harder
Survey, a pile of rocks from which
a Spanish oak marked x vrs S 60 W
38 vrs, and a live oak marked x vrs S 61 1/2 E
44 vrs thence S 30 E 950 vrs to the S E
corner a pile of rocks from which
a Spanish oak marked x vrs N 60 E
vrs, thence, S 60 W 950 vrs a pile of
rocks for the S. W. corner, thence
N 30 W 950 vrs a stake the South
line in the Sarah Kousley league
thence N 60 E 950 vrs to the place
of beginning — Being the preemption
Survey of 160 acres of Zeb. Faber

TO HAVE AND TO HOLD the above described Premises, together with all and singular the rights and appurtenances thereto in anywise belonging, unto the said R. P. Taber

his heirs and assigns, forever. And I do hereby bind myself

heirs, executors and administrators, to WARRANT AND FOREVER DEFEND; all and singular, the said premises unto the said R. P. Taber his

heirs and assigns, against every person whomsoever lawfully claiming or to claim the same, or any part thereof

WITNESS my hand at Bexar County Texas this 21st day of May A. D. 1883.

Signed, Sealed and Delivered in Presence of

W. A. Taber
mark

THE STATE OF TEXAS, }
County of Bexar } BEFORE ME B. F. Avenir Justice of the
Peace and Ex officio Notary Public
in and for Bexar County, Texas, on this day personally appeared W. A. Taber
known to me

to be the person whose name is subscribed to the foregoing instrument, and acknowledged to me that he executed the same for the purposes and consideration therein expressed.

Given under my hand and seal of office, this 21st day of July A. D. 1883.

B. F. Avenir
Justice of Peace & Ex officio Notary Public for Bexar County Texas

The State of Texas } Before me B. F. Avenir Justice of the Peace
County of Bexar } and Ex officio Notary Public in and for
Bexar County, Texas on this day personally appeared W. A. Taber
known to me to be the person

whose name is signed to the instrument of writing jointly with her husband and after being examined by me separate and apart from her husband and having the fully explained to her she the said W A Taber acknowledge to having signed the same for the purpose and considerations therein expressed and did not wish to retract it

Given under my hand and seal of office this 24 day of July A D 1883

B F Abbott
Justice of the Peace & ex officio Notary Public for Bexar County Texas

THE STATE OF TEXAS,

County of _____ } I, _____ Clerk of the

County Court of said County, do hereby certify that the above instrument of writing, dated on the _____

day of _____ 188____, with its certificate of authentication, was filed for record in my office, this

_____ day of _____ A. D. 188____, at _____ o'clock _____ M., and duly recorded the

_____ day of _____ A. D. 188____, at _____ o'clock _____ M., in the records of said

County, in volume _____ on pages _____.

WITNESS my hand and the seal of the County Court of said County, at office in

_____ the day and year last above written.

Clerk C. C. _____ County.

[Faint, mostly illegible handwritten text and markings covering the bottom half of the page, including what appears to be a signature and various scribbles.]

WARRANTY DEED.

— TO —

FILED FOR RECORD

_____ 188____,
at _____ o'clock and _____ minutes _____ M.

Recorded _____ 188____,

in _____ County Record

of _____ Book _____

Page _____

_____ Clerk.

_____ Deputy.

37 File 4050

Mrs. M. P. Taber
J. P. Taber

J. P. Taber & Wife
to } Transfer

R. P. Taber

Filed Dec 14/89

W. H. Kelley

Chas. H. [unclear]