

File 3662

MILAM PRE-EMPTION.

O. K. Perren

160 Acres.

Act

Correct on map of Boone County. Decemb. 20/80
C. W. Profles.

Correct for patenting June 9/81 Wash.

Patented June 10/81
mkt pld Gaitter

No. 306 Vol 12
111 Kd ptd Reg.

Mgl. 16094

c.c. 152 c 2/80
c.c. 177 N 80

CONTENTS.

No. 1. Affidavit.

No. 2. Field Notes.

Nov 30/80

Walton

15 cent of occupancy
June 8/81 Wash.

James M. Robertson

AFFIDAVIT FOR PRE-EMPTION.

THE STATE OF TEXAS,

COUNTY OF BOSQUE.

Before me, J. M. Carrier Clerk of the County Court of Bosque
County, this day personally appeared O. B. Berven

to me known, who after being by me duly sworn, upon his oath deposes and says: that he is now a
bona fide settler upon One Hundred Sixty acres of Land, that he believes to be of
the public vacant lands of the State of Texas; that he is improving said land for a Homestead, and
has no other; and further that he is a married man

and makes this Affidavit for the purpose of obtaining a Home. Said Land is situated in Bosque
County, about 14 miles "S" from Meridian, on the waters of Ruskey Creek:
beginning at under Jantsons D. N. Co.

and more particularly described by the accompanying field notes.

Given under my hand and the seal of the County Court of Bosque
County, at office, in the Town of Meridian, this 5th
day of April A. D. 1870

J. M. Carrier
Clerk of Court, Bosque County, Texas.

By J. M. Carrier Deputy.

Y File 3662
Milam Preemption
OK Bern
affidant (and)
Designation
Filed Nov 30/88



Phoebe A. Bern
By *S. A. Carver* Deputy
C. O. C. B. Co.

S. A. Carver
the 11th day of April 1888

ISSUED

Affidavit for Pre-emption.

S. A. Carver

do.

THE FEDERAL BUREAU OF INVESTIGATION

The State of Texas, ³ Fieldnotes of a survey
County of Bosque, ² of 160 acres of land
made for O.K. Bervin by virtue of
his affidavit made before the County
Clerk of Bosque County Texas on the
5th day of April ^{AD 1880}

Said land is situated ^{in Bosque County} on the waters of
Turkey Creek about 13^{3/4} miles South ^{20° East} from
Meridian in ~~Bosque County Texas~~ and
bounded as follows to wit:

Beginning at the S.W. corner of Andrew
Jenson's pre-emption survey in East
line of Samuel J Ross, a pile of rocks.
Thence N 60° E with Jenson and ^{P. Amerson's} ~~Attorney's~~
line 1900 rods to a pile of rocks being
P Amersons S.E. corner; Thence N 30° W
with Amerson's east line 26 rods to a
pile of rocks on the mountain; Thence
N 60° E 388 rods to a pile of rocks
for N.E. corner; Thence S 30° E 388
rods to a pile of rocks for S.E. corner;
Thence S 60° W with the north line
of a survey once made for Bell ^{Curry}
1448 rods to a pile of rocks from which
a Live Oak bears S 86° E 5 rods and
another bears S 42° E 18 rods;
Thence S 30° E 620 rods to a pile
of rocks being Wm Mc Curry's N.E.
corner from which a Live Oak

mkt E bears at $12\frac{1}{2}$ E 374 rods;
Thence S 60 W 740 rods crossed a branch
S 40 rods to a pile of rocks in Samuel
J Ross east line from which an
Elm mkt F bears S $16\frac{1}{2}$ E 69 rods
the same being W^m McCarry's at W corner;
Thence at S 0 W 742 rods to the
beginning.

Surveyed Oct 13th 1880.

A person of James M Robertson
Durrud Co Leachy Surveyor Bosque Co

The State of Texas, 3 James M
County of Bosque, 7 Robertson Co
Surveyor of Bosque County do
hereby certify that the above
survey was made in the field
according to law and that
the same is correct and
does not conflict with ad-
joining surveys. I also certify
that the survey was made at
a magnetic variation of
 $10\frac{1}{2}$ degrees magnetic varia-
tion and that the same is
recorded in my office in
Book C on page 39

James M Robertson
Co Surveyor of Bosque Co Tex

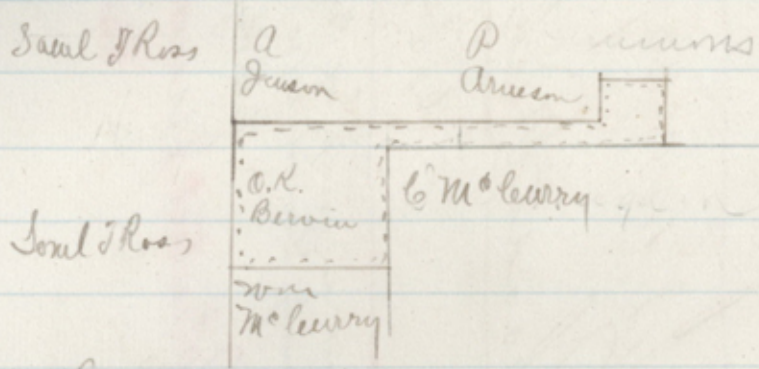

The State of Texas, J. I. Jones, Co. Rob-
 County of Bosque, Denton County
 Surveyor of Bosque County do
 hereby certify that the above
 is a rough Plat of the pre-
 emption of O.K. Bervin or
 made by me

Jones, Co. Rob-
 County Surveyor
 Bosque County Tex

²/₁ File 3662
Milano Preemption

O. K. Perrom

160 acres

field notes

Filed Nov 30/80

Rhoads & Hixson

Chfclerk

Correct and map of Bouque
County. Decemb. 20/80

L. W. Pfeiler.

Patented June 10/81

Gaither

O. K. Perrom

File 3662

Proof of Settlement under Homestead Act.

The State of Texas,

COUNTY OF Garza

3662
muen P-22

Before me, the undersigned J. A. Collins Clerk in and for the County afore-
said, this day came and personally appeared O. K. Gerren

a resident citizen of said County, who being by me duly sworn, declares that he is a bona

fide settler upon (160) acres of vacant public land, situated in said County,

and surveyed for O. K. Gerren on the 13th day of

October 1879 by Jos. W. Robertson a Surveyor of

said County, ; that he has occupied and improved the same as a Homestead for a period of

three consecutive years, beginning on the 10th day of July 1877

that he is Married Man and that he makes this affidavit for the

purpose of obtaining a title to the same for a Homestead, under an Act supplementary to

"An Act for the Benefit of Actual Occupants of the Public Lands," approved May 26th,

1873, and Acts prior thereto; and that he has not a Homestead other than the above.

AND also at the same time came and personally appeared Andrew Stark

and Andrew Daxland two credible resident citizens of said County, to me

well known, who being duly sworn, depose and say that O. K. Gerren

the person first above named in this Affidavit, has actually settled upon and cultivated as a

Homestead, the land surveyed for him on the 13th day of October 1879

by the Surveyor aforesaid, for the period of three years, and they nor either of them have

any interest in the said land.

O. K. Gerren
Andrew Stark
Andrew Daxland

SWORN TO and subscribed before me, and I hereby certify that Andrew

Stark and Andrew Daxland are credible and

trustworthy citizens of said County.



IN TESTIMONY WHEREOF, I have hereunto set

my hand and affixed the Seal of said County, at

office, this 14th day of July 1879

J. A. Collins

Clerk Court Co.

7
81

3/ File 2662

Milam Proclamation

O. K. Brown

Cert of occupancy

Filed June 8/81

Rhodes Hixey
Clerk

1-10

6-10

Seller.

O. K. Brown

SETTLEMENT OF LAND

PROOF OF