

File

3626

Bozque Co N

MILAM PREEMPTION

Peter Thompson

166 Acres

Act August 19. 1876

Corrected map of Bozque
County Feb 27/86 Mc Hill

Correct for Patent of the
original marshes
Patent

Patented March 20/86

No. 19476.18

J. M. Cunningham

March 20/86

9/5/10

Mgl.

15963

Oct. 28

11/11/80

CONTENTS.

No. 1. Affidavit & designation

No. 2. Field notes

Oct. 20/86

Beck

3- Proof of Occupancy

3/27/82

Meatman

4. bot. field notes

2/25/86 Hoff

Reports Oct 25/83
to Peter Thompson
Mendenhall

500 Det by T. A.

Collier

3/27/82 Mendenhall
J. X

AFFIDAVIT FOR PRE-EMPTION.

THE STATE OF TEXAS,

COUNTY OF BOSQUE.

Before me, John H. Johnson, Clerk of the District Court of Bosque County, this day personally appeared Peter Thompson, to me known, who after being by me duly sworn, upon his oath deposes and says: that he is now a bona fide settler upon one hundred and sixty (160) acres of Land, that he believes to be of the public vacant lands of the State of Texas; that he is improving said land for a Homestead, and has no other; and further that he is a Married man and makes this Affidavit for the purpose of obtaining a Home. Said Land is situated in Bosque County, about 5 miles South from Meridian, on the waters of Bee Creek: beginning at the N.E. Corner of Law Neilson Survey, and more particularly described by the accompanying field notes.

Given under my hand and the seal of the District Court of Bosque County, at office, in the Town of Meridian, this 17th day of June A.D. 1879.

John H. Johnson,
Clerk District Court, Bosque County, Texas.

By _____ Deputy.

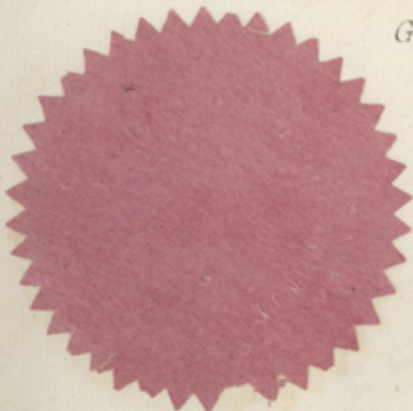

No. _____

Peter Thompson,

Affidavit for Pre-emption.

ISSUED

the *17th* day of *June* 187*9*,

John H. Johnson,
C. B., C., B. Co.

By _____

Deputy.

M. Strickland, Stationer and Printer, Galveston.

*Filed for record Feb
10th 1880 and
recorded some day.
James M. Robertson
Co Surveyor D.C.T.*

FILED IN THE OFFICE OF THE SURVEYOR

Peter Thompson

Resurrection Survey



File 3626

Milam Preemption

Peter Thompson

Affidavit & designation

filed Oct. 20/86

Rhoads Fisher
Clerk

The State of Texas Field notes of a survey
County of Bosque of 160 acres of land
made for Peter Thompson by virtue of his
affidavit made before the District Clerk
of Bosque County Texas on the 17th day
of June A.D. 1879. Said land
is situated in Bosque County Texas
about 6 miles south of Meridian.

Beginning at the N.E. corner of
Lars Neilson's survey a pile of rocks,
Thence S 30° E 950 varas to a pile of
stones in Neilson's east line;

Thence N 60° E 483 varas to a pile
of rocks in the west line of a survey
made for Whitworth; Thence N 30° W
with the line of Whitworth and
Greer surveys 1708 varas to a
pile of rocks whence a cedar
bears S 61° W 126 varas; Thence
N 60° W 586 varas to a pile of
stones in the east boundary
of Joe Jeanan survey; Thence
S 30° E crossing a branch 758
varas to the S.E. corner of Joe Jeanan
from which a Spanish Oak mtd K bears
S 81° E 50 varas and another mtd L bears
S 79° E 56 varas. Thence N 60° E 103
varas to the beginning

Surveyed March 30th A.D. 1880.

O. Erikson 3C
J. Dorsette 3C

James M. Robertson
Co. Surveyor Bosque Co. Tex

The State of Texas & James M. Robertson
County of Bosque & County Surveyor of
Bosque County Texas do hereby
certify that the above survey
was made according to law and
and that the limits and bound-
aries thereof are truly describ-
ed in the same. Magn. variation
10 1/2 degrees

James M. Robertson
Co. Surveyor Bosque Co. Tex

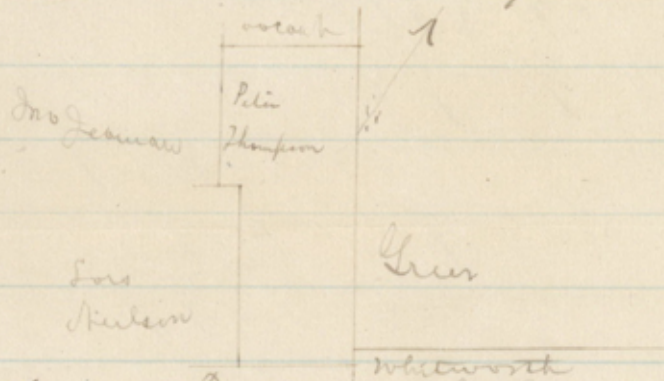

The State of Texas & James M. Robert-
son County of Bosque & County Surveyor of
Bosque County Texas do hereby
certify that the above is a true
plat of the foregoing land as
set forth in the above field
notes and that the same are
truly recorded in my office
in Book C page 31

James M. Robertson
Surveyor Co. Bosque Tex

2
File 3626

Milam Preemption

Peter Thompson

McC. Acus

Fieldnotes

Filed Oct. 20/80

Chas. H. Fisher
City Clerk

Cancelled by Com. of

FILING FEE PAID

OCT 20 1880

Ch 25
C. H. W. 50

Proof of Settlement under Homestead Act.

The State of Texas,

County of Waukegan

Before me, the undersigned D. A. Collins Clerk in and for the County afore-
said, this day came and personally appeared Pedro Thompson

a resident citizen of said County, who being by me duly sworn, declares that he is a *bona fide*
settler upon 2 1/2 acres of vacant public land, situated in said County, and
surveyed for Pedro Thompson on the 27th day of
March 18 80 by J. M. Robertson a Surveyor of

said County; that he has occupied and improved the same as a Homestead for a period of
three consecutive years, beginning on the 27th day of July 18 77
that he is Married Man and that he makes affidavit for the
purpose of obtaining a title to the same for a Homestead, under an Act supplementary to
"An Act for the Benefit of Actual Occupants of the Public Lands," approved May 26th,
1873, and Acts prior thereto; and that he has not a Homestead other than the above.

AND also at the same time came and personally appeared N. O. Myrtle
and John Robin two credible resident citizens of said County, to me
well known, who being duly sworn, depose and say that Pedro Thompson
the person first above named in this Affidavit; has actually settled upon and cultivated as a
Homestead, the land surveyed for him on the 27th day of March 18 80
by the Surveyor aforesaid, for the period of three years, and they nor either of them have
any interest in the said land.

Pedro Thompson
N. O. Myrtle
John Robin

SWORN TO and subscribed before me, and I hereby certify that D. A. Collins
D. A. Collins and John Robin are credible and
trustworthy citizens of said County.

IN TESTIMONY WHEREOF, I have hereunto set
my hand and affixed the Seal of said County, at
office, this 24th day of March 18 82

Clerk D. A. Collins Court Waukegan Co.

3/ Filed 3626,

Milam Precemption

Peter Thompson

Proof Occupancy

Filed Mech 27/80

Rhoads & Winter
Chyler

9-24-79
3-20-86
98-00-86

PROOF OF
SETTLEMENT OF LAND

Seller.

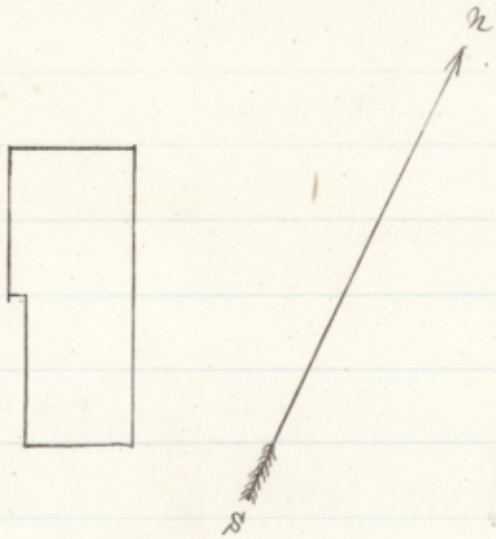

The State of Tex I N B Brandal Co Surveyor of
Co of Basque & Basque Co Tex, hereby certify that
the above survey was made on the
ground and according to Law, and that the
marks, Natural and artificial are truly described
in said field notes and that the same
is recorded in Book C Page 228 of County Surveyor
Records.

N B Brandal Co Sur
Basque Co Tex

The State of Tex^s Corrected field notes of
Co of Basque of 160 acres of land made
for Peter Thompson it being
the land to which he is entitled by
virtue of Certificate of occupancy issued
by the County Clerk, of Basque County
Tex on the — day of — 1878. Situated
on the waters of Bee creek about ^{4 1/2} ~~6~~ miles
South from Meridian

Beginning 281 as
N 30 W from the S E cor of Lars Nilson's
Sec. on said Nilson's East line from
which a Live oak Mk'd V to N 50 W 8 1/2 as
another Mk'd T to N 47 E. 5 1/2 as. Then
N 60 E 52 5' as pile of rock for cor
Then N 30 W. 15 53 as a pile of rocks for cor
Then S 60 W 63 8 as a pile of rocks for NW cor
Then S 30 E 76 7 as a pile of rock for cor
Then N 60 E 114 as a pile of rocks for cor
Then S 30 E 78 5 as to the flow of beginning

Resurveyed by me Dec. 1885.

chain carriers

O Nystol

J Robin

N B Randall

Co Surveyor

Basque Co Tex

4) File 3626
Milam Preempt^{tn}
Peter Thompson

Corrected
Field Notes
Filed Feb y 24/86

D W Robinson
Chf clk

Correct on map of Bosque
County Feb 27/86
C. Hill

Patented Mch 29/86
P. M. Lung

Feb 26/86
C. Hill