

File 3586

CONTENTS.

MILAM PREEMPTION

T. C. Nelson

80 Acres

Act: 3938 Rev. St.  
Hemlock Division

Correct on map of Boisjoc  
County. Decemb. 9/80  
Sept 9/84. Herman Joseph

Correct for patenting  
Sept 9/84 Robinson

Patented Sep 10/84

710787 9/84  
Wm. H. Murray

710787 9/84  
mks. pta. Reg.

Mgl. 15742.

c 520 8/80  
c 7107 80

c July 13  
c 7107 80

No. 1. Affidavit

No. 2. Field notes

3 Cr 47 Dec 6/80  
July 6/80  
Beck

4. P. S. Statement

Feb. 13/83.

To come

Jenkins +

John Robertson

# THE STATE OF TEXAS,

COUNTY OF BOSQUE.

Before me,

A. M. Gallier

Clerk of the County Court of Bosque

County, this day personally appeared

W. C. Nelson

to me known, who after being by me duly sworn, upon his oath deposes and says: that he is now a bona fide settler upon

Eighty (80)

acres of Land, that he believes to be of

the public vacant lands of the State of Texas; that he is improving said land for a Homestead, and has no other; and further that he is a

single

man

and makes this Affidavit for the purpose of obtaining a Home. Said Land is situated in Bosque County, about 11 miles

D.N.

from Meridian, on the waters of

Mustang Creek:

beginning Beginning 200 p 130 W from the S.E. corner of A. C. Deegs or F. C. Howard's map to him and more particularly described by the accompanying field notes.

Given under my hand and the seal of the County Court of Bosque

County, at office, in the Town of Meridian, this

24<sup>th</sup>

day of December A. D. 1879

A. M. Gallier

Clerk of the County Court, Bosque County, Texas.

By F. A. Gallier

Deputy.

File 3586

Milam No. Preemption

A. C. Nelson

Affidavit for Pre-emption.

filed July 6 80

Rhoads <sup>ISSUED</sup> ~~Chief Clerk~~  
the 2<sup>nd</sup> day of Dec. 1879

A. M. Gallie  
C. C., B. Co.

By A. A. Gallie Deputy.

M. Strickland, Stationer and Printer, Galveston.

Filed for Records  
March 5<sup>th</sup> 1882

and recorded  
March 8<sup>th</sup> 1882.

J. M. Robertson  
County Surveyor  
Boysen Co. Tex.  
Fee Oct 20.

500  
250  
250  
250  
250  
250

The State of Texas } Field notes of 80 acres  
County of Bosque } of land made for A.  
B. Nelson by virtue of his Certificate of  
occupancy issued by the County Clerk  
of Bosque County Texas on the 27<sup>th</sup> day  
of December AD 1879. Said land is sit-  
uated about 12 miles S W of Menquan  
on the waters of Mustang Creek and  
more fully described as follows to  
wit: Beginning 200 is N 30° W from  
the S. E. corner of F. C. Howards pre-emption  
survey a pile of rocks from which a  
Live Oak mkd A bears N 4° E 190 is and  
another mkd O bears S 20° W 310 is; Thence  
N 60° E 672 is to a pile of rocks from  
which a Live Oak mkd V bears N 67°  
W 30 is; Thence S 30° E 672 is to a pile  
of stone; Thence S 60° W 418 is to a branch  
672 is to a pile of stone; Thence  
N 30° W <sup>672</sup> to beginning.

Surveyed Feb 6<sup>th</sup> AD 1880

Ole Burnett } C

James M Robertson

Hans Weber } C

County Surveyor B C Six

The State of Texas } I James M. Robertson  
County of Bosque } County Surveyor of Bos-  
que County Texas do hereby certify that  
the above survey is correct and  
made according to law and that  
it does not conflict with survey 5  
Morris & Cummings the distance on the  
ground being greater than is shown on map.

James M Robertson  
County Surveyor of  
Bosque County Texas

A.C. Nelson  
 Milan Prumpton  
 Basque N. C. Nelson

Title 3586

80 Acres  
 Tractudes

Filed July 6 80  
 Charles H. Hinkle  
 Ch. H. Hinkle

Examined by certified field notes

FILED FEB 24 1880

July 13 1880  
 C. H. Hinkle

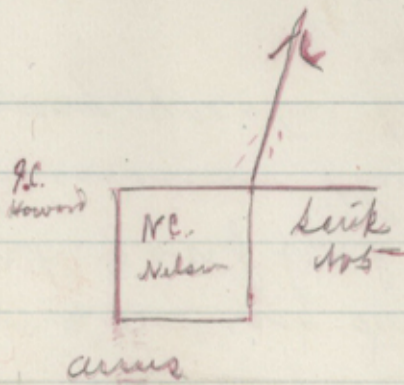

The State of Texas  
 County of Basque, I James M. Robertson  
 County Surveyor of Basque Co  
 Texas do hereby certify that  
 the above plat represents  
 a full, true, and complete  
 sketch of the land described  
 in the foregoing field notes as  
 ascertained by an actual survey  
 on the ground.

James M. Robertson  
 Co Surveyor of Basque Co.

35-86  
milar

The State of Texas, } Corrected field notes of a survey of 80 acres  
County of Bosque, } of land made for A. C. Nelson by virtue  
of his certificate of occupancy issued by the Sec. Clerk of Bos-  
que County Texas on the 26 day of January AD 1880.

Said survey is situated <sup>in Bosque County</sup> about  $9\frac{3}{4}$  miles <sup>65</sup> N from Meridian in  
Bosque County Texas on the waters of Spring Creek bounded as  
follows to wit: Beginning at the S.E. corner of F. B.  
Howards pre-emption survey (formerly ~~Depps pre-emption~~)  
a pile of rocks from which a Live Oak mkd C  
bears N 32 E 162 rods; Thence N 30 W 200 rods to a  
stake from which a Live Oak mkd A bears S 1/2 W  
20 rods; Thence N 60 E 80 rods to a stake in  
<sup>the position of</sup> Scrips survey No 5; Thence <sup>made for Morris & Cummings</sup> S 30 E 600 rods to a  
stake for S.E. corner; Thence S 60 W 1089 rods to  
a pile of rocks. Thence N 30 W 400 rods to a stake  
<sup>59 rods S 60 W from</sup> in Howards, <sup>SW corner</sup> ~~South line~~; Thence N 60 E 1009 rods  
to the beginning. Corrected Nov 27<sup>th</sup> AD 1880.

H. O. Peterson }  
Ole Wenses } C

James M. Robertson  
County Surveyor Bosque Co Tex

The State of Texas, } J. M. Robertson Co Surveyor of Bosque County Texas  
County of Bosque, } do hereby certify that the above survey was made  
according to law and is correct. I also certify that it was  
made actually in the field at a magnetic variation of  $10\frac{1}{2}$  degrees  
and is recorded in my office on Book C page 58

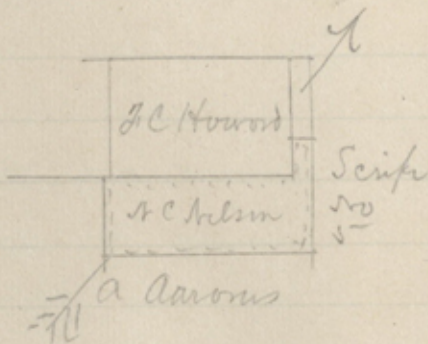

James M. Robertson Co S. B. C. T. Y.  
The State of Texas } J. M. Robertson Co  
County of Bosque } Surveyor of Bosque County  
Texas do hereby certify that the plot to the  
left is a rough diagram of Nelson pre-emption  
as made by me. James M. Robertson  
Co Surveyor Bosque Co Tex

3 / File 3586

Milau Preemptive

N. C. Nelson

80 acres

Corfield notes

Filed Dec 6/80

Rhoads Fisher

Chf Clerk

Correct and map of Torque

County. Decemb. 9/80

Dep 9/84. Herman Engel.

Patented Sep 10/84

P. M. Army

Amendment

N. C. Nelson  
c c 520 800 1000

# Proof of Settlement under Homestead Act.

The State of Texas,  
County of Boone

Before me, the undersigned Distick Clerk in and for the County afore-  
said, this day came and personally appeared A. C. Nelson

a resident citizen of said County, who being by me duly sworn, declares that he is a *bona fide*  
settler upon 80 acres of vacant public land, situated in said County, and  
surveyed for himself on the 1<sup>st</sup> day of  
April 1880 by James M. Robertson a Surveyor of  
said County; that he has occupied and improved the same as a Homestead for a period of  
three consecutive years, beginning on the 26<sup>th</sup> day of January 1880  
that he is a single man and that he makes affidavit for the  
purpose of obtaining a title to the same for a Homestead, under an Act supplementary to  
"An Act for the Benefit of Actual Occupants of the Public Lands," approved May 26th,  
1873, and Acts prior thereto; and that he has not a Homestead other than the above.

AND also at the same time came and personally appeared Geo R H Spencer  
and John Anderson two credible resident citizens of said County, to me  
well known, who being duly sworn, depose and say that A. C. Nelson  
the person first above named in this Affidavit; has actually settled upon and cultivated as a  
Homestead, the land surveyed for him on the 1<sup>st</sup> day of April 1880  
by the Surveyor aforesaid, for the period of three years, and they nor either of them have  
any interest in the said land.

A. C. Nelson  
Geo R H Spencer  
John Anderson

SWORN TO and subscribed before me, and I hereby certify that Geo R H Spencer  
and John Anderson are credible and  
trustworthy citizens of said County.

IN TESTIMONY WHEREOF, I have hereunto set  
my hand and affixed the Seal of said County, at  
office, this 9<sup>th</sup> day of February 1883  
W. W. Marshall  
Clerk Dist Court Boone Co.



H. J. C. 3586

Med. Prescription

H. C. Jackson

Prof. Document

Filed Feb. 13/83

J. A. Robinson

Chg. 212

1-26-80  
9-10-84

\_\_\_\_\_  
\_\_\_\_\_  
Selling  
*J. B. Chelem*

\_\_\_\_\_  
\_\_\_\_\_  
PROOF OF  
SETTLEMENT OF LAND