

File 3463.  
H-984

MILAM PREEMPTION

B. M. Bealy.

148 1/2 A.C. Acres

Act May 26 1873

See P-1447 for Abandonment

Covers J. R. Scales P-1447 - other  
view correct and map of Boque  
County. Decemb. 1/79. For 148 1/2 acres  
August 20/84 G. W. Proffler.

P-1447 in order  
Correct for patenting to  
James M. Manning after  
Sept 8/84

Patented a Sept. 13 1884

No 242 Vol. 16. M. Jenkins

M. R. d. ptd.  
M. R. d. ptd. Reg.

Mgl. 15007

for only 148 1/2 acres  
Oct 29/79 J. M.

CONTENTS.

- No. 1. Affidavit & designation
- No. 2. field notes
- 3. Surveyor's cert. of correction  
Aug. 15/79 Oct 29/79  
Book
- 4- Transfer Book
- 5- cert of Occupancy  
8/4/84 Bld doc

Repts 9/21/84

G. M. Manning

Jenkins & Robertson

J. M. Robertson

142

**AFFIDAVIT FOR PRE-EMPTION.**

**THE STATE OF TEXAS,**

COUNTY OF BOSQUE.

Before me, F. M. Coe Clerk of the County, Court of Bosque

County, this day personally appeared D. M. Deaty

to me known, who after being by me duly sworn, upon his oath deposes and says: that he is now a

bona fide settler upon One Hundred & sixty acres of Land, that he believes to be of

the public vacant lands of the State of Texas; that he is improving said land for a Homestead, and

has no other; and further that he is a Married man

and makes this Affidavit for the purpose of obtaining a Home. Said Land is situated in Bosque

County, about 15 miles N from Meridian, on the waters of Spring Creek:

beginning at Duncan Deatt, N.E. Corner, Thence S. 60° W.

and more particularly described by the accompanying field notes.

Given under my hand and the seal of the County Court of Bosque

County, at office, in the Town of Meridian, this 16

day of August A. D. 1878

F. M. Coe

Clerk Co Court, Bosque County, Texas.

By A. A. Coe Deputy.



x

No. *one*

*D. M. Peaty*

**Affidavit for Pre-emption.**

ISSUED

the *16<sup>th</sup>* day of *August* 18*78*

*F. M. Ballin*

C. C., B. Co.

By *F. A. Ballin* — Deputy.

M. Strickland, Stationer and Printer, Galveston.

~~Recorded page 125~~

~~Pre-emption Bonds~~

Recorded page 125 File 1878

*J. M. R. ...*  
*Geo. ...*





The State of Texas } Fieldnote of <sup>148 1/2</sup> ~~464~~ acres  
 County of Bosque } of Pond made for  
 B.M. Bealy by virtue of his certificate  
 of occupancy issued by the County Clerk  
 of Bosque County on the 16<sup>th</sup> day of  
 August A.D. 1878. said pond is situated  
 on the waters of Spring Creek about  
<sup>12 1/4</sup>  
~~10~~ miles west of Meridian.

Beginning at the N.E. corner of Simon  
 Scott's survey Thence S 60° W 475 varas to  
 a pile of stone the same being the S.E.  
 corner of Sarah Carrington's 640 acre tract  
 Thence N 30° W 1079 varas to the S.W. corner  
 of George J. Fletcher a pile of rocks;

Thence N 60° E 475 varas a pile of rocks  
 from which a Live Oak marked M bears  
 N 82° E and another marked M bears N 60° E  
 268 varas the same being the N.W. corner of  
 Samuel Mammell; Thence S 30° E 950 varas

to the S.W. corner of <sup>and</sup> Mammell a pile of rocks  
 Thence N 60° E 1109 varas to a pile of  
 stone; Thence S 30° E 1089 varas to the  
 S.E. corner of this survey a pile of stone  
 Thence S 60° W 159 varas to a pile of rocks

.. N 30° W 950 varas .. .. .

.. S 60° W 950 .. .. .

.. N 30° W <sup>10</sup> ~~70~~ varas to the place of begin

ning surveys May 20<sup>th</sup> A.D. 1879

J.B. Starr } c  
 J.W. Starr } c

Jonas M. Robertson C.S.B.C.D.

For change  
 see Surveyors  
 copy of



The State of Texas & I James M Robertson  
County of Bosque Surveyor of Bosque  
County do hereby certify that the afore-  
said Survey was made according to law  
and is correct on the ground according to  
measurement

James M Robertson  
County Surveyor Bosque Co

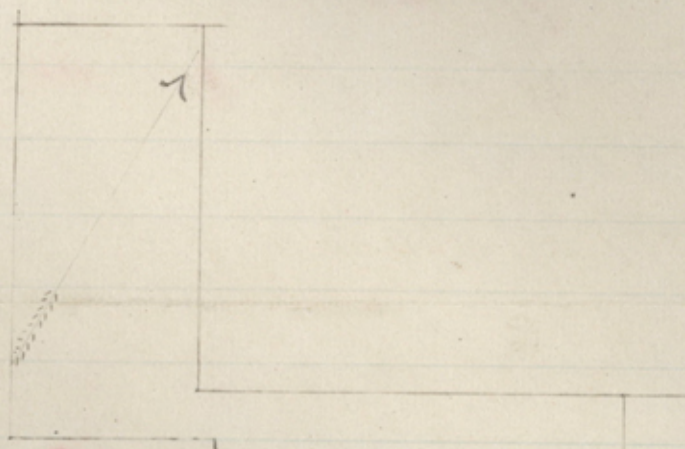

The State of Texas & I James M Robertson County  
County of Bosque Surveyor of Bosque County  
do hereby certify that I have examined the  
above plot and find it correct, also that  
the marks natural and artificial are truly  
described in the above field notes and that  
the same are recorded in my office in  
Journal No 6 page 282.

James M Robertson  
County Surveyor Bosque Co



File 31163.

Milam Preemption

B. M. Beatty

Preemption

B. M. Beatty

Boone Co. Mo.

160 Acres

14 1/2  
Affidavit and field notes

filed Aug. 15/79

Phasor Fisher,  
Chief Clerk

Covers J. B. Scales P. 1447 - otherwise correct and map of Boone County.

November 1/79 for 148 1/2 acres  
August 20/84. C. W. Preidler.

Patented Sept. 13 1884  
M. J. Jackson

1st	2000	5308	2009
2nd	2000	5308	2009
3rd	2000	5308	2009
4th	2000	5308	2009
5th	2000	5308	2009
6th	2000	5308	2009
7th	2000	5308	2009
8th	2000	5308	2009
9th	2000	5308	2009
10th	2000	5308	2009

Aug 19/79  
for only 148 1/2 acres.  
Oct 29/79 JMA.



Bozque Co 3

Meridian, Texas, Oct 24<sup>th</sup> 1879.

W. C. Walsh Esq. Recd. Oct 27/79 at 308  
Austin, Texas, J. D. Robertson

Dear Sir,

The error in B. M. Beatty's pre-emption is an error that was overlooked by me if the ~~10<sup>th</sup>~~ call is 100 vars because it should be 10 as I have examined my records and it is 10 on it and I must have made a mistake putting two ciphers instead of one in copying, so please erase the right hand cipher and it will then be correct. He will furnish evidence of abandonment of seals when necessary to get patents.

Lelemon Neathy's pre-emption is a narrow strip of land between Gibbs & Mailord and Hourick Smith & Stallett as the original surveyor failed to connect them or at least such seems to be the case on the ground.

Enclosed please find 50¢ in postage stamps for a sketch sent me in March 25 1879.

See 2<sup>nd</sup>

Yours truly  
James M. Robertson  
Co. Surveyor Bozque Co Texas



<sup>3</sup> File 3463.

Milam Preemption

B. N. Bealy  
Surveys Certificate  
of condemnation

filed Oct. 29. 79

Rhoads  
Chief Clerk

3463  
applied

5040



The State of Texas,

COUNTY OF Pasque.

Know all Men by these Presents,

THAT D. P. M. Beatty and Wife S. E. Beatty

of the County of Pasque. and State aforesaid, in consideration of the sum of

Two Hundred, \$200.00 DOLLARS,

to me in hand paid by James M. Manning of

the County of Pasque. and State of Texas,

have GRANTED, SOLD and CONVEYED, and by these presents do GRANT, SELL and CONVEY, unto the said

James M. Manning

of the County of Pasque. and State of Texas, all that certain

piece or parcel of land, described as follows,  
 lying and being situated in Pasque County,  
 beginning at the N.E. Corner of Union Deak  
 & running thence S 60° N. 220 rods, to the S.E. Corner  
 of Jno D. Dreed, Survey, thence N 20° W. 1049  
 rods to the S.W. Corner of Geo A. Fletcher  
 thence N 60° E 445 rods, to the N.W. Corner of  
 Samuel Manuel, a pile of rocks from which a line  
 Cox mcd. - M. bears N 82° E and another mcd. - M.  
 bears N 60° E 268 rods, thence S 30° E 950 rods  
 to Manuel's S.W. Cor., thence N 60° E. 1109 rods,  
 to a pile of rocks, thence S. 30° E 1039 rods, to a  
 pile of rocks, thence S 60° N. 159 rods, pile rocks,  
 thence N 20° N 900 rods, a pile of rocks, thence S 60° N  
 900 rods, a pile of rocks, thence N. 30° N 10 rods to  
 the place of beginning, containing one hundred  
 and sixty, 160 acres, surveyed for D. P. M. Beatty  
 by County Surveyor, James M. Robertson  
 May 20<sup>th</sup> 1879.



TO HAVE AND TO HOLD the above described Premises, together with all and singular the rights and appurtenances thereto in anywise belonging, unto the said

James M Manning, his heirs and assigns, forever. And do do hereby

bind our heirs, executors and administrators, to WARRANT AND FOREVER DEFEND, all and singular, the said premises

unto the said James M Manning, his

heirs and assigns, against every person whomsoever lawfully claiming or to claim the same, or any part thereof.

WITNESS, our hand at Mission this 3<sup>rd</sup>

day of August A. D. 1880 B M Beatty

WITNESSES

A E Beatty

THE STATE OF TEXAS,

COUNTY OF Pasque  
County Clerk

BEFORE ME, J. M. Callier

in and for Pasque County, Texas, on this day personally appeared

J. M. Beatty

to me personally known

to be the person whose name is subscribed to the foregoing instrument, and acknowledged to me that he executed the same for the purposes and consideration therein expressed.

GIVEN under my hand and Seal of office, this 3<sup>rd</sup> day of

August A. D. 1880.



J. M. Callier

County Clerk, Pasque County

By J. A. Callier Deputy



The State of Texas  
 County of Coyell } Before me W. D. Clark a Justice  
 of the Peace in and for the County of Coyell, State of  
 Texas personally appeared S. E. Beaty to me well known  
 who having been examined by me severally and apart  
 from her said husband, B. M. Beaty, and after having  
 said deed fully explained to her, acknowledged that  
 she had signed the same of her own free will and  
 willingly and for the purposes & consideration therein stated and  
 did not wish to retract it In Testimony whereof I sign  
 my name officially and affix the impress  
 of my Notarial seal of office, Coyell  
Texas The 3rd day of September A. D. 1880  
W. D. Clark J. P. Public  
 and Ex-officio Notary Tex.

THE STATE OF TEXAS,

COUNTY OF \_\_\_\_\_ } I, \_\_\_\_\_ Clerk of the  
 County Court of said County, do hereby certify that the above instrument of writing, dated on the \_\_\_\_\_  
 day of \_\_\_\_\_ 18\_\_\_\_\_, with its Certificate of Authentication, was filed for Record in my office, this  
 \_\_\_\_\_ day of \_\_\_\_\_ A. D. 18\_\_\_\_\_, at \_\_\_\_\_ o'clock \_\_\_\_\_ M, and duly recorded the  
 \_\_\_\_\_ day of \_\_\_\_\_ A. D. 18\_\_\_\_\_, at \_\_\_\_\_ o'clock \_\_\_\_\_ M, in the Records of said  
 County, in Vol. \_\_\_\_\_ on Pages No. \_\_\_\_\_

WITNESS my hand and the Seal of the County Court of said County, at office in  
 \_\_\_\_\_ the day and year last above written.

Clerk C. C. \_\_\_\_\_ County.



47  
Vol. 3463  
Milam Preemption  
B M Beaty

B M Beaty + wife  
of Transfer  
Jas M Manning

Filed Aug 4/84  
D. N. Robinson  
chf clk

0-52/4

WARRANTY DEED.

Geo. D. Barnard & Co., P.B. ST. LOUIS.

Jas M Manning  
to  
B M Beaty

Filed for Record

at \_\_\_\_\_ o'clock and \_\_\_\_\_ M  
Recorded \_\_\_\_\_ 18\_\_\_\_  
in \_\_\_\_\_ County Record  
of \_\_\_\_\_ Book \_\_\_\_\_ Page \_\_\_\_\_  
Clerk \_\_\_\_\_  
Deputy \_\_\_\_\_



# Proof of Settlement under Homestead Act.

The State of Texas, }  
County of Bosque

Before Me, the undersigned ~~a Notary Public~~ in and for the County aforesaid, this day came and personally appeared James M Manning a resident citizen of said County, who being by me duly sworn, declares that he is a bona fide settler upon 160 acres of vacant public land, situated in said County, and surveyed for B.M. Beatty on the 20<sup>th</sup> day of May 1879, by Jas M Robertson a Surveyor of said County; that he has occupied and improved the same as a Homestead for a period of three consecutive years, beginning on the 3<sup>rd</sup> day of August 1880, that he is married and that he makes this affidavit for the purpose of obtaining a title to the same for a Homestead, under an Act supplementary to "An Act for the Benefit of Actual Occupants of the Public Lands," approved May 26th, 1873, and Acts prior thereto; and that he has not a Homestead other than the above, and that he holds the same as assignee of B.M. Beatty per deed herewith filed.

AND, also, at the same time came and personally appeared Simem Scott and J. L. Scott, two credible resident citizens of said County, to me well known, who being duly sworn, depose and say that James M Manning the person first above named in this affidavit, has actually settled upon and cultivated as a his assignee B.M. Beatty Homestead, the land surveyed for him on the 20<sup>th</sup> day of May 1879, by the Surveyor aforesaid, for the period of three years, and they, nor either of them, have any interest in the said land.

James M. Manning  
S. Scott  
J. L. Scott

Sworn to and subscribed before me, and I hereby certify that Simem Scott and J. L. Scott are credible and trustworthy citizens of said County.

IN TESTIMONY WHEREOF, I have hereunto set my hand and affixed the seal of said County, at office, this 19<sup>th</sup> day of July 1884.

Jas M Robertson  
Notary Public for Bosque Co Texas





5) File 3463

Mulam Preemption

B M Beaty

cert of  
Occupancy

Filed Aug 4/84

Gen Robinson

Chfclrk

#1000

8-3-80  
9-13-84

Mul 3463

PROOF OF  
SETTLEMENT OF LAND

Jas M Manning  
Settler.

