

File 3318.

Act 967-3

MILAM PRE-EMPTION.

A. Peterson.

160 Acres.

for Proct. see P 642 milam
filed 11/1 28/79

Act May 26 / 1873.

Correct and map of Boque
County. January 9/80
C. W. Pfeiffer.

The above marked proct. does
not refer to this survey but to
P. 3327 etc.

Correct for patenting
Sep. 9/81

Patented Sept 9/81
Wm. Fisher
Wm. H. Pugh, Reg
14267.

Mgl. 14267.
C.C. for one, 115 acres. Jan 31 1880

CONTENTS.

No. 1. Affidavit / Affidavit

No. 2. Field Notes.

Jan 25 79. Feb 10 79

Ed Buck

3-cov field notes
5-06/80 Wallin

4 cov of occupancy
Sept 9/81 Wallin

J. M. Robertson

THE STATE OF TEXAS,

COUNTY OF BOSQUE.

Before me, *John H. Johnson,* Clerk of the *District* Court of Bosque County, this day personally appeared *A. Pederson,*

to me known, who after being by me duly sworn, upon his oath deposes and says: that he is now a bona fide settler upon *One Hundred and sixty* acres of Land, that he believes to be of the public vacant lands of the State of Texas; that he is improving said land for a Homestead, and has no other; and further that he is a *Married* man

and makes this Affidavit for the purpose of obtaining a Home. Said Land is situated in Bosque County, about *12* miles *S.W.* from Meridian, on the waters of *Meridian* Creek: beginning *at the S.W. Corner of the* *Smith Survey,*

and more particularly described by the accompanying field notes.

Given under my hand and the seal of the *District* Court of Bosque County, at office, in the Town of Meridian, this *2nd,* day of *December* A.D. 1878,

John H. Johnson,
Clerk *District* Court, Bosque County, Texas.

By _____ Deputy.

File 3318318

Milam Preemption

No. 5

A. Pederson,

Affidavit for Pre-emption.

ISSUED

2^d day of December 1878.

John H. Johnson,
filed in G. O. C. Feb'y 10. A. D. 1879.

By

Charles H. [Signature] Deputy
Chief Clerk

M. Strickland, Stationer and Printer, Galveston.

recorded on page 124

File Bk

J. H. R. Austin

his Survey

COPIED ON FILE

The State of Texas $\frac{2}{3}$ Field notes of #60
 County of Bosque $\frac{2}{3}$ acres of Land made
 for A Peterson by virtue of a certificate
 of occupancy issued by John H.
 Johnson Clerk of the District Court
 of Bosque County, Texas on the 2nd
 day of December AD 1878.

Situated ^{in Bosque Co} on the waters of Meridian
 Creek $12\frac{3}{4}$ miles S 38° W of Meridian
 and more fully described as follows:

Beginning at the SW corner of
 the Wm M Smith survey a pile of rocks
 from which a Live oak marked W
 bears S 43° W 85 varas. Thence N 60° E
 737 varas to the NE corner of this survey
 a pile of rocks from which a Live oak
 marked X bears N 30° W 245 varas and
 an Elm marked P bears N 82° W 80 varas
 the same being the NW corner of A.
 Johnsons pre-emption survey; Thence
 S 30° E 880 varas to the SE corner of
 this survey a pile of rocks from
 which a Spanish oak marked
 bears East 2 varas; Thence S 60° W
 737 varas a pile of rocks in East
 line of Wm M Smith ⁴⁵⁵ ³ ^{survey} ₅ ₂ from which a
 Live oak marked X bears N 28° W 44
 varas; Thence N 30° W 880 varas to

to the place of beginning.

Surveyed Dec 12th, AD 1878

James M Robertson

Audry Johnson } C

Co Surveyor B & T

John Swenson } C

The State of Texas }
County of Bosque } I, James M.
Robertson Surveyor of Bosque County,
do hereby certify that the foregoing
field notes are correct and that
the marks natural and artificial
are truly described in the foregoing
field notes This Jan 21st 1879

James M Robertson

Surveyor Bosque Co.



The State of Texas } I, James M
County of Bosque } Robertson
Surveyor of Bosque County, do
hereby certify that I have examined
the field notes and plat of the
foregoing field notes and find

2 File 3318

Milam Preemption

A. Peterson

160 acres
field notes

filed Jan 25 79
W. H. Hale,
Commissioner,
Chickasha

Classified by corrected field notes

James Robertson
January 13 6 1879

then assessed and that they are
recorded in my office in Journal
No 6 page 264

c.c. for only 115 acres. Jan 31/79
JH

3318

The State of Texas, I corrected field notes of
County of Bosque, a survey of 160 acres of
land made for A Peterson by virtue of his
affidavit made before the District
Clerk of Bosque County Texas on the
day of December AD 1878. (Said survey
was made by me but did not contain 160
acres at the time I made it hence I now
correct for 160 acres) Said survey is sit-
uated ^{in Bosque County} about $12\frac{3}{4}$ miles ³⁸⁰ S.W. from
Meridian on the waters of Medicine
Creek, in ~~Bosque County Texas.~~

Beginning at the N.E. corner of Wm
Hessard's survey a pile of rocks from
which a Live oak marked W bears S45^W
85 rods; Thence N60^E 737 rods to A.
Johnson's N.W. corner a pile of rocks from
which a Live oak marked X bears
N30^W 225 rods; Thence S30^E
1226 rods to a pile of rocks on the moun-
tain; Thence N60^W 737 rods to a
pile of rocks in Hessard's east line;
Thence N30^W 1226 rods to begin-
ning.

Corrected Nov 26th AD 1880.

A Johnson G
Geo Johnson C

James M. Robertson
Co Surveyor Bosque County

The State of Texas, } I James M. Robertson Co Surveyor
 County of Bosque, } of Bosque County Texas do hereby
 certify that I made the above survey on the
 ground at a variation of 10 1/3 degrees magnetic
 variation and that the same is now correct
 on the ground according to the above field-
 notes and made according to law, and is
 recorded in my office in Book C on
 page 57 Bosque County, Texas,

James M. Robertson
 Co Surveyor Bosque Co Texas,

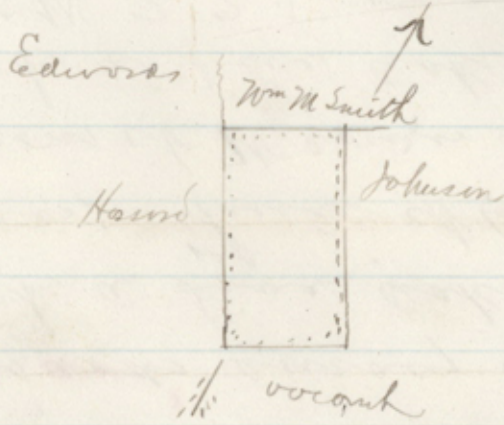

The State of Texas, } I Jacob Robertson Co Surveyor
 County of Bosque, } of Bosque County Texas do
 hereby certify that the above plat is a
 rough drawing of a Petersons pre-emption
 as made by me.

Jacob Robertson
 Co Surveyor Bosque Co Texas,

File 3318

William Parsenplin

J. Robertson

100 acres

for field notes

July 22nd 1880

Charles Fisher

Chief Clerk

Record and map of Bosque
 County, January 9/80
 B. W. English

Patented Sept 9/80
 B. W. English

A. Peterson

Amendment
 5008
 5/11/80

Proof of Settlement under Homestead Act.

The State of Texas, }
County of Bosque, }

3318

Before Me, the undersigned District Clerk in and for the County aforesaid, this day came and personally appeared A. Peterson, a resident citizen of said County, who being by me duly sworn, declares that he is a bona fide settler upon 160 acres of vacant public land, situated in said County, and surveyed for him on the 12th day of December 1878, by James M. Robertson, a Surveyor of said County; that he has occupied and improved the same as a Homestead for a period of three consecutive years, beginning on the 12th day of December 1877, that he is Married, and that he makes this affidavit for the purpose of obtaining a title to the same for a Homestead, under an Act supplementary to "An Act for the Benefit of Actual Occupants of the Public Lands," approved May 26th, 1873, and Acts prior thereto; and that he has not a Homestead other than the above.

AND, also, at the same time came and personally appeared C. P. Hughes, and H. J. Hanson, two credible resident citizens of said County, to me well known, who being duly sworn, depose and say that A. Peterson, the person first above named in this affidavit, has actually settled upon and cultivated as a Homestead, the land surveyed for him on the 12th day of December 1878, by the Surveyor aforesaid, for the period of three years, and they, nor either of them, have any interest in the said land.

A. Peterson
C. P. Hughes
H. J. Hanson

Sworn to and subscribed before me, and I hereby certify that C. P. Hughes, and H. J. Hanson, are credible and trustworthy citizens of said County.

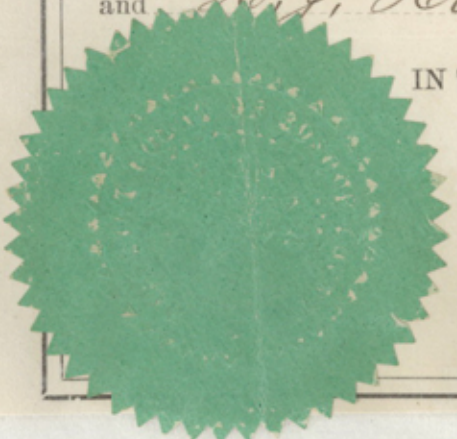

IN TESTIMONY WHEREOF, I have hereunto set my hand and affixed the seal of said County, at office, this Second day of September 1881.

John H. Johnson
Clerk of District-Court Bosque Co. Tx.

✓ File 3318

Milau Presumptio

A. Peterson

Cert of occupancy

Filed Sept 9/81

Rhoads Hiker

by deed

PROOF OF
SETTLEMENT OF LAND

A. Peterson,

Settler.

Filed Sept 9/81 -

by

J. M. Robertson

By
Hiker

18-14-81
9-9-81
11-8-81