

CONTENTS.

- No. 1. *Application* Certificate.
- Nos. 2 and 3. Field Notes.
- No. 3. *Treas Receipt*
July 1/82
Reynolds
- " 4 & 5 *certified notes*
- " 6. *S. Ketch*
3/8/84
- " 7 *Treas Receipt*
3/15/84
- 8 *Certy of Surveyor* 4/29/84
Brawlette
- 9 - *surveyors Cert*
4/19/84 *Blades*

Daniel Wise
Waco

3171

W. L. SCRIP.

Abst. - 1095

Daniel Wise

toroid wrapper see 2926-11-5-

117 Acres

July 11/79

Certificate No.

Examined and S. 2839.
Obtained according
to surveyors Certificate
and plan map of
Bosque Co. Schulze.
July 29/84.

Correct for patenting
July 29/84
Robinson

Patented July 29/84
No. 593 Vol. 9
Carriington

mkd ptd

mkd. ptd. Reg.

90280

Mgl.

H. B. White,

DEALER IN

DRY GOODS & GROCERIES

Highest Prices Paid for Cotton, Wool and Hides.

Meridian, Bosque County, Texas,

188

The State of Texas } I hereby make applica
 County of Bosque } tion to the County
 Surveyor of Bosque
 County to survey me all the vacant
 land South of F Keiville Survey and
 East of the D. B. Scott and North of
 the J. H. Allen Surveys containing 120
 acres more or less. I make this
 application in accordance with the acts
 of the Fall Session of the 16th Legislat-
 ure, approved July 14th 1879
 providing for the Sale of the un-
 appropriated Public domain of the State
 of Texas this the 19th day of April
 1882

J. P. Kessinger

Rec'd. & filed, W. J. Robideau
 Rec'd.

3177
1) Filed 29th 1882

Milam Scip
Daniel Wise
D. S. Kessinger

Application

Filed May 20th 1882

Rhoads Tucker
Chas. A. K.

Filed for Record
April 19th 1882,
and duly re-
corded May 11th 1882,
in D. S. Kessinger's
File Book page
218

Filed
D. S. Kessinger

DECEMBER



NEWTON & WISE,

2839 mil

2929

Morgan, Texas,

June 26 1882

Rhodes Fisher Esq

Austin Tx

Dear Sir,

I beg to enclose fifty
Six copies Dally (56⁰⁰) being amount
required as contained in your W^oriet
for purchase of D^o Messinger survey

112 acres

Awaiting papers I am

Yours Truly
Daniel Wise

Recd the \$56 above

Name F R Subbock

Jun 30/82

2926 mil Scrip

1777
Widow Verip
David Wise

Application

Filed July 1/52

Commissioner

Wm & J. 1/52

James M. 2/52

1797 90

WILSON & WISE

State of Texas }
 County of Bosque } Field notes of a Survey of 112 acres
 of land made by D. P. Harringer
 by virtue of his application to purchase
 under the provisions act providing for the sale
 of the unappropriated public domain of the State
 of Texas approved July 14th 1879 application
 made April 19th 1882

Said land is situated on the waters of Cedar
 Creek about 6 Miles S⁷⁵ E from Uniontown
 Beginning at the S^W cor of the J. S. Chamberlain
 320 acre sur. pile of rocks Thence N³⁰ W 766.04 to a cor
 of said Chamberlain sur. pile of rocks Thence N⁶⁰ E 217
 13 to the S^W cor of James Hickey 940 acre sur. pile of
 rocks Thence N³⁰ W 133.04 to D. P. Harringer cor. pile of
 rocks Thence S⁶⁰ W 582.04 said Harringer S^W cor. pile of
 rocks Thence N⁸⁰ W 582.04 Harringer N^W cor. pile of rocks
 Thence S⁶⁰ W 445.04 N^E cor. of J. De Cordova 1000 acre
 sur. pile of rocks Thence S⁸⁰ E 1441.04 to the S^E cor
 of S. B. Scatter 80 acre sur. pile of rocks Thence N⁶⁰ E
 310.04 to the place of beginning

James M. Spaduzo } Surveyed in 1881
 James Decker }

I S. J. Siddall County Surveyor
 of Bosque County do hereby certify that the
 foregoing survey was made according to law
 and that it was actually made on the ground

and that the field notes are recorded
 in my office in Book D page 175
 and that it was run on a variation of
 10 1/2 Degrees

S. J. Siddall
 County Surveyor

D. P. Ballinger, Past office address
 Morgan Texas

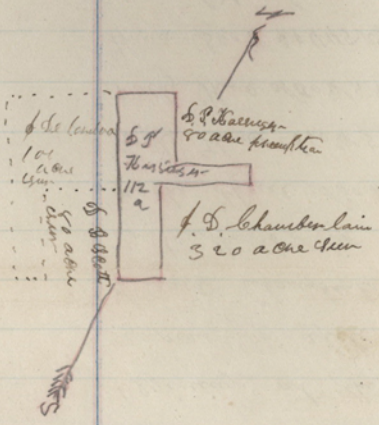

v/ Files 3177

William Scrip
 David Hyslop
 D. J. D. D.

Piecy Notes
 17 acres

Filed May 1876
 Charles Fisher

City of Ark

Corrected by [unclear]

May 25/76
 S. J. Siddall

Carroll Rhodes Fisher Esq. Genl. Ad. Office. 74

No. 1155

Treasurer's Office,

Austin, Texas, July 1st 1887

Received of Rhodes Fisher on account of Daniel Mose

the sum of Fifty six Dollars,

the same being payment in full on 112 acres unappropriated Public Lands in Bosque

County, under "An Act to provide for the sale of a portion of the unappropriated Public Lands of the State of Texas,

and the investment of the proceeds of such sale," approved July 14, 1879.

2926 = 1 mil 5 ✓

L. R. Luttich

Treasurer.

3/

3177

Title ~~2976~~

Milam Scrip
Dane & Wise
D. P. Resinger

Treas. Receipt

Given July 1/82

Commission

File this with 3177 Mil S.

The State of Texas } Connected with
County of Basque } of a Survey made for
3 } (Sold by Com. L. C. W.) Daniel West
4 } D. P. Kasinger of 134 1/2 acres
of land. it being the land to which he
is entitled by virtue of his application
to purchase under the act providing for
the sale of the unappropriated public
domain of the State of Texas appeared
July 14th 1879 application dated April 15th 1882
Said land is situated on the ^{South 6 7/8} waters of
Bedrou Creek. about 6 Miles East of
Meridian

Beginning at the S W cor of the
J. S. Chamberlain 320 acre Survey a
pile of rocks Thence N 30 W 766 N to a cor of the
Said Chamberlain Sur - a pile of rocks
Thence N 60 E 717 N to the S W cor of the
James Hickey 40 acre Sur - a pile of rocks
Thence N 30 W 133 N to D. P. Kasinger cor - a
pile of rocks Thence S 60 W 442 N to the
Said Kasinger S W cor a stake Thence N 20
W 671 N to the N W cor of the Said
Kasinger 80 acre Sur - a stake Thence
S 60 W 585 N to M. J. Hernandez 100 acre
Sur - a pile of rocks. it being the N E cor
of Said Hernandez Sur. Thence S 30 E 1570 N
to the S E cor of D. B. Scotts ^{or J. do Cordova} 80 acre Sur
a pile of rocks Thence N 60 E 310 N to the place
of Beginning Surveyed Sept 27th 1881
James M. Spadden } J. S. J. Siddall
James Decker } County Surveyor of
Basque County Texas do hereby certify

1 that the foregoing survey was made according
 2 to law and that it was actually made
 3 on the ground and all of the lines and
 4 corners of the surrounding surveys was found
 5 and that the field notes are recorded
 6 in my office in book 6 page 175
 7 and run on a variation S. 75° S. Siddall
 8 at 10 1/2 degrees } County Surveyor of
 9 Barque County, Texas

5/4/10 3177

Milam Stark

Daniel Hoel

Corfield notes

34 1/4 acres

Frank Marshall

W. N. Pittman

AM OK

(Commenced 29th Nov
 S. 28 3/4. The above are
 according to some system
 Certificate according
 maps of Barque Co
 July 29th 1897. W. N. Pittman

Daniel Stark
 Corfield

9/24/13
 2 PM. 50

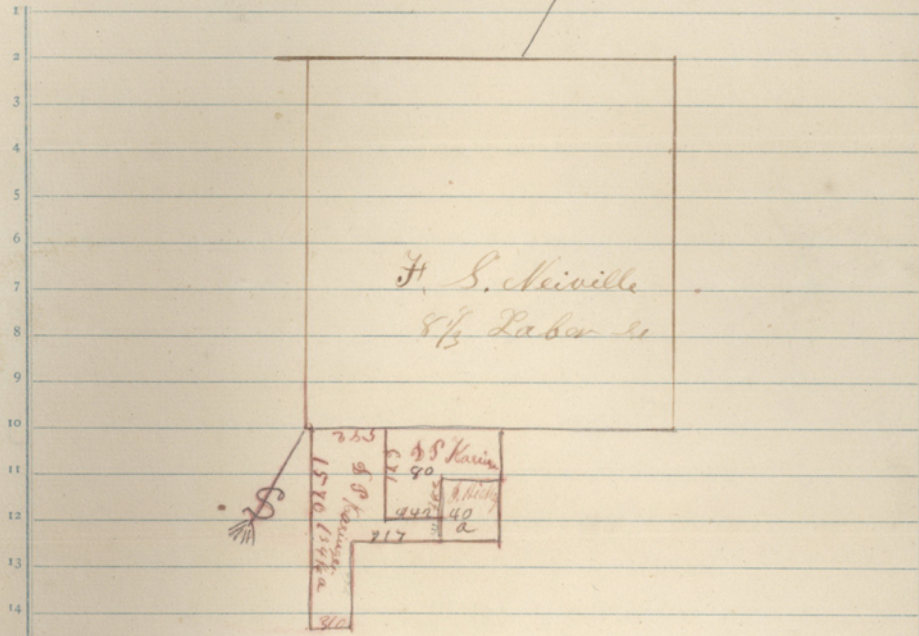

I S. J. Siddall County Surveyor of
 Basque County Texas do hereby certify
 that the foregoing sketch is correct and
 shows the location of the Basinger surveys
 Neville and Kichey

S. J. Siddall

6/ File 3177

Milam Sarg

Daniel Wise

Sketch

Fredman Jay

Gen Robinson

Moore

No. 9959

Treasurer's Office,

Austin, Texas, Mar. 15 1884

Received of Comd. G. L. A on account of Daniel Wise

the sum of Eleven ¹²/₁₀₀ Dollars,

the same being payment in full on 27 ²⁶/₁₀₀ acres unappropriated Public Lands in Bosque

County, under "An Act to provide for the sale of a portion of the unappropriated Public Lands of the State of Texas, and the investment of the proceeds of such sale," approved July 14, 1879.

(Additional to Rept. No 1455) W. B. Workman
a. s. g. Treasurer.

(used by J. P. Keeney)

7/ File 3177

Milam scrip

Daniel Wise

Treas Receipt

Filed Mar 15/84

D. W. Robinson

encl

Nichols & Robertson,

General Merchants,

J. W. FROST, MANAGER.

Meridian, Texas, April 21st 1884

Dear W. C. Walsh
Commissioner
Austin
Texas

Dear Sir
yours of the 12th inst is before me and
in answer will state that ^{the} Hernandez
N^o 6 corner is on the South line of the
S H Neville Survey for I have run
back of said survey and made all
the corners of the aforesaid surveys
with chain carriers duly qualified.

Yours Truly

S. J. Suddall
County Surveyor
of Bosque County Texas

File 3177

Milau Serip

Saul. Wise

Cert. of Surveyor

Filed Apr. 29/54

D. N. Robinson
Ch. Clk.

If the N.W. corner of this survey is identical with the Fernandez's N.E. corner, the ^{corner} ~~marker~~ the position of Fernandez and De Cordova 1570 or long instead of 1348.000. If any of the lines is longer than called for the Surveyor should explain - he should also call for the original grantee J. De Cordova instead of D. B. Gott.

Richard M. Brown

Richard M. Brown

The State of Texas } S. J. Siddall County
County of Basque } Surveyor of Basque County
Texas do hereby certify that
the S. P. Haringer (or San Jose) Sale & quit
Survey is correct on the ground the discrepancy
in the lines of the S B Scott or De Cordova
& Co. San Jose and the Ferrnades San is caused
by the Ferrnades San calling for the N E cor of
the George Estes and the S E cor of Jackson
San are then N 50 W 200 is on the Jackson East line
thence N 60 E to the N E cor of Ferrnades survey
makes said cor on the South line of S. J. Minville
Survey and at the Ferrnades San calls for the
N E cor of the S B Scott or De Cordova & Co.
San and the West line of the S. P. Haringer San
is as long as called in the field notes on file in your office
all of the Surrounding Surveys as well as
the S. P. Haringer San was run on the ground by
me with chain & pins. duly qualified
given under my hand this the 11th day of
June 1884
S. J. Siddall
County Surveyor of Basque County
Texas

9/ File 3177

Milam Scrip

Daniel Wise

Surveyors
Certificate

Filed June 19/84

G. A. Robinson

clerk