

Bosque 7/71

File 2731

Ab 906

Milam Preemption

Wm A Jenkins

15 3/4 Acres

Act May 21/77

According to Surveyors Certificate located in Map of Bosque County for 15 3/4 Acres Section 26 to name.

from given wrong quantity
are 9175 from

to C Elliott of
Sept 22/82

borned for patenting to
C Elliott of
Oct 3/82 Walsh

Patented 2/24/83

70571 Y 118

Mkd ptd 9651906
and Correll Vol XV

Mgl. 71149

Mkd ptd Rec

Chig 30
E 7/17/77

Contents.

No. 1. ^{Cont of Occupancy} Affidavit.

" 2. Field Notes.

" 3. Transfer

" 4. May 11/77

Daniel

5. Corfield notes

• Mason

Mohorner

6. Surveyors Certificate
6/8/82
Mahorney

7. Gen & John -

Sept. 21/83

Journal

John Hewlett

City

A. B. Vol. P.

Proof of Settlement under Homestead Act.

The State of Texas,
County of Bosque,

BEFORE ME, the undersigned, District Clerk in and for the County aforesaid, this day came and personally appeared C. E. Elliott, Assignee of W. A. Jenkins, a resident citizen of said County, who being by me duly sworn, declares that he is a bona fide settler upon one hundred & sixty (160) acres of vacant public land, situated in said County, and surveyed for him (W. A. Jenkins) on the First day of October, 1874, by William Macaulay, a Surveyor of said County; that he has occupied and improved the same as a Homestead for a period of three consecutive years, beginning on the day of October, 1873, that he ~~is~~ and the said W. A. Jenkins, are each the head of a family, and that he makes this affidavit for the purpose of obtaining a title to the same for a Homestead, under an Act supplementary to "An Act for the Benefit of Actual Occupants of the Public Lands," approved May 26th, 1873, and Acts prior thereto; and that he has not a Homestead other than the above.

AND also at the same time came and personally appeared, O. D. Griffin, and G. M. Paul, two credible resident citizens of said County, to me well known, who being duly sworn, depose and say that C. E. Elliott, Assignee of W. A. Jenkins, the person first above named in this affidavit, and the said W. A. Jenkins, has actually settled upon and cultivated as a Homestead, the land surveyed for him on the First day of October, 1874, by the Surveyor aforesaid, for the period of three years, and they nor either of them have any interest in the said land.

C. E. Elliott
O. D. Griffin
G. M. Paul

Sworn to and subscribed before me, and I hereby certify that O. D. Griffin, and G. M. Paul, are credible and trustworthy citizens of said County.



IN TESTIMONY WHEREOF, I have hereunto set my hand and affixed the seal of said County, at office, this 7th day of

October, 1876.
John H. Johnson,
Clerk of Dist. Court, Bosque County.

1. File 2731.

Wilam. Preemption

C. E. Elliott

West of Occupancy

PROOF OF
SETTLEMENT OF LAND

C. E. Elliott,

Settler.

John C. Smith
Appr. C.



Survey is correct and made according
to law

W^m Macaulay
Co Surveyor

I, S. J. Siddall Surveyor of Barque
County do hereby certify that
the foregoing field notes is a true
copy of the original as made for
Macaulay and that they are record-
ed in my office in the Journal
No: 6 Page 142

April the 11th 1884 S. J. Siddall Surveyor
of Barque County

To File 2731.

Milans Thompson

W. A. Jenkins

Field Notes

160 Acres.

Subscribed 16/1/84
J. M. [Signature]

Can added by corrected field notes

Can 5³⁸
C 97427

TO HAVE AND TO HOLD, all and singular, the premises above mentioned, unto the said

O. E. Elliott *this*
heirs and assigns forever; and *I* do hereby bind *my*
heirs, executors and administrators, to *Warrant and Forever Defend*, all and singular, the said premises unto
the said _____

_____ heirs and assigns, against every person whomsoever,
lawfully claiming or to claim the same or any part thereof.

WITNESS *my* hand at *Meridian*
this *28* day of *August* 187*5*
W. J. Jenkins
Clerk of Meridian

The State of Texas,)
County of *Brazoria*) Before me, *Geo James*
personally appeared, *W. J. Jenkins*
to me well known, who *says he*
signed, sealed and delivered the above Instrument of Writing, dated *28* day of *August* 187*5*,
and declared the same to be *his* binding act and deed, for the purposes and consideration therein stated.

IN TESTIMONY WHEREOF, I hereunto sign my name and affix the impress
of my official seal, at my office in *Meridian*
this *28* day of *August* A. D. 187*5*

By *O. L. Lockett* Deputy *Geo James* Clk.

The State of Texas,)
County of *Brazoria*) I, *Geo James* Clerk of
District Court of said County, do hereby certify that the above Instrument of Writing, dated on the *25*
day of *Oct*, 187*5*, with its certificates of authentication, was filed for registration in my office,
this *25* day of *Oct*, A. D. 187*5*, at *2* o'clock *P* M., and duly Recorded
the *25* day of *Oct*, A. D. 187*5*, at *2* o'clock *P* M., in the Records
of said County, in Vol. *0* on Pages No *421*.

WITNESS my hand and seal of District Court of said County, at office in
Meridian the day and year last above written.
Geo James
Clerk D. C., _____ County.
Prof. S. H. Coon Deputy

32
The State of Texas, before me N. J. King a Justice
County of Bosque of the Peace and Officer
Notary Public of Bosque
County Texas personally appeared Mrs. Eunice
Jenkins to me well known, who is the
wife of W. A. Jenkins who is a party to
a certain deed bearing date the 3^d day of
August A. D. 1874 - and here to Attached
and she having been examined by me privately
and a part from W. A. Jenkins her said
Husband and having the same fully
explained to her she the said Eunice
Jenkins acknowledged the same to be
her act and deed, and declared that
she had willingly signed sealed and
delivered the same and that she wished
not to retract it or any part thereof
of testimony whereof I sign my name
officially and affix the seal of my
office in Bosque County Texas
this 3^d day of August A. D. 1874 -

N. J. King
Justice of Peace & Notary Public
Bosque Co. Tex.

Warranty Deed.

W. A. Jenkins & wife

TO

C. E. Elliott

FILED FOR RECORD,

October 25th

1875

at 9 o'clock P. M.

Recorded Oct 25 1875

in Barrow County,

Record of Deeds

Book 11 Page 122

Mr James Clerk.

S. H. Brown Deputy Clerk.

3. Filer 2731.

William P. P. P.

W. A. Jenkins & wife

To Transfer

C. E. Elliott

Filed April 16th 1877
J. P. P.

For corr chain see survey or certificate

Connected

The State of Texas } Field Notes of a
County of Bosque } Survey of ¹⁵³ 160 acres of
land made for W. A
Jenkins ~~on~~ it being the land to
which he is entitled by virtue of
his Certificate of Occupancy. Said Land
is situated on the waters of Rocky Creek
about 12 ⁷³/₁₀₀ miles S. ~~65~~ ⁶⁵/₁₀₀ E from
Meridian

Beginning at the N. E. corner
of Henry Lacy's Survey, for the S. E.
cor of this sur. a Stone set in the
ground, marked H. L. Thence N. 30 W.
307 vrs. to a cor on the S. Line of
a survey in the name of Kid
a pile of Rocks Thence S. 60 W.
100 vrs. to said Kids S. W. cor a
pile of Rocks. Thence N. 30 W. 800 vrs
crossed Rocky Creek, 1202 vrs. to the
N. E. cor a pile of Rocks on the
S. line of Gettunde Chereus sur.
Thence S. 60 W. 390 vrs to the N. W.
corner a pile of Rocks. Thence S.
30 E. 400 vrs. recrossed Rocky Creek
790 vrs to corner a pile of Rocks.
Thence S. 60 W. 330 vrs to the N. E. cor
of Jim Parvill sur. a pile of Rocks.
Thence S. 30 E. ~~500~~ ⁷¹⁰ vrs to Henry



Lucy's Cor. a pile of Rocks. Thence
N. 60 E. 820 ors to the place of
beginning. Surveyed April 27th 1882.

J. W. W. Griffin } C. C.
R. B. Burch } }

I, S. J. Siddall County Surveyor of
Posque County Texas, do hereby cer-
tify that the foregoing survey was
made according to Law, and
that it was actually made on
the ground, and that it does
not conflict with any of the
surrounding surveys, and that
the field notes are recorded
in my office in Book "C" p.
99, and that it was run on
a variation of $10\frac{1}{2}$ degrees.

S. J. Siddall
County Surveyor

L. Elliott
Winnick

Corrected filed
notes of H. A.
Ferdinand 60 acre
Survey

Posque
County
according to Law
and
as contained, compiled
by S. J. Siddall
April 22/82
S. J. Siddall

7 Filed 2731
William Preemption
Mrs. A. Jenkins
Confidential Note
S. J. Siddall
Posque County
Chy. C. C.

The State of Texas } I. S. J. Siddall Surveyor of Basque
County of Basque } County do hereby certify that
I actually made the W. A. Jenkins
Survey on the ground and found the N^W cor of the
3rd Parvin 640 acre Sur by the witness, true and file
of racks for the N^E cor. and the N^E and N^W corners
of the Henry Lucy Survey found on the area described
in the field notes. and also the N^W corner
as made for Ann Whellock Sur and the Sid Sur
west of the Howard Sur and North of the Whellock
Sur runs 100 1/4 S^W from the west line of the Whellock
but in reality the Ann Whellock Survey according
to a translated copy of the Ann Whellock field
notes the said Whellock North line it is only
668 1/4 to the South line of Gertrude Chenna Sur
but the Surveyors heretofore claim that that it
is 1202 1/4 between Ann Whellock and Chenna Surveys
but that has no effect upon the W. A. Jenkins
and O. D. Griffin Surveys and I have also run
the South line of the Chenna League on the ground
and the S^E cor of the Chenna is standing and the
corrected field notes of O. D. Griffin Shows the lines
and corners of Sid. 780 acre Survey located by the
3rd Parvin 640 acre Sur in the W. A. Jenkins field notes
the call from the N^E cor of 3rd Parvin Sur 9308
should be 718 1/4 instead of 800 1/4 and you will
please correct the call as the call in Book 8th 89
has 718 1/4 instead of 800 1/4

June 5th 1882

I. S. J. Siddall

County Surveyor

6
File 2731

Milner Prescription

Wm A. Jenkins

Surgeon's Certificate

Filed June 8/82

Phadon Fisher

Chfct

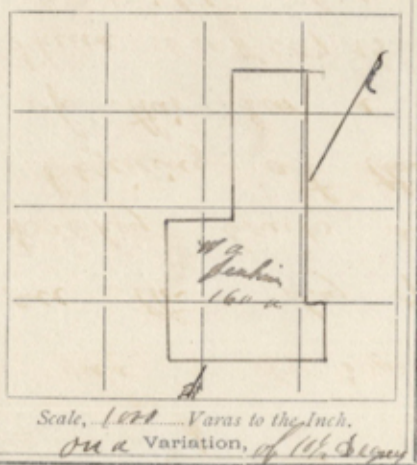

The State of Texas, } Survey No. _____
 COUNTY OF BOSQUE.

Connected Field Notes of a Survey of 160 acres

of land made for W. A. Jenkins
 it being _____ the land to which he is
 entitled by virtue of his certificate of occupancy
 issued by the Clerk of Bosque county

on the day of said land is situated on the waters of
 Rocky creek about 12 1/2 Miles S & E from Medicine
 Beginning at the N & E cor of Henry Lacy, Sur for the S & E cor.
 of this sur a stake set in the ground marked H L
 Thence N 30 W 307 1/2 to cor on south line of a sur in the name
 of Kidd a pile of rocks for cor Thence S 60 W 100 1/2 to said
 Kidd, S W cor a pile of rocks Thence N 30 W 500 1/2 crossed Rocky
 creek 1202 1/2 to the N & E cor a pile of rocks on the south
 line of Gertrude Cheneva Sur Thence S 60 W 390 1/2 to the N W
 cor a pile of rocks Thence S 30 E 400 1/2 recrossed Rocky creek
 790 1/2 to cor a pile of rocks Thence S 60 W 330 1/2 to the
 N & E cor of William Parvin Sur a pile of rocks Thence S 60 E
 Thence 719 1/2 to Henry Lacy, N W cor a pile of rocks
 Thence N 60 E 820 1/2 to the place of beginning

W W Griffing }
 D B Burch } Surveyed April 14th 1882

I, S. J. Siddall County Surveyor of
 Bosque county Texas do hereby certify that the foregoing
 survey was made according to law and that it was
 actually made on the ground and that it does not
 conflict with any of the surrounding surveys and
 that the field notes are recorded in my office
 in Book C page 89

S. J. Siddall
 County Surveyor of
 Bosque county Texas

7/5/11 2731.

Mil. Prunition

Wm. A. Jenkins

Cornelia, 7 Novis.

Filed Sep. 21/82

McNish

Com 2

Comit for only 15/7/82
ape 9/83
JWS

Prunition

*Wm. A. Jenkins
Cornelia, 7 Novis.
Filed Sep. 21/82*

McNish

[Faint bleed-through text from the reverse side of the page]