

Bosque County.

File 2524
Abst-997-922

Milam
PRE-EMPTION.

J. J. Sandifer

160 acres

Act May 26th 1873

OLD WRAPPER WITHIN
PATENTED

ptd to the original
on march 13/80

No 339 Vol-10-

Mgl. 1012 n,

abst - Vol-15-

CONTENTS.

No. 1. Affidavit.

No. 2. Field Notes.

No. 3.

No. 4.

Bosque Co.

File 2524

Milam Preemption

J J Sandifer

160

Act May 26/73

Correct and map of Bosque County. Decemb. 20/79

C. W. Pfeiffer

Correct for patenting March 18/80

Wash. Coms

Patented March 13/80

No 339 - Vol 10

Chiles

mkd ptd

Correct map

March 13/80

to cert of occupancy

Act 1897

Identity & Continuity of name Vol XX

Dec 20/79

Mkd Pat Reg

Mgl. 10127

Nov 21/77

May 27/77

July 26/76

Conte

1. Affidavit

attached to

2. Field Note

3. Cert. field notes

4. May 26/79

Nov 20/74

Ed Beck

5. Cert. of occupancy

Mar 12. 80

Beck

Condition furnished

Survey Nov 13/76

\$5.00 dep'd Mar 11/80

James Robertson Meridian

A. B. Vol.

The State of Texas,
County of Bosque.

Before me, *JNO. JAMES*, Clerk of the District Court of Bosque County, this day personally appeared *J. J. Saunders* to me known, who after being by me duly sworn, upon his oath deposes and says: that he is now a *Bona Fide* settler upon *160* acres of Land, that he believes to be of the public vacant lands of the State of Texas; that he is improving said Land for a Homestead, and has no other; and further that he is a *Married* man, *head of family* and makes this Affidavit for the purpose of obtaining a Home. Said Land is situated in Bosque County, about *5* miles *S.E.* from Meridian, on the waters of *Bosque* Creek: begining

and more particularly described by the accompanying field notes.

Given under my hand, and the Seal of the District Court of Bosque County, at office, in the Town of Meridian, this *17th* day of *January* 187*2*.

Jno James
Clerk District Court, Bosque County, Texas.

By *L. H. Cooney* Deputy.

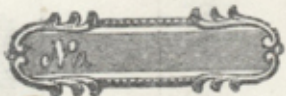

J. Sander
Affidavit for Pre-emption.

FILED
the *20th* day of *January* 187*6*

Jno James
C. D. C., B Co.
By *J. H. Berry* Deputy.

The State of Texas } Field Notes of a Survey of 160
 Acres of Basque Acres of land made for J. J.
 Sanaffer it being the quantity that he is entitled
 to by virtue of his Affidavit of Occupancy
 made before the Clerk of the District Court
 of said Basque County on the 7th of January
 1876 Situated 3 1/2 Miles East from
 The Town of Mirador on the Main Road
 Beginning 1063 Varas S 30° E from the

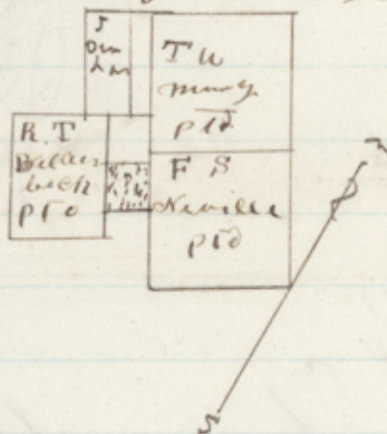

NE corner of Robt T Biles 853 acres Survey
 for the NW cor at 3/4 a live oak mark & this S
 45° W 180 and a live oak mark S this S 74° E 2 Varas
 Hence S 30° E 1063 to the S.W corner a live oak mark S
 this S 72° E 32 and a live oak mark S this S 67 1/2° E 500
 Hence S 60° E 850 to the NE corner in F. S. Neville's whine
 Hence S 30° W 1063 to the NE corner a mound then S
 60° W 850 to the beginning

Survey Jan 8th 1876

E. C. Rucker

J. P. Sanaffer

their Comrs

J. H. Southfield

Dept Survey B Co

I S. J. Siddall surveyor of Bosque county do hereby certify that the foregoing survey was made according to law, and that the limits, boundaries and corners, with the marks natural and artificial, are truly described in the foregoing plat and field notes
S. J. Siddall

I S. J. Siddall surveyor of Bosque county do hereby certify that I have examined the foregoing plat and field notes, and find them correct; and that they are recorded in my office in Journal No 6 page 204
S. J. Siddall
Surveyor Bosque County

File 2524.
Milam Premption
J. J. Sanders
Nichols of
No. 7 Capital.
filed June 9/76.
J. J. Sanders

Cancelled by corrected file

96
26/76

The State of Texas } Corrected field notes of 160
County of Bosque } acres of land made for
J. J. Sandifer by virtue of his certificate of
occupancy issued by the District Clerk
of Bosque County on the 7th day of January
A.D. 1875 said survey having been made
on the 8th day of January A.D. 1875 by L. H.
Scrutched Deputy Surveyor and said survey
having been in conflict with H. Hanks
and Francis Steville has been corrected
on the 15th day of April A.D. 1879 by James
M. Robertson County Surveyor of Bosque County
as follows to wit: Situated 5 miles S 76 E of Meridian
Beginning 1151 varas S 30° E from the N.E.
corner of Robert T. Bilderbeck a pile of rocks
in east line of said Bilderbeck from which
and Elm marked X bears N 29 1/4 W 10 varas
and three small rockberries bear S 45 W 1 vara
Thence S 30° E partly with Bilderbeck's line,
passing his corner, 1657 varas to a pile of
rocks from which a L.O marked W bears
N 54 1/2 W 28 varas, another bears S 64 W 68 varas
marked X; Thence N 60° E 545 varas to a pile
of rocks in west line of Francis Steville in
prairie; Thence N 30° W 1657 varas through
the prairie to the N.E. corner of this tract
in prairie; Thence S 60° W 545 varas
to the beginning. Surveyed April 15th A.D. 1879

Sam'l Sandifer }
R. K. B. Sandifer }
J. J. Wainwright }
Co Surveyors

James M. Robertson
Co Surveyor Bosque Co Tex

The State of Texas I James M Robertson
 County of Bosque County Surveyor of
 Bosque county Texas do hereby certify that
 the above survey was made according to law
 and that the marks natural and artificial together
 with the limits and boundaries thereof are
 truly described in the foregoing field notes.

James M Robertson
 Co Surveyor Bosque Co Texas

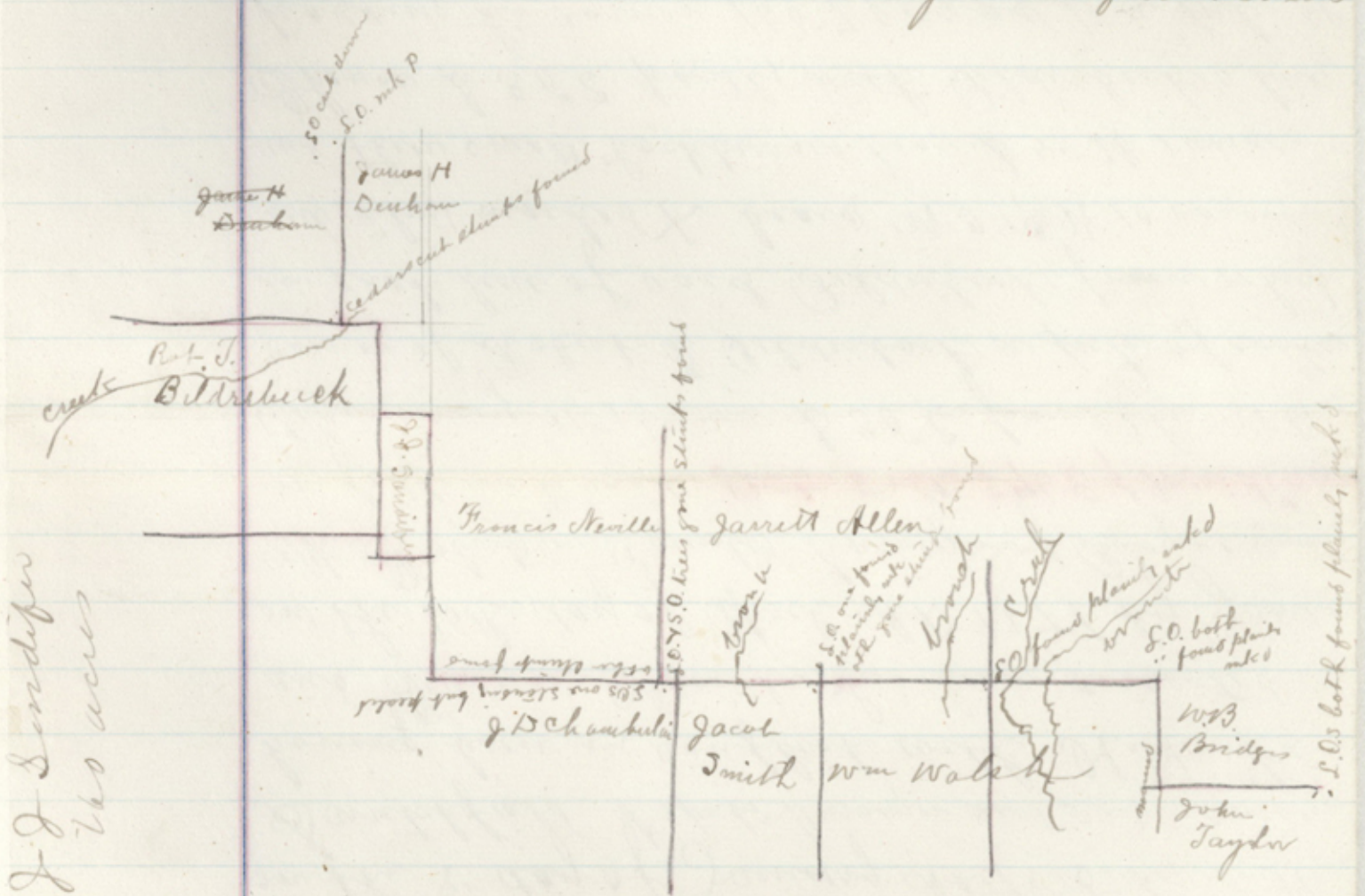

J. J. Sandifer
 160 acres

The State of Texas I James M Robertson Surveyor of
 County of Bosque Bosque county do hereby certify
 that I have examined the foregoing plat
 and field notes and they are recorded in
 my office in Journal No 6 page 274

James M Robertson
 Surveyor Bosque Co Texas

Sackett & Robertson,
Attorneys and Land Agents.

Will buy, sell and
rent land, examine
titles, pay taxes, etc.

Refer, by permission, to
SHERIFF,
COUNTY JUDGE,
DIST. CLERK,
TREASURER
of Bosque County.

Meridian, Texas, May 22nd 1879.

Hon W C Walsh
Austin Tex

Dear Sir:

Enclosed please find copies
of field notes of J D Sandifer and
David Cline examine same and
report result to me at your
earliest convenience

Yours &c
James W Robertson
Surveyor Bosque Co Tex

3 / File 2524

Milam Preemption

J. J. Sander.

160 acres

Corrected fieldnotes

Filed May 26 79.

Rhoads Fisher,
Chief Clerk

Cancelled by corrected fieldnotes

c me 27
c Jmt 79

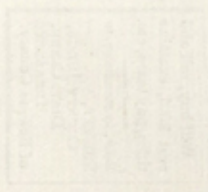

The State of Texas } Corrected field notes of
County of Bosque } 160 acres made for J.D.
Sandifer by virtue of his certificate of
occupancy issued by the District Clerk
of Bosque County Texas January 8th 1875
said land is situated on the waters
of the Bosque about 5 miles ^{75°} S.E. of
Meridian: Beginning at a point 1157
varas S 30 E of the N.E. corner of R.F.
Bilderbeck a pile of rocks in Bilderbecks
East line from which an elm mtd
X bears N 30 W 10 varas and three rock-
berries bear S 45 W 1 vara; Thence S 30 E
1213 varas to a pile of stone; Thence
N 60 E 745 varas to a pile of stone
in the west line of Francis Neville
Thence N 30 W passing Nevilles N.W.
corner 1213 varas to a pile of stone
in ^{Thos. W} Murray's west line; Thence S 60 W
745 varas to the beginning

Corrected Oct 27th 1879

J.J. Wainwright

James M. Robertson

M.F. Shapley

Surveyor Bosque County Tex

The State of Texas } James M. Robertson County
County of Bosque } Surveyor Bosque County Tex
do hereby certify that the above survey is
correct and is represented by plat hereto

James M. Robertson
Co. S. P. C. Tex

File 2524
Milam Preemption
J. J. Sandifer

J. J. Sandifer
160 acres
Bosque County

160 acres
Corrected field notes

Filed Nov. 20, 79
Phadde Fisher,
Chief Clerk

Correct and map of Bosque
County, Decemb. 20, 79
Patented March 13, 80
A. J. B. 6

Nov 22
1879

Bilalutah



Shawnee

Murray

Proof of Settlement under Homestead Act.

The State of Texas,

County of Basque

Before Me, the undersigned District Clerk in and for the County aforesaid, this day came and personally appeared J. J. Sandifer a resident citizen of said County, who being by me duly sworn, declares that he is a bona fide settler upon 160 acres of vacant public land, situated in said County, and surveyed for J. J. Sandifer on the 7th day of January 1876, by L. H. Scrutshieff a Surveyor of said County; that he has occupied and improved the same as a Homestead for a period of three consecutive years, beginning on the 20th day of January 1876, that he is Married and that he makes this affidavit for the purpose of obtaining a title to the same for a Homestead, under an Act supplementary to "An Act for the Benefit of Actual Occupants of the Public Lands," approved May 26th, 1873, and Acts prior thereto; and that he has not a Homestead other than the above.

AND, also, at the same time came and personally appeared J. J. Kinnecoette and Wm. H. Austin, two credible resident citizens of said County, to me well known, who being duly sworn, depose and say that J. J. Sandifer the person first above named in this affidavit, has actually settled upon and cultivated as a Homestead, the land surveyed for him on the 7th day of January 1876, by the Surveyor aforesaid, for the period of three years, and they, nor either of them, have any interest in the said land.

J. J. Sandifer
J. J. Kinnecoette
Wm. H. Austin

Sworn to and subscribed before me, and I hereby certify that

and are credible and trustworthy citizens of said County.

IN TESTIMONY WHEREOF, I have hereunto set my hand and affixed the seal of said County, at office, this 6th day of

March 1880.

John A. Johnson
Clerk of Dist. Court Basque Co. Texas
By N. W. Marshall



5/ File 2524

Milam Premption

J. J. Sandifer

Certificate of occupancy
1-20-76

Filed March 11 80

Thomas Fisher
Clyde Clerk

2524

PROOF OF
SETTLEMENT OF LAND

J. J. Sandifer
Settler.

Jas. M. Robertson

Co. Surveyor, Bosque Co.

Dear Sir

Be kind enough to explain to this office the condition of a ^{pts} survey in name of H. M. Hawks - 1-1929 - it lies about 5 miles S 80 E of Meridian and immediately north of a prescriptive survey of 160 acres in name of J. J. Sandefer. If the Sandefer is correct as returned in Corcoran's field notes, the Hawks ^{pts} survey must be more than half on the J. H. Durham + Robt. J. Bildersack survey.

Reported Aug 11/29
Callman

Hilam Pre - 2524

Statement
for
County
Surveys

Statement
Aug 18/99 Morrison