

File 1989

Milam 1st Class

Ab-733-734

Claiborne Stinnett

369 acres

= 2,083,005 sq. rs.

Relocation of Milams 1-1837-

Copy CERTIFICATE No. 3412/3573.

Our original records in the
matter of H. The Milams
(2-2-34-8) 1/25
April 26/98 Robert H. H.

According to the field notes
of the corresponding survey
see one of the strip of paper
enclosed between R. L. L. and
Mr. P. C. Stinnett.

There is a conflict
in the 1/82

Ab 733 + 734 -

733 an error - Same as 734
copy by H. Wackerup red
Nov Vol XV.

This conflicts with H. Atal
- drop 2-340 & Dallas Love
large survey 2-242, both

Mgl. 1/7/98
Std. 1/19/98
R.P.M.M.

Contents.

No. 1. Certificate.

" 2. Field Notes.

" 3. —

" 4. —

3. Corrected field notes
April 20/98 Robinson

Oct. 24 '78.

Book.

Sanitchfield in
his certifi in - 1.790
makes the dist. only
630 rs instead of
1005 rs between the
Dallas Love & H. C. L.
tender, hence the app.
conflict noted on the
reverse side of this.

5/19/98
P. L. Hill

A. B. Vol. P.

General Land Office
Austin December 19th 1874

I, J. Groves, Commissioner of the General Land Office do hereby certify that the foregoing is a correct and true copy of the Original Certificate on file in this Office, and that the field notes of a Survey located in Brooke County, made by virtue of the aforesaid Certificate, have been returned this Office, and having been found to conflict with a Survey in the name of H. M. Vincent, that a Copy of the aforesaid Certificate is floated in lieu of the Original Certificate for Relocation, in accordance with the provisions of an act approved June 2nd 1873.

In testimony whereof I hereunto
Set my hand and affix the
impress of the Seal of Said
Office the date above written

J. Groves

Commissioner

183rd William 1st Class

No 3412
3513

General Land Office
Austin March 23^d 1854

This is to Certify that Satisfactory evidence
having been produced of the loss of Headright
Certificate N^o 3 Class 1st issued by the Board
of Land Commissioners of Gonzales County to
Claiborne Stimell for Three Hundred
and Sixty Nine Acres of Land dated the
— day of — 1838. This Duplicate therefore
will entitle the Heirs of Claiborne Stimell
now dec^d to all the benefits granted in said
Original Headright Certificate

Seal
Well

In Testimony Whereof I have set
my hand and affix the impress of
the Seal of said Office the day
and date first above written

S. Crosby

Commissioner

1 Filed '1989

Mailam 1st class.

Helvethus

\$1.00

Claiborne Stinnett

Copy Cert. No. $\frac{3412}{3513}$.

Filed Dec. 31/74.

J. P. Moore Com

The State of Texas }
County of Bosque } Field notes of a survey
2,083.065, 4qr. vs.
of 369 acres made

for Claiborne Sturmet by virtue of Duplicate Certificate, issued by Jacob Crosby Comms. Gen. L. O. March 23rd 1854

No 3412/3513

Situated about 12 miles N 25 E from Meridian on the waters of Mesquite Creek

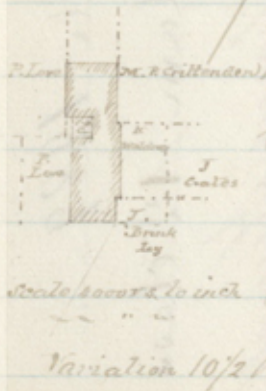

Beginning at the S. E. C. of the small Pallas Cove, on the North line of Dan Robinson

Thence N 30° W 1834 ms N. E. C. of said survey (S. W. C. of 24 acre survey made for Jennie Mc Cardova)

Thence N 60° E 360 ms S. E. of said survey

" N 30° W 393 " N. E. " " "

" S 60° W 562 ms East line of Pallas Cove

Thence N 30° W 1158 ms N. W. C. of this

" N 60° E 1030 ms to West line of

M. P. Crittenden

Thence S 30° E 1211 ms S. W. C. of Crittenden

" N 60° E 12 ms to West line of H

Waldrop

Thence S 30° E 1565 N line of J Brinkley

" S 60° W 62 ms N. W. " " "

" S 30° E 606 " North line of Dan

Robinson

2 Filed 1989

Moilam 1st class.

Clairborne Heights

Field notes 369 A.

2.083005 sq. m.

Filed Dec 31/74

Also a copy of the Com
field notes of the
joining surveys there
is no space to locate
this survey
O. No. 672 E. Schuyler

South cross - difference between
N 60 E bearings + 560 Westing
360 m - here 875
JHX

Corrected
survey

Moilam 1st class 410000 & place of beginning
Mr. Lowell Davis Dec 29 1874
W. G. Chickering
Survey

Probably correct that the bearings
join notes are correct. Remember
in Book B, page 699

Wm. Macmillan
Bohannan
Engene 60

1-1989
1-1764
2-1724

State of Texas

County of DeSoto

True note of a
resurvey of 369 acres of land made for
William Stinnett by virtue of a
Duplicate Certificate issued by the
Crisby Comm^{rs} of General Land Office
March 23 1854 No 341255-13

Situated about 12 miles N.W.
from Sherman on the waters of
Mesquite Creek

Beginning at the N.E. corner of
a 492 acre survey in the name of
Paris Love Thence S 30 E 112 rods
to a monument for corner Thence N 60 E
670 rods to S.W. corner of Hardin Har-
vey survey Thence N 30 E 1565 rods
to line of A.P. Witterman survey
Thence S 60 E 15 rods to Witterman's
S.W. corner Thence N 30 E 1033 rods
to a pile of rock from which a live
oak tree marked X bears S 60 E
distant 9 rods and another marked
B bears S 74 E distant 19 rods Thence
S 60 E 1005 rods to a pile of rock in
the line of the Carl P. Love survey
Thence S 30 E 1033 rods to the S.W.
corner of a 24 acre survey in the
name of James DeCordova Thence
N 60 E 360 rods to E. corner

Title 1989

Milam 1st Class

Claborne Stinnett

369 acrs or
2,083,005 sq rods

Corrected field notes

Tiled April 26, 1876

J. P. Love Com.

There is no vacancy
between P. Love and
H. Waldrop and
this survey will
be covered by
said Waldrop's

1st survey
July 19/76

Three papers

Also of possession
with P. Love large sur 2-24

Advt + pld.
of May 23/76
R.P.M.H.

of the same. Thence N 80° E 393 rods
to the beginning
James Harrison }
of }
P. Love Harrison }
of John Walton County surveyor
of Brogue county do here by certifi-
cate of the surveyor the P. Love
the 24th, 1876 survey of the land
above survey. The right corner
corner of the John Walton survey
on the Negro River and the N.E.
corner of the old distribution survey
and also the four corners of the
survey are in the name of the
James P. Love survey and by actual
measurement on the ground the
foregoing field notes show that the
said title, any of the same, is
covered in my plan book A
of the same