



No 3000

This is to certify

Unlocated Balance Certificate  
No 227 for \$1,333.00 issued  
& forwarded to you & paid  
Sept 7/76

Rhoads Fisher,  
Chief Clerk

Office  
February 21 1876

*[Faint handwritten signature and text, possibly "J. H. ..."]*

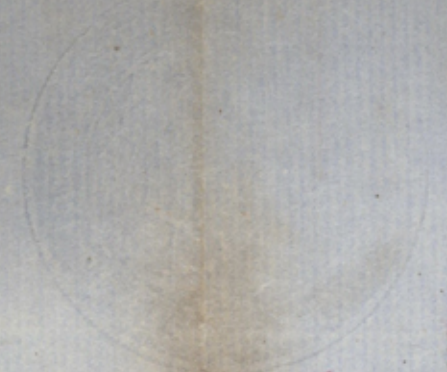

1/ Feb 1747  
Melrose 1st Class,  
S. P. Eldridge

3340  

---

3441

Filed April 19/47

Sas. P. Eldridge  
1/3 copy

S. P. Smith

Republic of Texas }  
Tarrant County } By this public

instrument, Be it known,  
that on the 14th. day of November, in the year  
1837, Before me, Amos Biscoe, Chief  
Justice of the County, and ex officio a Notary  
Public for the Republic of Texas, duly commis-  
sioned and sworn, personally came and  
appeared, James J. Eldridge, a native of  
the United States of America, born in the  
State of Virginia, aged about twenty seven  
years, and by the oath of Samuel Moore,  
proved that he has been resident in the  
Republic from the 27th. day of January 1836,  
and having sworn that he intends permanently  
to reside in this Republic, and he  
took and subscribed to the oath of allegi-  
ance prescribed by law;

And on the 16th day of November  
of the same year, came again the same  
James J. Eldridge, and by the oath of  
John Clayton, made proof that he has been  
resident in this Republic from the 27th.  
day of January 1836, to the present time,  
(all which will more fully appear by reference  
to the archives of my office) and prayed that  
the same might be certified to him as proof  
that he is entitled to a head-right of land  
under the Colonization Laws of the State of  
Coahuila and Texas. — Wherefore I grant

these presents under my hand and  
seal of the County, at Houston, this  
16th. day of November, in the year  
of our Lord, 1837. —

A. Biscoe C. J. H. C. }  
ex Off. Not. Pub. }

J. J. Clavidge

Certificate of Residency

Nov 16/37

San Simons

No. 1.

2

Feb 1749

Milam 10/10/49

J. G. Eldridge

best of residing  
40

Filed Apr 19/42



# Statement

To the Commissioner of the General Land Office  
You will see by the foregoing field notes that they are  
in conflict with the D. Farmer, Survey sent up by  
the former Surveyor of this County which I wish  
to explain as follows

The D. Farmer certificate was an unlocated  
balance and therefore the Surveyor decided that  
his instructions were such that he was compelled  
to fill it out if there was vacant Land enough  
to do so. But the Owners of the present entry  
claim that the present entry having been  
filed the same Day as the D. Farmer entry  
the Land was not vacant at the time  
but the fact that the present entry calls  
for Gauss's (The Owner of the D. Farmer's) line  
the Surveyor decided gave priority to Gauss  
and ordered the Survey made as reported to  
you at the time although it was not in  
exact accordance with the entry made at the  
time

But this Party claim it as their right that  
the case be reported to you for a decision as  
they are not willing to submit to it as it is  
and they have called upon me to send you  
these field notes, and the above Statement

Yours Respectfully

John G. Wilson

13

Co. Sur. - Milam Co.

Milam Co. 72  
Feb. 1747  
Milam Co.  
Field No. 923898  
J. G. Eldridge  
Filed April 19/72

On a survey marked  
on map. D. Farmer  
otherwise correct on  
map of Milam Co.  
June 12/72  
not shown

Cancelled by ~~noted~~ ~~filed~~

G. C. May 10/72 St.

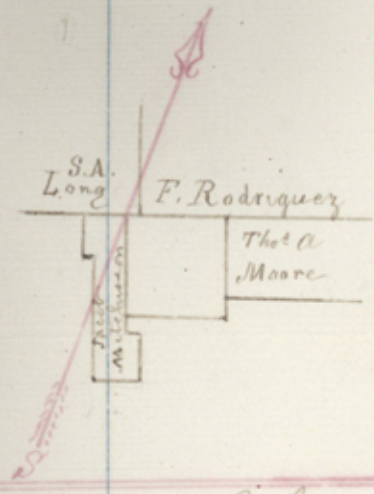

The State of Texas }  
 County of Milam } Field-notes  
 of a Survey made for Joseph P. Sneed  
 by virtue of a certificate No  $\frac{3340}{3441}$  issued  
 by S. Crosby Com<sup>r</sup> Feby 28<sup>th</sup> 1854 in accordance with  
 an Act authorising and requiring the Commissioners  
 of the General Land Office to issue to James G.  
 Eldridge a Certificate for one third of a League  
 of Land passed February 8<sup>th</sup> 1854  
 This survey is situated <sup>in Milam Co</sup> about ~~17~~ <sup>17</sup> Miles <sup>47°</sup> S. E. from Cam-  
 eron and north from Cedar Creek

Beginning at a corner in <sup>The line of a Four</sup> ~~an~~ <sup>League</sup> ~~Corner~~ Grant in the name of Rodriguez supposed to  
 be Jacob ~~Mitchuson~~ <sup>Mitchuson</sup> corner, from which two Post  
 Oak trees are the bearing trees, from which a  
 Black Jack marked I bears N 24 1/2° W 7 rods thence  
 S 19° <sup>E</sup> with an old line <sup>1984</sup> ~~2044~~ varas to a corner in  
 a Water <sup>at 1950 of crop a Creek at 2075 varas</sup> ~~Marsh~~ thence N 71° <sup>E</sup> to another corner  
 thence N 19° W at <sup>221</sup> ~~356~~ varas passed the S. W. corner  
 of a Survey made for Thos. A. Moore at <sup>1984</sup> ~~3059~~ varas  
 the N. E. corner of this survey in the S. E. line  
 of P. Rodriguez it being also the N. W.  
 corner of Thos. A. Moore from which a Post Oak  
 marked X bears S 41° W 9 3/4 varas and a Black Jack  
 marked I bears N 63° E 8 1/2 varas thence S 71° W

For changes see Surveyors statement at the end  
 of corrected field-notes for 1. 142. 000 19. 000.  
 S. W. B.

x by o.c.

x 2075 varas

With Rodriguez line to the beginning containing  
730  
730 acres of Pasture Land being the remainder  
to which he is entitled to by virtue of the  
above certificate surveyed March 27<sup>th</sup> 1872

Alex. Wardcastle & Chain

J. P. Sneed & Carriers

I, John S. Wilson County Surveyor Milam  
County do hereby certify that the foregoing  
Survey was made according to Law and that  
the limits boundaries and corners with the  
marks natural and artificial are truly  
described in the foregoing plat and Field-  
notes, and that they are recorded in My  
Office in Book A page 434

given under My hand this the 2<sup>nd</sup> April 1872

John S. Wilson  
Co-Sur Milam County

4  
Milam Co. Tx  
No 1747  
Milam 1st Class

4. 120. 850.  
Fildark 4. 25. 360  
m. art. 152  
James P. Eldridge  
Filed Apr 19/72

5248  
391760  
39315  
4335360

Correct on map  
of Milam Co.  
Supt. P. P. Co.  
June 12/72  
Aug. 30/72  
not recommended  
C. W. P. P. S. L.

Let Survey  
Patented to Webb Kidd  
Access Sept 12/72  
A. S. L. S. L.  
MW 85 Vol 19  
Sept 1872

Di. Survey of last course omitted  
C. C. Aug. 30/72 C. W. P. P. S. L.  
C. C. July 18/72 St.



The State of Texas }  
 County of Milam } Field notes  
 of a survey made for Joseph P. Sneed  
 by virtue of Certificate No.  $\frac{3340}{3441}$  issued

by S. Crosby Comr. Feb'y 28<sup>th</sup> 1834 in accordance  
 with an Act authorizing and requiring the  
 Commissioner of the General Land Office to  
 issue to James S. Eldridge a Certificate for  
 one third of a League of Land passed Feb'y 8<sup>th</sup> 1834  
 This survey is situated on the North side of  
 Cedar Creek and about ~~2 miles S. 45 E of~~ <sup>14 miles S. 45 E of</sup> ~~the~~ <sup>the</sup> ~~Bay~~ <sup>Bay</sup>  
 of ~~Commerce~~ <sup>Commerce</sup>.

Beginning at the S.E. corner of Lewis Wells  
 survey from which a Post Oak bears N 65° E 900  
 and another marked D bears S 37° E 400 thence N 19° W  
 950 to the N.E. corner of Wells a Black Jack  
 bears S 42° E 500 and another bears N 21° W 400 thence  
 N 71° E 670 to the S.E. corner of a preemption claim  
 in the name of Annie Webb from which a Post  
 Oak marked A. bears N 42 1/2° W 700 and another bears N  
 7 1/2° E 8 1/2 000. Thence N 19° W 950 to the N.E.  
 corner of Webb's from which a Post Oak marked H  
 bears S 22° E 4 1/2 000. Thence S 71° W 950 to the  
 N.W. corner of Webb's from which a Black Jack  
 bears S 25° W 1 1/2 000 and another bears S 5 1/2° E 500  
 Thence S 19° E 950 to the S.W. corner of Webb  
 in the line of L. Wells from which a Black Jack  
 bears N 41° E 900 and another marked X bears S 12 1/2° E  
 900. Thence S 71° W 637 to a corner of A. Jett's  
 survey from which a Black Jack bears S 38° W  
 400 and another bears N 54° W 400 — Thence N 19°

5

Milam Co. 273

File 1747.

Milam 1st Class  
m. abt. 153.

Field notes 1919 300 Sps

J. C. Eldridge  
Filed April 19/72

Correct as map of  
Milam Co. June 12/72  
unrecorded ~~Shiloh~~

Patented to Noble.  
Kiddies Aug 10/72  
J. C. Eldridge

W 57 W 00 19  
6 Aug 1872

C. C. May 10/72 Th.

W 1088 was with the lines of Gatt and Hutchcock  
to a corner from which a Post-Box bears N64W  
6000 and another bears N20E 10000 Thence  
S171°E 16500 to W. Th. line of a survey in the name  
of J. Gibbon <sup>to a corner</sup> from which a Blair's 618 bears  
N47°E. 8000 and a Whicker's bears S99W 13000  
thence S19°E with a survey in the name of J. A.  
Long 20000 to the N. Corner of John Turner's  
survey thence S71°E 73300 to the place of  
beginning containing 540 acres of prairie land  
W. G. Jackson &  
D. S. Lane  
Surveyed March 30<sup>th</sup> 1872

J. John E. Miller County Surveyor Milam County  
do hereby certify that the above survey was  
made according to law and that the limits  
boundaries and corners with the bearings, natural  
and artificial are truly described in the fore-  
going plat and field notes and that they  
are recorded in my Office in Book A  
page 433 given under my hand  
this 1<sup>st</sup> day of April 1872  
John E. Miller Co. Sur  
Milam County



The State of Texas  
 County of Milam  
 Field notes  
 of a Survey made for Joseph P. Smed  
 by virtue of Certificate No  $\frac{3240}{3441}$  issued  
 by S. Crosby Comr Feb 28<sup>th</sup> 1854. in accordance with  
 An Act passed Feb 8<sup>th</sup> 1854 Authorizing and requiring  
 the Commissioner of the General Land Office to issue  
 to James G. Eldridge a Certificate for  $\frac{1}{3}$  of a League  
 of Land

This survey is located about  $\frac{7}{16}$  Miles South West  
 from Nashville and  $\frac{19}{100}$  miles S. 58° E of Cameron  
 beginning at a corner made  
 for C. Wickson in the N.E. boundary line of Chas  
 M. Matthews survey from which two Post Oaks are  
 the bearing trees and also another Post Oak marked  
 X bes N 79° W 1200rs thence N 55° W with Matthews  
 line, at 2140 rs crossed Willow Branch at 3280 rs was  
 a corner of this survey at the intersection of Matthews  
 and Rodriguez' lines from which a Post Oak 14 in  
 in dia marked X bes S 86° W 4  $\frac{3}{4}$  rs, thence N 71° E  
 with the Rodriguez line at 981 rs comes to the N.W. corner  
 of a survey in the name of F. Ariola thence S 30° E  
 with the lines of F. Ariola and C. Wickson 1879 rs  
 to the place of beginning, containing 160 Acres  
 all pasture Land Surveyed March 27<sup>th</sup> 1872

J. P. Smed Chain  
 Alex. Wardcastle Surveyor

J. John. C. Wilson County Surveyor Milam County  
 do hereby certify that the above survey was made accor-  
 ding to Law and that the limits, boundaries,  
 and corners with the marks natural and artificial  
 are truly described in the foregoing plat and field notes

Milam Co. 72

6

File 1747

Melrose 1st

m. abt. 154.

Field notes 903 200 5

Jas. P. Eldridge

Filed April 19/42

Correct on map of  
Milam Co. June 12/72  
surrounded the copiers

Patented to Noble  
Kidd Assoc Aug 5/72

A Goulour

no 49 vol 19  
5 Aug 1872

cc. May 10/72 Jh.

Patented to Noble Kidd Assoc

and that they are recorded in my office in  
Book A page 431 given under my  
hand this the 1<sup>st</sup> day of April 1872.  
John B. Wilson Sec-Gen  
Milam County

17<sup>4</sup>/<sub>7</sub> mil 1

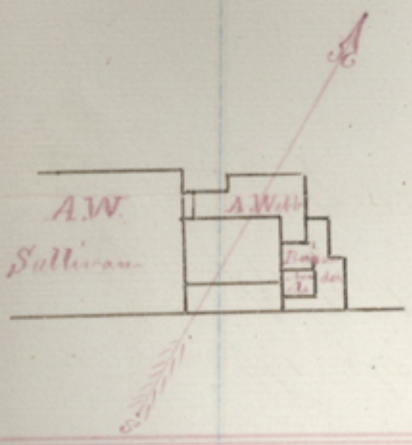

The State of Texas  
 County of Milam & Field notes  
 of a Survey made for J. P. Sneed  
 by virtue of Certificate No  $\frac{3340}{3441}$

issued by S. Crosby Com<sup>r</sup> in accordance  
 with an "Act authorising and requiring the  
 Commissioner of the General Land Office  
 to issue to James. G. Eldridge a certificate  
 for One Third of a League of Land" passed  
 Feb 8<sup>th</sup> 1854 — This survey is located  
 about 4 Miles West from Nashville

Beginning at the S.E. corner of A.W. Sullivan  
 1/3 of a League, — thence N 30° W <sup>+4,40</sup> ~~57~~ rods to a  
 Stake for corner from which a Mesquit tree  
 bears S 42° E 182 rods thence N 60° E <sup>+1935</sup> ~~2000~~ rods  
 to another corner in the W. by. line of H. News, — Thence  
 S 30° E with News and Brawder's West line <sup>+440</sup> ~~57~~  
 rods to a corner in the North line of Jennett  
 Bowen's League Thence S 60° W <sup>+1935</sup> ~~2000~~ rods to the  
 beginning containing <sup>+55,400 sq. rods.</sup> ~~200~~ acres, all  
 Pasture Land Surveyed March 26<sup>th</sup> / 72

† Connection of Feb.  
 26-73 in file No  
 1-1701.  
 Richardson

Joseph Sneed & Chas  
 A. Hardcastle & Carriers  
 J. John, G. Wilson County Surveyor Milam  
 County do hereby certify that — the —

foregoing survey was made according  
to Law and that - the limits boundaries  
and corners with the marks natural and  
artificial are truly described in the  
foregoing plat - and Field - notes and that  
they are recorded in my Office in Book A  
page 430 - given under my hand  
this the first - day of April 1872

John G. Wilson  
County Surveyor W. V.

To the Hon Jacob Knechtler  
Com<sup>r</sup> of the General Land Office

I wish to  
withdraw the field notes of a survey beginning  
at A. W. Sullivan's  $\frac{1}{3}$  of a League, and made  
by virtue of Certificate - No.  $\frac{3340}{3445}$  issued to  
James G. Eldridge and would substitute  
the above field notes as being more correct  
under existing circumstances.

I also wish to have corrections made  
as follows in a survey made by virtue of  
the above certificate and beginning at  
J. Mitchessons corner - The lines running  
respectively  $S 19^{\circ} E$  and  $N 19^{\circ} W$  I wish

Reduced from 2089 to 1984 varas and  
passing Thos. A. Moore's corner at 221 varas  
instead of 326 varas which will make  
the survey contain 730 acres instead of  
768 acres as before

In regard to the survey made  
by virtue of the above Certificate and  
Beginning at a corner made for C. Wickson  
in the N.E. boundary line of Chas. Matthews  
I have to state that - the lines and  
corners are all plainly marked and  
easily found and do not conflict on the  
ground and therefore my fieldnotes are  
correct

John. C. Wilson  
County Surveyor  
Milam County

1747

Philad 1st Edn,  
m. aut. 156.  
Corrected

Includes 202 a.c.  
1,442,000 sq. vs.  
James G. Eldridge  
Filed Aug 29/72

Corrected map of  
Michigan Co. in regard to  
Appt 20/73. E. W. P. P.  
copy which also applies to the  
survey Aug 1/72. E. W. P. P.

Patented to Webb Kidd  
Apr 23 May 23/73  
A. S. out our

no 382 vol 191 P. need  
23 May 1873 Aug 29/72

E. W. P. P. Aug 30/72  
S. C. Apr 16/73. P. and E. W. P. P.



The State of Texas  
 County of Milam } Field notes  
 of a survey made for Joseph P. Sneed  
 by virtue of Certificate No.  $\frac{3340}{3441}$   
 issued by S. Crosby Com<sup>r</sup>. July 28<sup>th</sup> 1854 in  
 accordance with an Act authorising and re-  
 quiring the Commissioner of the General Land  
 Office to issue to James G. Eldridge a  
 Certificate for one third of a League of  
 Land passed July 8<sup>th</sup> 1854 Situated in Milam  
~~County about 18 miles S. 80° E of Cameron and~~  
 Beginning at a stake on the West bank of the  
 Brazos River for the S.E. corner of this survey  
 it being also the N.E. corner of a Labor survey  
 in the name of James Shaw from which a  
 Cottonwood tree 24 inches in Dia marked T  
 bears N 56° W. 7 varas and an Elm 5 inches in  
 Dia marked A bis N 71° W. 8 1/2 varas thence S 60° W  
 with Shaws line 1418 varas to a corner from which  
 a Post Oak 18 in in Dia marked C.B. S 78° E  
 12 1/2 varas and another 10 inches in Dia marked  
 X bears S 44° W. 3 1/2 varas thence N 45° E with the E  
 boundary line of a survey in the name of T. J.  
 Chambers 1380 varas to the corner of Chambers  
 Survey on the bank of the Brazos thence S  
 43° E 366 varas with the River to the beginning  
 containing forty five  $\frac{5}{7}$  acres of Land  
 A.C. Thompson } Chain Surveyed July 4<sup>th</sup> 1855  
 Jas. Evans } Surveys  
 W.D. Thompson } Marker  
 I, John L. Wilson County Surveyor of Milam  
 County do hereby certify that I have examined

Milam Co. 72

8 / File 1747

Milam 1st Class

m. abt. 155

Sheetwork 257, 258, 259

J. G. Eldridge

Filed Apr 19/72

Consent on map of  
Milam Co. June 12/72  
The map is  
surrounded

Patented to Webb & Child  
also Aug 6/72

A. G. Johnson

no 50 vol 19

6 Aug. 1872

C.C. May 10/72 5th.

The foregoing plot and find them correct and  
that they are recorded in my Office  
in Book A Page 432. given under my  
hand this the 22<sup>d</sup> day of April 1872

John B. Wilson

County Surveyor

Milam County

The foregoing survey is one done by a  
former legal surveyor of this district - whom  
I wish to adapt according to provision made  
allowing surveys to do so if they believed  
them correct - as I believe this one to be  
John B. Wilson  
Com<sup>r</sup> in Law Milam Co

5645  
7/22 157 50/3225  
228 2 2 5  
225 6 1 5  
3 2 2 5  
257 2 5 0  
5645  
5645  
5645

Republic of Texas }  
Harrisburg County } Know all men by these  
presents, that I, James  
J. Eldridge, of the Republic of Texas, and late  
of the Army thereof, have made, created,  
nominated, constituted, and appointed,  
and by these presents, do make, nominate,  
constitute, and appoint, Morgan C. Hamilton  
of the County and Republic above named,  
my only true and lawful attorney, with  
full and ample power in my name and  
of my right, and in my stead, to choose,  
select, and locate my headright of land  
to which I am entitled as a settler in the  
Republic of Texas, before and at the time  
of the declaration of Independence, acquired  
under the Colonization laws of the State of  
Coahuila and Texas, and confirmed to me  
by the Constitution of this Republic, which  
consists of one third of a league of land,  
to be selected from any unappropriated  
lands of the Republic; and in my name to  
apply for and receive from the proper office  
the patent ~~the said~~ ~~land~~ in his own  
name if the patent shall be made out in  
his name, or in my name if the regulations  
of the land office shall so require it, and  
when the said head-right shall have been  
so located, selected, and patented, to enter upon  
and take possession of the same, with full  
power to hold, occupy, lease, release, mortgage,  
sell, donate, or in any other manner convey  
the same, in the same manner as I could  
do myself if I were myself present and  
acting; for which purposes and all others

necessary in the selecting, locating, claiming,  
enjoying, and alienating the said land, I do  
hereby authorize him the said Morgan C. Hamilton  
to sign my name to all petitions, receipts,  
leases, letters of Attorney, deeds, bills of sale, or  
any manner of conveyances, at such time and  
in such manner as he shall deem proper,  
in all matters touching or in any manner  
relating to the said land, or settlement  
right, - and in case it should not suit the  
Convenience of the aforesaid Morgan C. Hamil-  
ton to select and locate the land aforesaid,  
I hereby authorize and empower him to appoint  
an attorney who shall have such power in  
regard to the said land as the said Morgan  
C. Hamilton shall give him; and I hereby  
ratify and confirm all acts which the  
aforesaid Morgan C. Hamilton or his lawful  
attorney, shall hereafter, by virtue of these  
presents, in my name, and relating to the  
settlement right above named and described,  
do and perform.

In testimony of all which I have hereunto  
set my hand and seal, at ~~\_\_\_\_\_~~ this seventh  
day of November, in the year of our Lord one thousand  
eight hundred and thirty seven, in presence of  
Seth Carey - and J. D. Watkins, of the  
County of Harrison, witnesses signing with me and  
Andrew Buscoe, Chief Justice of the County, who has  
also hereunto set his hand and seal as a Notary Public  
in order to give this all the faith and credence of a Notarial  
act. witnesses

Seth Carey  
J. D. Watkins

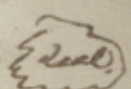
James T. Eldredge 

A. Buscoe C. J. H. C.  
of off. Not. Pub.

our Lord, one thousand eight hundred and  
thirty seven, and in the year of the Republic  
the second, in the presence of Seth Carey  
and J. D. Watkins, of the County of Harrison  
witnesses signing with me, and Andrew  
Biscoe, Chief-justice of the County, and of office  
a Notary public for the Republic of Texas, who  
has also hereunto set his hand and the seal  
of the County, in view to give this and all  
faith and credence of a notarial act.

Witness

Seth Carey  
J. D. Watkins

James J. Eldredge

A. Biscoe C. J. H. C.  
of off. Not. Pub.

I, James J. Eldredge, do solemnly swear,  
that I was a resident citizen of the Republic  
of Texas at the time of the declaration of  
Independence; that I did not abandon the  
Country during the Spring of 1836 to avoid a  
participation in the war; that I did not  
refuse to participate in the war; that I did not  
aid nor assist the enemy; that I have not  
previously obtained my quantum of land,  
as a Colonist, nor sold the same; and that  
I honestly believe that I am entitled to the quan-  
tity of land, for which I have authorized my  
assignee to apply; viz: one third of a league.  
So help me god.

Sworn to & subscribed before me,  
Houston, Nov. 17th. 1837

James J. Eldredge

A. Biscoe, Chief Justice of Harrison County.

9

Feb 1747

Michael Allen

Sir G. Aldridge

Windsor

Thomas C. Hamilton

Feb 17th 1747

Aldridge

Windsor

Nov 17th 1837

No 3

The state of Texas 3  
County of Travis 3 Know all men by these  
presents that I, Morgan C. Hamilton, of said  
County and state, for the consideration of Ten  
Dollars in hand paid, by Webb Kidd, the receipt  
of which is hereby acknowledged, do hereby  
transfer, alienate, set over and forever  
quit claim unto the said Kidd, all  
right and interest in and to the aforesaid  
said Certificate, granted to James C. Eldredge  
by J. Brasly, Com<sup>r</sup> of the General Land  
office, on the 28th day of February A. D. 1854,  
under special act of the Legislature  
No <sup>3340</sup><sub>3441</sub> - which should have been issued to James  
J. Eldredge, as shown by his deed of con-  
veyance to me dated at Houston the 14th  
day of November A. D. 1837, which deed  
was laid before the Land Committee of the  
House, along with the Petition, asking  
the Certificate in the name of James  
J. Eldredge. Together with all the rights  
immunities and privileges to the same  
belonging, hereby relinquishing all claim  
to the same, as well for my heirs and legal  
representatives as for myself.

In witness whereof I hereto set  
my hand, at the City of Austin the 14th  
day of May, in the year of our Lord one  
thousand, eight hundred and fifty four.

Morgan C. Hamilton

10  
Feb 1747  
Merrill  
10  
Merrill  
10  
Merrill  
10  
Merrill  
10  
Merrill

That of said [unclear] the undersigned Authority [unclear] of  
David County [unclear] Morgan C. Merrill to me personally and well  
known, who acknowledged that he signed and executed the  
within instrument of writing for the purposes and considerations  
therein expressed.

In testimony of which I have set my hand  
and [unclear] my Official Seal at Clarksville  
24th day of May A.D. 1851.

J. J. [unclear]  
Notary Public  
David County

The State of Texas }  
County of Limestone } Know all men by these  
presents that I, Webb Kidd of County and  
State aforesaid, have this day bargained sold  
& conveyed unto Jos. P. Sneed of Milam County  
all my right and title in the unlocated balance  
of Special Act Certificate No. <sup>3344</sup>/<sub>3441</sub>, issued to James G.  
Eldridge by Com'r. G. L. O. Feb 28<sup>th</sup> 1854 for  $\frac{1}{3}$  League  
of Land, and do hereby ~~con~~ bind myself  
my heirs and assigns forever <sup>to</sup> warrant and de-  
fend the same to him and his heirs and assigns  
having received and hereby acknowledging due  
consideration therefor in locating for me  
the balance of said Certificate Done this  
the 9<sup>th</sup> day of June A.D. 1870

Webb Kidd

The State of Texas }  
Limestone County } Before me J. L. Corcoran an  
acting Justice of the Peace and Ex Officio  
Notary Public in and for said County, personally  
appeared Webb Kidd to me well known  
and acknowledged that he executed and  
delivered the foregoing Conveyance to  
Jos. P. Sneed of Milam County bearing ~~and~~

date November. for the purposes and  
considerations therein set forth. and  
expressed,

being under my hand  
affixed seal at my office  
do here. this 15th day  
of June 1875.

J. H. Brown  
J. P. & Co  
A. D. & Co

" July 1747  
Milam pt Clap

W. Kidd  
To J. Trauser  
J. P. Sued

J. P. Sedidge

Filed Aug 21/76  
Khaad & Kirkus  
City of London

The State of Texas,

Before Me, the undersigned authority, this

COUNTY OF A

day, personally appeared

Joseph P. Sneed

to me well known, who being duly sworn, deposes and says that he is the BONA FIDE owner of the unlocated balance of 281.333  
Acres of special act

Certificate No. <sup>3340</sup> 3444, issued to James Y. Eldridge July 25/54  
by Genl Land Office for 1/3 league

~~Acres~~ of Land; that he has never sold, alienated, or transferred the same in any manner

Joseph P. Sneed

Sworn to and subscribed before me }  
this 4<sup>th</sup> day of Sept 1876 }

T. J. W. Hays  
C. C. Rice

<sup>12</sup> Dec 1747  
Milam per Cap

---

James G. Eedidge  
appt. omnibus

---

And Sept 1746  
Rhaad & others  
of OK

Republic of Texas }  
Winnifred County } Know all men, by these  
presents, that in and for  
the consideration of Six hundred Dollars, Cash  
in hand to me paid, the receipt whereof is  
herby acknowledged and confessed, and  
which I declare to be full and entire Com-  
pensation to my entire satisfaction remane,  
I, James J. Burdige, late of the Texian Army  
and now of the Republic of Texas a resident  
Citizen, have this day given, granted, donated  
alienated, transferred, and conveyed, and  
by these presents, Do give, grant, donate,  
alienate, transfer and convey, and so far  
as in me exists the ability, deliver possession  
of, to Morgan C. Hamilton of the County  
and Republic above named, one third  
of a league of Land, to be located on any  
unappropriated land of the Republic,  
the same having been acquired by me  
under the Colonization laws of the State  
of Coahuila and Texas, by virtue of a  
residence in the Country at the time of and  
before the Declaration of Independence,  
separating this Republic from that of Mexico,  
which land usually called and denominated  
a settlement right or head right, was  
confirmed to me by the Constitution of the  
Republic of Texas, by which instrument  
I am also empowered to sell, alien, and  
convey the same, vesting in the purchaser  
the rights and liabilities which are imposed  
by the laws of Colonization above alluded  
to; to have and to hold the said  
head-right of Land, to him, the said

Morgan C. Hamilton, his heirs, executors,  
administrators, and assigns, to his and  
their own proper use, benefit, and behoof  
forever, alienating and renouncing from  
this day from myself, my heirs, executors,  
and administrators, forever, all right,  
power, or control over the same or any part  
thereof, and vesting in him the said  
Morgan C. Hamilton, his heirs, and assigns,  
all the rights and powers, which originally  
appertain to me as the Settler or Colonist,  
for locating, selecting, and obtaining a  
Patent for the said Head-right, and for  
taking possession of, entering upon, enjoying,  
selling or mortgaging the same, as the full,  
maintained, and lawful owner thereof;

And I do Covenant and agree to  
the said Morgan C. Hamilton, his heirs  
and assigns, the title to the said unlocated  
head-right or settlement-right of land,  
provided that the same shall be located on  
land otherwise unappropriated, against all  
claims of myself, my heirs, executors, and  
administrators, and all persons, holding  
or in any manner claiming by virtue of  
any right of mine or in any wise emanating  
from me, forever to warrant and defend,  
avouching and guaranteeing that I am  
entitled to the quantity of land, which I  
have herein before described as my right  
by settlement as a Colonist.

In testimony of all which, I have  
hereunto set my hand and affixed my  
seal, at the town of Houstow, on the  
sixteenth day of November, in the year of

1837  
I, James J. Claridge, do solemnly swear,  
that I was a resident Citizen of the Republic  
of Texas at the time of the date of the declara-  
tion of Independence; that I did not abandon  
the Country in the Spring of 1836, to avoid  
a participation in the war; that I have not  
refused to participate in the war; that I  
did not aid nor assist the enemy; that I  
have not obtained my quantum of land as  
a Colonist; and that I honestly believe I  
am entitled to one third of a league of land  
for which, through my attorney, I now apply.  
Sworn & subscribed before me  
Houston, Nov. 17th. 1837 J. James J. Claridge  
A. Biscoe Chief Justice  
Harrisburg County

13

Mo 1747

Milieu 1<sup>re</sup> Lie.

Le G. Eldridge

1<sup>er</sup> P. atty.

Thom. Hamilton

Filed G. 17/47

J. F. Eldridge }  
                          } Qua.  
M. C. Hamilton }  

---

Nov 17/37

No 2

Peter Jackson County Surveyor of Melrose County  
Please enter and survey the following lands by  
virtue of Certificate No <sup>3340</sup><sub>3441</sub> Issued from the  
General Land office to James G. Elanage for one  
third of a league Beginning at the SE corner  
of A. W. Sullivan's  $\frac{1}{3}$  of a league Thence N 30° W  
to W. J. Gaus's entry Thence N 60° E 2000 acres to  
the NE corner Thence S 30° E to corner in the line  
of Bennett Downs league Thence S 60° W 2000 acres  
to the beginning

Also by the same Certificate  
Beginning at the East corner of J. J. Chambers  
league on the Pringos Thence across the Pringos  
to the NE corner of James Gaus's land  
Thence S 60° W to a corner in Chambers line  
Thence N 45° E to the beginning

Also by the same Certificate  
Beginning at the SE corner of J. Wells  
survey on Beaver Creek Thence N 19° W to the  
NE corner of Wells Thence S 71° W to the SE  
corner of J. M. Hitchcock Thence N 19° W to the  
SW corner of J. M. Gellaw's survey Thence N 71°  
E to the SE corner of Gellaw Thence S 49° E  
to the NE corner of John Turner's survey  
Thence S 71° W to the beginning

Witness my hand and seal at  
Melrose, March 18<sup>th</sup> 1877. Joseph O. Innes

x Gas. P. Edinger 1476

J P Greer

Witnessed <sup>at</sup> 21<sup>st</sup> 1871

Peter Jackson  
County Surveyor  
Milam County

reentered March 21<sup>st</sup>  
1872

John G. Wilson  
Co. Surveyor Milam Co.

Recorded

14

File 1747.

Richard S. Clark

J. P. Edinger

Filed April 19<sup>th</sup> 1872

To Hon Texas Land Commissioner

This is to certify that the Rev Jos  
P. Sneed has located for me the  $\frac{1}{3}$   
League ~~of~~ Certificate granted to James  
L. Eldridge and I ask that the  
Patents be issued in my name  
by virtue of the accompanying pa-  
pers this the 18<sup>th</sup> April A.D. 1872  
Webb Kidd

15

1744

Mid 1.

*[Faint, illegible handwritten text, likely bleed-through from the reverse side of the page]*

As per Jackson enter for me in the  
 Thomas J. Bailey willis's to mention your  
 Religion the following parcel of land beginning  
 on the Hudson Bay line beginning at the north  
 west corner of a survey for Dr. [unclear] [unclear]  
 Hudson line thence S 71° 8' with the Hudson line  
 road to include all the vacant land  
 Thence from 1871 Joseph O. Good

Also a survey to be made beginning at the S W  
 corner of a survey for St. John in the [unclear] [unclear]  
 survey with his line to the N W corner thence with  
 the following bearings as to include all the vacant land  
 Thence from 1871 J. Good

1747  
 Medium Full  
 Beginning at the South West corner of  
 the [unclear] [unclear] [unclear] [unclear]  
 Thence S 71° 8' with the Hudson line  
 road to include all the vacant land  
 Thence from 1871 Joseph O. Good

0 7 1111 Peter J

Filed June 25<sup>th</sup> 1871

Peter Jackson

Co Sur Milan Co

vs J. B. W. Dyer



MS 1AM - 1<sup>st</sup> Class  
1747

Cert 17 acts

July 8, 1964

J. R. Parker

---