

Bosque Co 178

File

7504

Abst-594-

MILAM PREEMPTION

L. J. McDaniel

160 ~~162~~ Acres

Act

May 26 1873

Correct and map of Bosque
County. Octob. 9/79

~~and~~

Correct for patenting
to H. V. Moon, apc
Oct 10/79

Patented Oct 10/879

in Col 22a

J. D. Davis

N^o. 469 - Vol 9

Mgl.

6476

March 25/79

Oct 3/79

CONTENTS.

No. 1. aff of settlement

No. 2. Fieldnotes

" 3. Transfer

" 4. Cert. of occupancy

" 5. Transfer

" 6. Cert. of fieldnotes

" 7. old wrapper

" 8. Cert. of fieldnotes

May 5. 79 Sept 30 79

& d Book

S. 5th dep'd. Aug 27 78
by T. M. Collier
Meridian.

The State of Texas }
County of Bogue } Before me Jno James
Clerk of the District
Court of Bogue

County Texas. this day came and
personally appeared the Citizen
L. T. Mc Daniel. to me known
who after being by me duly
sworn upon his oath deposes
and says that he is now a
bona fide settler upon One
hundred & Sixty (160) acres
of land. that he believes to be
of the public domain of the
State of Texas. that he is impro-
ving said land for a Homestead
and has no other. and further
that he is a married man. with
a family. said Land is
situated in Bogue County Tx.
about 7 miles North West from
the town Meridian. adjoining
the pre-emptions of Fowler and
Clive. - and more particularly
described by the accompanying
field notes.

Given under my hand & seal
of said Court at Office in
Meridian. this Aug 27th 1873
Jno James
Clerk D. C. B. Co

D File 1554

Milaw Preemption
Card of Settlement

L. T. M. Daniel

Filed July 1/74
Thomas Fisher,
Clerk.

L. T. M. Daniel
Recorder.

The State of Texas
 County of Bosque

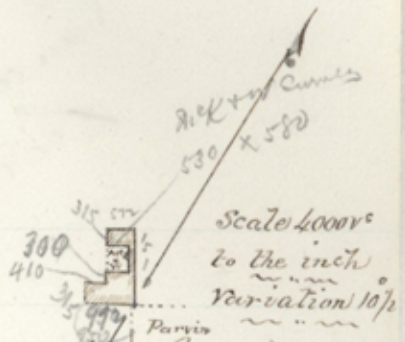

Field notes of a

Survey of 12 1/2 acres of land made
 for L. G. McDaniel, by virtue of
 Pre-emption Cert. issued by the
 Dist. Clerk, August 27th /73.

Situated on the waters of the Bosque
 about 7 miles N.W. of Meridian
 commencing 42 ms N 60° E from the
 N.W. C. of Parvin Survey, from which
 a Live oak ^{mkd C} bears S 19 W 5 ms marked C

Thence N 30° W 15-10 ms N. E. C. a pile of
 rocks on the bank of a branch

Thence S 60° W 5-72 ms - N. W. C. a pile of
 rocks about 75 ms from bank of branch

S 30° E 315 ms N. W. C. of 5 1/2 acre survey
 made for M. Kinney & Williams

N 60° E 5-30 ms - N. E. C. of same a Pile of rocks

S 30° E 580 " S. E. " " " " "

S 60° W 5-30 " S. W. " Live Oak mkd D

ms S 68° E 104 ms and a Live oak mkd P

ms S 64° E 102 "

S 30° E 300 ms to corner of Loader's pre-emption

S 60° W 410 " " " on Loader's line

a pile of rocks

S 30° E 315 ms S. W. C. of this a pile of
 rocks

N60°E 950ms to c. of Parovis, 992 ms to
place of beginning.

Surveyed May 21 1874

Wm Billingsly Zecher
R. G. Childress Zecher

I hereby certify that the foregoing
survey is correct and made according
to law Recorded in Pre-emption Book
Page 142 in 10th Macaulay
County Surveyor
Bozard Co.

L. J. McDaniel

2) File 1534

William Preemption

Field notes of 12.2/20

L. J. McDaniel

Filed July 1/74
Thos Childress
L. J. McDaniel

Seems to disagree with
adjoining surveys.
Surveyors will be
forwarded to Ketchikan
all adjoining surveys
and instructions so
we get the correct
true discrepancy should
be - Aug 28/74
Johnson

2 Aug 74
C. J. H. H.

The State of Texas } Know all men
 Basque County } by these presents
 that I S. I. McDaniel of the afore-
 said county and state in consid-
 eration of three hundred dollars to
 me paid by Ellen Harvick the
 receipt of which is hereby acknow-
 edged have bargained sold and
 conveyed and by these presents
 do bargain sell and convey to
 the said Ellen Harvick the following
 described tract or parcel of land
 to wit, one hundred and twenty
 two and one half acres of land, my
 preemption made by virtue of certificate
 issued by the District Clerk of Basque
 County Aug 21st 1873 situated on the
 waters of the Basque about 7 miles
 N. N. of Meridian Beginning 42 or
 N 60 E from the N. N. corner of Parvin
 survey from which a Live Oak tree S.
 19 N 5 or marked C, thence N 30 W 15-10 or
 to N. E. corner a pile of rocks on bank
 of a branch, thence S 60 W 5-7 2 or
 to a corner a pile of rocks about 75
 or from bank of branch, thence S 30 E
 2-15 or to N. N. corner of a 5/8th acre
 survey made for McKinney and
 Williams, thence N 60 E corner of

same, thence S 30 E 5-80 us S. E. corner
of same, thence S 60 W 5-80 us S. W.
corner of same, from which a Live
Oak marked O has S 68 E 104 us
and a Live Oak marked P has S 64 E
102 us, thence S 30 E 300 us to corner
of Loaders preemption, thence S 60 W
410 us to corner on Loaders line
thence S 30 E 315 us to S. W. corner
thence N 60 E 950 us to corner
of Darwin, thence 992 us to beginning,
said preemption surveyed May
23^d 1874 by Wm Mc Canloy
surveyor of Bosque Co.

To have and to hold the said
tract of land with all the rights
and improvements thereto belonging
to the said Ellen Kearnock her heirs
and assigns forever.

Witness my hand this
29th day of Dec. 1875

L. J. Mc David

The State of Texas &
County of Bosque & Before me J. K. Hel-
ton Notary Public in
and for the County of Bosque

**THE STATE OF TEXAS,
Bosque County.**

I, John James, Clerk of the Dist., Court of Bosque
County, Texas, do hereby certify that the above

and foregoing Deed with attached certificate, was filed for record, on the 10th
day of April A. D. 1876 at — o'clock — M., and was duly
recorded in Bosque County Deed Records, Book P Page
6

WITNESS, my official signature, and the seal of the District Court of
Bosque County, Texas, at office in Meridian, on this the 10th

day of April A. D. 1876

John James
Clerk District Court, Bosque County, Texas

By L. H. Owen Deputy

this day personally appeared
L. J. Daniel, who acknowledged
the execution and delivery
of the above and foregoing In-
strument of writing, for all
the uses, purposes, and consider-
ations therein ~~contained~~ con-
tained and expressed.

Witness my official
seal and signature
at office in the town
of Meridian this
the 29th day of December A.D. 1876

J. H. Gullett
Notary public

3

File 1554.

Milam Preemption.

L. S. McDaniel

L. S. McDaniel

to 3 Deed

To Transfer

Ellen Harvick

Ellen Harvick

filed Aug. 27. 78

McWalsh

Filed for record

Feb'y 10th 1876

Clerk

Jur James Clark

By L. S. McDaniel, per page

Recorded -

Proof of Settlement under Homestead Act.

The State of Texas,

County of Bosque

Before Me, the undersigned County Clerk in and for the County aforesaid, this day came and personally appeared Hefekiah Moore ^{resign.} a resident citizen of said

County, who being by me duly sworn, declares that he is a bona fide settler upon 102 1/2 acres of vacant public land, situated in said County, and surveyed for L. S. McDaniel

on the 21st day of May 1874, by Wm McCanley

a Surveyor of said County; that he has occupied and improved the same as a Homestead for a this affidavit and those under which he holds period of three consecutive years, beginning on the 21 day of May 1874 that

he is a married man and that he makes this affidavit for the purpose of obtaining a title to the same for a Homestead, under an Act supplementary to "An Act for the Benefit of Actual Occupants of the Public Lands," approved May 26th, 1873, and Acts prior thereto; and that he has not a Homestead other than the above.

AND, also, at the same time came and personally appeared Milton Cline and Andrew J. Jordan two credible resident citizens of said County,

to me well known, who being duly sworn, depose and say that H. V. Moore ^{is now}

the person first above named in this affidavit, has actually settled upon and cultivated as a Homestead, the land surveyed for him on the 21st day of May 1874, by the

Surveyor aforesaid, for the period of three years, and they, nor either of them, have any interest in the said land.

H. V. Moore
Milton Cline
A. J. Jordan

Sworn to and subscribed before me, and I hereby certify that Milton Cline and A. J. Jordan are credible and trustworthy citizens of said County.

IN TESTIMONY WHEREOF, I have hereunto set my hand and affixed the seal of said County, at office, this 17th day of August 1874.

F. Mc Collier
Clerk of Co Court Bosque Co.

File 1554

Milam Preemption

L. J. McDaniel
by H. V. Moor, Aps^{ca}.

Certificate of occupancy

filed Aug. 27/78.

M. S. Walsh
Comr.

Sends up to Land office
95.00 left as fee.
wt transfers from

R. G. Childress
PROOF OF
SETTLEMENT OF LAND

H. V. Moor
under: Ellin Harris et al
Harris et al
L. J. McDaniel Settler.

Handwritten notes in purple ink, including 'Harris et al' and other illegible text.

Extensive handwritten notes in purple ink on the right side of the page, including 'Harris et al' and other illegible text.

State of Texas
County of Bosque }
Know all men by these presents
that I Ellen Sawick of the county and state aforesaid
in consideration of two horses that have been turned over
to me, and one two horse wagon which is also to be turned
over to me ^{by} ~~with~~ of H. V. Moore when the patent on
the hereinafter described preempted tract of land is
issued, have bargained, sold and conveyed, and by these
presents do bargain, sell and convey to the said H. V.
Moore all my right, title and interest in the following
described preempted tract of land, to wit: One hundred
and twenty two and one half (122 1/2) acres my preemption
made by virtue of a certificate issued ^{by} of the
District Clerk of Bosque County Texas Aug 27th ad. 573
and purchased from L. T. McDonald on the 29th day
of Dec. 1845, the record of said transfer being
recorded in Book P. page 6. of Bosque County deed
records. Said preemption being situated on the waters
of the Bosque about 7 miles N^W. of Moredian
beginning 4200000 N 60° E from the N^W corner
of the Prairie survey from which a live oak bears
S. 19° W 5000. marked C; thence ~~N 30° W~~ N 30° W 1570
000 to the N E corner pile of rock on bank of a
branch; thence S. 60° W 5720 000 to a corner a pile
of rocks about 75000 from bank of branch; thence
S 30° E 315000 to N^W corner of a 542 acre
survey made for McKinney & Williams; thence N. 60°
E to corner of same; thence S. 30° E 580000 to S. E.

corner of same, thence S 60^W 435⁰⁰ to S^W
corner, from which a live oak marked O bears
S 68 E 184⁰⁰ and a live oak marked P bears S 64 E
182⁰⁰; thence S 30 E 300⁰⁰ to corner of Loder's preemption
thence S 60^W 410⁰⁰ to a corner on Loder's line,
thence S 30 E 315⁰⁰ to the S^W corner, thence
N 60 E 950⁰⁰ to the corner of Parvin survey, thence
992⁰⁰ to beginning, said preemption conveyed, May 23rd
1874 by William McBauley County Surveyor of Boone
County. To have and to hold the said tract of
land with all and singular the rights and improve-
ments thereto belonging to the said H. V. Moor
his heirs and assigns forever.

In testimony whereof I hereunto set my hand and
seal using scroll for seal this day of June

At 1874.
Witnessed J. D. Martin Eben Harriek
H. V. Loder

STATE OF TEXAS, }
BOSQUE COUNTY. }

Before me, *J. M. Ballier*

appeared *mrs Ellen Harwick* who is to me
well known, and acknowledged that *she* signed,

executed and delivered the foregoing instrument of writing, for the purposes and consideration therein specified.

WITNESS my official seal and signature, at my office, in the town of

Wardman this the *20th* day of

September A. D. 187*8*.

J. M. Ballier Clerk C. C., B. C.

Per *J. A. Ballier* Deputy.

As 99

Ellen Hawick

To } Dad.

H. J. Mass

[Faint blue ink scribbles]

[Faint blue ink scribbles]

[Faint blue ink scribbles]

[Faint blue ink scribbles]

[Faint blue ink scribbles]

[Small blue mark]

5/ File 1554.

Milam Preemption.

L. J. McDaniel.

Ellen Carvick

To Dad.

H. V. Moor

Ellen Carvick

To Transfer

122 1/2 Acres

H. V. Moor.

Filed Sept. 6th 1878

W. Walsh.

Commr

auth

Must be authentic

The State of Texas ^{corrected} field
County of Bosque notes of L. T.
McDaniel preemption survey of 102
acres the same having heretofore been
made by Wm McCauley on the 23rd
of May AD 1874 and has been cor-
rected by James M Robertson County
Surveyor of Bosque County on the 19th
day of March AD 1879. Said survey
having been first made by virtue of L.
T. McDaniel's certificate of occupa-
cy issued by the District Clerk of
said county on the 27th day of August
AD 1873.

Beginning at the S W corner of James
Howe 320 acre survey from which a
Live Oak marked C bears S 19th W 500
Thence N 30th W 1099 varas to the
S. E. corner of Isaac Gary's survey
the same being in the west line of
said Howe survey; Thence S 60th W
572 varas to the N E corner of a survey
made for Wm Billingsley the same
being in the south line of Isaac
Gary's tract; Thence S 30th E 219 varas to
the N W corner of a 54¹/₂ acre tract
made for McKimney & Williams;
Thence N 60th E 530 varas to the N E
corner of said McKimney & Williams

situated in
Bosque Co

Thence S 30° E 580 varas to the S E corner
of said McKimney & Williams;
Thence S 60° W 530 varas to the S W
corner of said McKimney & Williams
Thence S 30° E 411 to the S E corner
of T. F. Loaders pre-emption survey;
Thence S 60° W 420 varas to a pile
of rocks in south line of said Loaders
survey; Thence S 30° E 204 to the
N W corner of O. Blinc pre-emption
survey; Thence N 60° E 950 varas to the
N. E. corner of Cline's survey;
Thence N 30° W 315 varas to the
N W corner of Wm Parvins survey
Thence N 60° E 420 varas to the
beginning

Wm Ballinger } c
R. L. Childers } c

The State of Texas }
County of Bosque } I James M. Robertson
Surveyor of Bosque County do hereby
certify that the above survey was
corrected according to law and
that the same is in accordance
with the lines and corners on
the ground around said sur-
vey.

James M. Robertson
Co Surveyor Bosque Co Tex

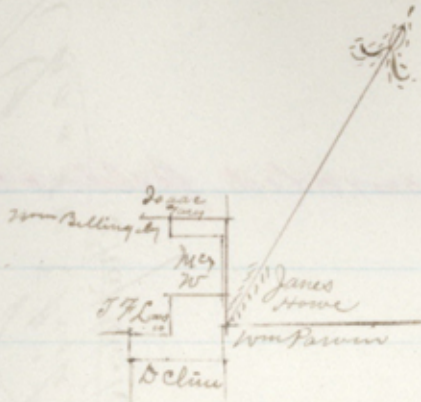

The State of Texas &
 County of Bosque & I James
 M. Robertson County Surveyor
 of Bosque County Texas
 do hereby certify that I have
 examined the foregoing
 plat and find it correct and
 that they are recorded in my office
 in Journal No. 6 page
 142

James M. Robertson
 County Surveyor Bosque
 County Texas

File 1554

Milam Preemption

L. J. McDaniel

102 Acres

Corrected field notes.

field March 24/79

~~Charles Fisher~~
Chief Clerk

Still in

15

Cancelled by omitted field notes

Corrected Field notes

of
L. J. McDaniel

Boque Co

2
a
Mch 25
1879

Bosque Co. 1874

File

1554

Milam Preemption

L. J. McDaniel

122 1/2 acres.

Certificate No.

Field notes endorsed

Aug 28/78

This survey gives the McKinney or
Harris survey S. 19 1/4 p. a wrong position
It will conflict with J. C. Garry
P. 1053 and the call for TF leader
is erroneous. See explanatory
Sketch within compiled in Office
Oct 30/78

Three papers
for corrected field
notes in correction
made 25/78. E. Sparty
Groves

Sept. 7/78

Nov 4/78

Sketch sent to T.
A. Collier

Mgl. 6476

o/mk 25
o/114 79

c/ang 6
o/114 74

No. 1. Cert of Settlement
2. Field Notes

3. Transfer July 1st 78
Moore

4. Cert. of occupancy
(Aug 27 78)
Ed Beck

5. Transfer Sept. 6 78
Ed Beck

6. Cert. field notes
March 24 79
Ed Beck

\$5.00 deposited Aug 27 78
by T. A. Collier
P. 142 Vol. 4. A.B.
Meridian.

The State of Texas. Corrected field notes of 160
County of Bosque } acres of land made for
L. J. McDaniel by virtue of his certificate
of occupancy issued by the District Clerk of
Bosque County on the 27th day of August
A. D. 1873. Said land is situated in Bosque
County, Texas about $5\frac{3}{4}$ miles ^{North 66°} west of Meridian
Beginning at the S.W. corner of James Stone for
the beginning corner of this survey; Thence N 35° W
1099 varas to a pile of rocks in Stone's west
line being the S.E. corner of Isaac & Gary's.

Thence S 60° W 572 varas to a corner the same
being the S.E. corner of Wm. Billingsley sur-
vey; Thence S 30° E 219 varas to N.W. corner of
54½ acres made for McKinney & Williams;
Thence N 60° E 530 varas to the N.E. corner
of M^o & W^o ^{McKinney} ^{Williams}; Thence S 30° E 580 varas to the S
E corner of M^o & W^o; ^{same} Thence S 60° W 530 varas
to the S.W. corner of, ^{same} M^o & W^o; Thence S 30° E
411 varas to the S.E. corner of J. F. Loader a
pile of rocks in prairie; Thence S 60° W 1204
varas to the S.W. corner of J. F. Loader a pile
of rocks from which a live oak hooked
bears N 27° W 100 varas; Thence S 30° E 418
varas to a pile of rocks in the brush;
Thence N 60° E 784 varas to a pile of rocks
in west line of D. Blines; Thence N 35° W 214
varas to D. Blines N.W. corner a pile of
rocks; Thence N 60° E 950 varas to D. Blines

N. E. corner a pile of rocks from which an elm marked B bears N 3 W 18 rods, Thence N 30° W 315 rods to the N.W. corner of Wm Parvin a pile of rocks from which a live oak marked C bears S 19° W 5 rods and another marked D bears S 46° E 14 rods, Thence N 60° E 42 rods to the place of beginning. ~~Sworn~~

Corrected on the ground August 30th 1879

Isaac Gary } C

James M Robertson

Henry Gary } O

Surveyor Bogue Co Texas

The State of Texas } & James M Robertson Surveyor
 County of Bogue } or of Bogue County do hereby
 certify that the above survey was corrected on
 the ground and that there is no conflict
 on the ground by measurement with
 sworn chain carriers

James M Robertson
 Co Surveyor Bogue Co Texas

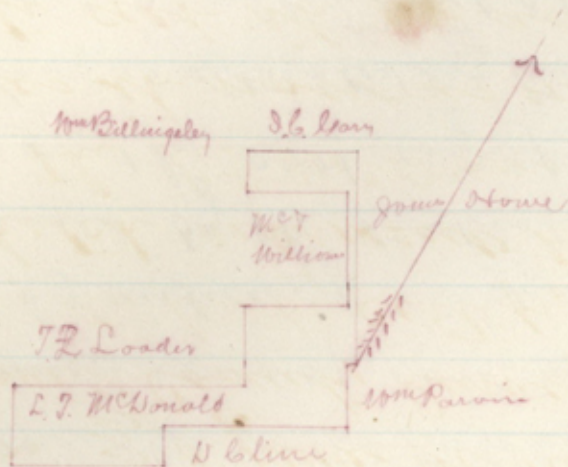

The State of Texas & I James M Robertson
County of Bosque ³ County, Surveyor of
Bosque County, do hereby certify, That
the above sketch represents the true
position of The L.T. McDonald
pre-emption as it now is near as
I was able to get it by actual
measurement on the ground
and that it does not conflict
with surrounding surveys

To certify of which
I hereunto set my
hand at office in
Meridian Sept 27th 1879
James M Robertson
County Surveyor
Bosque Co Tex.

File 1554

Milam Preemption

L. T. McDaniel

160 acres

Corrected field notes

filed Sept. 30/79

Rhoads Fisher,
Chief Clerk

Correct on map of Bosque
County. Octob. 9/79
C. W. Proffers.

Patented Oct 10/879

Davis

L. T. McDonald
Correction

Bosque Co