

Beque Co.
1053 79.

File

MILAM PRE-EMPTION.

Isaac C. Gary

100 Acres.

Act August 12 1870.

Correction map of Beque Co.
Febr. 19/79. Schutte

Mkd Pat

Correct for patenting
Febry 20/79 Marsh

Patented Febry 20/79

394268 S.D. Davis

Mgl. 4351
Mkd Pat Reg.

o July 15
1874 79

CONTENTS.

- No. 1. Affidavit.
- No. 2. Field Notes.
- " 3. Cert. of occupancy
- " 4. Old wrapper
- " 5. Corrected field notes

Febry 12 79
Ed Beck

pat found Febry 20/79
S. 5th dep d Dec 1378
by Isaac C. Gary.
Meridian

The State of Texas } Before me Jno.
County of Bosque } James Clerk of
the District Court
of Bosque County Texas. personally
appeared on this day Isaac C.
Gary to me well known. who after,
being by me duly sworn upon
his oath deposes and says that he
is now bona fide settler upon
One Hundred and Sixty (160) acres
of land. that he believes to be out
of the public domain of the
State of Texas. and further that
he is improving said land for a
Home-Steak and that he has
no other. and that he is a man
of a family.

Said land is situated
in Bosque County. 7 miles
N W from Meridian on the
waters of the Bosque river. and
more particularly described by
the accompanying field notes.

Given under my hand & seal
of the District Court of Bosque Co.
at Office in Meridian
This March 7th 1873

Jno James
Clerk D. C. B. Co.

File 1053

Milam Preemption Isaac C. Gory.
Affidavit & Designation Certificate to
Isaac C. Gory Pre-empt.
Filed May 31st / 73

The State of Texas Field notes of a Survey
County of Bosque of 160 acres of land
made for Isaac G. Gony, it being
the quantity of land that he is ent-
itled by virtue of his act as an acti-
al settler made before ~~John~~ James
Chick of the District Court of
Bosque County on the 7th day of March
1873

Situated on the water
of the Bosque about 9 miles N^W from
Meridian Beginning at the N^W
Corner of ^{James Howe} ~~James~~ ~~Howe~~ Survey a pile
of Rocks

Thence N 60 E 350 Var to the S^W
Corner of ^{James Howe} ~~Joseph~~ ~~Clyde~~ Survey
a pile of Rocks

Thence N 30 W 686 Var a pile
of Rocks for which a live ack mark
I beset N 27 W 59 Var on the live ack
mark C bes N 30 W 611 Var

Thence S 60 W 898 Var a pile of
Rocks in the East line of McKin-
ney & Williams Survey

Thence S 30 E 431 Var to McKinnis
SP corner a pile of Rocks and live
ack mark C bes N 25 W 94 Var
Thence S 60 W 276 Var to the N^W Cor-
ner of W^m Bellings Survey from which

a white oak (marked) I lay
S 58 E 40 Var end on Elm Street
has S 8 E 20 Var. Th. 3.30 E. 500 or
Thence N 60 E 84 0 Var. Cross
Thence N 30 E 24 5 W to
the place of being

Signed May 2^d 1873

Edw R Spear

of Flaar
Mr Bellamy
Cherishers

Deputy Super
Basque Co

My -

J. S. H. Southfield County
Surveyor of Basque County do
herby her by that I have care
examined the above field notes
and find them correct and that
on any record in my office
in Book A page 99

Witness My hand 28th 1873

J. S. H. Southfield

County Surveyor

File 1033

William Freeman

Field notes of 160 ac

Spac C. Gory

Filed May 31st 73

Contains 84 1/5 acres
June 24th 73
J. S. H. Southfield

Proof of Settlement under Homestead Act.

The State of Texas, }
County of Parmer

Before Me, the undersigned County Clerk in and for the County aforesaid, this day came and personally appeared Isaac C. Garry a resident citizen of said County, who being by me duly sworn, declares that he is a bona fide settler upon 160 acres of vacant public land, situated in said County, and surveyed for Isaac C. Garry on the 7 day of March 1873, by E. A. Spencer, a Surveyor of said County: that he has occupied and improved the same as a Homestead for a period of three consecutive years, beginning on the 11 day of November 1872, that he is Married man and that he makes this affidavit for the purpose of obtaining a title to the same for a Homestead, under an Act supplementary to "An Act for the Benefit of Actual Occupants of the Public Lands," approved May 26th, 1873, and Acts prior thereto; and that he has not a Homestead other than the above.

AND, also, at the same time came and personally appeared P. Aoulie and A. H. Childress, two credible resident citizens of said County, to me well known, who being duly sworn, depose and say that Isaac C. Garry the person first above named in this affidavit, has actually settled upon and cultivated as a Homestead, the land surveyed for him on the 7 day of March 1873, by the Surveyor aforesaid, for the period of three years, and they, nor either of them, have any interest in the said land.



Isaac C Garry
P. Aoulie
A. H. Childress

Sworn to at _____ before me, and I hereby certify that P. Aoulie and A. H. Childress are credible and trustworthy citizens of said County.

IN TESTIMONY WHEREOF, I have hereunto set my hand and affixed the seal of said County, at office, this 11 day of February 1873.

H. M. Callie
Clerk of les Court Par Co.

By J. A. Hollister

3

File 1053.

Milam Preemption.

Isaac C. Garry.

Certificate of occupancy.

Filed December 13 78
W. Marsh.
Commissioner.

1053.

PROOF OF
SETTLEMENT OF LAND

Isaac C. Garry,
Settler.

4

2 Mosque Co 75

File 1053.

William Preemption

Isaac C Gary

160a

Dec 12/78

eds correction. The
the call is admitted
led the extreme
earth line and the
line are to show
that. 20/78. E. Gary

11 3

Don't think
of left & right
R. D. D. notes.

Nov 26/78
No 3. Cert. of occupancy
Dec 16/78
Ed Beck

\$500 depd Dec 13/78
by Isaac C. Gary
Meridian

The State of Texas } Corrected field notes
County of Bexar } of a survey of ^{160 acres} land
made for Isaac G. Garcia by C. R. Spencer
a Deputy Surveyor of Bexar County, on the
17th day of April A.D. 1873 and corrected
on the 8th day of February A.D. 1879 by
James M. Robertson County Surveyor of
Bexar County, Texas. Said land is situated
in the waters of the Bexar River about
6 miles ^{N. 60} west of Verdiana and more
fully described as follows to wit:

Beginning at the NW corner of
a survey made for James Howe at
a pile of rocks in the prairie; Thence
N 60° E 350 varas to the SW corner of
Joseph Eyles a pile of rocks in prairie
Thence N 30° W 686 varas to a pile
of rocks in west line of Joseph Eyles from
which a bunch of Live oaks bears N 31°
W 100 varas; Thence S 60° W 914 varas
to a corner a pile of rocks in East line of
a survey made for McKinney William
Thence S 30° E 481 varas to the S.E. corner
of said McKinney William a pile of
rocks from which a Live oak marked
C bears S 45° W 94 varas; Thence
S 60° W 276 varas to the N.E. corner of
William Billingsley survey; Thence

5/ File 1053

Milam Preemption
Isaac C. Gary

160 acres
Corrected field notes

Filed February 12 79
Charles Fisher,
Chief Clerk

Correction map of Bosque
Feb. 19/79
1853

Patented Feb. 20 79
J. D. Davis

July 15
1879

I James M. Robinson do hereby certify
that I have examined the foregoing
field and field notes and find
them correct.

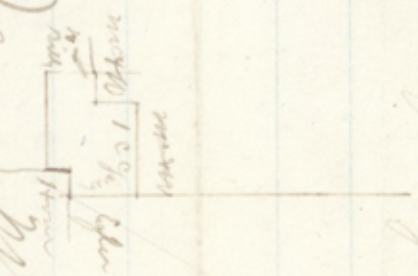

James M. Robinson
County Surveyor

As 305 500 was to a pile of rocks
in prairie. Thence N 60° E 840
was to a pile of rocks in neck line
of James Adams in prairie thence
S 73° 05' W 245 was to E. beginning
of J. F. Larkin }
then Billingsley }
I James M. Robinson County Surveyor
do hereby certify that the
above survey was correctly measured
to land and that the on-site natural
and artificial are truly described
in the foregoing field notes.