

Booque 186/18

M. J. Johnson 52

File 1078

Milam 1st Class

abet 54

William B. Bridges by Act

7,016,700 Square Varas.  
Cont. 1128/1227

Correct on map. Nov. 17/52  
Booked p. 10. Cruz. 1852  
S. J.

See files 1-407. Priority given for original cart.

Patent to Culet No.  
Hubby apu

Elgin  
No 479 Vol 10

Patented Dec 10/52

Kimbell

Hubby  
1852

M. J. Johnson

mgc 10426

Content,  
1 Certificate  
2 Field notes  
3 Transcripts  
Oct 21/58  
Linn

No 1128.  
1227.

GENERAL LAND OFFICE,

<sup>Clinton,</sup> May 13<sup>th</sup> 1849

This is to certify that Wm. B. Bridges is entitled to have surveyed,  
by any legally authorized Surveyor, upon any of the vacant and unappropriated public domain of the  
State of Texas, Seven Million Six Hundred and Sixty  
thousand Seven Hundred and Ninety (7,616,790)  
Square Varas of land, it being the unlocated balance  
of Headright Certificate No. 251 issued by the Board  
of Land Commissioners of Washington County  
to the said Wm. B. Bridges for One  
League and One labor of land, dated the Twenty  
seventh day of January 1838.

In testimony whereof I hereunto set my hand and affix  
the seal of said Office the day and date first above  
written.

Geo. W. Smyth  
Commissioner.

Hubby 504

1 / File 1048

Milam 1st Class

Cert. Und. Bal. - 7,616,790 vrs.

William B. Bridges

OFFICE OF THE CLERK

See 5th

5164079 616790 / 1043  
 17771049  
 1093125  
 2773150  
 2258300  
 2170800

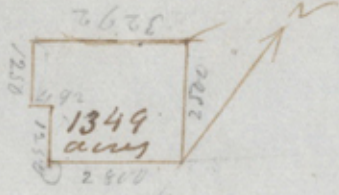

State of Texas  
District of Milam

Survey for Wm Bridges of  $\frac{7675 \times 2476}{1000000}$   
 Acres of land situated on Redon creek  
 about  $\frac{1}{2}$  miles from the junction of Redon  
 and the Brazos, about 3 miles from Fort Graham  
 being the quantity of land to which he is  
 entitled by virtue of certificate No  
 issued in the genl land office

Beginning at the N.W. corner of a survey  
 in the name of Joseph Taylor for the  
 N.W. corner of this survey running from  
 thence N. 60 E. 2800 varas to the S.E. corner  
 of this survey from which a live oak marked  
 A bears S. 60 E. 130 varas and another marked B  
 bears N 20 E 40 varas thence N 30 W. 2500  
 varas to the N.E. corner of this survey  
 on the bank of Redon from which a boxelder  
 marked D bears N. 60 E. 20 varas and an  
 Elm marked C bears N. 58 E. 24 varas  
 thence S. 60 W. crossing and recrossing Redon  
 3272 varas to a mound for the S.W.  
 corner of this survey thence S 30 E 1250  
 varas a mound for a corner on the north line of  
 a survey in the name of Wm Walsh  
 thence with said Walsh North line N. 60 E.  
 490 varas to the N.E. corner of Walsh  
 from which a live oak marked H bears  
 N. 30 W. 90 varas and another live oak marked K  
 bears N. 28 W. 72 varas thence S 30 E 1250  
 varas to the beginning Surveye 9<sup>th</sup> May 1850  
 Wm McLenney Clerk  
 D. Reed } Surveyor  
 Sur Milam Dist

I solemnly declare the above survey to be  
 made according to law at the time above  
 written  
 Cameron 19 June 1850

File 1078

Milam 1000 lbs

Field notes.  $\frac{286790}{1100000}$  Labors

Apr 13. Bridges by road.

Rec<sup>d</sup> in full payment  
of 400 lbs on the  
within field notes  
from C. M. Hubby  
amounting to 300 in specie  
Dec. 14<sup>th</sup> 1830

Geo. H. Gray.

Patented Dec 15<sup>th</sup> 32

Hubby

This survey exactly closes  
& contains the quantity

Case for -

Apr 7/33 J. W. H.

Examiners Receipt

Wm Bridges

fraction

Hubby

I take up this & I do certify that I have examined  
C. M. Hubby's field notes & find them correct and the  
survey made according to law  
Given at Caldwell this 12<sup>th</sup> day of July 1830.  
James H. Hargett  
Circuit Clerk

The State of Texas }  
County of Matagorda } I know all men by sight.

presently that I Wm B

Bridges of the State and County aforesaid  
for and in consideration of one hundred and  
twenty Dollars to me in hand paid the receipt  
whereof is hereby acknowledged have granted  
Bargained and sold unto Caleb M Hubby  
all my right title and interest in and to a certain  
Land Certificate being the unlocated balance of Head  
Right Certificate No 256 Issued by the board of  
Commissioners of Washington County to the  
Said Wm B Bridges for one League & one Labor  
of Land Dated the Twenty seventh Day of January  
1838. Said Certificate Calls for seven Million six hundred  
and sixteen thousand seven hundred and Ninety 7,616,790  
Square Perches of Land To have and to hold the  
above mentioned Land Certificate and the Land  
on which it is Located forever in fee simple and  
I hereby authorize the Commissioners of the Genl  
Land office to issue the Patent for the same  
to the Said Caleb M Hubby as my assignee

In witness whereof I have hereunto

Set my hand and Seal for Seal

this 5<sup>th</sup> Day of ~~April~~ May A D 1857

Witness  
John Fitzgerald  
John Moore  
Frank W. Robbins

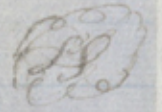
Wm B Bridges of 

State of Texas  
County of Matagorda } Before me the under-  
signed Justice of the Peace in and for  
the County aforesaid, personally appeared  
this 5<sup>th</sup> day of ~~August~~, 1851. Wm. B. Bridges  
who acknowledged that he signed and sealed  
the within transfer for the purposes  
therein expressed. and as his voluntary  
act and deed.

Witness my hand and  
seal (a scroll for a seal)  
Frederick W. Robbins (J.)  
J. P. Precinct, No. 4 M. Co.

The State of Texas ; Before me James H. Selkirk clerk of the County  
County of Matagorda } Court for the County aforesaid personally appeared  
Frederick W. Robbins to me well known who being duly sworn deposed  
and said that he saw William B. Bridges sign and seal the with-  
in deed or transfer to Caleb M. Hubby for the consideration  
and purposes therein mentioned. And Deponent acknowl-  
edged his signature as a subscribing witness to the same.

In testimony whereof I have hereunto set  
my hand and seal of Office at Matagorda  
this 21<sup>st</sup> day of July A. D. 1852.

James H. Selkirk  
Clerk, C. C. M. Co.



Wm B Bridges  
Deed to  
C M Hubby

---

File 1048

Millam 1st Class.  
William B. Bridges  
to & Conveyance  
Caleb M. Hubby

---