

Bozque Co. 75

Patent corrected Ser. to original
9/21/91
Chp. Clerk

File 978

Hilam

PRE-EMPTION.

L. N. Nordshon

Abst. 616.

160 Acres

Act August 12/1870

Correction map of Bozque
April 1880
Corrected sup Cr. to orig
9/15-91 Baylors
Correct for patenting
April 1880 Hatch
Patented April 10th 1880
mkt ptd McKinn

72435 - 0010

Patent corrected survey to orig
Re-Patented Oct 5/91 Dawson
7/18/91 26224 Mkt Pat Req
77730 Pt don Req
Mgl. Abst. 1870

Corrected field notes copy
1-1905 ptd
April 1/190
Chp. Clerk

CONTENTS.

- No. 1. Affidavit. designation
- No. 2. Field Notes.
- No. 3. Certificate of occupancy
- No. 4. old wrappers.

Apr 27 80
Book

5. Affidavit
12/20/88.
Dawson

6. Cor. of maps
4/9/90. Dawson
7 Cor. of notes
& surveyor's Statute
9/9/91 Dawson

\$5.00 Patent fee deposited
by L. N. Nordshon
Hilam Bozque
County Tex. Nov. 2, 1880.
This fee being for new patent
\$5.00, dep. Mar 9, 80
by L. N. Nordshon
Mercury Hills
Bozque

Patent No. 4354, Pt. 1 by returned & cancelled on the part of the patentee because the fee was not covered. The land actually purchased by Dawson's certificate. W. L. McKinnon's land.

The State of Texas. Before me Jno James
County of Bosque Clerk of the District
Court of Bosque

County Texas. this day personally app-
eared L. H. Stordenhauj to me
known who after being by me duly
sworn upon his oath deposes and
says that he is now a bona fide
settler upon One hundred & sixty
acres of land that he believes to be
of the public domain of the State
of Texas. that he is improving
said Land for a Homestead and
has no other ^{and} further that he
is a married man of a family.
said Land is situated in Bosque
County Texas. two miles S. W.
from the town of Meridian on the
waters of Meridian Creek ^{and}
more particularly described
by the accompanying field
notes.

Given under my hand ^{and}
seal of the District Court of
Bosque Co. at office in
Meridian

This May 28th 1873

Jno James
Clerk of District Court.

1.

No. 978

Milwaukee Group

L. H. Nordenhauß Jr

Capped

Designations

Filed April 3/73

L. H. Nordenhauß

Certificate of
Pre-emption

The State of Texas, Fells Water
County of Bexar 160 acres of 100
acres of land Made for J H New
arrows it being the quantity of land
that he is entitled to by virtue
of his Certificate of actual settle-
ment dated Meridian March 28th 1833

Situate in Bexar County on
the South Side of ~~Meridian~~ ^{Meridian} ~~County~~ ^{County}
and about ~~10~~ ² miles South from the
Town of Meridian.

Begin at the South Corner
of ~~Armond Thibault's~~ ^{Armond Thibault's} 160 acre Survey for
the S W corner of this a State
and thence N 60 E 68.0 Var to
the S E corner in the W line of Salva
~~of Knudson's~~ ^{Knudson's}
Kantler Survey a State and thence
thence N 30 W 69.0 Var to ~~Knudson's~~ ^{Knudson's}
N W Cor a mound thence N 60 E 90.0 Var
to a corner in the E line of ~~Knudson's~~ ^{Knudson's}
Says Survey thence N 30 W 443 Var to
N E Cor a State thence S 60 W 98.0
Var to the N W Cor a State and thence
thence S 30 E 1133 Var to the Beginning
Survey March 26th 1833

Carl Gustaf
P Hussey
Chancery

J. H. Bentfield
County Surveyor Bexar Co

The State of Texas
Bosque County } J. H. Scutchfield
County Surveyor of Bosque County
do hereby certify that I have carefully
examined the aforesaid bill note and
find them correct and that they
are duly recorded in my office
in Book A Page 86

Given under my hand at
Meridian this 28th day of March
1873

J. H. Scutchfield
County Surveyor
Bosque County

Dr
Feb 9 1878
Melrose Texas

Fullerton 1600

D. H. Moreland

Filed April 3/73

Correct on map of
April 9/88

Robert G. Eckhardt

Subscribed April 10th 1880
C. C.

C. C. April 24/73. J. Bickler

Proof of Settlement under Homestead Act.

The State of Texas,
County of Bosque.

Before me, the undersigned J. M. Collier Clerk in and for the County aforesaid, this day came and personally appeared S. H. Nordeshaug, a resident citizen of said County, who being by me duly sworn, declares that he is a *bona fide* settler upon 160 acres of vacant public land, situated in said County, and surveyed for S. H. Nordeshaug, on the 28th day of March 1873 by S. H. Denschfield ^{Deputy} a Surveyor of said County; that he has occupied and improved the same as a Homestead, for a period of three consecutive years, beginning on the 28th day of March 1873 that he is Married man and that he makes affidavit for the purpose of obtaining a title to the same for a Homestead, under an Act supplementary to "An Act for the Benefit of Actual Occupants of the Public Lands," approved May 26th, 1873, and Acts prior thereto; and that he has not a Homestead other than the above.

AND also at the same time came and personally appeared C. O. Strand and Gilbert Olberg, two credible resident citizens of said County, to me well known, who being duly sworn, depose and say that S. H. Nordeshaug, the person first above named in this Affidavit; has actually settled upon and cultivated as a Homestead, the land surveyed for him on the 23rd day of March 1880 by the Surveyor aforesaid, for the period of three years, and they nor either of them have any interest in the said land.

S. H. Nordeshaug
Gilbert Olberg
C. O. Strand

SWORN TO and subscribed before me, and I hereby certify that C. O. Strand and Gilbert Olberg, are credible and trustworthy citizens of said County.

IN TESTIMONY WHEREOF, I have hereunto set my hand and affixed the Seal of said County, at office, this 31st day of March 1880
J. M. Collier
Clerk County Court Bosque Co.

R. A. Collier Deputy

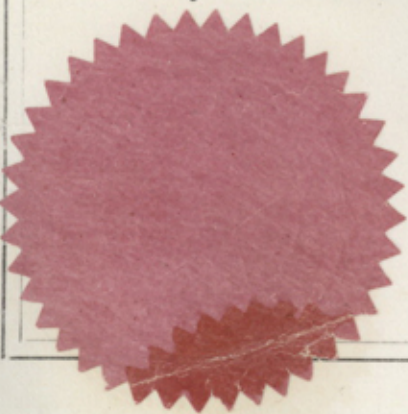

3 Title 978
Milam Preemption
L. H. Norderberg

Certificate of occupancy
Filed April 2, 1880
Roads & Highways
Chy Clerk

978

JENNINGS BROS. PRINTERS AND BLANK BOOK MAKERS, MARSH, L. TEXAS.

PROOF OF
SETTLEMENT OF LAND

L. H. Norderberg,
Settler.

I, W. C. Coker, Clerk of the County of Milam, Texas, do hereby certify that the within and foregoing is a true and correct copy of the original as the same appears in the records of said County.

Witness my hand and the seal of said County, at the City of Houston, Texas, this 2nd day of April, 1880.

W. C. Coker
Clerk of the County

1880

L. H. Norderberg
Settler

TESTIMONY ATTESTED: I have personally examined the within and foregoing and find it to be a true and correct copy of the original as the same appears in the records of said County.

W. C. Coker
Clerk of the County

L. H. Norderberg
Settler

Amson 4

1 Bosque Co 75

File 948

Milam Press

L. H. Nordenberg

160 a

Sat Aug. 12, 1870.

According to Thos F. Johnston's
corrected field notes, a line run-
ning E. from A. Ahlberg's S.E. corner
strikes the West line of S. Knudson
22,000 North from his S.W. corner
two for the distance to Knudson
S.W. corner should be 27800 in-
stead of 69000 - Correction re-
quired. March 18/80 G.W. Ryker.

Contents
1. Aft & designa
2. field notes

Nov 26/78 Bank

\$5.00 deposited March 9,

L. H. Nordenberg
Norway Mills P.O.
Bosque Co

Information furnished
Surrendered by 25/8
Gillilan

3809

3. April 24/73. J. Bickler

The State of Texas, } Before the under-
1 county of Bosque. } signed authority
2 on this day personally appeared
3 Mrs. Inger Norderhang the surviving
4 widow of L. H. Norderhang deceased
5 resident of Bosque County Texas
6 who first being duly sworn de-
7 poses and says: that she is the
8 surviving widow of L. H. Nar-
9 derhang deceased; that she is
10 now the head of the family consist-
11 ing of several children, and as
12 such the owner of 160 acres of
13 land in Bosque County Texas,
14 being the pre-emption survey
15 of said L. H. Norderhang dec'd;
16 that she is living on and occu-
17 pying said land and has done
18 so continuously since and
19 before the death of her said
20 husband; that said land has
21 never been sold or transferred
22 to any one, and that the field
23 notes in the patent to said
24 land does not correspond
25 with the work of the surveyor
26 on the ground, nor cover the
27 land actually surveyed
28 by the surveyor under which
29 said patent was issued.

attest

Mrs. Inger ^{her} X Norderhang.
mark

J. John Johnson
Jas M. Robertson

Sworn to and subscribed by
her work, before me this
18th day of December A.D. 1888.



James M. Robertson
Notary Public for
Boone Co. Iowa.

5 Dec 1978.
William F. Wright
L. H. Wardenburg
Affiant
Fris Dec 19/88.

Perfect.

J. B. Weeks, Surveyor,

BOSQUE COUNTY.

Meridian, Texas, 18.....

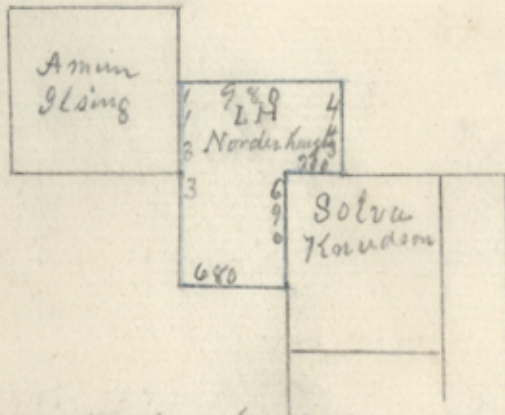

Corrected field notes to fit the ground on which a patent was issued to LH Nordshugh. The patent is an error and its field notes would fail as shown by sketch. to cor in WB line of S Knudson. but pass on N60E. 300 ms from his SW cor. This would cut off a part of the most valuable land be longing to said homestead. Begin at A Glasing's SE cor. Then S30E 690 ms to pile of stone for cor. Then N60E passing through narrow gap in Mountain 680 ms to cor in WB line of S Knudson. Then N30W 690 ms to said Knudson NW cor. Then N60E. 300 ms to cor in NB. line of said Knudson's son

J. N. Weeks, Surveyor,

BOSQUE COUNTY.

Meridian, Texas, _____ 18__

Thence N 30 W 443 ms to pile of stone for N E cor
of this, Thence S 60 W 980 ms to cor in E B.
line of said String's Preemption.

Thence S 30 E 443 ms to place of beginning
the same being the land surveyed
by L H Scratcher field for said
Worren haugh but field note &
and record wrong

Surveyed 26th March 1873

Resurveyed 1890

The State of Texas }
County of Bosque } I James N Weeks do
Surveyor of Bosque Co
Texas do hereby certify that the foregoing
plot and field notes show the true location
of the ground described and it was legally
corrected on the ground fixing old corners
as described in above field notes

Book No. 6. p. 94.

James N Weeks
Co. Sur
1867

Price 975.
Mile and Preempt
L. H. Woodward
City of Boston
July 27 1890.
R. W. Kelley
Prof. A. C.

[Faint, illegible handwritten notes, possibly bleed-through from the reverse side of the page.]

No quantity given -
Would be passed as
correct for 160 acres
but that the 6d notes
& certificates written
in pencil - Books
must be sent with
written in ink -
at 10/20 J. W.

J. D. Kelley, Treasurer
BOSTON COUNTY
Woodman's Corner

RECEIVED

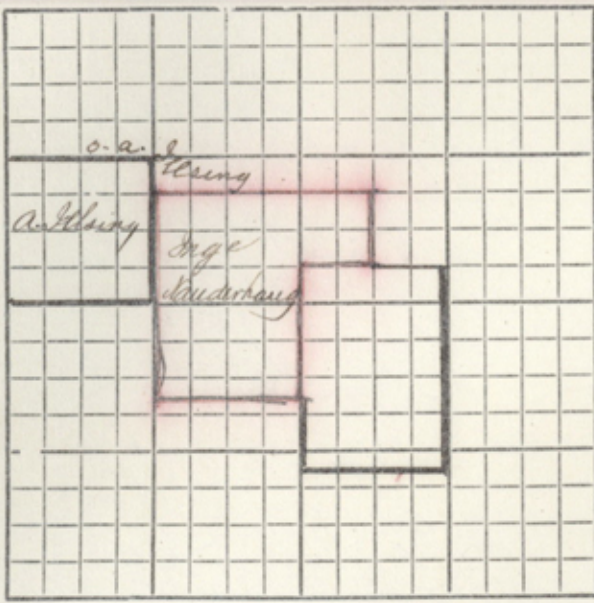

The State of Texas, } SURVEY
 County. } No.

FIELD NOTES of a Survey of *One Hundred and 66 acres of* Lands, made for *Inge Nauderhaug* (originally *L.H. Nauderhaug dec'd*) out of the public domain under the Homestead Laws of Tex. by virtue of Certificate of occupancy before Dist Clk dated *March 28th 1893*

Scale _____ Varas per inch.

Said Survey is No. _____, in *Bosque* County, Texas, situated on the waters of *Meridian Creek* a tributary of *Brazos* River, about *12* miles *N.W.* of *Meridian* Beginning *at 440 varas S30°E from the S.E. Cor. of the Ammann Illing Preemption Survey - a pile of rock on E. side of branch running North. Thence N60°E 680 varas to Cor. in west line of the Solvey Knudson Preemption Survey. Thence with said Knudson West line N30°W - 690 varas to Knudsons N.W. Cor. in open prairie. Thence N60°E - 300 varas to corner at a branch in North line of said Knudson & S.W. Cor. of S. Knudson. Thence N30°W with said line of S. Knudson 443 varas to Cor. from which a large Live O. mk'd \bar{x} to N57°E - 39 varas Thence S61°W with said Knudsons S. line & O.A. Illing S. line 980 varas to Cor. in E. line of A. Illing Preemption. Thence N30°W S30°E - 1424 varas to pt.*

to the place of beginning.

Bearings marked

Re Surveyed *Aug. 17th* 1891

P.G. & O.A. Illing } Chain Carriers.

I, *A.M. Dillard* Co. Surveyor of *Bosque* County, Texas, do hereby certify that the foregoing described Survey was actually made by me on the ground, according to law, on the date and with the Chain Carriers aforesaid, duly qualified, and that all the corners, lines, boundaries and marks of the same, whether natural or artificial, are truly and correctly described and set forth in the foregoing Plat and Field Notes.

By _____ Deputy *A.M. Dillard* Co. Surveyor *Bosque* County, Texas.

Filed for Record the *19* day of *Aug.* 1891 } *A.M. Dillard* Surveyor.
 at _____ o'clock _____ M.

and recorded in No. *6-p 374*

7 File 978

Milam Premption
L. H. Nordberg

Cor. Notes

Filed Sept 9th 1891

According to Surveyor's within
statement correct on map of
Basque Co.
9/10/91 L. H. Nordberg

Particulars of
Quar.

Meridiane. Dec. 9/10/91

Large chunky
9/25/91
L. H. Nordberg

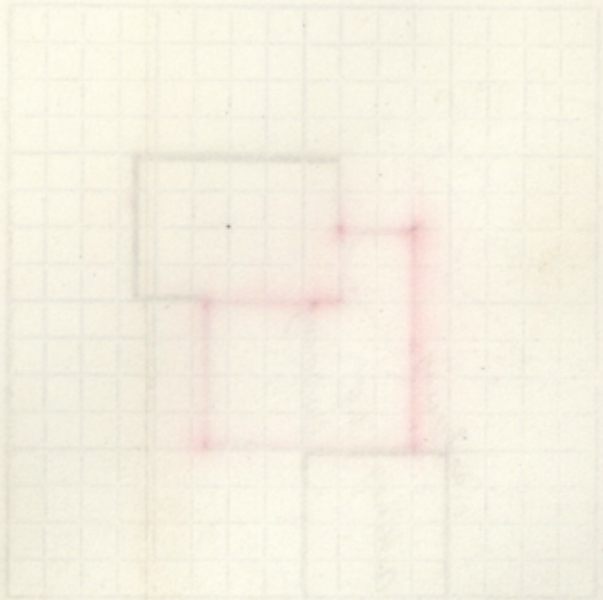

[Faint, illegible handwriting, likely bleed-through from the reverse side of the page.]

THE STATE OF TEXAS.

W.B. THOMPSON, Co. Judge.
H.C. COOKE, Co. Clerk.
F.P. SMITH, Dist. Clerk.
JOHN DYER, Tax Collector.
WYATT MCFADDEN, Tax Assessor.
W.S. POWELL, Co. Treasurer.
ROBT DONNELL, Sheriff.
H.S. DILLARD, Co. Attorney.

CO. COMMISSIONERS:
R.B. HARRIS,
C.V. OGDEN,
W.G. FEAGIN,
L.H. SCRUTCHFIELD.



Bosque Co.

Meridian, Tex.

189

Report of the Surveyor resurveying the L. H. nor Ange
Kanderhaug Preemption Survey of Bosque Co.

The original field notes of this survey began at the S.E. Cor.
of the A. Dilling Preemption which according to the testimony
of L. Huse & O. A. Dilling the two original chain carriers was a
mistake in the call. 440^{00} $S 30^{\circ} E$ of this corner I found an
old rock pile several years ago when surveying the Tho^s A
Johnson for the Plum Brothers of Galveston for Corneida field
notes & reported and sketched said Johnson to conform to
this line rather than the call. on this survey I found
said pile of rocks or rather L. Huse above alluded to carried
me to this as the beginning corner of the L. H. Kanderhaug
From this I ran $N 60^{\circ} E - 680^{00}$ distance called for & 682^{00} found
old rock pile. Thence $N 30^{\circ} W - 690^{00}$ & found rock pile & Hud-
son's field fenced to same point. Thence $N 60^{\circ} E$ &c. to be-
ginning finding all the corners as called for & in conflict
with nothing else on the contiguous surveys.

Meridian Tex.

Aug. 19th 1891

H. M. Dillard

Co. Surv. Bosque Co.

File 978

William Prumptions

L. A. Korderning

Surveyor's Statement

Dated Sept 9th 1891

