

Bosque 186-39

75

W. G. ... 157

File 728

Milam County

Ab-881

Joseph S. Wilson died

1345 acres no. 845

See July 13. 738  
Correct on map. Sept. 27/51  
B. m. h. d. p. t. d. (Cruz) Baker

Coronet for Patenting to  
The heirs of Joseph S.  
Wilson d. c. s.

*(Signature)*

no. 702 vol 5

Patented Oct. 1857

no. 702 vol 5

*(Signature)*

Patent sold to J. D. Gordon  
9th Oct. 1857.

Mgl. 5534  
m. h. d. p. t. a. m. h. v.

Contents. <sup>186-39</sup> <sup>157</sup>

1. Certificate.
2. Field Notes

Nov. 14. 1878.

*(Signature)*

5 24 187





845

STATE OF TEXAS.

1920 Acres.

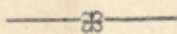

KNOW ALL MEN TO WHOM THESE PRESENTS SHALL COME,

THAT Joseph S. Wilson <sup>Kearney Co</sup> having served faithfully

and honorably in the Army of the Republic of Texas, for the term of \_\_\_\_\_

Months, from the \_\_\_\_\_ day of \_\_\_\_\_, until the

\_\_\_\_\_ day of \_\_\_\_\_

and having fallen with Fannin at Goliad

is entitled to Nineteen hundred twenty Acres BOUNTY LAND,

for which this is his CERTIFICATE.

AND the said Joseph S. Wilson is entitled

to hold said Land; or to sell, alienate, convey and donate the same; and to exercise all rights of ownership over it.

IN TESTIMONY WHEREOF, I have hereunto set my hand, at Austin  
this thirteenth day of June

1857

Approved Sept 30. 1857

Ben J. Hill  
Adj Gen

Ben J. Hill

Adjutant General



July 28

Milam County

140

Warrant  
Joseph S. Wilson  
1920 acres

101  
39

Recd. to W. J. 3039

Handwritten signature

1345 acres per

No transfer

July 11 1858

1920
600
1476
<u>3140</u>
1345
<u>575</u>

1345
575
<u>1920</u>



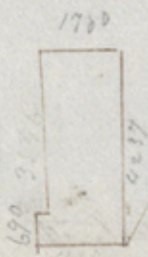

State of Texas  
District of Milam

Survey for Joseph L. Wilson of 1345  
acres of land situated <sup>in N. Glenn County</sup> on the north side  
of Christian Creek above the mouth  
of Spring Creek <sup>about 38 miles above Waco</sup> being part of the quantity  
of land to which he is entitled by virtue  
of land warrant No. 845 dated 15 June  
Regiment at the N.E. corner of a <sup>1854</sup> survey  
in the name of A. G. Simonds for the N.W.  
corner of this survey from which a mulberry tree  
bears N. 38 E. 84 varas and an Elm marked X  
bears N 42 E 90 varas thence S. 30 E. 35 1/2  
varas to the S.E. corner of A. G. Simonds survey  
thence S. 60 W. 100 varas to the N.E. corner  
of <sup>Footmarks</sup> ~~Footmarks~~ thence S 30 E 690  
varas to the N.W. corner of a smaller survey  
in the name of J. Footman thence N. 60 E.  
1880 varas to the S.E. corner of this  
survey from which a live oak marked X  
bears S. 30 E. 140 varas thence N. 30 W.  
4237 varas to the N.E. corner from which  
a live oak marked I bears S. 16 W. 24 varas  
and another marked V bears S. 39 E. 4 varas  
thence S. 60 W. 1726 varas a branch 1780  
varas to the beginning Surveyed 27 July 1854  
J. Riggs J. B. Erath & Co. Surveyors  
M. Gum J. B. Erath  
St. Milam

I solemnly swear the above survey  
to be made according to law at the time  
above stated Waco 8 August 1854  
J. B. Erath & Co. Surveyors  
St. Milam



I William Armstrong district Surveyor for Milam district  
do hereby certify that I have Examined the foregoing Plat and  
field notes and find them correct and the survey was made  
according to Law. Given under my hand August 29<sup>th</sup> 1851  
Wm. Armstrong  
District Surveyor for Milam District

Joseph  
Wilson

134.5 acres

Landowner

File 726  
Milam County  
Field notes 1345 acres  
Joseph S. Wilson

Placed ~~at~~ 1/5  
J. Ambler