

Houston  
H. Dist 760/58  
H. Dist 3742/4 custom

Houston 3. Clap  
H. Abst 257-1

CA Abst 188-1  
Eli Chaffin

Cisco  
cert 308

Correct on map. No. 6  
Frank. J. D. Deurbain.

A 1 of Patenting to  
to the Hon. of Eli Chaffin  
debt

No 535 vol 3  
Patented Nov 7. 1849.  
Hact.

Patent delord. to Jas. M. Parker  
on the 7th of November 1849.

Mil 4900 m. m. in 12

del. Jas. M. Parker  
7th Nov. 1849

No. outline

1. Certificate

in field notes.

Aug 14/78. Lunt,

Republic of Texas } No 308  
County of Houston } Fourth Class  
The heirs of Eli Chaffin is entitled to  
Six hundred and forty acres of  
Land proof having been made that  
he emigrated to this Republic in the  
year 1840 and was at <sup>the</sup> time a man of  
Family and a married man, and that  
he did in this Republic, and performed  
all the duties required of him as a  
Citizen, and that he resided in the  
Republic from the date of his emigration  
up to his death.

Given under our hand at  
Crockett this 29<sup>th</sup> December  
1845.

Oliver H. Randolph  
Chief Justice of P. B. & C. Courts.

Wm. Greene } County  
William Lane } Commissioners

J. H. Gillespie  
Clerk of the  
Office of the Board  
Land Commrs.

17 Feb 1848

Houston 3<sup>rd</sup> Cl<sup>o</sup> / 3

Wm. McCallister  
Eli Chaffin Secy

40 Acres

29 Decr 1845

5320  
J. W. Barber

5308--

64 Acres

Certificate

J. R. Griffin

I John W. Hidenhamer a Deputy Surveyor for Houston District do hereby solemnly swear that on the 17<sup>th</sup> day of December 1848 I surveyed 64 hundred & forty acres of land in Houston and Anderson Counties. On the within Claim Witness my hand this the 27<sup>th</sup> day of December 1848

*[Signature]* Deputy Surveyor for Houston District

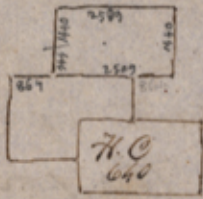

Variation of 206

By a scale of 4000 Varas Per Inch

State of Texas, Houston County

Survey for the heirs of Eli Chaffin Dec'd for 320 hundred and forty acres of land situated in Houston & Anderson

Counties on the Waters of the Elk Hart Creek a Tributary of the Trinity River by Virtue of Certificate CV 308 fourth Class issued by the Board of Land Commissioners of Houston County on the 29<sup>th</sup> day of December 1845 at Crockett Beginning ~~576 Varas West and 578 North of the North West Corner of a 640 acre Survey and~~ 864 Varas East of the North West Corner of a 640 acre Survey in the name of John L. Milford

on a Stake from which a blackjack MK + 16 In Di B. CX 57 E 2 1/2 Varas and the MK + 12 In Di B. CX 12 W 9 1/10 Varas Thence North 444 Varas crossing the Anderson County line at 1460 a Stake from which a Sandjack MK + 5 In Di B. S 69 E 4 to Varas and then 9 In Di MK + B. CX 17 E 16 1/10 Varas Thence East 2509 Varas to a Stake from which a blackjack MK + 14 In Di B. CX 84 E 11 1/10 Varas another MK + 10 In Di B. S 50 W 13 1/10 Varas Thence South 1440 Varas to a Stake from which a Sandjack MK + 6 In Di B. S 49 W 25 1/10 Varas and then MK + 14 In Di B. CX 15 E 17 1/10 Varas Thence West 2509 Varas to the Beginning ~~Survey~~ This the 17<sup>th</sup> December 1848

James S. Cartright J. C. C.

Wm W Bodenhamer

John W Bodenhamer Deputy Surveyor for Houston District

I John W Bodenhamer a Deputy Surveyor for Houston District do hereby solemnly swear under my official Oath that the Survey designated by the foregoing Plot and field notes was made by me on the 17<sup>th</sup> day of December 1848 and that the lines boundaries and Corners of the same together with the marks Natural and artificial are truly described therein Witness my hand This the 27<sup>th</sup> day of December 1848

John W Bodenhamer Deputy Surveyor for Houston District

I J. H. Holland District Surveyor for the District of  
Houston hereby Certify that I have examined the forego-  
-ing plot and field notes and find them correct  
and the survey made according to Law.

Witness my hand this 12<sup>th</sup> day of Jan A. D. 1849

J. H. Holland  
District Surveyor of Houston Dis

J. M. P. 116

Amesbury, 3<sup>rd</sup> Class

Field notes 640

E. C. Chaffin

Patented Nov 7. 1849.

Amesbury

See on the East F. 6445

E. C. Chaffin  
Amesbury