

File 36

Brazos 1st class
ad. 72

Thos. Gorman
no paper
— 16. 1/2. 430 p. as —
no 70

Correct on map. May 23/
I recd. ptd. (Cruzbaun.)
149

Correct for printing
Cash

Retained May 28. 1849
Cash

no 959 v. 6

File 8936. mkd ptd. ad

1. H. R. Certf.
 2. Field Notes.
 3. Cancelled Field Notes.
 4. Receipt for Gort dues.
- Aug. 10. 1849.

Cancellation

26,000-000
15,077.430
19,382,170



This is to Certify, that *Thomas Dillard* has appeared before
us, the BOARD OF LAND COMMISSIONERS FOR THE COUNTY OF *Robertson*
and proved according to law, that he arrived in this country in *February 1835*
and that he is a *free white man* and entitled to
One Saquo of *Per Labor* of LAND, upon the
condition of paying at the rate of *30 Cts* for every labor of irigable land,
20 Cts for every labor of temporal or arable land,
10 Cts for every labor of pasture land, which may be contained in the
Survey secured to him by this Certificate.

GIVEN UNDER OUR HANDS, THIS *5th* of *February* 183*5*

Thomas Dillard PRESIDENT.

ASSOCIATE COMMISSIONERS.

ATTEST,

A. McCoy
CLERK.

REPUBLIC OF TEXAS.

TELEGRAPH PRESS—HOUSTON.

I hereby certify, that the field notes of fifteen
and a half labors of land made for Thomas Bowman
in the County of Washington, by virtue of the within
certificate (No. 70.) have been filed in this office

Given under my hand this 10th day of Nov, 1838
Adolphus Hope Co. Surveyor
for Washington County

I hereby certify that the field notes of 16617430 square
varers has been made for Thomas Bowman
in the County of Brazos by virtue of the
within Certificate No 70 given under my
this 19th July 1848

Thomas Sear Co. Surveyor
for Brazos County

Thomas Bowman

1
1848

Brazos Co. Pa. Clerk

Adolphus Hope

Thomas Sear

1 July 1848

CLERK OF THE COURT

Surveyor

Surveyor

Surveyor

BOVER OF FIELD NOTES

FILED

REPUBLIC OF TEXAS

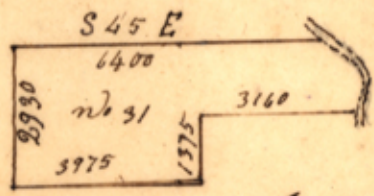

A plot and field notes of a survey of 16617430 square varers made for Thomas Bowman it being a part of the Land to which he is entitled by virtue of his headright Certificate No 70 Issued to him by the board of Land Commissioners for Robertson County on the first of February 1838 for one League and one Labor the said Survey is no 31 ^{in Brant's Co} on the Navasota River in the County of Brazos ^{about 26 1/2 miles above its mouth.}

Beginning at a Stake on the west bank of the Navasota river ^{at the longer corner of E. W. Johnson's survey No 39} ~~which serve for E. W. Johnson's line corner~~ on said River from which a black gum 10 inches in Diameter bares S 7 E 5 varers and a pin oak 15 inches in Diameter bares N 33 W 7 varers thence N 45 W 6400 varers to wicksons ^{W.} ~~other~~ corner, and set a stake thence S 45 W at 2930 varers and set a Stake at the ~~S E~~ ^{S E} corner of ~~Survey~~ ^{J. W. Stewart's league survey} ~~made for~~ ^{J. D. Allison} from which a hickory 7 inches ~~in~~ in Diameter bares N 68 W 4 1/3 varers and a post oak 10 inches in Diameter 1 bares S 68 E 6 2/3 varers thence S 45 E at 3975 varers and set a Stake on Brunette's ^{N.W.} boundary line from which a post oak 12 inches in Diameter bares S 17 E 6 varers another post oak 18 inches in Diameter bares N 37 1/2 W 20 varers thence N 45 E at 1357 varers set a Stake at Brunette's N corner in the prairie thence S 45 E 3160 varers to the Navasota and set a Stake from which a black gum 2 feet in Diameter bares N 70 W 8 varers an Elm 12 inches in Diameter bares N 48 1/2 E 7 1/2 varers thence up the River with its meanders to the place of

beginning
 Charie } L. J. Green
 mine } Thomas Bowman

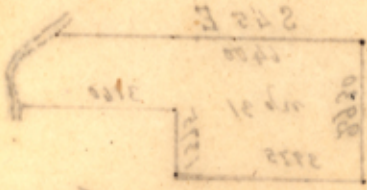

The above survey contains 5 Labors of arable Land and 11 Labors and $10\frac{1}{2}$ acres of pasture Land

I Joshua Seal County Surveyor of Brazos County do hereby solemnly swear under my official oath that the survey designated by the foregoing plot and field notes was made by me on the 3 Day of July 1848 and that the Lines ~~and~~ boundaries and corners of the same together with the works Natural and artificial are truly described therein witness my hand this 19 Day of July A. D. 1848

Joshua Seal

County Surveyor of Brazos Count

I Joshua Seal County Surveyor of Brazos County do hereby certify that I have examined the foregoing plot and field notes and find them correct and the survey made according to Law and that the said field notes are recorded in Book A page 71

Joshua Seal C. S. B. C.

The above survey was made by Moses Cummins D. S. W. C. in 1838 and has been returned to me.

to be Resurveyed and is surveyed according to the foregoing plot

Joshua Seal C. S. B. C.

Received, Genl Land Office Austin January 17th 1852, of Geo.
W. Smyth Commissioner of the General Land Office Ten dol
lars in Texas Promissory notes being part of the amount
overpaid on the million field, for government dues, which amount
I now apply to the payment of the patent fee on the within
claim.

J. A. Bowman Esq
By H. Mitchell
Agent,

A drawing of 294 1/2 acs
made for
Thomas Bowman

Recorded in Book
A Page 271

John and Kate Esq.

2 Filed 30

Wray Co. 1st class

Filed Notes W. H. 430.

Thos. Bowman

Correct and map. of May 25
1852

Patented May 25th 1852
Hamm

Surveyed for Thomas Bowman. Fifteen
and a half Labors of Land in the
County of Washington on the West
Side of the Navesota. being part of
the Land to which he is entitled
by virtue of a Certificate No. 70.

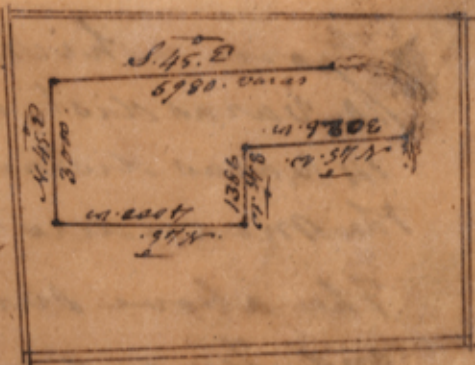

Issued by the board of Land Commissioners for the Territory
of Robertson. which Certificate calls for one League
and one Labor of Land. Beginning at the East corner
of a tract of Land of 270 acres Surveyed for Jefferson
Page on the West bank of the Navesota a Stake
from which a pin oak marked X. bears N. 2. E. 5.
varas distant and a black Gum marked P. bears
N. 55. W. 10. varas distant. Thence N. 45. W. at 340. varas
intersected the East corner of a third of a League
of Land Surveyed for Edwin Burnett. Same course
continued with his N. E. boundary line in all 3026
vs. to his North corner. Thence S. 45. W. 1386. varas to the
East corner of a League of Land Surveyed for George
Thence N. 45. W. with Gilpins N. E. boundary line
4000. varas to the South corner of a League of Land
in the name of J. D. Allcorn Administrator of
the Estate of J. W. Stewart. Thence N. 45. E. with the
S. E. boundary line of said League 3000. varas to a
Stake from which a Black Jack marked X bears
S. 64. W. 2. varas distant and a Black Jack marked
B. bears N. 40. E. 13. varas distant. Thence S. 45. E. 5980. vs.
to the Navesota. where set a Stake for the upper corner

From which a pin oak marked W. bears N. 20° 2'
10. Varas distant and an Elm marked I. bears N. 5° 1'
14. Varas distant. Thence down the Navesota with
the meanders to the place of beginning.

The above survey contains Five Labors of Arable land
and Ten and a half Labors of pasture land

Olthott Milliman } Chain Carriers
Dyron Wickham } M. Cummins
D.S. W. 1838

I Moses Cummins do solemnly declare on my
oath of office that the foregoing survey was made
since the first day of February last

Washington County
October 17th 1838
M. Cummins

I hereby certify that I have exam-
ined the within field notes and find them correct
and the survey made according to Law.

Given under my hand this 14th November 1838

Adolphus Hoar, County Clerk,
for Washington County.

Rec^d on the foregoing field notes the sum
of fifty ²⁰/₁₀₀ dollars.
Washington Aug. 27th 1838. Court H. S. Office

Plot & Field notes
for T. Mowman
1st Class.

15 1/2 Acres

31

Washington Co

539842 N. or S.

or
~~53~~ = 95 ³/₅ Acres.

too much

not including the land
between the points on
the River and the banks
they not being necessary
to be

T. Mowman

T. Mowman

Republic of Texas }
Washington County }

I hereby certify that
I have obtained fifteen and
a half labor of Land by vir-
tue of a certificate N^o 70 issued by the Board
of Land Commissioners, for Robertson county,
for one league and one lot of Land.

Given under my hand this 18th day of November
1838

Thos. Bowman

5

File 136

Brazos Co. Class

Cancelled field notes
returned to show the
payment of the Gov's
Acct.

M. W. Dawson to Republic of Texas 1872

To 5 labor of arable land @ \$5.00	\$25.00
- 10 do " pasture land " " 0.20	2.20
	<hr/>
	\$27.20
	<hr/>
	\$50.20

Rec^d at Genl Land Office, City of Washington Aug. 29th 1863. The amt of the foregoing acct being for 5 labor on survey of fifteen and one half labor of land being part of the headright of Thomas Dawson.

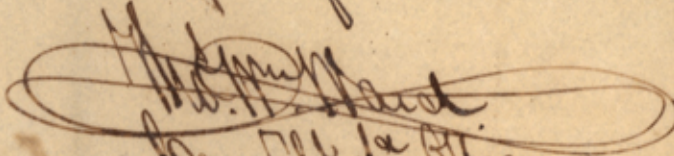
Genl. Land Office

The above bill should have been calculated at the lowest rates which would make a balance in favour of the claimant of Twenty five ¹⁰⁰/₁₀₀ Dollars

Certificate of Unlocated Balance
on this claim to be made to
Basinell. Directed to James J
Dawson

7

31.

Paid for the payms
of Gen. dms.

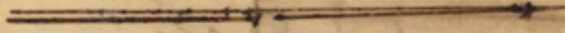

[Faint, illegible handwriting, possibly a name or title]

[Faint, illegible handwriting, possibly a date or reference number]

1720
1721
1722
1723

[Faint, illegible handwriting, possibly a list or account entry]

[Large, stylized signature or name]

[Faint, illegible handwriting, possibly a name or title]

10.017.430