

Brazos 4
58
75

2nd of 17.

Brazos Indef.
Ab. 98

1. Nonal (Cott)
 2. An cond. Def.
 3. Field Notes
 4. Special Report.
- Aug. 10/74

(Cotton)

Thomas Black
Cyrus

Abt 8 1/2

No 52

See file 2-19 Brazos for Balance
Correct ord map. December 13/58
On a league marked C. Gilpin C. W. Prebles
& mtd ptd otherwise

no title or field notes
in file for this land, in name
of C. Gilpin -

Cornet for Patenting
Elgin
Patented Dec 28th 1855.

No 873
Thomas

Miss P...
Majl

No. 44

CLASS 2.

REPUBLIC OF TEXAS,

COUNTY OF SHELBY:

THIS IS TO CERTIFY that

Thomas B. Clarke

has appeared before us, the BOARD OF LAND COMMISSIONERS for the County of Shelby, and proved according to law, that he arrived in this Republic subsequent to the Declaration of Independence, in September 1837 and that he is a Married man and that he is entitled to Twelve hundred & Eighty acres of LAND, to be surveyed after the first day of August, 1838.

GIVEN UNDER OUR HANDS, AT SHELBYVILLE, THIS 4th August, A. D. 1838.

ATTEST

[Signature]
CLERK

Geo English PRESIDENT.
Wm Sandram { ASSOCIATE
George Butler { COMMISSIONERS.

Thos B. Clarke

To Z cert

Entry 34

Navarro City

1280

1850

1280

1850

1850

1850

The State of Texas
Sumner County

No. 13

Chap. 2.

This is to certify that Thomas B. Clark
is entitled to an unconditional headright
for Three Hundred and Eighty acres of
Land, by virtue of certificate No. 144
dated the 14th day of August A.D. 1838. granted
to him by the board of land commissioners
for the County of Shelby. he having sworn
to us, that he has resided in the State
Three years, and performed all the duties
required of him as a citizen.

Given under our hands at the
town of Anderson, on this the Sixth day
of June A.D. 1853.

Geo. H. Patrick Chief Justice

A. B. Dodson Commissioner

J. L. Greenwood

Attest

G. M. Manning

Clk. Co. Comm.

Sumner County

I Joshua Seal County Surveyor
for Brazos County do hereby Certify that
I have surveyed 640 ac of Land on the within
certificate October the 25th 1855

Joshua Seal C. S. B. C.

Citizens

Wagon de la ...

No 553

Mar 13 Black

Regd ...

John ...

Thomas ...

Wm ...

Brazos ...

File #17

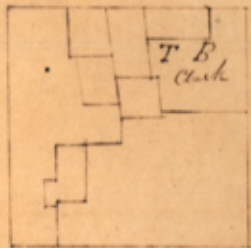

A plat and field Notes of a survey of 640
 acres of Land Surveyed for Thomas B. Clark
 it being a part of the Land to which he is
 entitled by a head Right Certificate No. 53
 Class 2nd Granted By the Board of Commis-
 sioners of Grimes County Dated June the
 6th d. 1853 for 1280 acres of Land *Situated in Brazos County*

about 8 miles N 83 E from Brensville
 Commencing at the N. Corner of a League onst Survey
 for Gilpin and Running S 45 E with said Line at 2150 vars
 Crosses Badmans Creek and at 2290 vars set a Stake
 from which a pinoak 14 in in Diam bears N 67 W 2 vars
 and a pinoak 10 in in Diam bears S 28 E 4 1/4 vars
 then S 45 W at 1653 vars the N. E. Boundary Line of
 a Survey of 160 acres made for J. S. Riley and set a Stake
 from which a pole 14 in in Diam bears N 27 W 32 vars
 and a B Jack 12 in in Diam bears S 9 E 17 vars
 then N 56 W at 730 vars the N. Corner of Rileys Survey a
 Stake from which a B Jack 12 in in Diam bears S 29 W 12
 vars and a B Jack 12 in in Diam bears S 52 1/2 E 2 1/2 vars
 then S 45 W at 150 vars the ^{W. E.} N. E. Corner of the ^{W. E.} Ellis Survey
 then N 56 W with said Line ^{910 vars} to the S. E. Corner of a
 Survey of 160 acres made for White then N 45 E with said
 Line at 1320 vars the S. E. Corner of Whites Survey a Stake
 from which a pole 10 in in Diam bears N 60 E 10 vars and a
 pole 8 in in Diam bears N 77 E 8 1/2 vars then N 45 W at 150
 vars the N. W. Corner of Whites Survey and the old League
 Line a Stake from which a pinoak 9 in in Diam bears
 S 3 E 4 vars and a pinoak 10 in in Diam bears N 59 E 2 1/2 vars
 then N 45 E with the old League ^{Line} at 780 vars the
 Place of Beginning this Sept^r the 28th. A. D. 1855

Chair^y Stephen McLaughlin

Men^y James M. Estus

Joshua Seal C, S, B, C

I Joshua Seal County Surveyor for Brazos County
 do hereby Certify under my oath of office that the Survey
 Designated by the foregoing plat and field Notes
 was made by me on the 28th Day of Sept^r 1855 and that
 the Lines boundaries and Corners of the Same to-

- gether with the marks Natural and artificial are truly Described therein
Witness my hand This 6th Day of ~~Sept~~
A. D. 1855

Joshua Siale C. S. B. C.

I Joshua Siale County Surveyor for Brazos County do hereby certify that I have Examined the foregoing plat and field notes and find them correct and the survey made according to Law and that the said field notes are Recorded in Book B Page 23

Joshua Siale C. S. B. C.

A survey of 540 acres
of land made for
Thomas B. Clark

Recorded in Book B

Page 23

Joshua Siale, C. S. B. C.

3
Filed
Brazos County

Filed by
Thomas B. Clark

Filed by
A. M. P.

Patented Dec 28th 1855
James

The State of Texas }
County of Grimes } 3

On the application of
Thomas B Clark for an unconditional
Certificate for Twelve hundred and
eighty acres of land. Ordered that
an unconditional Certificate for
twelve hundred and eighty acres of
land be issued to the said Thomas B Clark
by virtue of Conditional Certificate
No 44. Class 2. issued by the board of
Land Commissioners of Shelby County
on the 4th day of August A.D. 1838
"issued."

The State of Texas }
County of Grimes } 3

I J. G. Chatham
Clerk of the County Court in and
for the County of Grimes and State
of Texas do Certify that the foregoing
is a true & correct copy & transcript
from the records of said County Court
as made & entered at a called Session
held on the 6th day of June 1853, showing
the decree to issue Thos B Clark an
unconditional Certificate for 1280
acres of land as said copy of Order
shows. Given under my
hand and seal of said
County Court at Office
in Anderson this the 17th
day of December A.D. 1853

J. G. Chatham Clerk
1853

Feb 17th
Bozons 2nd class

Special Report
Thos. B. Clarke
1280 Ave