

2 Brazos Co. Tex.

2. Brazos Co. Tex.

File 283 = 1/53

Brazos

Navigable 2^d Class

ab. 193-194

James Powell

2 Surveys 640 each

no 1280 Acres

no 138

Correction of Map of Brazos

Co. Nov. 23/59 Hill

Bank plat

Surveys are marked patented

Patented - Both surveys

July 5th 1842, and plats delivered to J. A. Head

July 5th 1842

no 105 vol 1

no 106 " "

cert. approved

J. A. Powell

W. P. Hill

Mgt 859

2 cc map 13 of B

H. R. Outy

J. Lincoln

3 + 4 Field Notes

Aug. 10/74

Cecilia

860

No. 57



CLASS 2.

REPUBLIC OF TEXAS,

COUNTY OF

Robertson

This is to Certify, that James Brewitt has appeared before us, the BOARD OF LAND COMMISSIONERS FOR THE COUNTY AFORESAID, and proved according to law, that he arrived in this Republic subsequent to the DECLARATION OF INDEPENDENCE, prior to 12th Oct 1837 and that he is a married man and is entitled to Twelve Hundred Eighty acres — of LAND, to be surveyed after the first day of August 1838.

GIVEN UNDER OUR HANDS, AT Franklin THIS 6th Sept A. D. 1838.

Thomas Dillard

PRESIDENT.

H. Owen

ASSOCIATE COMMISSIONERS.

ATTEST,

A. S. McCoy

CLERK.

TELEGRAPH PRESS — H. V. TOWN

1
File 903
Navisote
Traybo 2^d Class
Cond
Headright Certificate

James Hewitt
1280 Acres

James Hewitt
1280 Acres

No. 52
W. Hewitt
2/15/42



REPUBLIC OF INDIANA
COUNTY OF

as the BOARD OF LAND COMMISSIONERS for the COUNTY aforesaid, and having
according to law the said land in the public sale and the declaration of INDEMNITY

and that the said land is a private
is entitled to be surveyed after the first day of January 1838.
A. D. 1838. THIS

PRESIDENT

ASSOCIATE COMMISSIONERS

CLERK

ATTEST



The Republic of Texas Certificate No. 138
County of Travis, 2nd Class

James Prewett is
entitled to Twelve hundred and Eighty acres
of Land as per certificate now on file in the
General Land Office No fifty two Issued
to him by the Board of Land Commissioners
for Robertson County dated 6th September
1838 he having further more proved to
us that he has complied with all the
conditions of the Land Law in such
cases made and provided

Given under our hands
at Austin Texas 7th
1842

Attest
M. H. Beatty, Clerk County Court & Pres of B. Land
Ex off Clk Board Land County, Laughlin associate

Received
Newman

2 File 243

Stavisco Co 2nd Class

General H. R. Certificate

James Prewitt

1280 acres

Reg. Mg. C. D. 106
C. A. L. 100

James Prewitt
Aug 18/8

San Antonio, Tex.

Patented



Scale of 4000 bars to an Inch

13 miles from Austin

A plot and field notes of a survey of 640 acres of land made for James Pruitt it being the balance of the land to which he is entitled by virtue of his headright certificate No 52 second class for 1280 acres issued by the Board of Land Commissioners for the County of Robertson on the 6th day of September 1838. The said survey is No 14 on Big Cedar Creek on the South side of the San Antonio road in the County of Missouri Beginning at the East corner of Survey No 16 made for the said Pruitt on the above described certificate a stake from which a 2nd oak 12 In in diameter bears S 74 W 10 1/4 bars and another 2nd oak 14 In in diameter bears S 4 W 10 1/4 bars "

N. 45. E.	1900.	Thence N 45 E at 300 bars into bottom at 1250 bars cut runs East at 1550 left Bottom at 1900 bars a stake set for the East corner of this survey from which a 2 nd oak 12 In in diameter bears S 58 W 4 2/3 and another 2 nd oak 10 In in diameter bears N 12 W 14 1/4 bars "
N. 45. W.	1900.	Thence N 45 W 1900 bars to North corner in S.E. boundary line of survey No 15 made for Job B. Cook a stake from which a 2 nd oak 18 in in diameter bears S 10 E. 2 1/2 and another 2 nd oak 14 In in diameter bears N 9 W 29 1/2 "
S. 45. W.	1900.	Thence S 45 W with the S.E. boundary line of No 15, 1570 bars to same corner 1900 bars to the West corner of this survey and in S.E. boundary line of No 14 on said Eldred 10 In in diameter from which an Eldred in diameter bears N 62 E 4 bars and a 2 nd oak 14 In in diameter bears S 45 W 47 1/4 "
S. 45. E.	1900.	Thence S 45 E 1900 bars to the place of Beginning "

Chas. Stephen Cooley
 James Pruitt

I H. G. Collett, do solemnly declare under the oath of my office that the above described survey was made on the 12th day of June last that it was made according to law and that the corners boundaries and corners with the marks, notes and articles are truly given and described in the foregoing plot and field notes "

H. G. Collett C.S.
 N.C.

Missouri County October 15th 1841

3

File 2+3

Navisette Co. 9th Claps

Field Notes 640 acres

James Hewitt

Sur. No 17

patent No 105

A plot and field notes of a
lot of 640 acres made for
James Hewitt

m 17

Recorded in Book A

page 3

H. G. Battie

cc vol 1459 H B

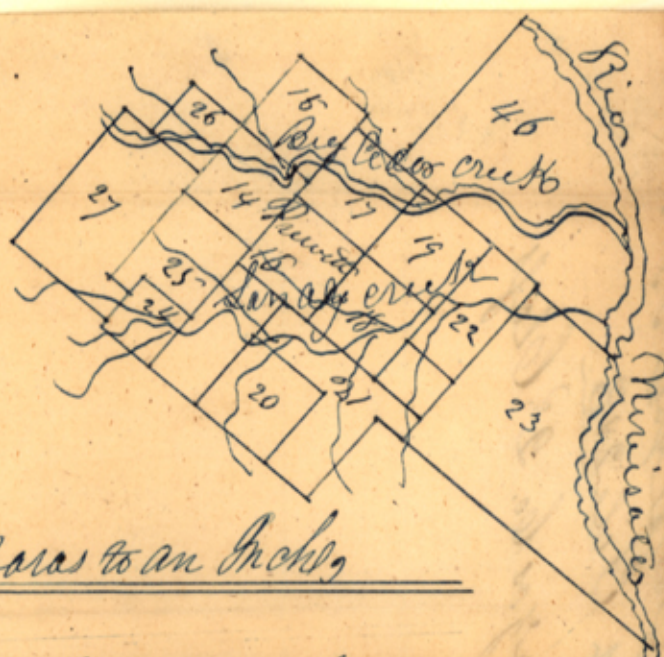

San Antonio 1841

Scale of 4000 paces to an Inch

A plot and field notes of a survey of 640 acres of land made for James Pruitt it being a part of the land to which he is entitled by virtue of his headright Certificate No 52, Second Class issued Dec 12th 1840 issued by the Board of Land Commissioners for Robertson County on the 6th day of September 1838

The said survey is no 16 on the waters of Big Cedar Creek and the north side on the South side of the San Antonio road in the County of Wisconsin

Beginning at a stake set for the west corner of this survey from which a 2nd Post Oak 15 in in diameter bears N 75 E 74 paces and another 2nd Post Oak 18 in in diameter bears S 47 W 64 paces

N 45 E 1900 Thence S 45 E 1900 paces to a stake set for the South corner of this survey from which a Hickory 12 in in diameter bears North 83 paces and a 2nd Post Oak 10 in in diameter bears S 74 E 64 paces

N 45 E 1900 Thence N 45 E 1900 paces to a stake set for the East corner of this survey from which a 2nd Post Oak 12 in in diameter bears S 74 W 104 paces and another 2nd Post Oak 14 in in diameter bears N 45 W 104 paces

N 45 W 1500 Thence N 45 W 1500 paces to North corner and S. E. Boundary line of Callen head survey No 14 at stake corner on an Elm 10 in in diameter from which an Elm 8 in in diameter bears N 62 E 44 paces and a 2nd Post Oak 14 in in diameter bears S 24 W 44 paces

S 45 W 1900 Thence S 45 W with said Callen head 1570 paces to his South corner same course at 1900 is the place of Beginning

Chain Stephen Copley
 Minn R. B. Pruitt

I H. G. Battlett as solemnly declare under the oath of my office that the above described survey was made on 13th day of June last and that it was made according to law and that the limits boundaries and corners with the most natural and artificial are truly given and described in the foregoing plot and field notes

Wisconsin County October 15th 1841

H. G. Battlett C.S.
 W.C.

4 Pillsbury

Marquette Co. 2 Bluffs

Office Notes 640 West W. 3rd St

James Freeman - 2000 - 2000 - 2000

Sur. No. 16.

Patent No. 106.

1716

A plot and subdivision of
640 acres made for
James Freeman & Co. 2^d Bluffs
as marked on the
File 213.

6

No 283

James Prescott

& Surveyor

1280 Orono and Bluffs

Marquette County

Datunka

22