

24,000,000

Mary Cole -

Witnessed by 7/35  
vol 15. p. 1111

Coryell Co  
Iowa

1854

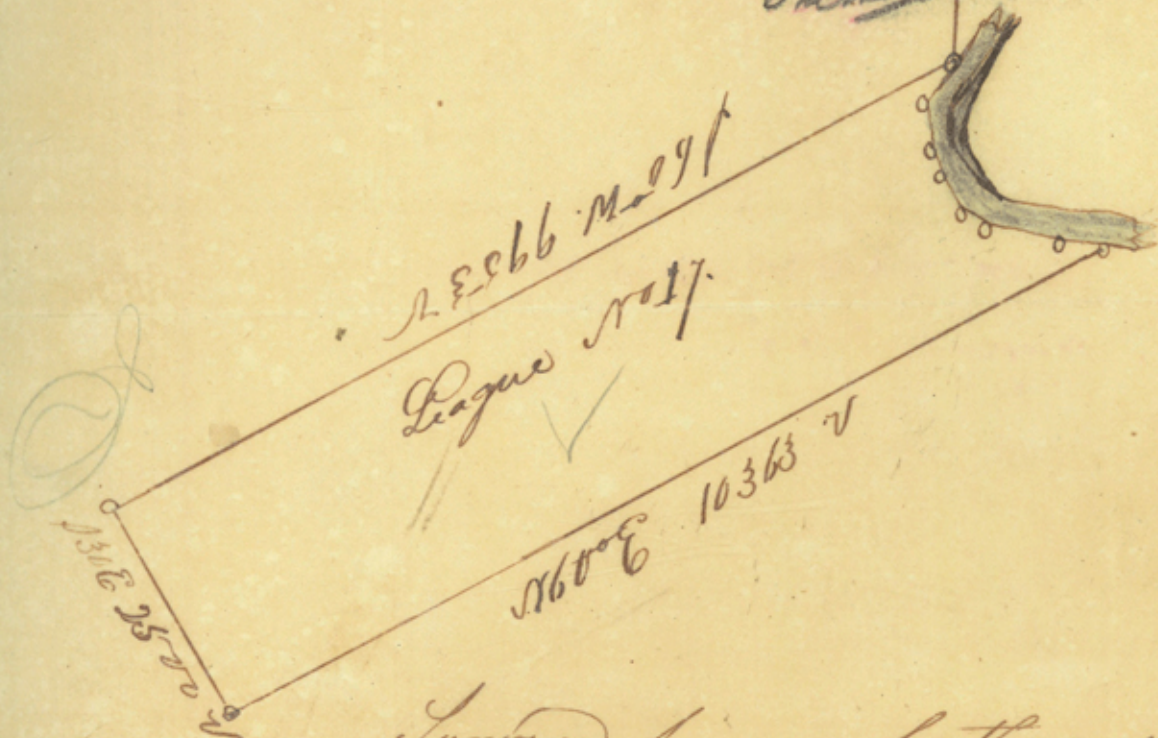

Surveyed for and by the order of  
~~Mary Cole~~ one league of land No 17 above  
 the mouth of Childers creek & lying on the west  
 bank of the Brazos and bounded as follows. Beginning  
 on the upper corner of league No 18. on an ash tree 10 in  
 an ash 8 in. bears S10°W. 11.0 v also a cotton wood tree 24 in  
 bears N23°E. at 6.0 v. Thence running up the river meander  
 -ing the same for a bear of 2500.0 v. (viz) N63°W. 450.0  
 N80°W 780.0 v. N33°W. 280.0 v. N34°W 420.0 v. N21°W 310.0 v  
 N10°W 500.0 v. N33°E 530.0 v to the lower corner of league  
 No 16. on a cedar tree 14 in diam a cedar 8 in bears  
 N30°E at 1.0 v. also a cedar 6 in. bears west at 1 1/2 v. —

Thence running N60°W 9953.0 v. at 800.0 v. enter prairie  
 and pass to the corner & drive a stake no bearings.

Thence N30°E. 2500.0 v. to a stake in prairie no bearings.

Thence N60°E. 10363.0 v to the beginning containing  
 an area of 24,000,000. square rods in. Superficial  
 of which 9/24 is farming & 23/24 is pasture lands without  
 the facility of exogation surveyed the 31<sup>st</sup> day of  
 May 1855 - by

C. B. Chance & D. L.  
 Surveyors

88

1851

*Faint pinkish text, possibly bleed-through or a stamp.*



Platt & certificate  
 are before  
 1851  
 Surveyed for

*[Large decorative flourish or signature]*

May 1851